

• F.A.P. 72, F.A.P. 67, F.A.P. 75 & F.A.P. 668
 ** D-6 SPFLD-CLRLAKE DIRKSEN 2002

F.A.P. RTE.	SECTION	COUNTY	TOTAL SHEETS	SHEET NO.
*	**	SANGAMON	363	33
STA.		TO STA.		
FED. ROAD DIST. NO.	ILLINOIS	FED. AID PROJECT		
CONTRACT NO. 72088				

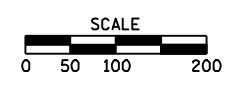

STAGE I SUGGESTED SEQUENCE OF CONSTRUCTION:

1. CONSTRUCT STORM SEWERS ASSOCIATED WITH SOUTH FRONTAGE ROAD AND KMART PARKING LOT.
2. BORE & JACK NEW STORM SEWER UNDER CLEAR LAKE AVE. AT STA. 29+95.
3. CONSTRUCT STORM SEWER ALONG RE-ALIGNED HILL STREET, NORTH FRONTAGE ROAD, AND WB CLEAR LAKE STA. 25+50.00 TO STA. 29+95.00.
4. CONSTRUCT RE-ALIGNED HILL STREET STA. 0+46 TO STA. 17+84.
5. CONSTRUCT NORTH FRONTAGE ROAD.
6. ROUTE HILL ST TRAFFIC TO RE-ALIGNED HILL ST.
7. REMOVE EXISTING HILL ST STA. 13+62 TO STA. 22+14.
8. CONSTRUCT WEST ENTRANCE TO K-MART AND SOUTH FRONTAGE ROAD. (ROUTE K-MART TRAFFIC TO EXISTING EAST ENTRANCE).
9. CONSTRUCT SOUTH FRONTAGE ROAD STA. 9+38 TO 13+89.
10. CONSTRUCT SIGNALS AT WEST KMART ENTRANCE AND RE-ALIGNED HILL STREET INTERSECTION AND ACTIVATE.
11. CONSTRUCT KMART PARKING LOT CURB/GUTTER.
12. ADJUST OVERHEAD SIGN SUPPORTS OUTSIDE PROPOSED PAVEMENT.

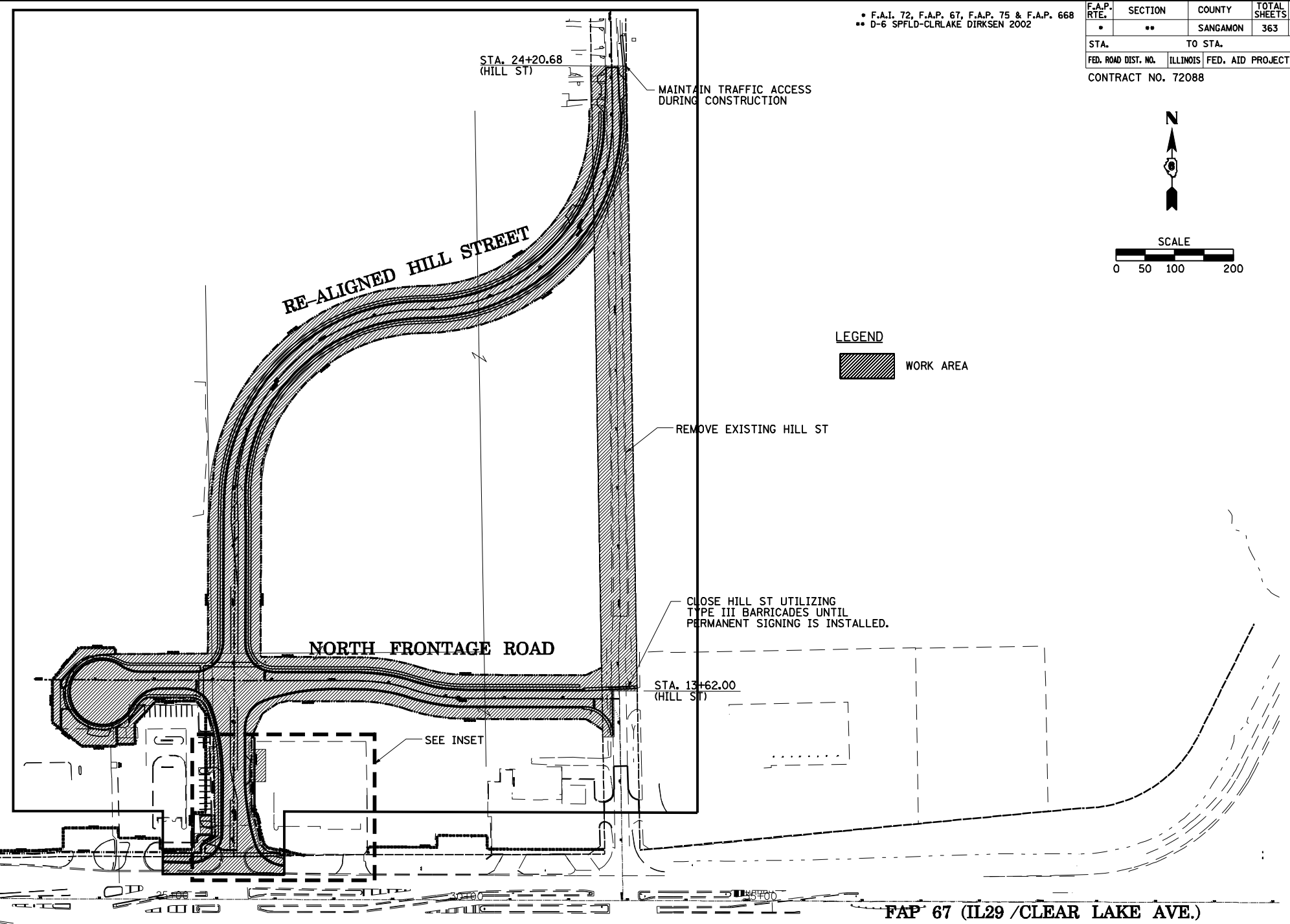
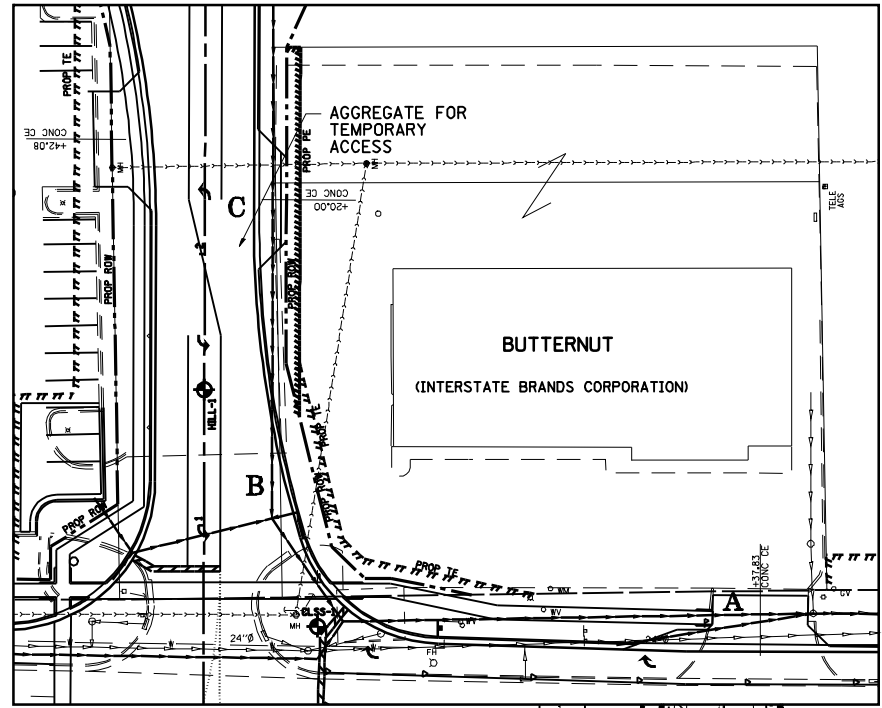

LEGEND
 WORK AREA

SHEET NOTES

1. USE STANDARD 701601 FOR LANE CLOSURES ON CLEAR LAKE AVE.
2. USE STANDARD 701501 FOR STAGING RE-ALIGNED HILL ST AT EXISTING HILL STREET.
3. -ACCESS TO EXISTING BUSINESSES SHALL BE MAINTAINED.
 -CONSTRUCT TEMPORARY ENTRANCE AT THE PROPOSED ENTRANCE AT 2+20.00 ON PROPOSED HILL STREET (LOCATION C IN THE INSET).
 -INSTALL STORM SEWER ACROSS ENTRANCE A KEEPING ENTRANCE B & C OPEN.
 -OPEN ENTRANCE A, CONSTRUCT STORM SEWER ACROSS ENTRANCE B.
 -OPEN ENTRANCE B TEMPORARILY TO CONSTRUCT STORM SEWER ACROSS ENTRANCE C.
 -CONSTRUCT ENTRANCE C AND COMPLETE CONSTRUCTION OF HILL STREET.
4. USE STANDARD 701801 FOR SIDEWALK CLOSURES.
5. TRAFFIC CONTROL FOR STAGE I CONSTRUCTION SHALL BE PAID FOR AT THE CONTRACT UNIT PRICE FOR THE TRAFFIC CONTROL ITEMS SPECIFIED.

FAP 75 (IL29 / DIRKSEN PKWY.)

CLOSE ENTRANCE WITH TYPE III BARRICADES DURING CONSTRUCTION

REVISIONS	
NAME	DATE

ILLINOIS DEPARTMENT OF TRANSPORTATION

STAGE I CONSTRUCTION

SCALE: VERT. 1/05
 HORIZ. DATE

DRAWN BY MLO
 CHECKED BY CWG