

F.A.I. 72, F.A.P. 67, F.A.P. 75 & F.A.P. 668
 D-6 SPFLD-CLRLAKE DIRKSEN 2002

F.A.P. RTE.	SECTION	COUNTY	TOTAL SHEETS	SHEET NO.
*	**	SANGAMON	363	40
STA. TO STA.				
FED. ROAD DIST. NO.	ILLINOIS	FED. AID PROJECT		
CONTRACT NO. 72088				

LEGEND

	WORK AREA
	SIGN ON PORTABLE OR PERMANENT SUPPORT
	DRUM WITH MONO DIRECTIONAL LIGHT
	DRUM WITH MONO DIRECTIONAL FLASHING LIGHT
	TYPE III BARRICADE

	PAVEMENT MARKING TO BE REMOVED	6' TYP	2' TYP	10' TYP	30' TYP	10' TYP
	TEMPORARY PAVEMENT MARKING					
	PAVEMENT MARKING TO REMAIN					
	TRAFFIC FLOW DIRECTION					
	ITEM [4] DOUBLE YELLOW (NARROW)					

TEMPORARY PAVEMENT MARKING LEGEND

1	4" SKIP-DASH YELLOW
2	4" SOLID YELLOW
3	4" DIAGONAL YELLOW
4	4" DOUBLE YELLOW NARROW
5	4" SKIP-DASH WHITE
6	4" SOLID WHITE
7	24" STOP BAR WHITE
8	4" DIAGONAL WHITE

TRAFFIC CONTROL STANDARDS
701602

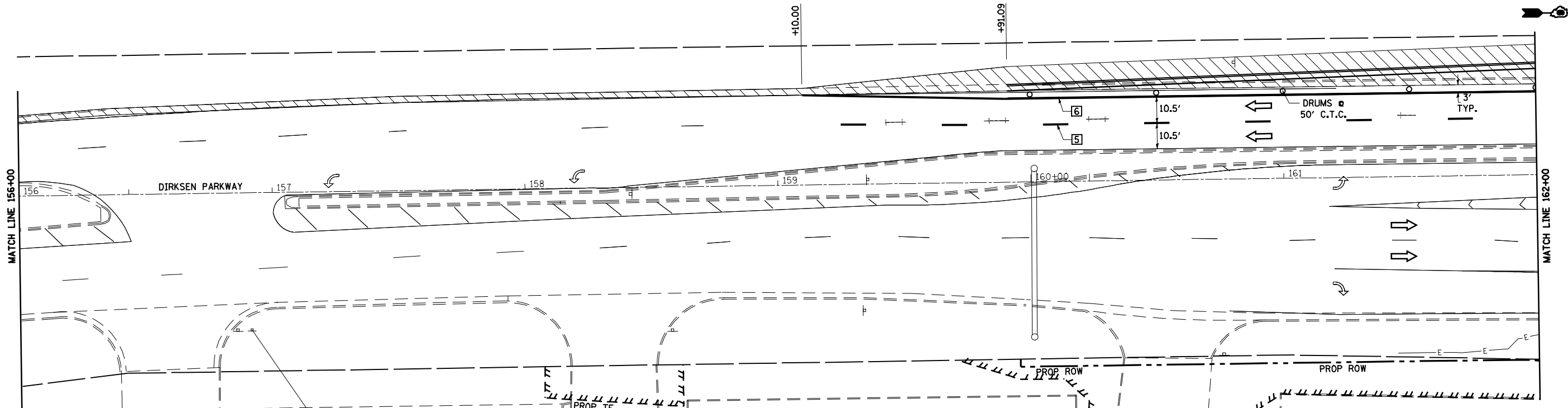
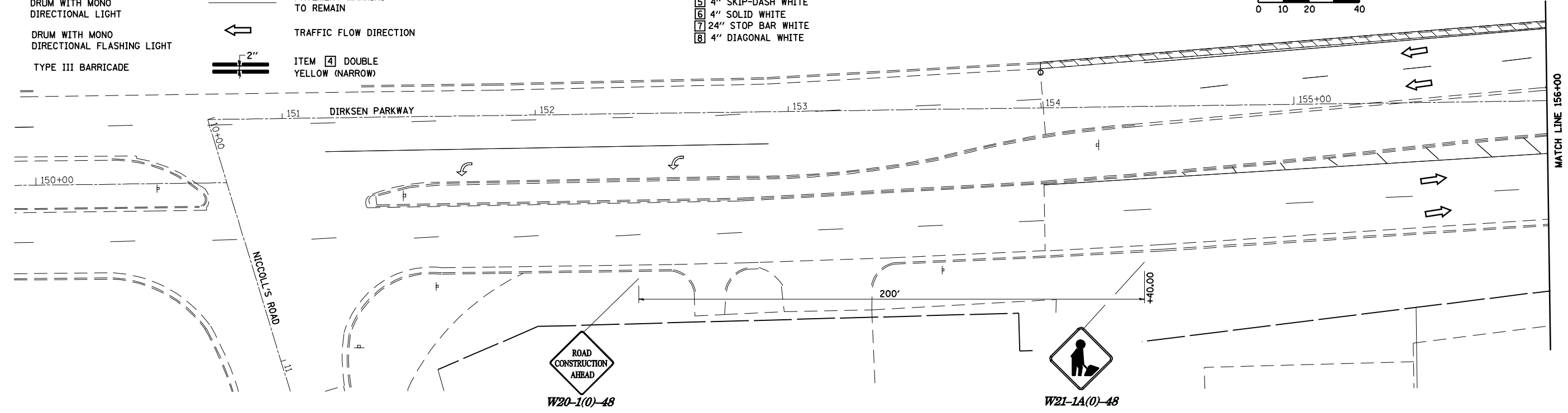
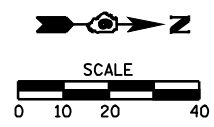

SHEET 8 OF 34

REVISIONS	
NAME	DATE

ILLINOIS DEPARTMENT OF TRANSPORTATION

STAGE II CONSTRUCTION

SCALE: VERT. 1"=20'
 HORIZ. 1"=40'

DATE: 1/05

DRAWN BY: NJV
 CHECKED BY: CWG