

• F.A.P. 72, F.A.P. 67, F.A.P. 75 & F.A.P. 668
 • D-6 SPFLD-CLRLAKE DIRKSEN 2002

F.A.P. RTE.	SECTION	COUNTY	TOTAL SHEETS	SHEET NO.
*	**	SANGAMON	363	41
STA.		TO STA.		
FED. ROAD DIST. NO.	ILLINOIS	FED. AID PROJECT		
CONTRACT NO. 72088				

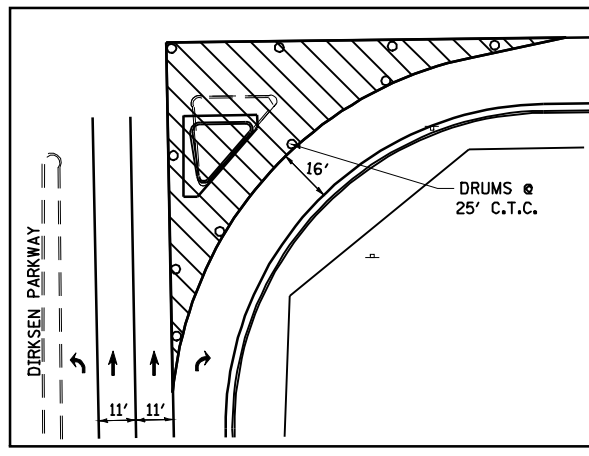

TYPICAL ISLAND STAGING

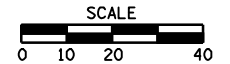
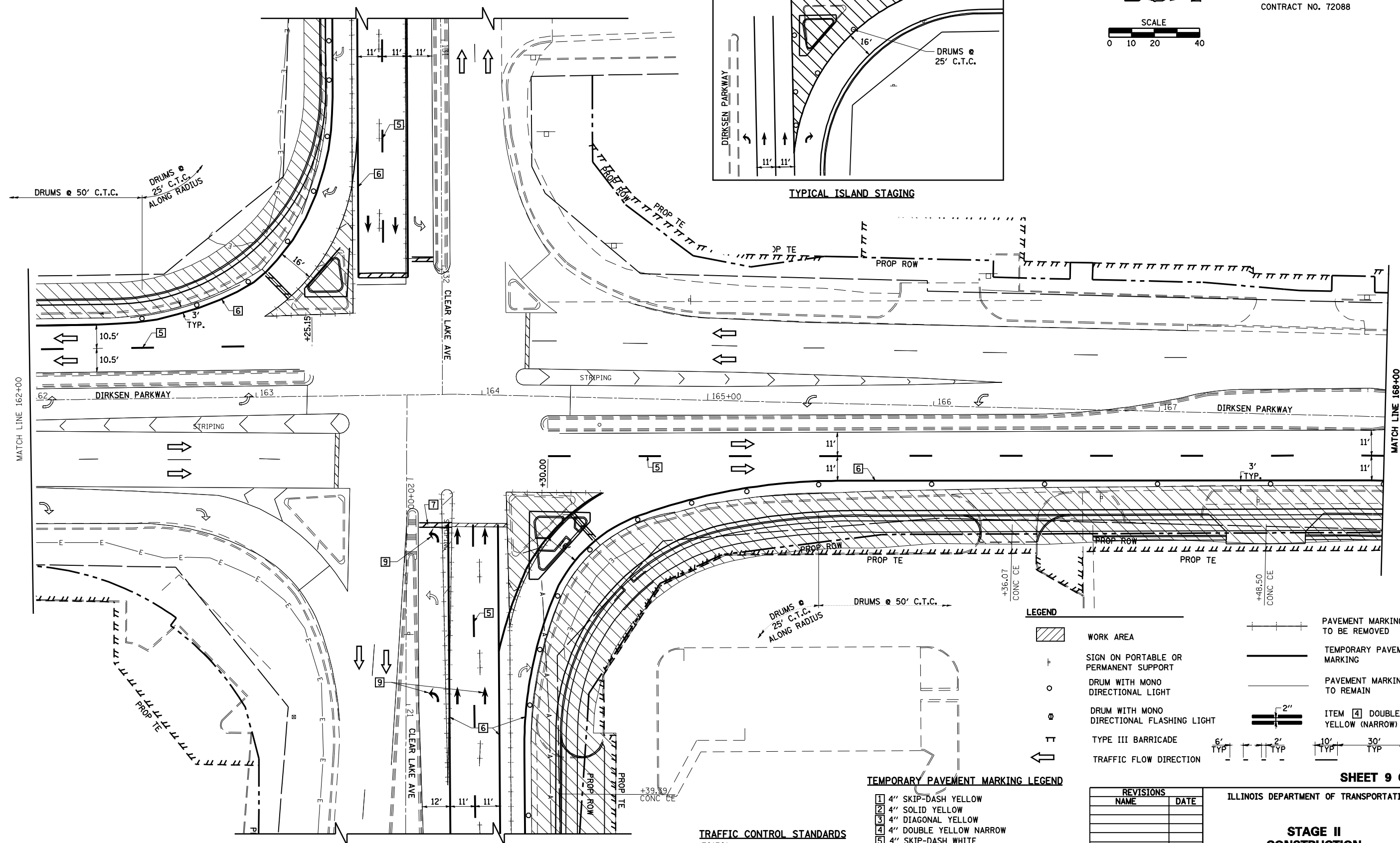

LEGEND		PAVEMENT MARKING TO BE REMOVED	
	WORK AREA		PAVEMENT MARKING TO BE REMOVED
	SIGN ON PORTABLE OR PERMANENT SUPPORT		TEMPORARY PAVEMENT MARKING
	DRUM WITH MONO DIRECTIONAL LIGHT		PAVEMENT MARKING TO REMAIN
	DRUM WITH MONO DIRECTIONAL FLASHING LIGHT		ITEM [4] DOUBLE YELLOW (NARROW)
	TYPE III BARRICADE		TRAFFIC FLOW DIRECTION

TEMPORARY PAVEMENT MARKING LEGEND

- 1 4" SKIP-DASH YELLOW
- 2 4" SOLID YELLOW
- 3 4" DIAGONAL YELLOW
- 4 4" DOUBLE YELLOW NARROW
- 5 4" SKIP-DASH WHITE
- 6 4" SOLID WHITE
- 7 24" STOP BAR WHITE
- 8 4" DIAGONAL WHITE
- 9 LETTERS & SYMBOLS

TRAFFIC CONTROL STANDARDS
701701

REVISIONS	
NAME	DATE

ILLINOIS DEPARTMENT OF TRANSPORTATION

STAGE II CONSTRUCTION

SCALE: VERT. 1/8" = 1'-0"
 HORIZ. 1" = 40'-0"

DATE: 1/05

DRAWN BY: NJV
 CHECKED BY: CWG