

F.A.P. RTE.	SECTION	COUNTY	TOTAL SHEETS	SHEET NO.
*	**	SANGAMON	363	46
STA.		TO STA.		
FED. ROAD DIST. NO.	ILLINOIS	FED. AID PROJECT		
CONTRACT NO. 72088				
* F.A.I. 72, F.A.P. 67, F.A.P. 75 & F.A.P. 668				
** D-6 SPFLD-CLRLAKE DIRKSEN 2002				

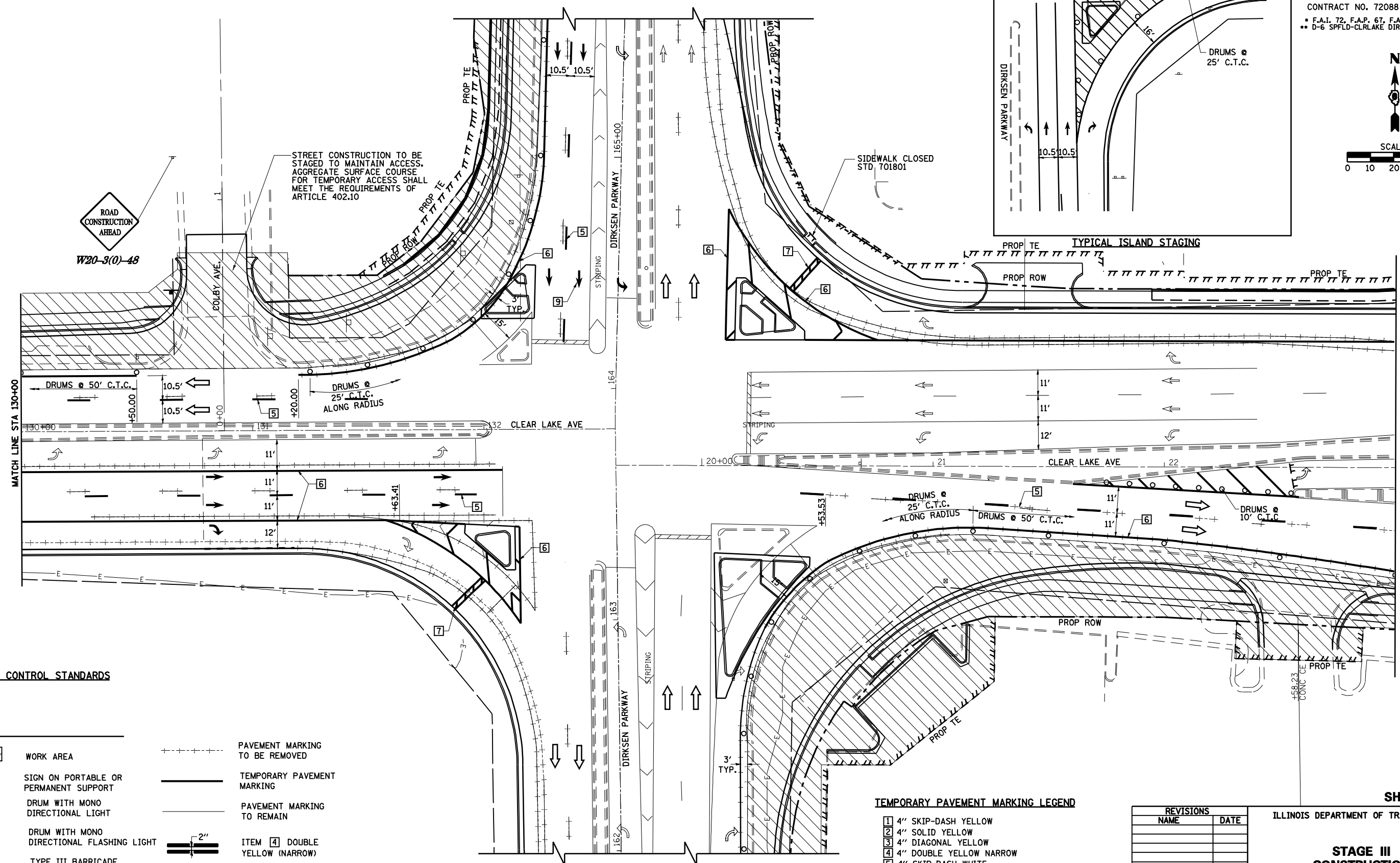
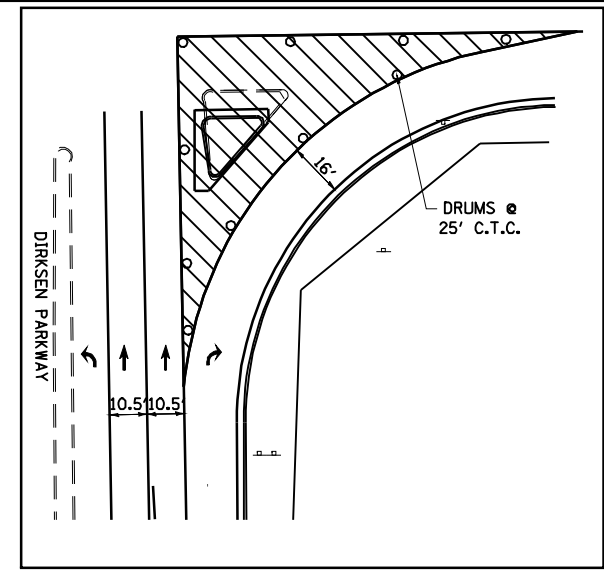
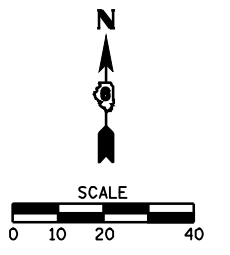

TRAFFIC CONTROL STANDARDS

701701
701801

LEGEND

	WORK AREA		PAVEMENT MARKING TO BE REMOVED
	SIGN ON PORTABLE OR PERMANENT SUPPORT		TEMPORARY PAVEMENT MARKING
	DRUM WITH MONO DIRECTIONAL LIGHT		PAVEMENT MARKING TO REMAIN
	DRUM WITH MONO DIRECTIONAL FLASHING LIGHT		ITEM [4] DOUBLE YELLOW (NARROW)
	TYPE III BARRICADE		
	TRAFFIC FLOW DIRECTION		

TEMPORARY PAVEMENT MARKING LEGEND

- 1 4" SKIP-DASH YELLOW
- 2 4" SOLID YELLOW
- 3 4" DIAGONAL YELLOW
- 4 4" DOUBLE YELLOW NARROW
- 5 4" SKIP-DASH WHITE
- 6 4" SOLID WHITE
- 7 24" STOP BAR WHITE
- 8 4" DIAGONAL WHITE
- 9 LETTERS & SYMBOLS

REVISIONS	
NAME	DATE

ILLINOIS DEPARTMENT OF TRANSPORTATION

STAGE III CONSTRUCTION

SCALE: VERT. 1/05
HORIZ. 1/05

DATE: 1/05

DRAWN BY: NJV
CHECKED BY: CWG