

• F.A.P. 72, F.A.P. 67, F.A.P. 75 & F.A.P. 668
 • D-6 SPFLD-CLRLAKE DIRKSEN 2002

| | | | | |
|---------------------|----------|------------------|--------------|-----------|
| F.A.P. RTE. | SECTION | COUNTY | TOTAL SHEETS | SHEET NO. |
| • | •• | SANGAMON | 363 | 51 |
| STA. | | TO STA. | | |
| FED. ROAD DIST. NO. | ILLINOIS | FED. AID PROJECT | | |
| CONTRACT NO. 72088 | | | | |

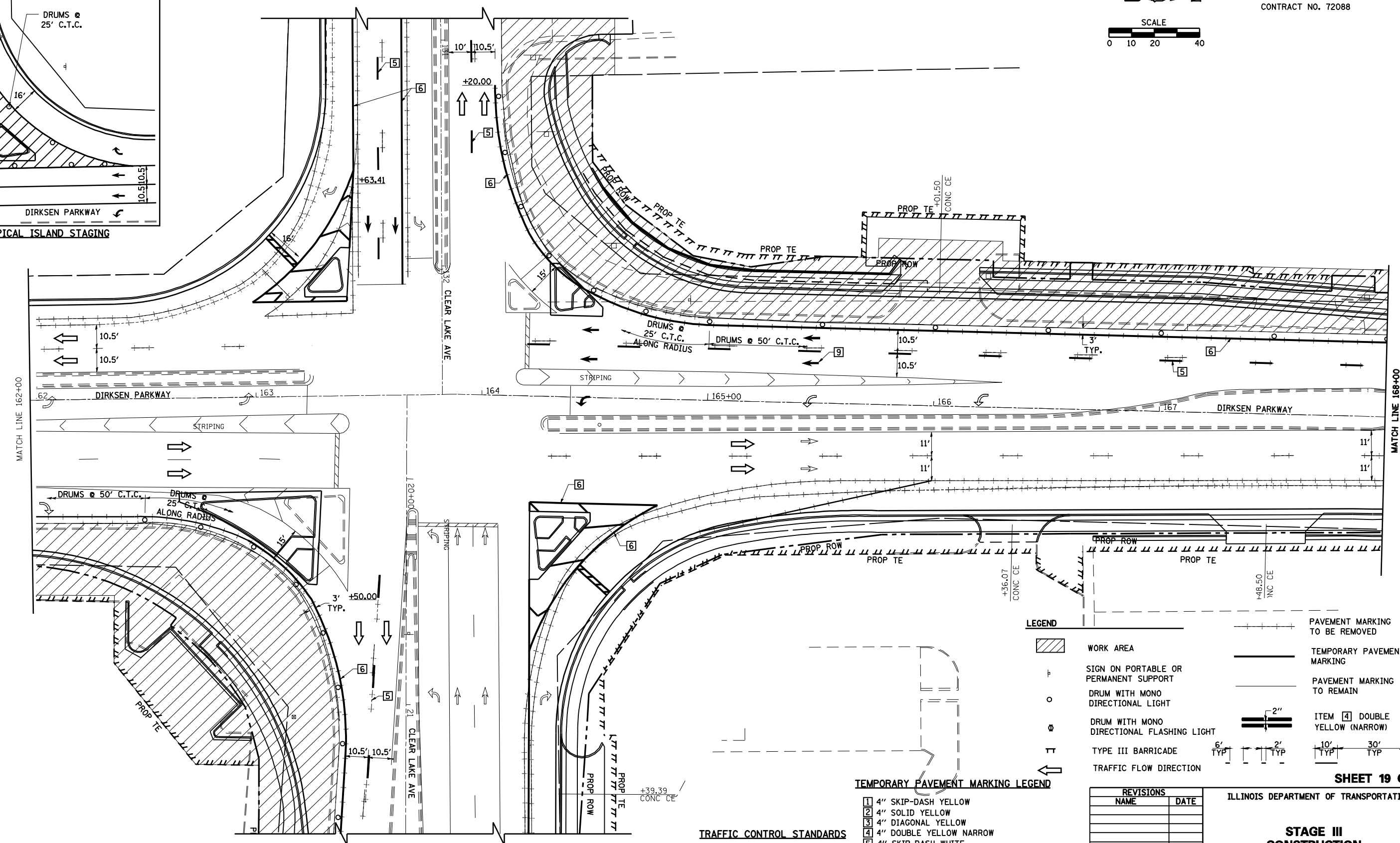
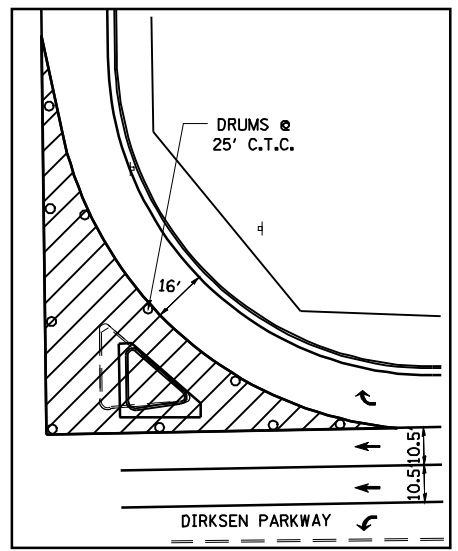
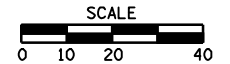

LEGEND

- WORK AREA
- SIGN ON PORTABLE OR PERMANENT SUPPORT
- DRUM WITH MONO DIRECTIONAL LIGHT
- DRUM WITH MONO DIRECTIONAL FLASHING LIGHT
- TYPE III BARRICADE
- TRAFFIC FLOW DIRECTION
- PAVEMENT MARKING TO BE REMOVED
- TEMPORARY PAVEMENT MARKING
- PAVEMENT MARKING TO REMAIN
- ITEM [4] DOUBLE YELLOW (NARROW)
- 2" TYP.
- 6' TYP.
- 2' TYP.
- 10' TYP.
- 30' TYP.
- 10' TYP.

TEMPORARY PAVEMENT MARKING LEGEND

- [1] 4" SKIP-DASH YELLOW
- [2] 4" SOLID YELLOW
- [3] 4" DIAGONAL YELLOW
- [4] 4" DOUBLE YELLOW NARROW
- [5] 4" SKIP-DASH WHITE
- [6] 4" SOLID WHITE
- [7] 24" STOP BAR WHITE
- [8] 4" DIAGONAL WHITE
- [9] LETTERS & SYMBOLS

TRAFFIC CONTROL STANDARDS
701701

| REVISIONS | |
|-----------|------|
| NAME | DATE |
| | |
| | |
| | |
| | |
| | |
| | |
| | |
| | |
| | |
| | |

ILLINOIS DEPARTMENT OF TRANSPORTATION

STAGE III CONSTRUCTION

SCALE: VERT. 1/8" = 1'-0"
 HORIZ. 1" = 40'-0"

DATE: 1/05

DRAWN BY: NJV
 CHECKED BY: CWG