

SEC 36, T16N, R5W, 3RD PM

F.A.I. 72, F.A.P. 67, F.A.P. 75 & F.A.P. 668
 D-6 SPFLD-CLRLAKE DIRKSEN 2002

| F.A. RTE. | SECTION | COUNTY | TOTAL SHEETS | SHEET NO. |
|---------------------|----------|------------------|--------------|-----------|
| * | ** | SANGAMON | 363 | 97 |
| STA. TO STA. | | | | |
| FED. ROAD DIST. NO. | ILLINOIS | FED. AID PROJECT | | |
| CONTRACT NO. 72088 | | | | |

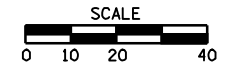

LEGEND

- MEDIAN & C&G REMOVAL
- PAVEMENT REMOVAL
- DRIVEWAY PAVEMENT REMOVAL
- PARKING LOT REMOVAL
- CONSTRUCTION LIMITS

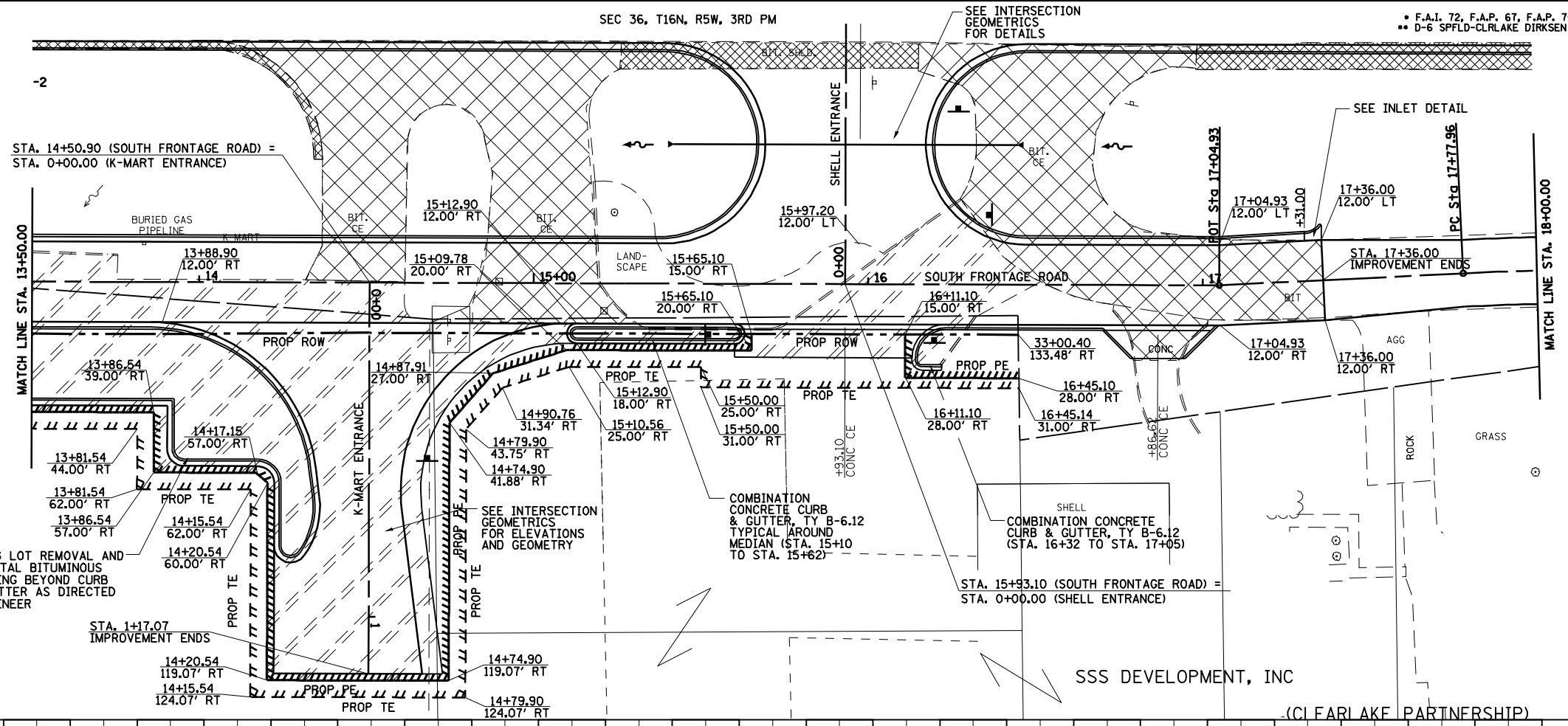

| | | |
|------|--------------------|------|
| PLAN | SURVEYED | DATE |
| | PLOTTED | |
| | CHECKED | |
| | BY | |
| | NO. OF WAY CHECKED | |
| | CADD FILE NAME | |

| | | |
|---------|--------------------------|------|
| PROFILE | SURVEYED | DATE |
| | PLOTTED | |
| | CHECKED | |
| | BY | |
| | STRUCTURE NOTATIONS CHRD | |

