

TYPICAL PAVEMENT MARKING LEGEND

- 1 5" SKIP-DASH YELLOW
- 2 5" SOLID YELLOW
- 3 12" DIAGONAL YELLOW
- 4 5" DOUBLE YELLOW NARROW
- 5 5" DOUBLE YELLOW WIDE
- 6 5" SKIP-DASH WHITE
- 7 6" SKIP-DASH WHITE
- 8 5" SOLID WHITE
- 9 6" SOLID WHITE
- 10 8" SOLID WHITE
- 11 24" STOP BAR WHITE
- 12 12" DIAGONAL WHITE

- U - URETHANE
- PP - PREFORMED PLASTIC, TYPE B
- T - THERMOPLASTIC
- P - PAINT
- ALL TRAFFIC ARROWS ARE "PP"

SEE STANDARDS 780001 & 781001 AND DISTRICT PAVEMENT MARKING DETAILS FOR ADDITIONAL DETAILS FOR PAVEMENT MARKING AND RAISED REFLECTIVE PAVEMENT MARKERS.

• F.A.I. 72, F.A.P. 67, F.A.P. 75 & F.A.P. 668
 •• D-6 SPFLD-CLRLAKE DIRKSEN 2002

F.A.P. RTE.	SECTION	COUNTY	TOTAL SHEETS	SHEET NO.
•	••	SANGAMON	363	153
STA. 62+00.00		TO STA. 74+00.00		
FED. ROAD DIST. NO.	ILLINOIS	FED. AID PROJECT		
CONTRACT NO. 72088				

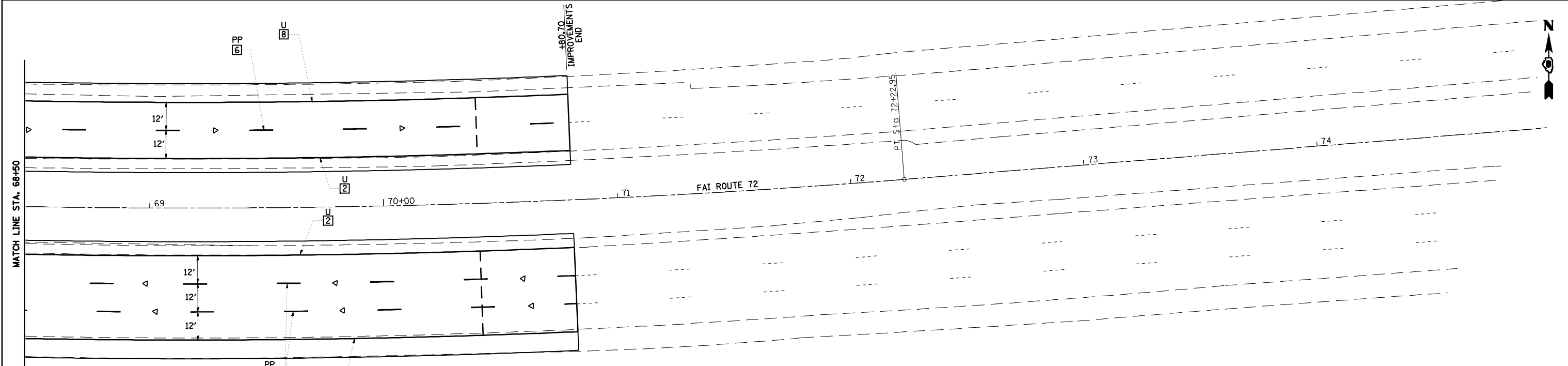
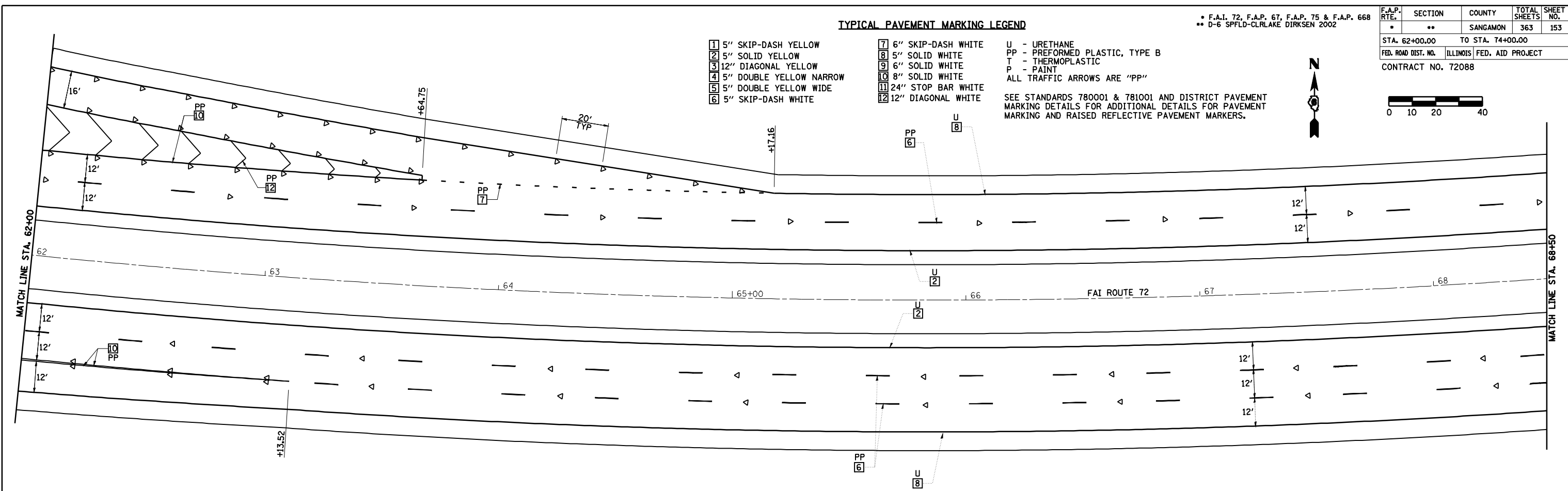
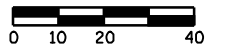

LEGEND

- RAISED REFL PAVT MKR AMBER BIDIRECTIONAL
- RAISED REFL PAVT MKR AMBER MONODIRECTIONAL
- RAISED REFL PAVT MKR CRYSTAL MONODIRECTIONAL
- PRISMATIC CURB REFLECTOR AMBER BIDIRECTIONAL
- PRISMATIC CURB REFLECTOR AMBER MONODIRECTIONAL
- PRISMATIC CURB REFLECTOR CRYSTAL MONODIRECTIONAL
- EXISTING PAVEMENT MARKING
- ITEM 4 DOUBLE YELLOW (NARROW)
- ITEM 5 DOUBLE YELLOW (WIDE)
- 6' TYP
- 2' TYP
- 10' TYP
- 30' TYP
- 10' TYP

REVISIONS	
NAME	DATE

ILLINOIS DEPARTMENT OF TRANSPORTATION

PAVEMENT MARKING PLAN
CLEAR LAKE AVENUE

SCALE: VERT. DATE 08/05
 HORIZ. DATE 08/05

DRAWN BY MLO
 CHECKED BY SJK