

STATE OF ILLINOIS  
DEPARTMENT OF TRANSPORTATION

F.A.P. RTE.	SECTION	COUNTY	TOTAL SHEETS	SHEET NO.
317	**	*	196	103

STA. 452+50.00 TO STA. 454+50.00  
FED. ROAD DIST. NO. ILLINOIS FED. AID PROJECT  
\* BROWN & SCHUYLER CONTRACT NO. 72432  
\*\* 9RS-4, (10,11) RS-3; (10B-1) R  
SHEET 31 OF 123

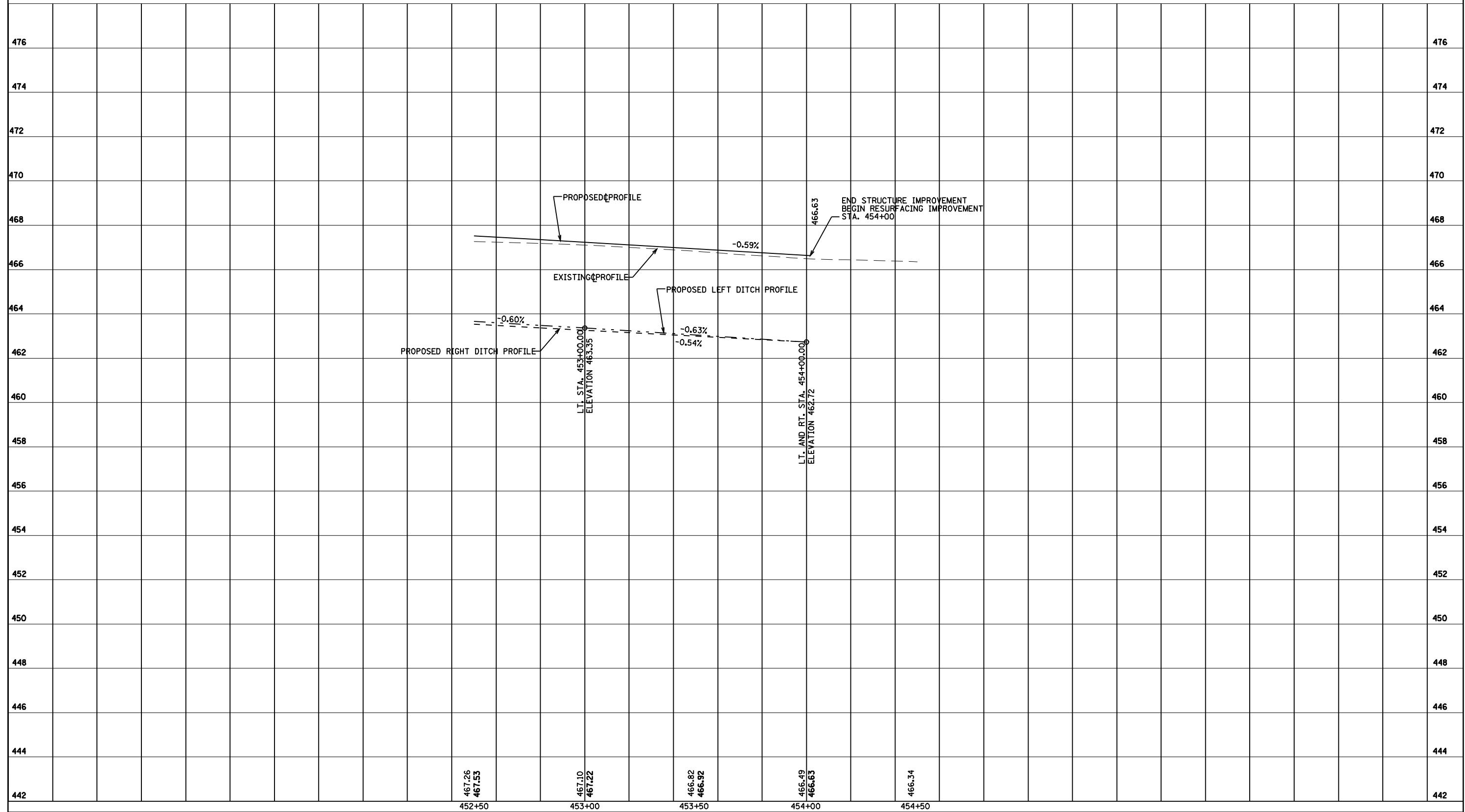

PROFILE - STA. 452+50 TO STA. 454+50