

STATE OF ILLINOIS
DEPARTMENT OF TRANSPORTATION

F.A.P. RTE.	SECTION	COUNTY	TOTAL SHEETS	SHEET NO.
317	**	*	196	113
STA. 420+00.00 TO STA. 454+00.00				
FED. ROAD DIST. NO.	ILLINOIS	FED. AID PROJECT		

* BROWN & SCHUYLER CONTRACT NO. 72432
* * 9RS-4, (10,11) RS-3; (10B-1) R
SHEET 41 OF 123

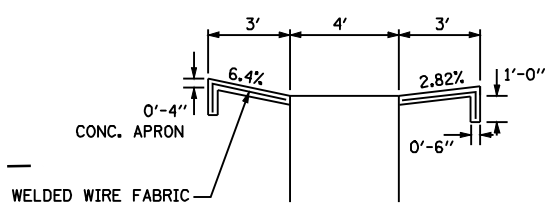
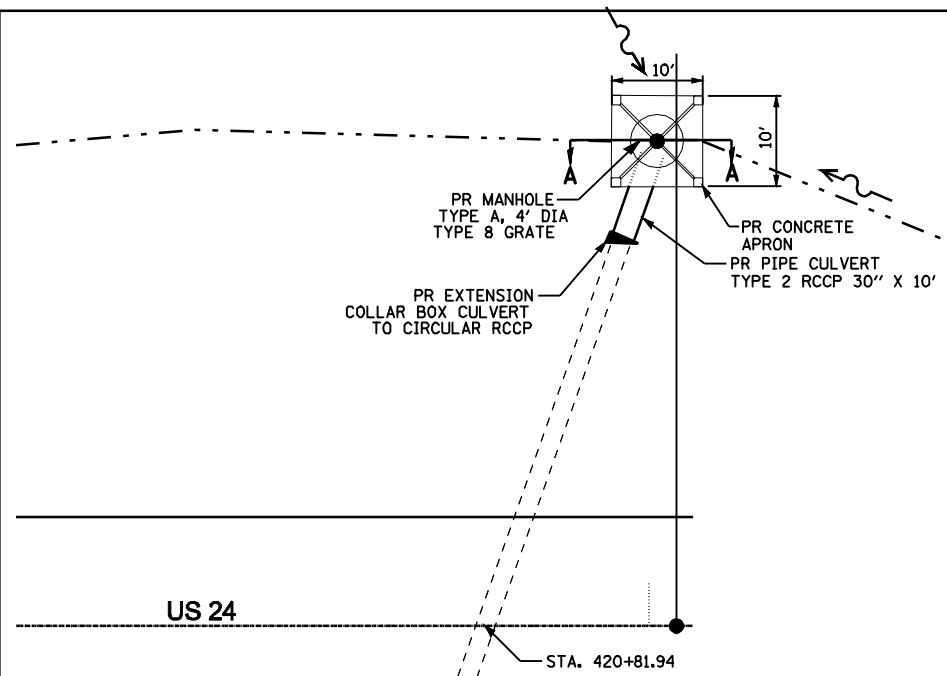

SECTION A-A

NOTE: THE UNIT PRICE BID FOR PROP. MANHOLE, TYPE A, 4' DIA., TYPE 8 GRATE SHALL INCLUDE CASTINGS, CONCRETE, AND REINFORCEMENT FOR CONSTRUCTING THE CONCRETE APRON.

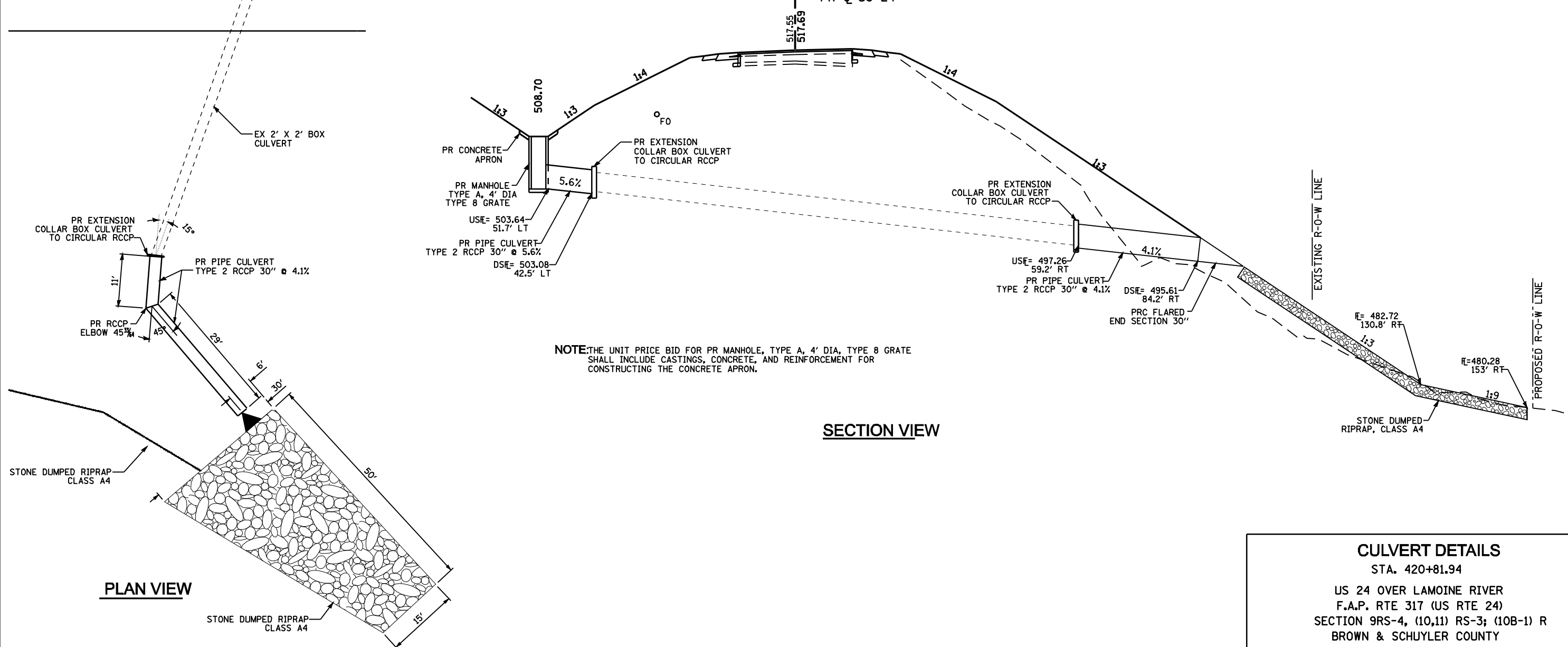

SECTION VIEW

NOTE: THE UNIT PRICE BID FOR PR MANHOLE, TYPE A, 4' DIA, TYPE 8 GRATE SHALL INCLUDE CASTINGS, CONCRETE, AND REINFORCEMENT FOR CONSTRUCTING THE CONCRETE APRON.

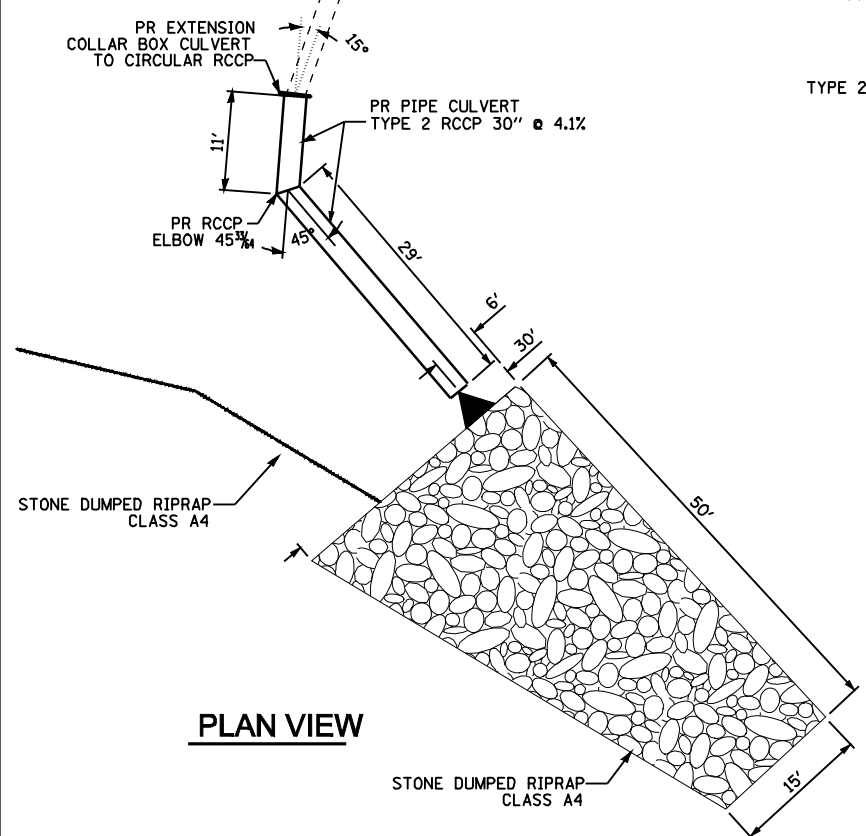

PLAN VIEW

CULVERT DETAILS
STA. 420+81.94
US 24 OVER LAMOINE RIVER
F.A.P. RTE 317 (US RTE 24)
SECTION 9RS-4, (10,11) RS-3; (10B-1) R
BROWN & SCHUYLER COUNTY