

F.A. RTE.	SECTION	COUNTY	TOTAL SHEETS	SHEET NO.
317	**	*	196	168
STA. 440+50.0000 TO STA. 440+50.0000				
FED. ROAD DIST. NO. ILLINOIS FED. AID PROJECT				

* BROWN & SCHUYLER CONTRACT NO. 72432
 ** 9RS-4, (10,11) RS-3; (10B-1) R SHEET 95 OF 123

130 140 150 160

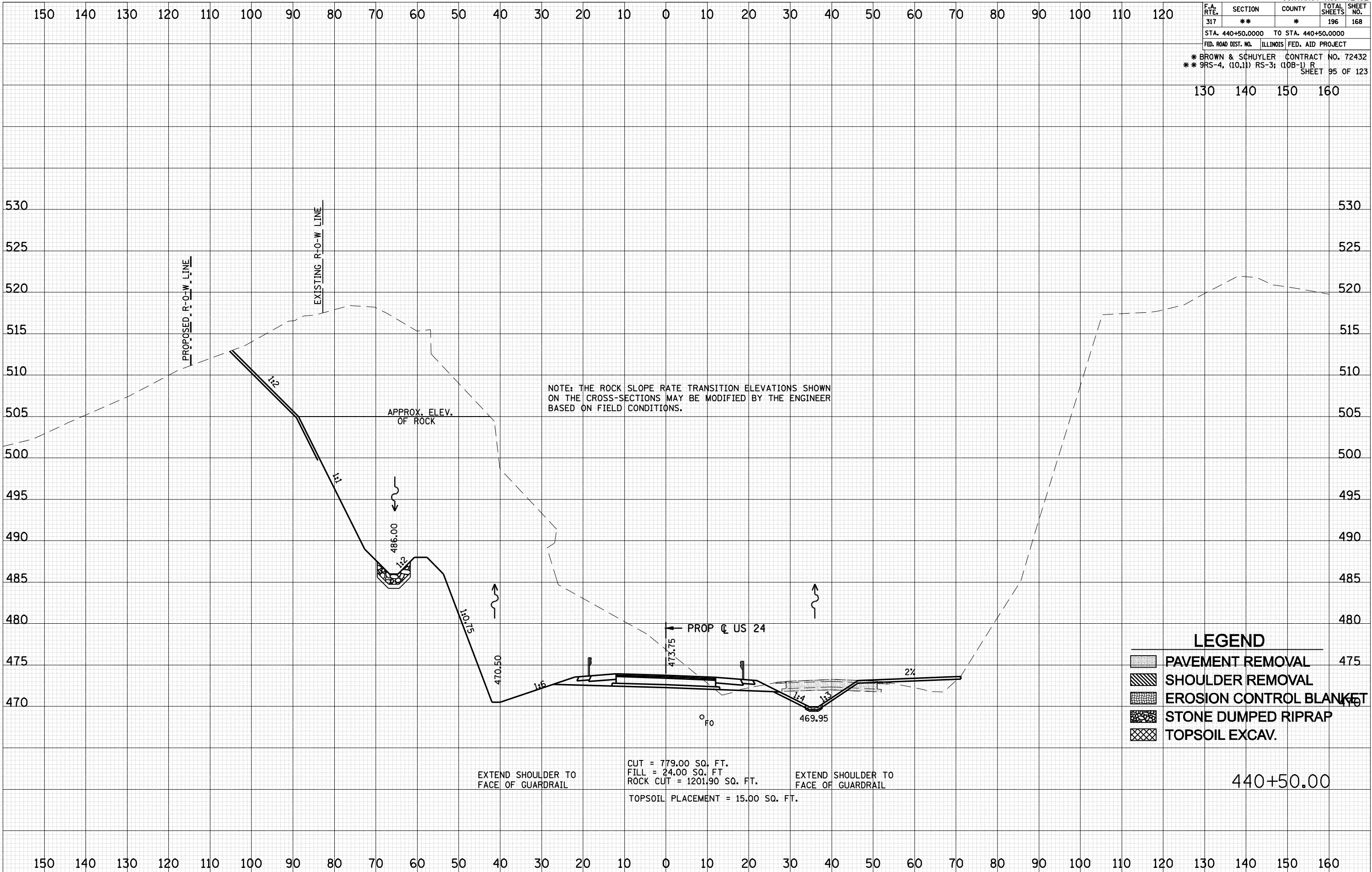

NOTE: THE ROCK SLOPE RATE TRANSITION ELEVATIONS SHOWN ON THE CROSS-SECTIONS MAY BE MODIFIED BY THE ENGINEER BASED ON FIELD CONDITIONS.

LEGEND

	PAVEMENT REMOVAL	475
	SHOULDER REMOVAL	
	EROSION CONTROL BLANKET	
	STONE DUMPED RIPRAP	
	TOPSOIL EXCAV.	

440+50.00

BY _____ DATE _____

ORIGINAL SURVEY	SURVEYED
NOTE BOOK	PLOTTED
NO.	REPLATE
	AREAS CHECKED

BY _____ DATE _____

ORIGINAL SURVEY	SURVEYED
NOTE BOOK	PLOTTED
NO.	REPLATE
	AREAS CHECKED

PLOT DATE = Mar-26-2016 03:46:38PM
 PLOT TIME = 3:46:38 PM
 FILE NAME = FILE4