

F.A. RTE.	SECTION	COUNTY	TOTAL SHEETS	SHEET NO.
317	**	*	196	179
STA. 443+25.0000 TO STA. 443+25.0000				
FED. ROAD DIST. NO. ILLINOIS FED. AID PROJECT				
* BROWN & SCHUYLER CONTRACT NO. 72432				
** 9RS-4, (10,11) RS-3; (10B-1) R SHEET 106 OF 123				

130 140 150 160

BY	DATE

BY	DATE

PLOT DATE = Mar-24-2018 10:46:04AM
 PLOT TIME = 10:46:01 AM
 FILE NAME = FILE1

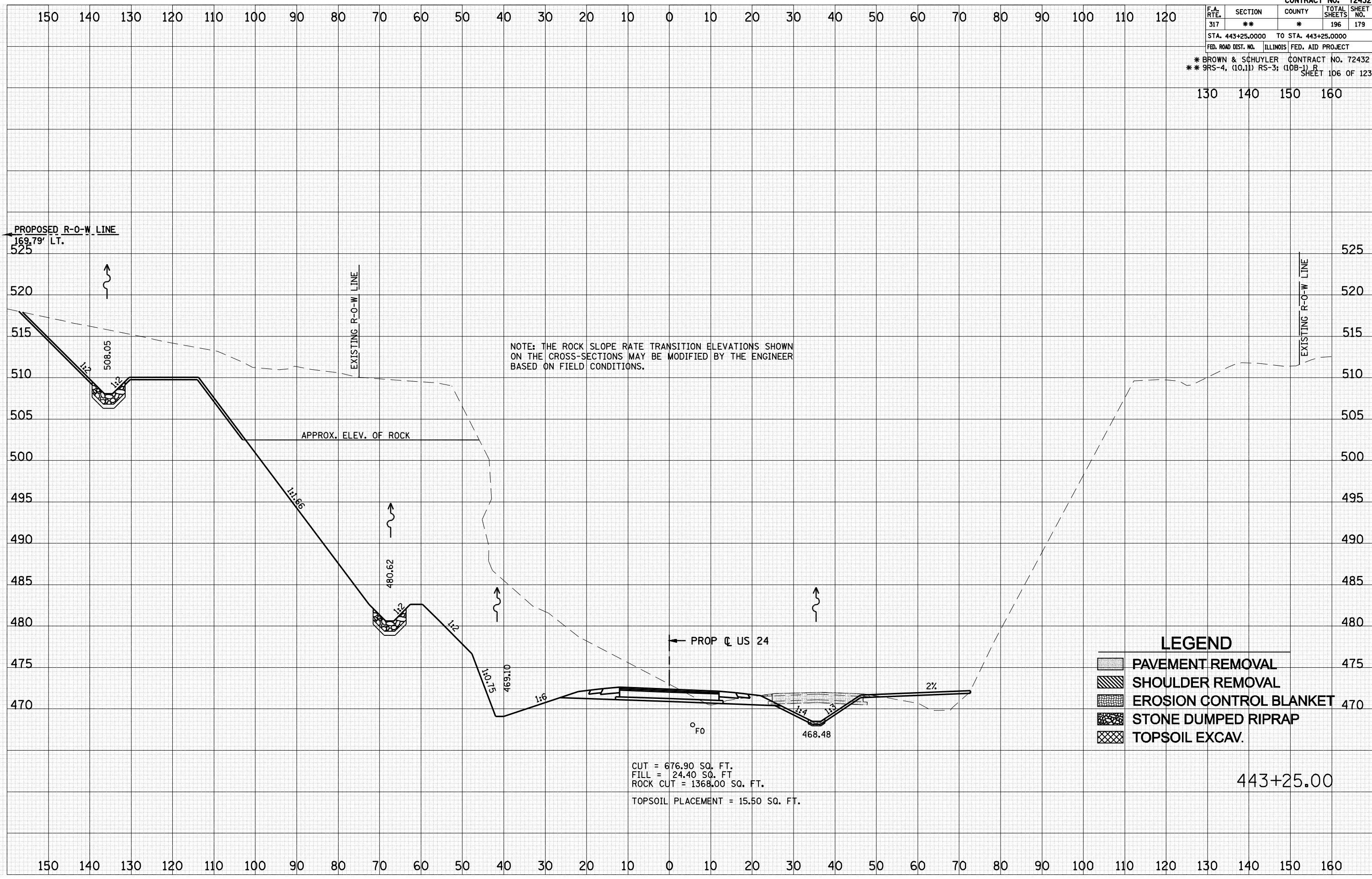

NOTE: THE ROCK SLOPE RATE TRANSITION ELEVATIONS SHOWN ON THE CROSS-SECTIONS MAY BE MODIFIED BY THE ENGINEER BASED ON FIELD CONDITIONS.

LEGEND

- PAVEMENT REMOVAL
- SHOULDER REMOVAL
- EROSION CONTROL BLANKET
- STONE DUMPED RIPRAP
- TOPSOIL EXCAV.

CUT = 676.90 SQ. FT.
 FILL = 24.40 SQ. FT.
 ROCK CUT = 1368.00 SQ. FT.
 TOPSOIL PLACEMENT = 15.50 SQ. FT.

443+25.00