

F.A. RTE.	SECTION	COUNTY	TOTAL SHEETS	SHEET NO.
317	**	*	196	183

STA. 444+50.0000 TO STA. 444+50.0000
 FED. ROAD DIST. NO. ILLINOIS FED. AID PROJECT

* BROWN & SCHUYLER CONTRACT NO. 72432
 ** 9RS-4, (10,11) RS-3; (10B-U) R SHEET 110 OF 123

DATE
BY
NO.
NO.
NO.
NO.

DATE
BY
NO.
NO.
NO.
NO.

PLOT DATE = Mar-24-2010 10:43:20AM
 PLOT TIME = 10:43:23 AM
 FILE NAME = FILE1

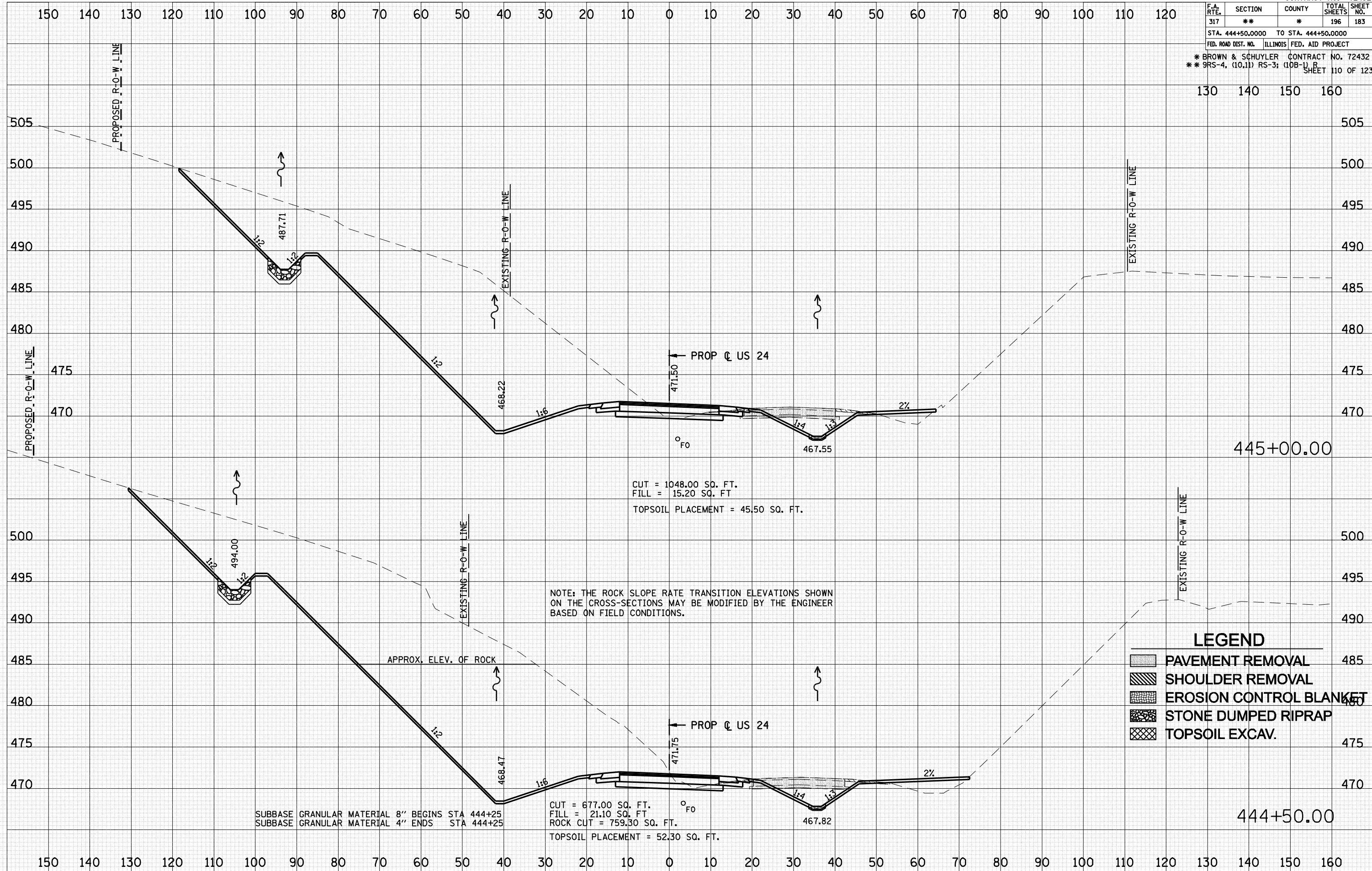

CUT = 1048.00 SQ. FT.
 FILL = 15.20 SQ. FT.
 TOPSOIL PLACEMENT = 45.50 SQ. FT.

NOTE: THE ROCK SLOPE RATE TRANSITION ELEVATIONS SHOWN ON THE CROSS-SECTIONS MAY BE MODIFIED BY THE ENGINEER BASED ON FIELD CONDITIONS.

SUBBASE GRANULAR MATERIAL 8" BEGINS STA 444+25
 SUBBASE GRANULAR MATERIAL 4" ENDS STA 444+25

CUT = 677.00 SQ. FT.
 FILL = 21.10 SQ. FT.
 ROCK CUT = 759.30 SQ. FT.
 TOPSOIL PLACEMENT = 52.30 SQ. FT.

LEGEND

- PAVEMENT REMOVAL
- SHOULDER REMOVAL
- EROSION CONTROL BLANKET
- STONE DUMPED RIPRAP
- TOPSOIL EXCAV.