

6039109A

RUSSELL F. SHELTS, TRUST



STA 756+85.00, 15° SKEW-RTFWD
EX 10' X 10' RC BOX CULV TO BE EXTENDED
(SEE DETAILS)

+00
155.0' LT

+00
155.0' LT

+50
120.0' LT

+00
90.0' LT

+00
90.0' LT

PR RIP RAP, CL A5
(SEE SCHEDULE)

PROP SPBGR
(SEE SCHEDULE)

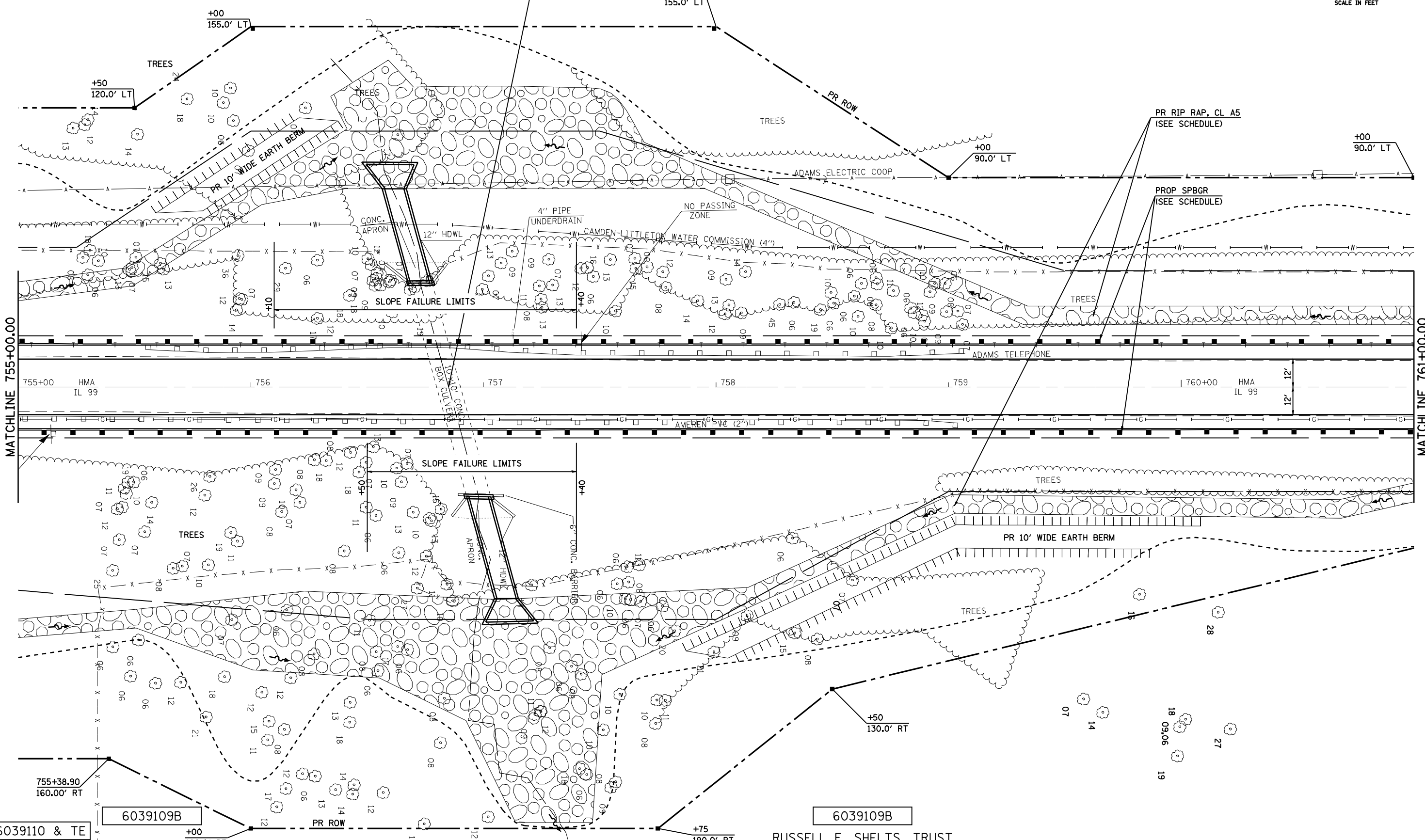

MATCHLINE 755+00.00

MATCHLINE 761+00.00

6039110 & TE

6039109B

6039109B

RUSSELL F. SHELTS, TRUST

FILE NAME =	USER NAME = laughlinr1	DESIGNED -	REVISED -	STATE OF ILLINOIS DEPARTMENT OF TRANSPORTATION	PLAN SHEETS			F.A.P. RTE.	SECTION	COUNTY	TOTAL SHEETS	SHEET NO.		
es:\pwork\PWIDOT\LAUGHLINRL\dms25016\653103_sht.pln.dgn		DRAWN -	REVISED -		SCALE:	SHEET NO.	OF SHEETS	STA. 755+00	TO STA. 761+00	550	(9,10); 11(RS-1,B1)	SCHUYLER	86	27
		CHECKED -	REVISED -											
		DATE -	REVISED -											
	PLOT SCALE = 48.0000' / IN.													
	PLOT DATE = Apr-06-2010 12:01:49PM													
											CONTRACT NO. 72802		ILLINOIS FED. AID PROJECT	