

*a₁ & a₂ bars in skew portion of slab shall be ordered full length & cut to fit.
Balance of bar to be used in opposite end of culvert.

MIN BAR LAPS

- #4 = 1'-4" (barrel)
- #5 = 1'-8"
- #6 = 2'-0"
- #7 = 2'-9"
- #8 = 3'-8"

Note: Bars indicated thus 11x2-#6 etc. indicates 11 lines of bars with 2 lengths per line.

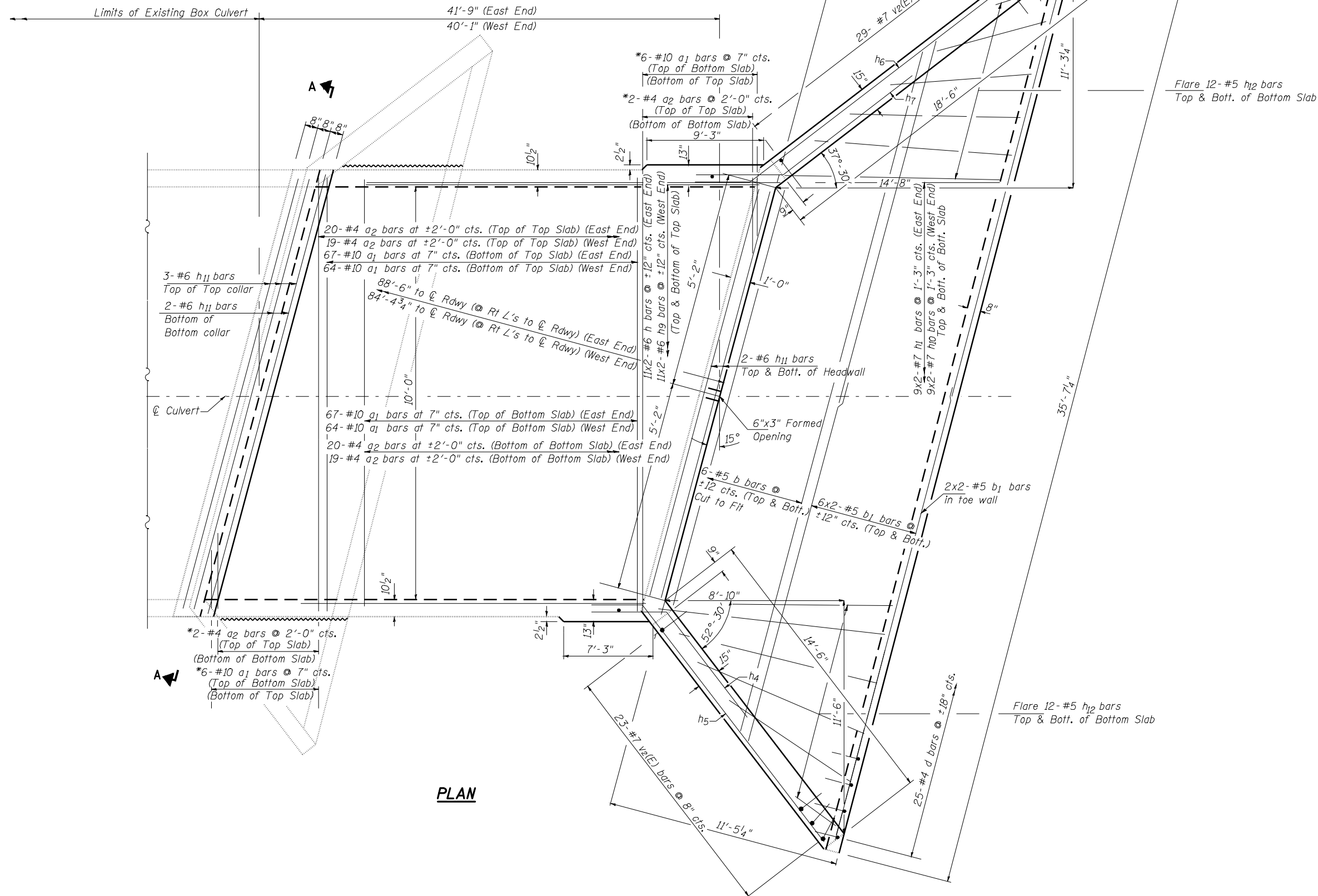

PLAN

CULVERT DETAILS
SCHUYLER COUNTY
SECTION (9,10)I; 11 (RS-1,BI)
FAP 550 (IL 99) OVER
DRAINAGE DITCH
STATION 756+84.99
STRUCTURE NO. 085-7029

FILE NAME =	USER NAME = laughlinr1	DESIGNED CTM	REVISED -	STATE OF ILLINOIS DEPARTMENT OF TRANSPORTATION	SINGLE BOX CULVERT DETAILS, SN 085-7029	F.A.S. RTE.	SECTION	COUNTY	TOTAL SHEETS	SHEET NO.
er:\pwork\pwork\PWIDOT\LAUGHLINRL\dms25016\2447-14e003.dgn		DRAWN CTM	REVISED -			IL 99	(9,10)I; 11(RS-1,BI)	SCHUYLER	86	37
PLOT SCALE = 1/8" = 1'-0"		CHECKED BAN	REVISED -			CONTRACT NO. 72802				
PLOT DATE = Apr-06-2010 12:02:24PM		DATE -	REVISED -			FED. ROAD DIST. NO. 7 ILLINOIS FED. AID PROJECT				
				SCALE:	SHEET NO. 3 OF 4 SHEETS	STA.	TO STA.			