

DATE	
BY	
FINAL SURVEY	SURVEYED
NOTE BOOK	PLOTTED
NO.	AREAS CHECKED

DATE	
BY	
ORIGINAL SURVEY	SURVEYED
NOTE BOOK	PLOTTED
NO.	AREAS CHECKED

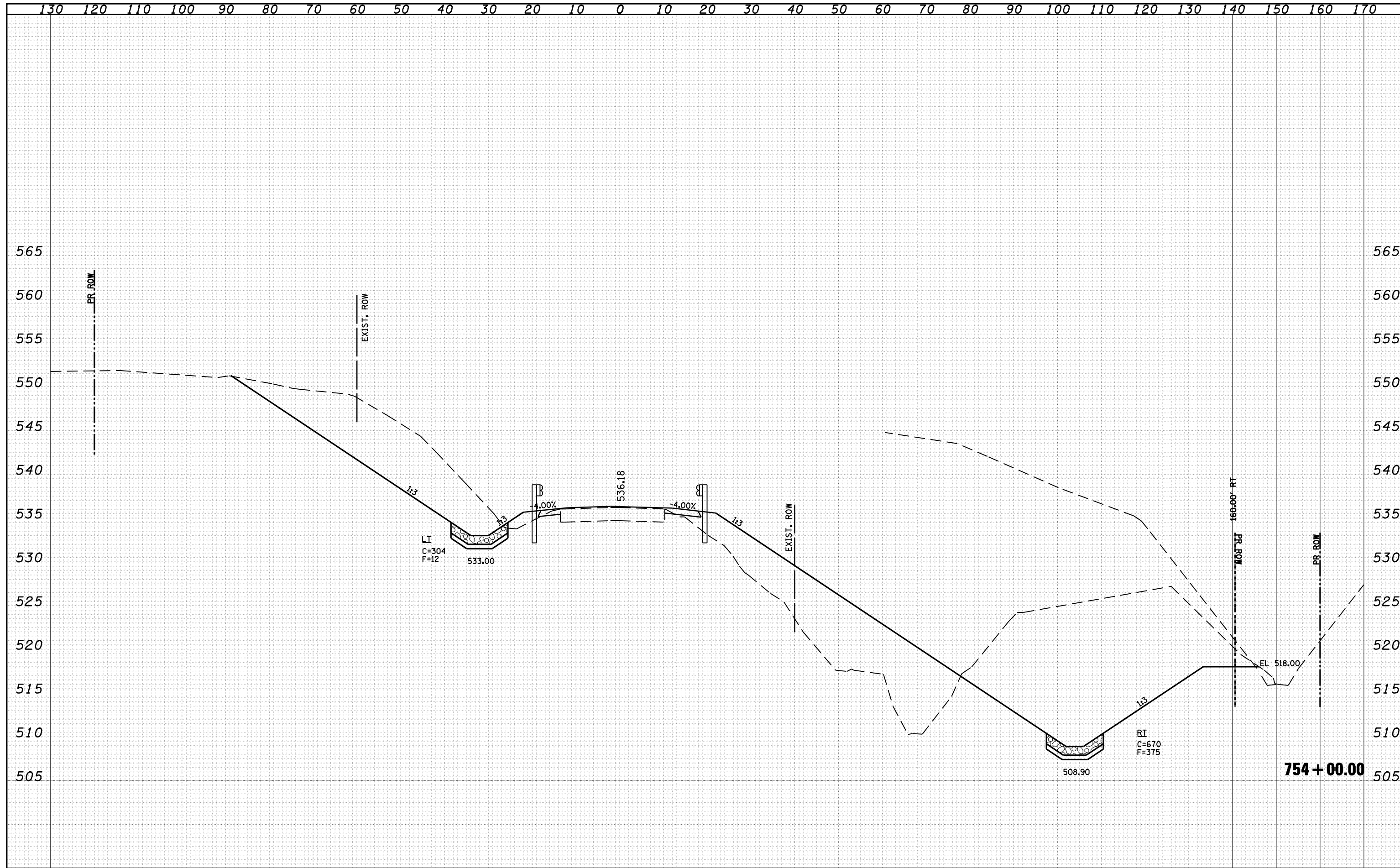

FILE NAME =	USER NAME = laughlinr1	DESIGNED -	REVISIED -	STATE OF ILLINOIS DEPARTMENT OF TRANSPORTATION	CROSS SECTIONS		F.A.P. RTE. 550	SECTION (9,10); 11(RS-1,B1)	COUNTY SCHUYLER	TOTAL SHEETS 86	SHEET NO. 66	
o:\pwork\PWIDOT\LAUGHLINRL\dms25016\0653103-ah-t-x-shite001.dgn		DRAWN -	REVISIED -		SCALE:	SHEET NO.	OF SHEETS	STA. 754+00.00	TO STA. 754+00.00	ILLINOIS FED. AID PROJECT		
PLOT SCALE = 20.0000' / IN.		CHECKED -	REVISIED -		CONTRACT NO. 72802							
PLOT DATE = Apr-06-2010 01:20:17PM		DATE -	REVISIED -									