

EXIST. CURVE 15  
 PI STA. = 688+20.12  
 $\Delta = 33^\circ 07' 01''$  (LT)  
 $D = 3^\circ 30' 01''$   
 $R = 1,636.93'$   
 $T = 486.70'$   
 $L = 946.15'$   
 $E = 70.82'$   
 $e = 6\%$   
 $T.R. = 42'$   
 $S.E. RUN = 166'$   
 $P.C. STA. = 683+33.42$   
 $P.T. STA. = 692+79.57$

CURVE NO.	e	A	B	C	D	E	TRANSITION
15	6.00%	681+81.02	682+22.62	682+64.22	683+33.42	683+88.82	Trans. In
15	6.00%	694+31.97	693+90.37	693+48.77	692+79.57	692+24.17	Trans. Out

(EXISTING)  
**FULL S.E.:** (S.E.#6 = 6.0%)  
 STA. 684+15.80 TO 692+04.06  
**S.E. TRANSITION:**  
 STA. 681+80.95 TO 684+15.80  
 STA. 692+04.06 TO 694+44.06

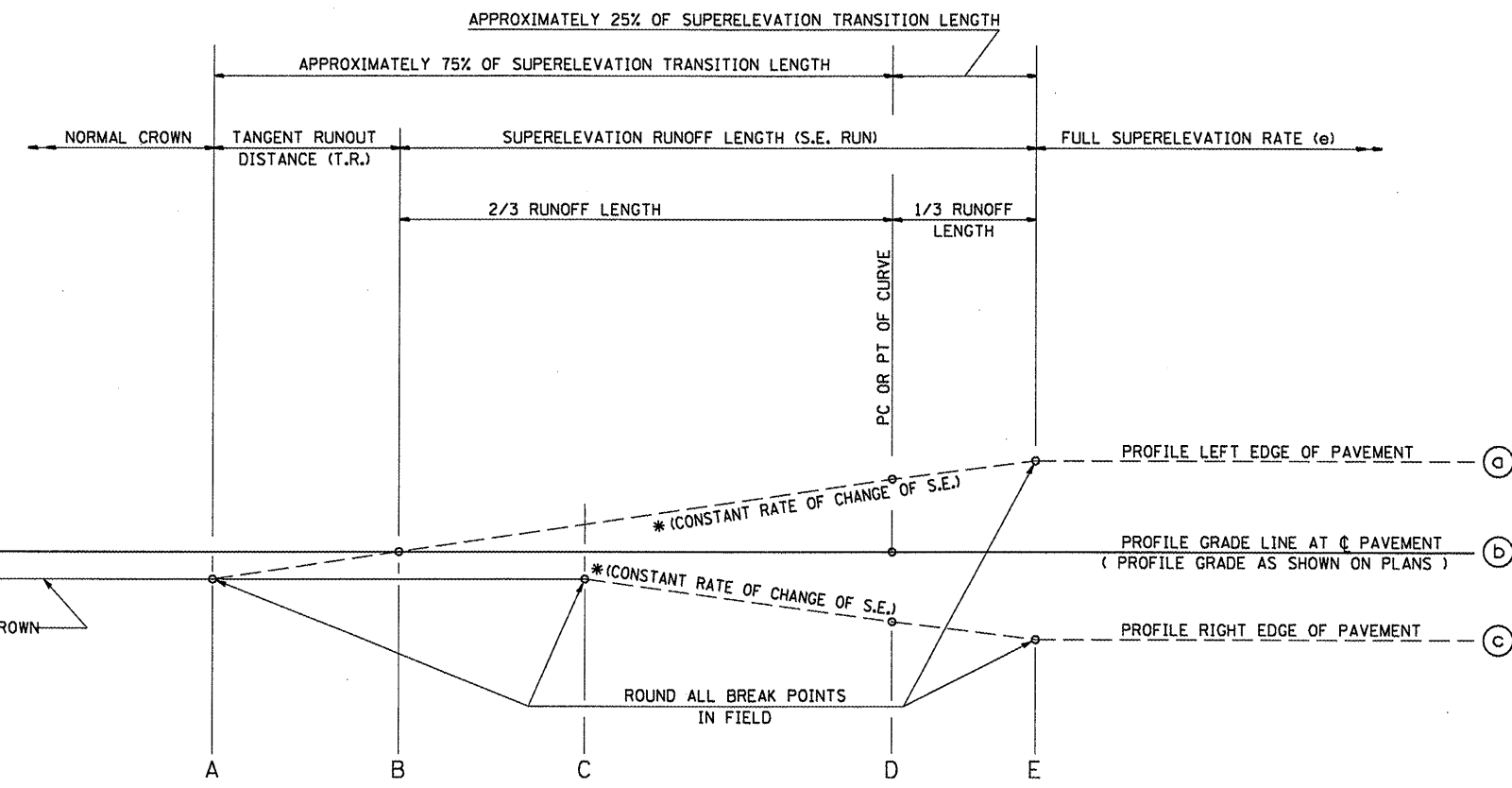
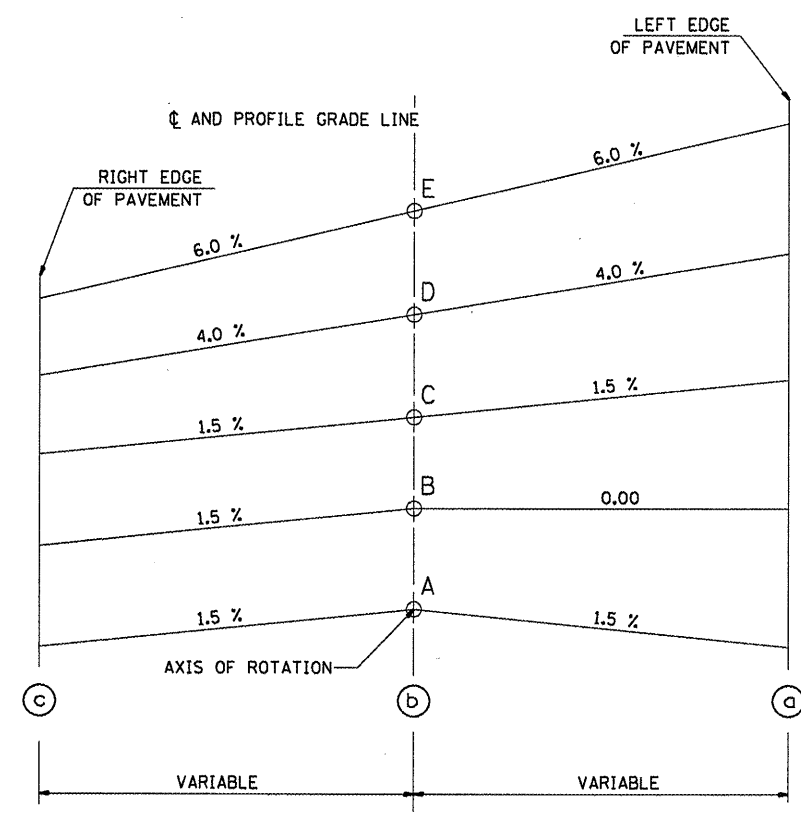
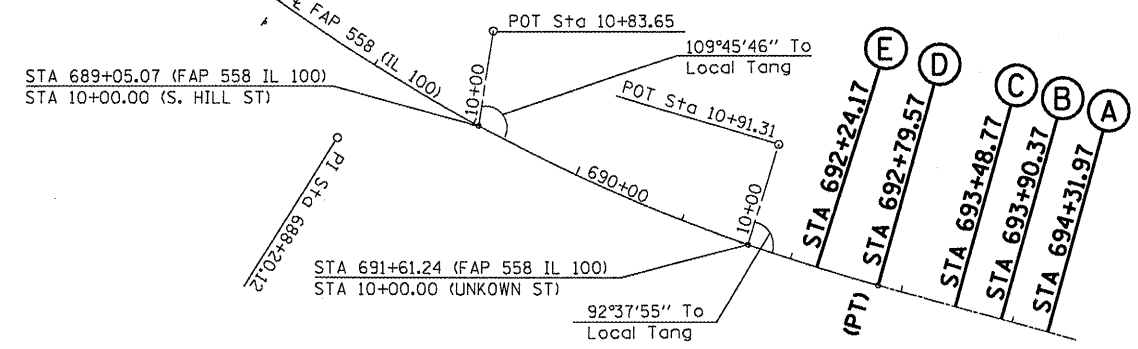

TYPICAL PROFILE - S.E. TRANSITION