

F.A.P. RTE.	SECTION	COUNTY	TOTAL SHEETS	SHEET NO.
322	11-12	CHRISTIAN	284	41
STA.	TO STA.			
FED. ROAD DIST. NO.	ILLINOIS	FED. AID PROJECT		

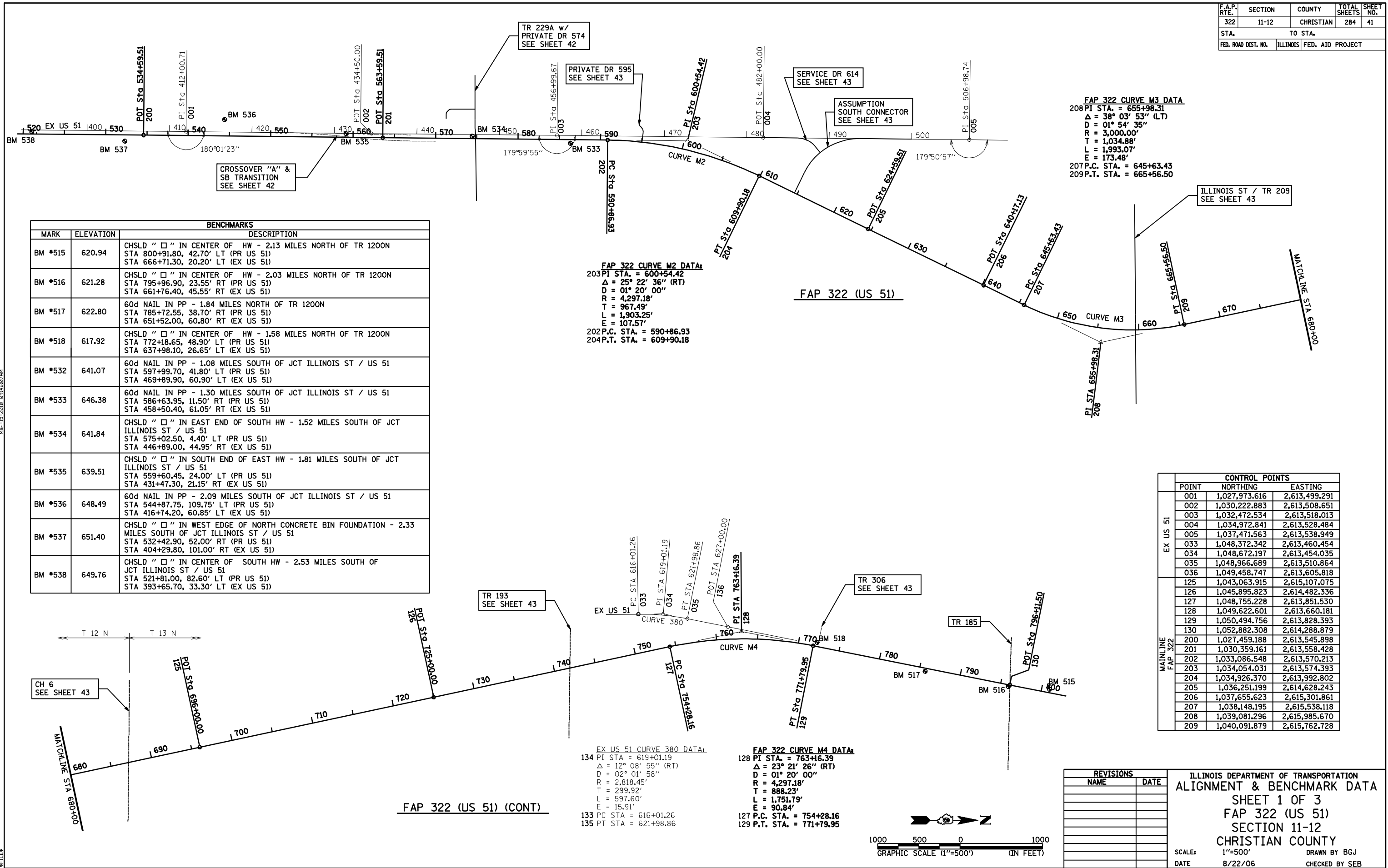

FAP 322 CURVE M3 DATA
 208 P.I. STA. = 655+98.31
 $\Delta = 38^\circ 03' 53''$ (LT)
 $D = 01^\circ 54' 35''$
 $R = 3,000.00'$
 $T = 1,034.88'$
 $L = 1,993.07'$
 $E = 173.48'$
 207 P.C. STA. = 645+63.43
 209 P.T. STA. = 665+56.50

FAP 322 CURVE M2 DATA:
 203 P.I. STA. = 600+54.42
 $\Delta = 25^\circ 22' 36''$ (RT)
 $D = 01^\circ 20' 00''$
 $R = 4,297.18'$
 $T = 967.49'$
 $L = 1,903.25'$
 $E = 107.57'$
 202 P.C. STA. = 590+86.93
 204 P.T. STA. = 609+90.18

EX US 51 CURVE 380 DATA:
 134 P.I. STA. = 619+01.19
 $\Delta = 12^\circ 08' 55''$ (RT)
 $D = 02^\circ 01' 58''$
 $R = 2,818.45'$
 $T = 299.92'$
 $L = 597.60'$
 $E = 15.91'$
 133 P.C. STA. = 616+01.26
 135 P.T. STA. = 621+98.86

FAP 322 CURVE M4 DATA:
 128 P.I. STA. = 763+16.39
 $\Delta = 23^\circ 21' 26''$ (RT)
 $D = 01^\circ 20' 00''$
 $R = 4,297.18'$
 $T = 888.23'$
 $L = 1,751.79'$
 $E = 90.84'$
 127 P.C. STA. = 754+28.16
 129 P.T. STA. = 771+79.95

CROSSOVER "A" & SB TRANSITION SEE SHEET 42

TR 229A w/ PRIVATE DR 574 SEE SHEET 42

PRIVATE DR 595 SEE SHEET 43

SERVICE DR 614 SEE SHEET 43

ASSUMPTION SOUTH CONNECTOR SEE SHEET 43

ILLINOIS ST / TR 209 SEE SHEET 43

TR 306 SEE SHEET 43

TR 193 SEE SHEET 43

CH 6 SEE SHEET 43

BENCHMARKS		
MARK	ELEVATION	DESCRIPTION
BM #515	620.94	CHSLD " " IN CENTER OF HW - 2.13 MILES NORTH OF TR 1200N STA 800+91.80, 42.70' LT (PR US 51) STA 666+71.30, 20.20' LT (EX US 51)
BM #516	621.28	CHSLD " " IN CENTER OF HW - 2.03 MILES NORTH OF TR 1200N STA 795+96.90, 23.55' RT (PR US 51) STA 661+76.40, 45.55' RT (EX US 51)
BM #517	622.80	60d NAIL IN PP - 1.84 MILES NORTH OF TR 1200N STA 785+72.55, 38.70' RT (PR US 51) STA 651+52.00, 60.80' RT (EX US 51)
BM #518	617.92	CHSLD " " IN CENTER OF HW - 1.58 MILES NORTH OF TR 1200N STA 772+18.65, 48.90' LT (PR US 51) STA 637+98.10, 26.65' LT (EX US 51)
BM #532	641.07	60d NAIL IN PP - 1.08 MILES SOUTH OF JCT ILLINOIS ST / US 51 STA 597+99.70, 41.80' LT (PR US 51) STA 469+89.90, 60.90' LT (EX US 51)
BM #533	646.38	60d NAIL IN PP - 1.30 MILES SOUTH OF JCT ILLINOIS ST / US 51 STA 586+63.95, 11.50' RT (PR US 51) STA 458+50.40, 61.05' RT (EX US 51)
BM #534	641.84	CHSLD " " IN EAST END OF SOUTH HW - 1.52 MILES SOUTH OF JCT ILLINOIS ST / US 51 STA 575+02.50, 4.40' LT (PR US 51) STA 446+89.00, 44.95' RT (EX US 51)
BM #535	639.51	CHSLD " " IN SOUTH END OF EAST HW - 1.81 MILES SOUTH OF JCT ILLINOIS ST / US 51 STA 559+60.45, 24.00' LT (PR US 51) STA 431+47.30, 21.15' RT (EX US 51)
BM #536	648.49	60d NAIL IN PP - 2.09 MILES SOUTH OF JCT ILLINOIS ST / US 51 STA 544+87.75, 109.75' LT (PR US 51) STA 416+74.20, 60.85' LT (EX US 51)
BM #537	651.40	CHSLD " " IN WEST EDGE OF NORTH CONCRETE BIN FOUNDATION - 2.33 MILES SOUTH OF JCT ILLINOIS ST / US 51 STA 532+42.90, 52.00' RT (PR US 51) STA 404+29.80, 101.00' RT (EX US 51)
BM #538	649.76	CHSLD " " IN CENTER OF SOUTH HW - 2.53 MILES SOUTH OF JCT ILLINOIS ST / US 51 STA 521+81.00, 82.60' LT (PR US 51) STA 393+65.70, 33.30' LT (EX US 51)

CONTROL POINTS		
POINT	NORTHING	EASTING
001	1,027,973.616	2,613,499.291
002	1,030,222.883	2,613,508.651
003	1,032,472.534	2,613,518.013
004	1,034,972.841	2,613,528.484
005	1,037,471.563	2,613,538.949
033	1,048,372.342	2,613,460.454
034	1,048,672.197	2,613,454.035
035	1,048,966.689	2,613,510.864
036	1,049,458.747	2,613,605.818
125	1,043,063.915	2,615,107.075
126	1,045,895.823	2,614,482.336
127	1,048,755.228	2,613,851.530
128	1,049,622.601	2,613,660.181
129	1,050,494.756	2,613,828.393
130	1,052,882.308	2,614,288.879
200	1,027,459.188	2,613,545.898
201	1,030,359.161	2,613,558.428
202	1,033,086.548	2,613,570.213
203	1,034,054.031	2,613,574.393
204	1,034,926.370	2,613,992.802
205	1,036,251.199	2,614,628.243
206	1,037,655.623	2,615,301.861
207	1,038,148.195	2,615,538.118
208	1,039,081.296	2,615,985.670
209	1,040,091.879	2,615,762.728

REVISIONS	
NAME	DATE

ILLINOIS DEPARTMENT OF TRANSPORTATION
 ALIGNMENT & BENCHMARK DATA
 SHEET 1 OF 3
 FAP 322 (US 51)
 SECTION 11-12
 CHRISTIAN COUNTY

SCALE: 1"=500'
 DATE: 8/22/06

DRAWN BY: B.G.J.
 CHECKED BY: S.E.B.

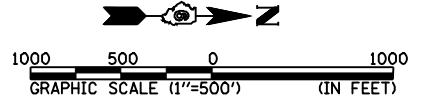

FAP 322 (US 51) (CONT)

Map-11-2010 01/14/07/04

FILE#