

F.A.P. RTE.	SECTION	COUNTY	TOTAL SHEETS	SHEET NO.
322	11-12	CHRISTIAN	284	49
STA.	TO STA.			
FED. ROAD DIST. NO.	ILLINOIS	FED. AID PROJECT		

THE STAGE CONSTRUCTION SEQUENCE IS FOR INFORMATION ONLY. THE CONTRACTOR IS RESPONSIBLE FOR PLANNING AND EXECUTING THIS PROJECT WHICH SHALL BE SUBJECT TO THE APPROVAL OF THE ENGINEER.

STAGE 2

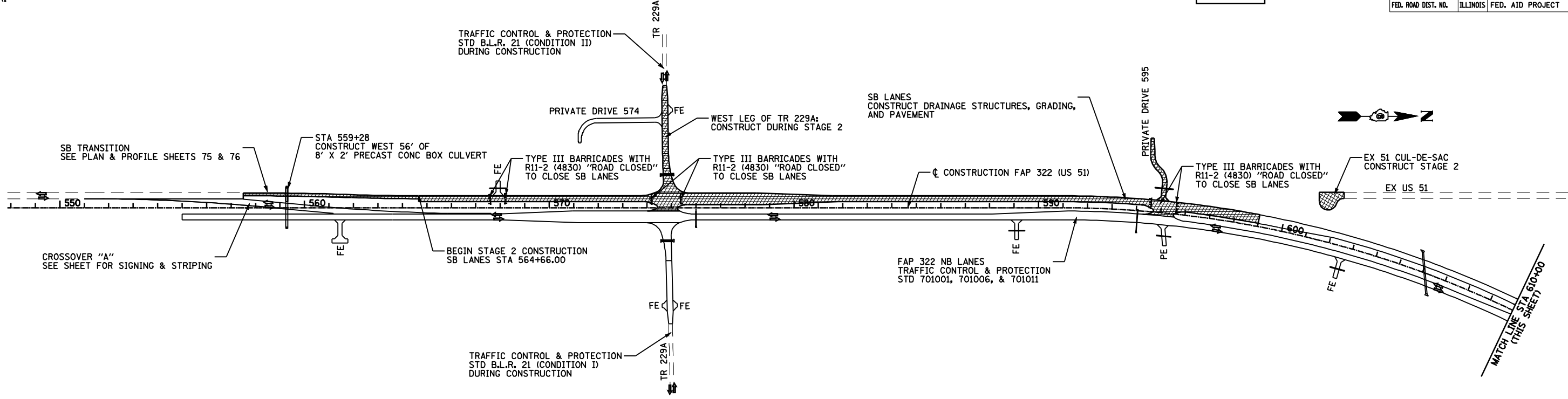

NOTE:
COMPLETION OF ASSUMPTION SOUTH CONNECTOR AND SERVICE DRIVE 614 SHALL BE THE FIRST PRIORITY OF STAGE 2.

NOTE:
AT ALL TIMES THE NEXT SIDE ROAD TO THE NORTH AND SOUTH OF A CLOSED SIDE ROAD SHALL REMAIN OPEN TO THROUGH TRAFFIC.
PROVIDE ALL WEATHER ACCESS TO ALL PROPERTIES DURING CONSTRUCTION.
THE FINAL 2" HOT-MIX ASPHALT SURFACE LIFT TO BE PLACED AFTER STAGE 2 ON THE NORTHBOUND LANES AND CROSSOVER "A".

LEGEND

- CONSTRUCTION AREA - GRADING & PAVING
- CONSTRUCTION AREA - PAVING ONLY
- DIRECTION OF TRAFFIC

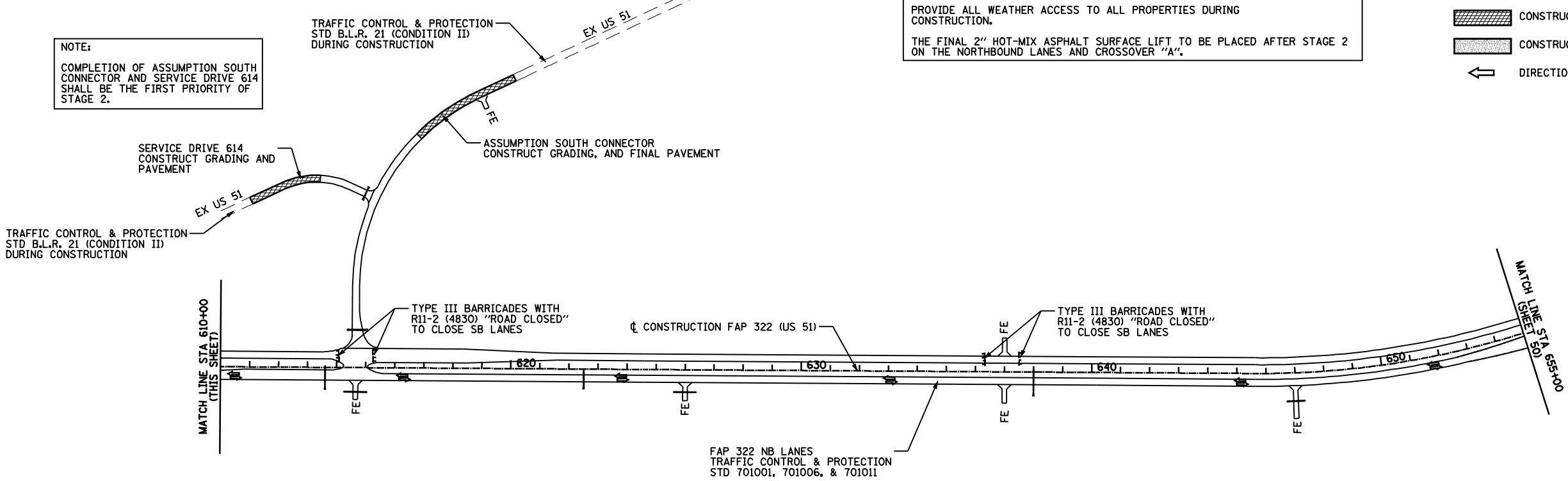

400 200 0 400
GRAPHIC SCALE (IN FEET)

REVISIONS	
NAME	DATE

ILLINOIS DEPARTMENT OF TRANSPORTATION
TRAFFIC CONTROL AND STAGING
STAGE 2 - 548+00 TO 655+00
FAP 322 (US 51)
SECTION 11-12
CHRISTIAN COUNTY

SCALE: 1"=200'
DATE: 8/22/06
DRAWN BY: SEB
CHECKED BY: TLD

Mo-15-2018 @144631RM

SFILE4