

F.A.P. RTE.	SECTION	COUNTY	TOTAL SHEETS	SHEET NO.
322	11-12	CHRISTIAN	284	50
STA.	TO STA.			
FED. ROAD DIST. NO.	ILLINOIS	FED. AID PROJECT		

STAGE 2

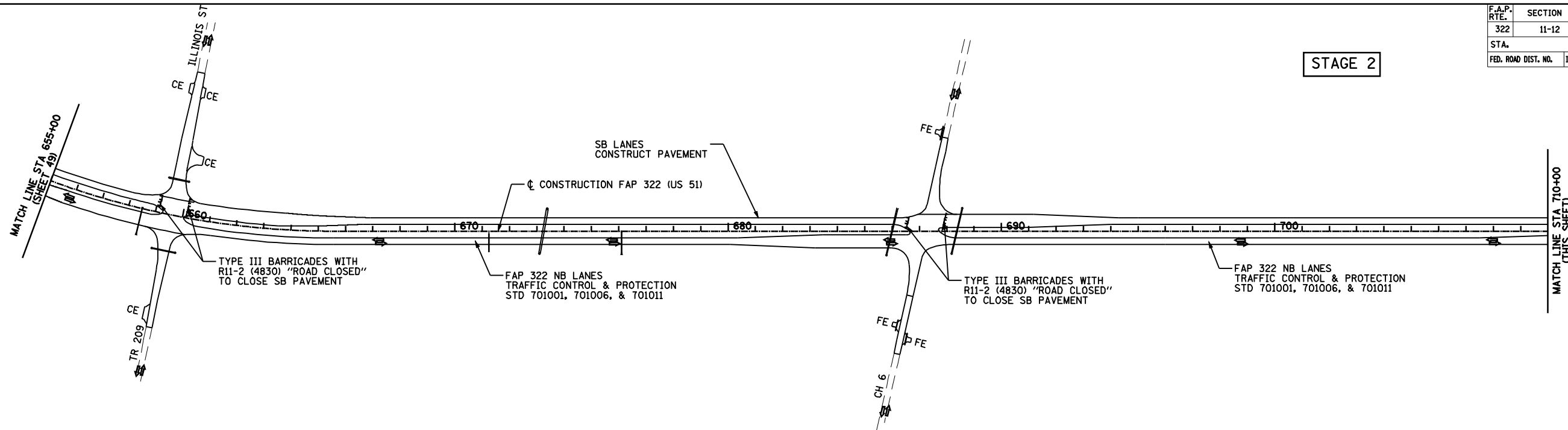

THE STAGE CONSTRUCTION SEQUENCE IS FOR INFORMATION ONLY. THE CONTRACTOR IS RESPONSIBLE FOR PLANNING AND EXECUTING THIS PROJECT WHICH SHALL BE SUBJECT TO THE APPROVAL OF THE ENGINEER.

NOTE:
 AT ALL TIMES THE NEXT SIDE ROAD TO THE NORTH AND SOUTH OF A CLOSED SIDE ROAD SHALL REMAIN OPEN TO THROUGH TRAFFIC.
 PROVIDE ALL WEATHER ACCESS TO ALL PROPERTIES DURING CONSTRUCTION.
 THE FINAL 2" HOT-MIX ASPHALT SURFACE LIFT TO BE PLACED AFTER STAGE 2 ON THE NORTHBOUND LANES AND CROSSOVER "A".

LEGEND

- CONSTRUCTION AREA - GRADING & PAVING
- CONSTRUCTION AREA - PAVING ONLY
- DIRECTION OF TRAFFIC

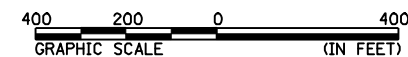
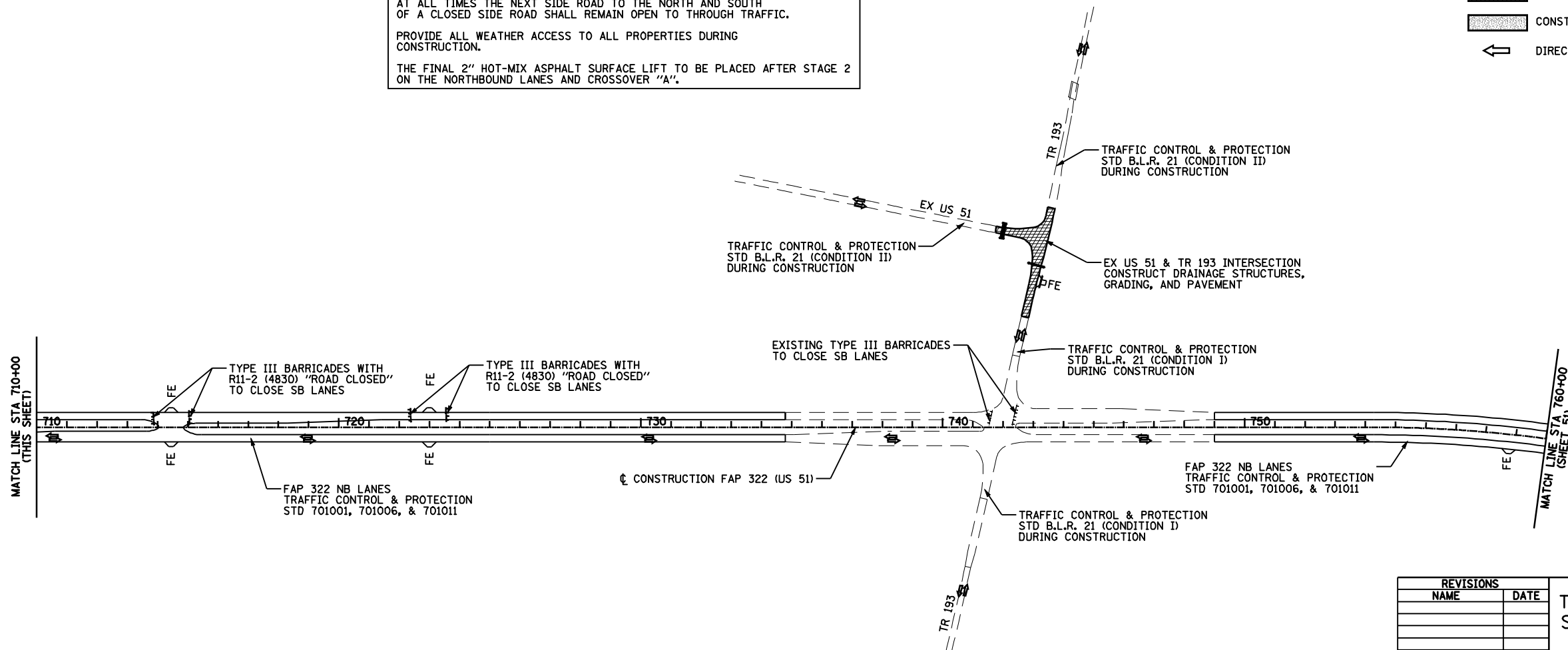

REVISIONS	
NAME	DATE

ILLINOIS DEPARTMENT OF TRANSPORTATION
 TRAFFIC CONTROL AND STAGING
 STAGE 2 - 655+00 TO 760+00
 FAP 322 (US 51)
 SECTION 11-12
 CHRISTIAN COUNTY
 SCALE: 1"=200'
 DATE: 8/22/06
 DRAWN BY SEB
 CHECKED BY TLD

Mo-115-2018 01/14/2018

\$FILE