

F.A.P. RTE.	SECTION	COUNTY	TOTAL SHEETS	SHEET NO.
322	11-12	CHRISTIAN	284	63
STA.	TO STA.			
FED. ROAD DIST. NO.	ILLINOIS FED. AID PROJECT			

PAUL H. YOUNG JR  
 PARCEL NO 6085157

DATE	BY

DATE	BY

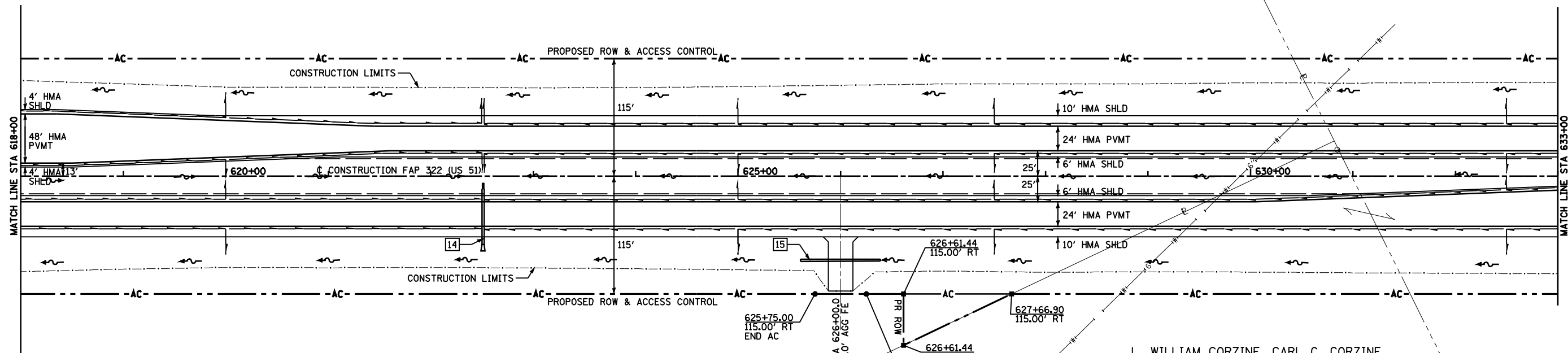

14 - STA 622+51.0 RT  
 INLET BOX, STD 542506, 1 EACH  
 PIPE CULVERT, CLASS A, TYPE 1, 24" Ø X 54'  
 USFL = 636.99 DSFL = 636.83  
 CONCRETE FLARED END SECTION 24", STD 542301, 1 EACH  
 TRENCH BACKFILL, 1.6 CU YD

15 - STA 626+00.0 82.0' RT  
 PIPE CULVERT, CLASS D, TY 1, 24" Ø, 78'  
 USFL = 637.10 (626+38.7, 82.0' RT)  
 DSFL = 637.03 (625+60.7, 82.0' RT)

L. WILLIAM CORZINE, CARL C. CORZINE,  
 AND ROBERT D. CORZINE AS TRUSTEES  
 PARCEL NO 6085158

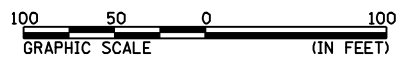

NW 1/4 SEC 36, T13N, R1E, 3RD PM

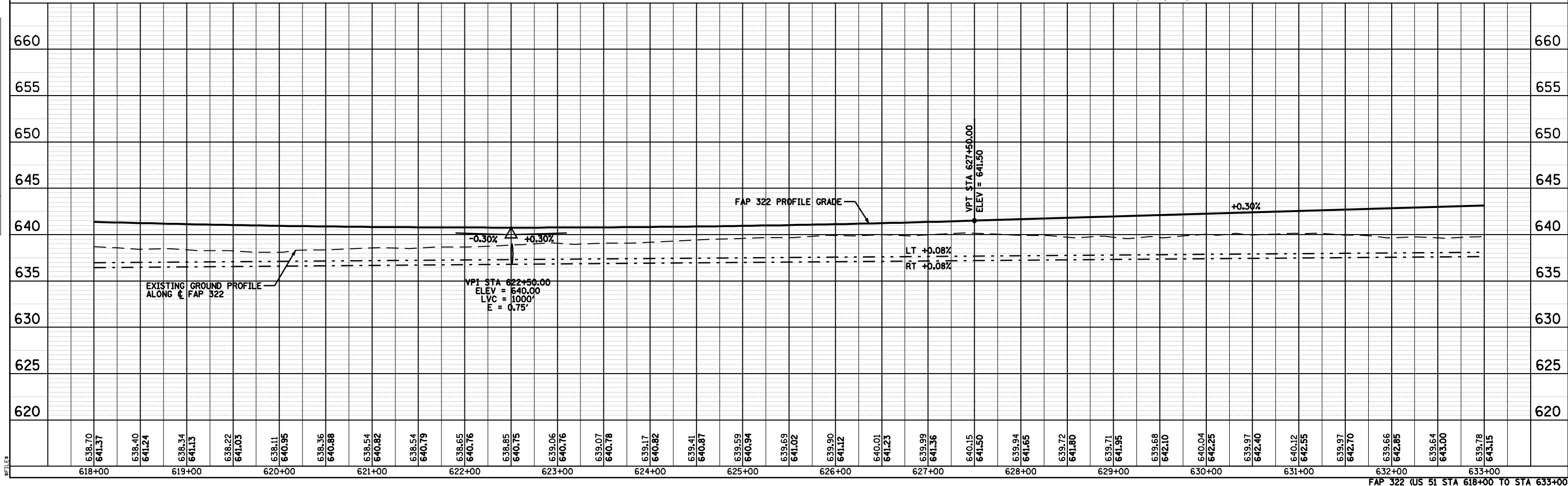

FAP 322 (US 51 STA 618+00 TO STA 633+00)

FILE#