

POINT	FAP 322 (US 51)		COUNTY HIGHWAY 6		ELEVATION
	STATION	OFFSET	STATION	OFFSET	
A1	686+30.25	49.00' LT	49+71.49	96.65' RT	642.06
A2	686+44.33	49.57' LT	49+67.85	83.03' RT	642.09
A3	686+58.31	51.27' LT	49+63.13	69.76' RT	642.10
A4	686+72.12	54.08' LT	49+57.35	56.90' RT	642.05
A5	686+85.66	58.00' LT	49+50.56	44.56' RT	641.97
A6	686+98.83	63.00' LT	49+42.80	32.80' RT	641.85
A7	687+07.14	67.51' LT	49+36.57	25.68' RT	641.76
A8	687+14.45	73.51' LT	49+29.12	19.86' RT	641.67
A9	687+20.51	80.78' LT	49+20.70	15.55' RT	641.55
A10	687+25.08	89.05' LT	49+11.63	12.89' RT	641.42
A11	687+28.02	98.04' LT	49+02.21	12.00' RT	641.25

POINT	FAP 322 (US 51)		COUNTY HIGHWAY 6		ELEVATION
	STATION	OFFSET	STATION	OFFSET	
E1	685+98.95	25.00' LT	50+01.77	121.92' RT	641.97
E2	686+63.41	1.44' LT	50+10.62	53.86' RT	641.69
E3	686+59.02	12.63' RT	50+25.32	55.06' RT	641.90
E4	686+51.35	13.00' LT	50+27.36	62.46' RT	641.88
E5	687+85.23	13.00' LT	49+72.64	62.46' LT	641.27
E6	687+77.56	12.63' LT	49+74.68	55.06' LT	642.24
E7	687+73.17	1.45' RT	49+89.38	53.86' LT	642.00
E8	688+37.63	25.00' RT	49+98.23	121.92' LT	642.66
E9	687+23.91	25.00' LT	49+74.38	CL	642.33
E10	687+12.68	25.00' RT	50+25.62	CL	642.30

POINT	FAP 322 (US 51)		COUNTY HIGHWAY 6		ELEVATION
	STATION	OFFSET	STATION	OFFSET	
B1	687+83.00	233.27' LT	47+58.22	12.00' LT	639.04
B2	687+78.71	211.33' LT	47+80.57	12.63' LT	639.22
B3	687+75.65	189.18' LT	48+02.85	14.50' LT	639.45
B4	687+73.84	166.90' LT	48+24.99	17.61' LT	639.72
B5	687+73.27	144.55' LT	48+46.92	21.96' LT	640.04
B6	687+73.96	122.20' LT	48+68.57	27.52' LT	640.47
B7	687+78.03	103.04' LT	48+86.37	35.70' LT	640.93
B8	687+87.63	85.97' LT	49+00.92	48.81' LT	641.46
B9	688+01.88	72.53' LT	49+10.91	65.65' LT	641.95
B10	688+19.48	63.95' LT	49+15.42	84.71' LT	642.31
B11	688+38.84	61.00' LT	49+14.06	104.25' LT	642.42

F.A.P. RTE.	SECTION	COUNTY	TOTAL SHEETS	SHEET NO.
322	11-12	CHRISTIAN	284	106
STA.		TO STA.		
FED. ROAD DIST. NO.		ILLINOIS FED. AID PROJECT		

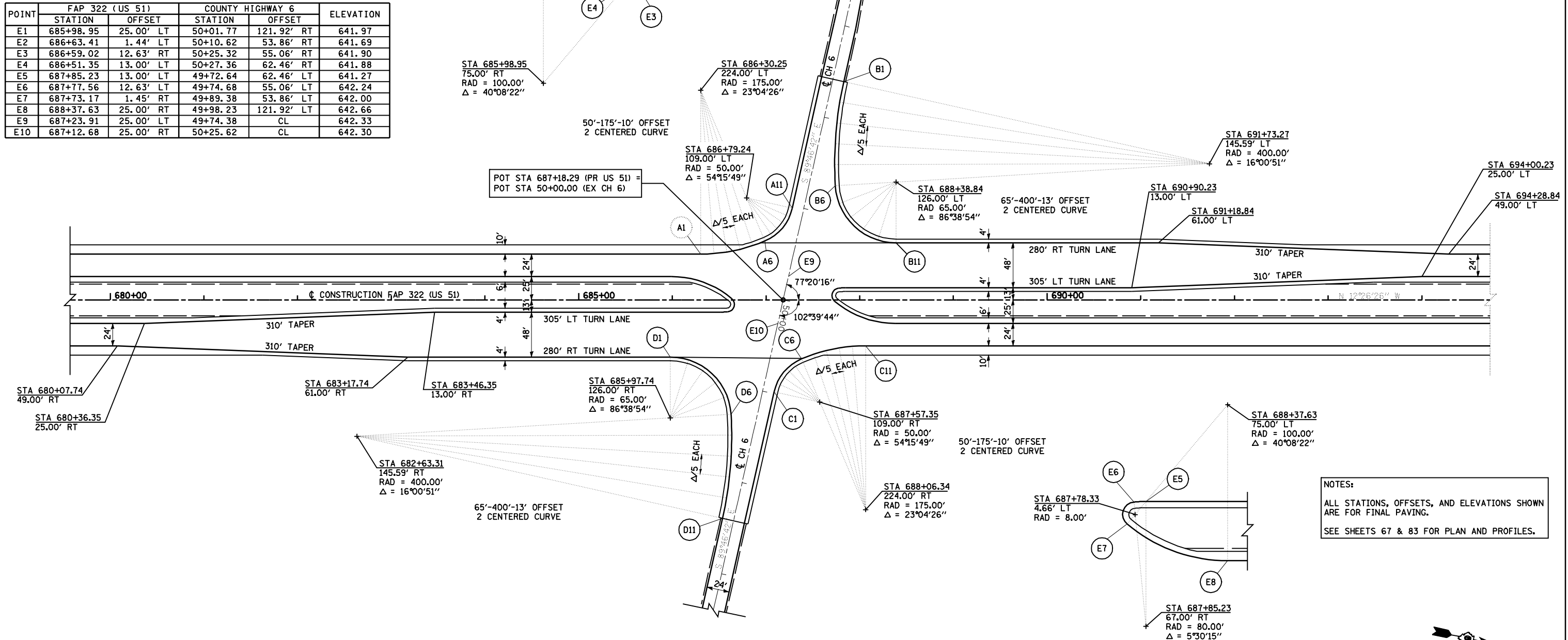

POINT	FAP 322 (US 51)		COUNTY HIGHWAY 6		ELEVATION
	STATION	OFFSET	STATION	OFFSET	
D1	685+97.74	61.00' RT	50+85.94	104.25' RT	641.73
D2	686+17.10	63.95' RT	50+84.58	84.71' RT	641.72
D3	686+34.71	72.53' RT	50+89.09	65.65' RT	641.61
D4	686+48.95	85.97' RT	50+99.08	48.81' RT	641.28
D5	686+58.55	103.04' RT	51+13.63	35.70' RT	640.87
D6	686+62.63	122.20' RT	51+31.43	27.52' RT	640.44
D7	686+63.31	144.55' RT	51+53.08	21.96' RT	639.97
D8	686+62.75	166.90' RT	51+75.01	17.61' RT	639.53
D9	686+60.93	189.18' RT	51+97.15	14.50' RT	639.13
D10	686+57.87	211.33' RT	52+19.43	12.63' RT	638.72
D11	686+53.58	233.27' RT	52+41.78	12.00' RT	638.28

POINT	FAP 322 (US 51)		COUNTY HIGHWAY 6		ELEVATION
	STATION	OFFSET	STATION	OFFSET	
C1	687+08.56	98.04' RT	50+97.79	12.00' LT	641.16
C2	687+11.50	89.05' RT	50+88.37	12.89' LT	641.33
C3	687+16.08	80.78' RT	50+79.30	15.55' LT	641.52
C4	687+22.13	73.51' RT	50+70.88	19.86' LT	641.70
C5	687+29.44	67.51' RT	50+63.43	25.68' LT	641.85
C6	687+37.75	63.00' RT	50+57.20	32.80' LT	641.99
C7	687+50.93	58.00' RT	50+49.44	44.56' LT	642.17
C8	687+64.46	54.08' RT	50+42.65	56.90' LT	642.32
C9	687+78.27	51.27' RT	50+36.87	69.76' LT	642.44
C10	687+92.26	49.57' RT	50+32.15	83.03' LT	642.52
C11	688+06.34	49.00' RT	50+28.51	96.65' LT	642.57

NOTES:
 ALL STATIONS, OFFSETS, AND ELEVATIONS SHOWN ARE FOR FINAL PAVING.
 SEE SHEETS 67 & 83 FOR PLAN AND PROFILES.

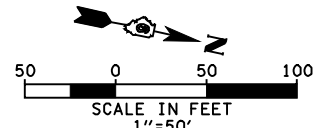

REVISIONS	
NAME	DATE

ILLINOIS DEPARTMENT OF TRANSPORTATION
 GEOMETRIC DETAILS
 COUNTY HIGHWAY 6
 FAP 322 (US 51)
 SECTION 11-12
 CHRISTIAN COUNTY
 SCALE: 1"=50'
 DATE: 8/22/06
 DRAWN BY: B.G.J.
 CHECKED BY: T.L.D.