

| | | | | |
|---------------------|----------|------------------|--------------|-----------|
| F.A.P. RTE. | SECTION | COUNTY | TOTAL SHEETS | SHEET NO. |
| 322 | 11-12 | CHRISTIAN | 284 | 151 |
| STA. | | TO STA. | | |
| FED. ROAD DIST. NO. | ILLINOIS | FED. AID PROJECT | | |

NE 1/4 SEC 14, T12N, R1E, 3RD PM

SE 1/4 SEC 11, T12N, R1E, 3RD PM

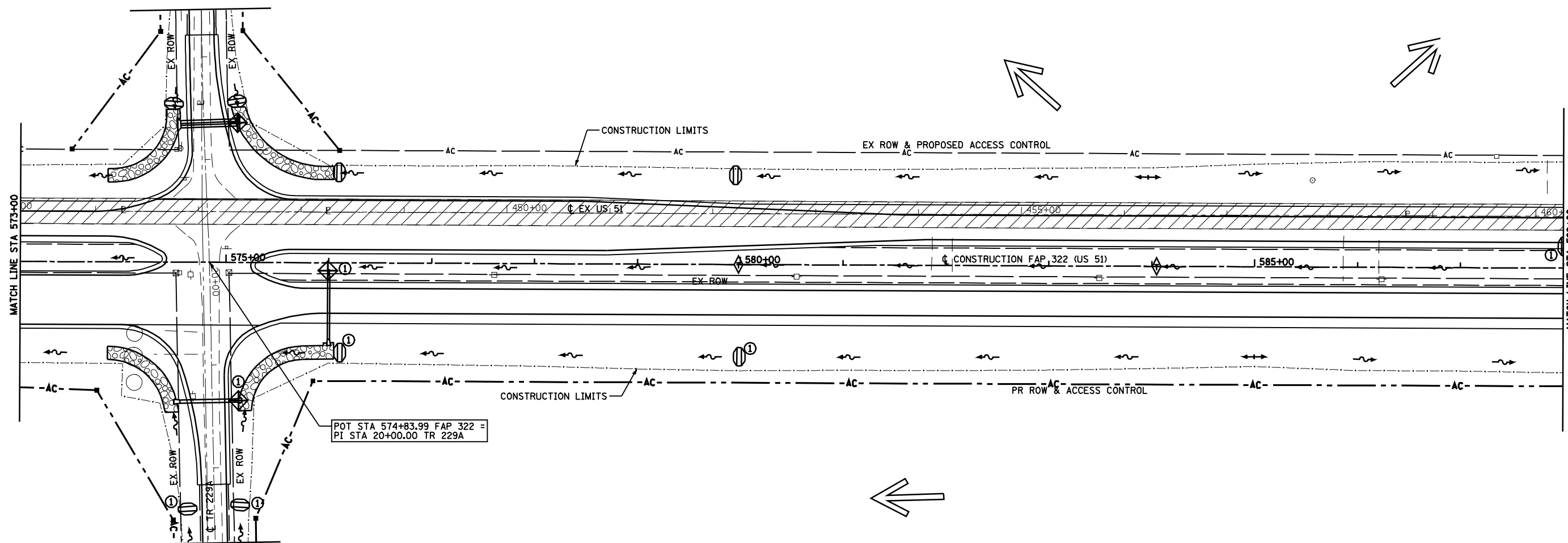

Mo-15-2018 1:27:43PM

MATCH LINE STA 573+00

MATCH LINE STA 588+00

NW 1/4 SEC 13, T12N, R1E, 3RD PM

SW 1/4 SEC 12, T12N, R1E, 3RD PM

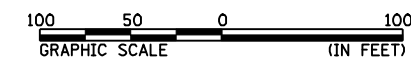

| REVISIONS | |
|-----------|------|
| NAME | DATE |
| | |
| | |
| | |
| | |
| | |
| | |
| | |
| | |
| | |
| | |

ILLINOIS DEPARTMENT OF TRANSPORTATION
 STORM WATER POLLUTION
 PREVENTION PLAN
 FAP 322 (US 51)
 SECTION 11-12
 CHRISTIAN COUNTY

SCALE: 1"=50' DRAWN BY: BGJ
 DATE: 8/22/06 CHECKED BY: SEB

FAP 322 (US 51) STA 573+00 TO STA 588+00