

F.A.P. RTE.	SECTION	COUNTY	TOTAL SHEETS	SHEET NO.
322	11-12	CHRISTIAN	284	167
STA.	TO STA.			
FED. ROAD DIST. NO.	ILLINOIS	FED. AID PROJECT		

NE 1/4 SEC 11, T12N, R1E, 3RD PM

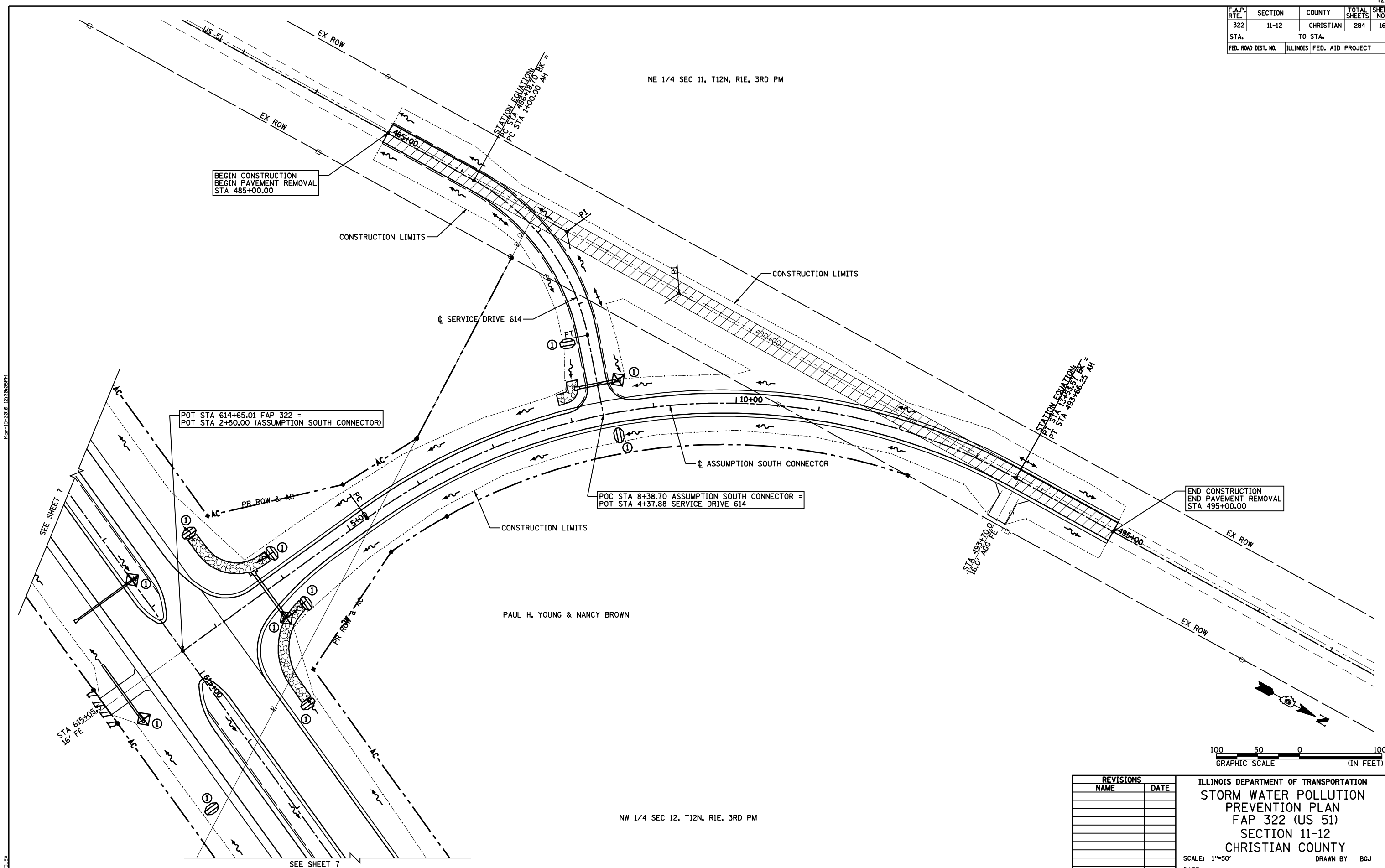

BEGIN CONSTRUCTION
 BEGIN PAVEMENT REMOVAL
 STA 485+00.00

POT STA 614+65.01 FAP 322 =
 POT STA 2+50.00 (ASSUMPTION SOUTH CONNECTOR)

POC STA 8+38.70 ASSUMPTION SOUTH CONNECTOR =
 POT STA 4+37.88 SERVICE DRIVE 614

END CONSTRUCTION
 END PAVEMENT REMOVAL
 STA 495+00.00

PAUL H. YOUNG & NANCY BROWN

NW 1/4 SEC 12, T12N, R1E, 3RD PM

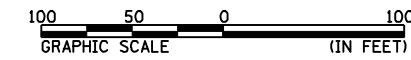

REVISIONS	
NAME	DATE

ILLINOIS DEPARTMENT OF TRANSPORTATION
 STORM WATER POLLUTION
 PREVENTION PLAN
 FAP 322 (US 51)
 SECTION 11-12
 CHRISTIAN COUNTY

SCALE: 1"=50' DRAWN BY B.G.J.
 DATE CHECKED BY

ASSUMPTION SOUTH CONNECTOR & SERVICE DRIVE 614

Mo-15-2018 12:30:00PM

\$FILE\$