

F.A.P. RTE.	SECTION	COUNTY	TOTAL SHEETS	SHEET NO.
322	11-12	CHRISTIAN	284	175
STA.	TO STA.			
FED. ROAD DIST. NO.	ILLINOIS	FED. AID PROJECT		

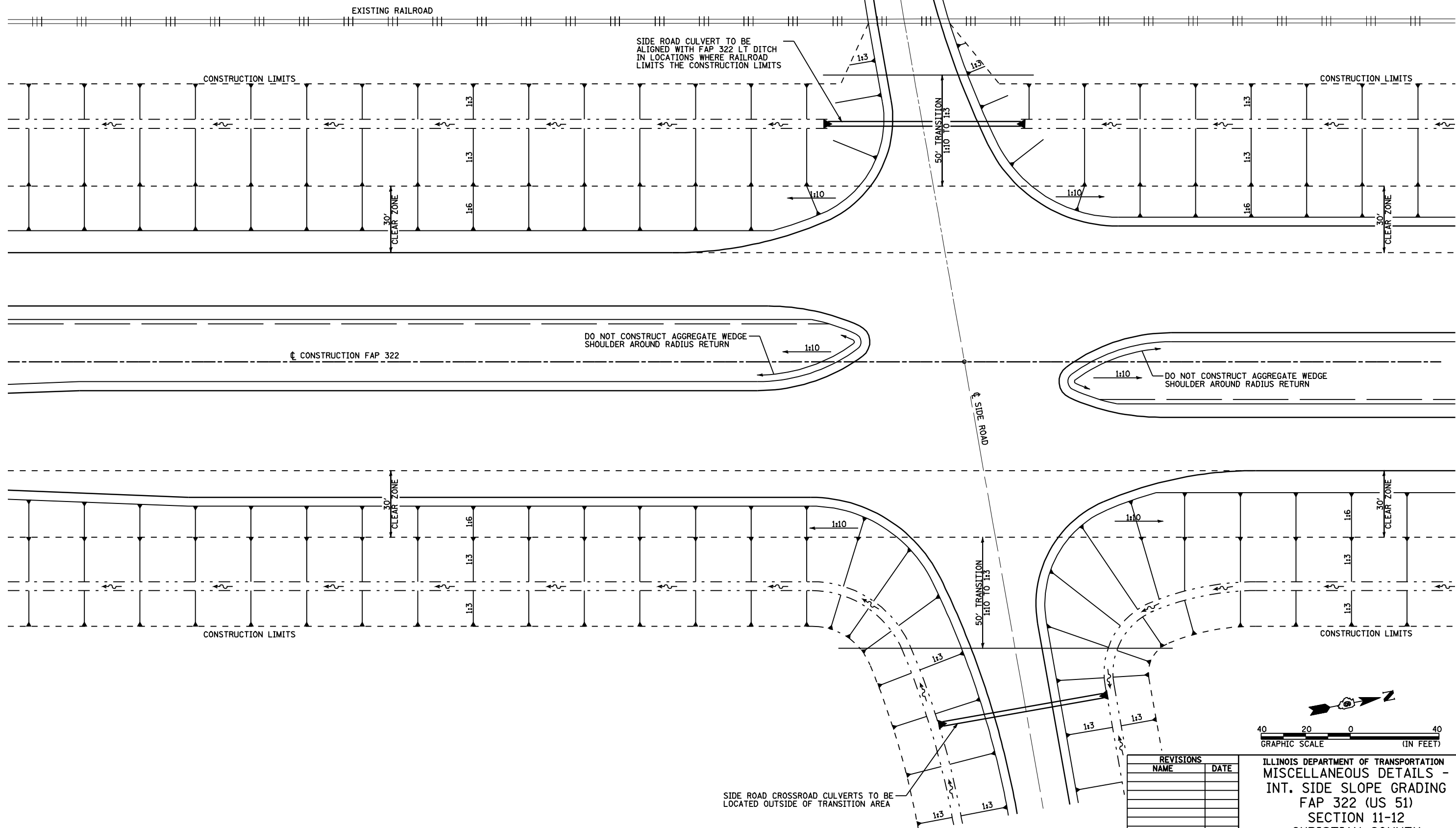

Mo-15-2018 12:30:27PM

\$FILE\$

REVISIONS	
NAME	DATE

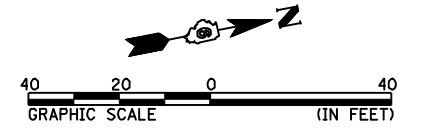

ILLINOIS DEPARTMENT OF TRANSPORTATION
 MISCELLANEOUS DETAILS -
 INT. SIDE SLOPE GRADING
 FAP 322 (US 51)
 SECTION 11-12
 CHRISTIAN COUNTY

SCALE: 1"=20'
 DATE: 8/22/06

DRAWN BY: BDJ
 CHECKED BY: SEB