

F.A.P. RTE.	SECTION	COUNTY	TOTAL SHEETS	SHEET NO.
320	(24Z)RS-4, N; 116RS-5	LOGAN	32	1
FED. ROAD DIST. NO.	ILLINOIS	CONTRACT NO. 72998		

INDEX OF SHEETS

1	TITLE SHEET
2	GENERAL NOTES & MIXTURE REQUIREMENTS
3	SUMMARY OF QUANTITIES
4 - 7	TYPICAL ROADWAY SECTIONS
8 - 9	SCHEDULE OF QUANTITIES
10 - 16	PAVEMENT REMOVAL PLAN
17	CONTROL POINT CROSS TIES
18 - 20	IL. 121 & IL. 10 INTERSECTION DETAILS
21 - 27	STRIPING & PAVEMENT MARKER PLAN
28 - 32	IL. 10 CROSS SECTIONS

STATE OF ILLINOIS
DEPARTMENT OF TRANSPORTATION
DIVISION OF HIGHWAYS
PROPOSED
HIGHWAY PLANS

FAP ROUTE 320 - (IL. 121) & FAP ROUTE 717 (IL. 10)
SECTION (24Z)RS-4, N; 116RS-5

D-96-530-05

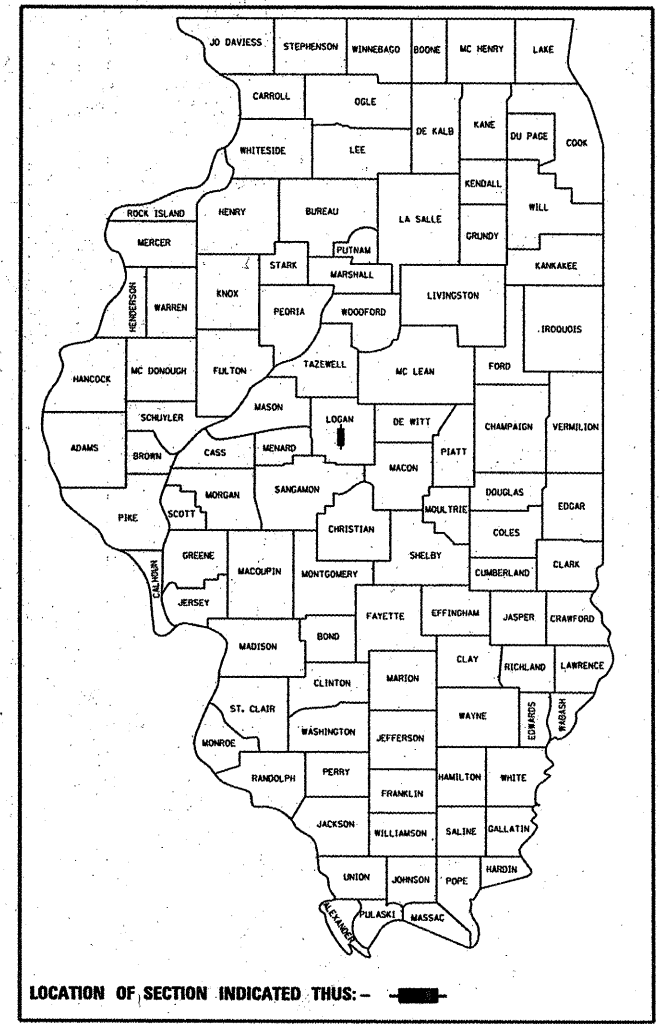

LIST OF ILLINOIS DOT HIGHWAY STANDARDS

000001-05	606201-02
001006	701201-03
280001-05	701306-02
353001-04	701311-03
482011-03	701326-03
542301-02	701501-05
542501-02	701601-06
602301-02	701602-04
602306-02	701606-06
602401-02	701701-06
604001-03	701801-04
604006-04	701901-01
604106-01	780001-02
606001-04	781001-03

LOGAN COUNTY
C-96-502-10

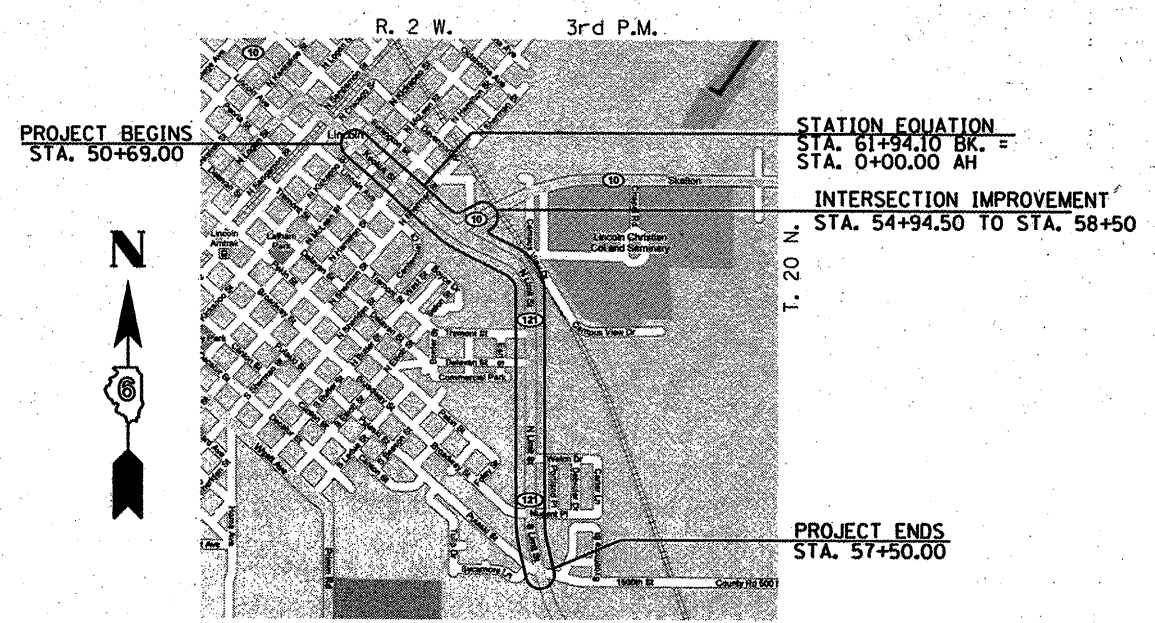

LOCATION MAP

LENGTH OF SECTION - 6875.10 FEET = 1.302 MILES

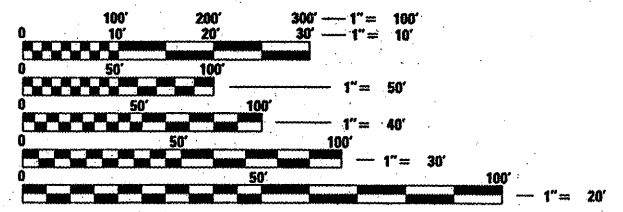

FULL SIZE PLANS HAVE BEEN PREPARED USING STANDARD ENGINEERING SCALES. REDUCED SIZED PLANS WILL NOT CONFORM TO STANDARD SCALES. IN MAKING MEASUREMENTS ON REDUCED PLANS, THE ABOVE SCALES MAY BE USED.

J.U.L.I.E.
 JOINT UTILITY LOCATION INFORMATION FOR EXCAVATION
 1-800-892-0123
 OR 811

PROJECT ENGINEER: JOHN NEGANGARD 217-782-6990
SQUAD LEADER: VICTOR YOUNG 217-557-7897

CONTRACT NO. 72998

Allen Henderson & Associates, Inc.
 Civil and Structural Engineers Springfield, IL
 62703 Phone: (217)544-8033 IL. Design Firm
 No. 184-001907

Christopher T. Koblus 11/30/10
 EXPIRATION: 11/30/2011

ADT = 5,628 (2003)
% SU = 8.0 (2003)
% MU = 5.0 (2003)
MUNICIPALITY: LINCOLN
FUNCTIONAL CLASSIFICATION: OTHER PRINCIPAL ARTERIAL

STATE OF ILLINOIS
 DEPARTMENT OF TRANSPORTATION
 DIVISION OF HIGHWAYS

SUBMITTED March 17 2010
Roger Zank
 DEPUTY DIRECTOR OF HIGHWAYS, REGION ENGINEER

May 7 2010
Scott E. Stitt, P.E.
 acting ENGINEER OF DESIGN AND ENVIRONMENT

May 7 2010
Christine M. Reeder
 DIRECTOR OF HIGHWAYS, CHIEF ENGINEER

PRINTED BY THE AUTHORITY
OF THE STATE OF ILLINOIS