

DATE	
BY	
PLAN	REVIEWED
	PLOTTED
	ALIGNED
	CHECKED
	DESIGNED
	NO. _____
	CADD FILE NAME

DATE	
BY	
PROFILE	REVIEWED
	PLOTTED
	GRADES CHECKED
	STRUCTURE NOTATIONS OK'D
	NO. _____

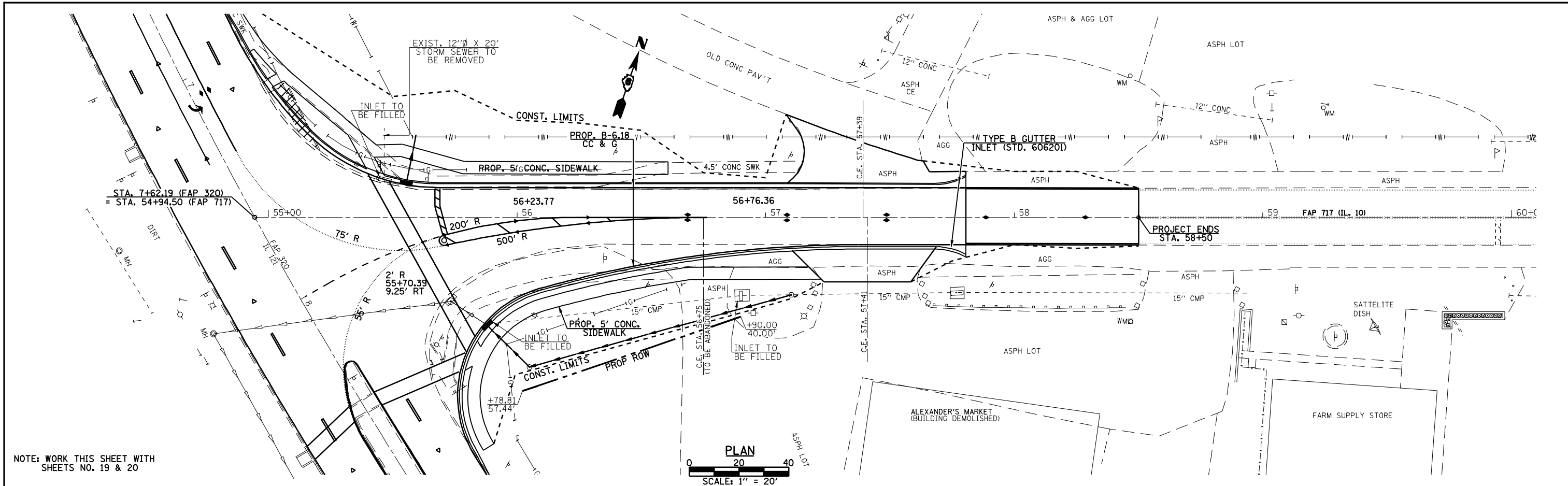

NOTE: WORK THIS SHEET WITH SHEETS NO. 19 & 20

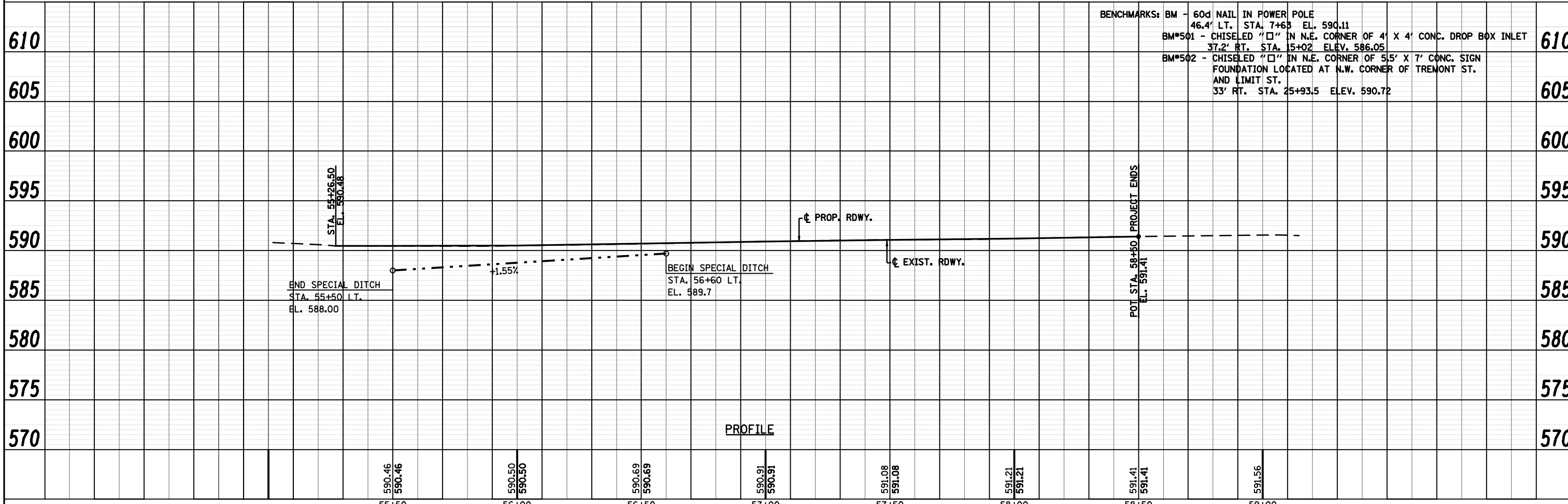

BENCHMARKS:	BM - 60d NAIL IN POWER POLE 46.4' LT. STA. 7+63 EL. 590.11	610
	BM#501 - CHISELED "□" IN N.E. CORNER OF 4' X 4' CONC. DROP BOX INLET 37.2' RT. STA. 15+02 ELEV. 586.05	610
	BM#502 - CHISELED "□" IN N.E. CORNER OF 5.5' X 7' CONC. SIGN FOUNDATION LOCATED AT N.W. CORNER OF TREMONT ST. AND LIMIT ST. 33' RT. STA. 25+93.5 ELEV. 590.72	605

55+50	56+00	56+50	57+00	57+50	58+00	58+50	59+00
590.46 590.46	590.50 590.50	590.69 590.69	590.91 590.91	591.08 591.08	591.21 591.21	591.41 591.41	591.56

USER NAME = laughlir1	DESIGNED -	REVISED -
PLOT SCALE = 40.0000' / IN.	CHECKED -	REVISED -
PLOT DATE = Mar-18-2010 02:17:03PM	DRAWN -	REVISED -
	CHECKED -	REVISED -

Allen Henderson & Associates, Inc.
Civil and Structural Engineers Springfield, IL
62703 Phone: (217)544-8033 IL Design Firm
No. 184-001907

PLAN & PROFILE	
SCALE: 1" = 20'	SHEET NO. 18 OF 32 SHEETS
STA. 55+26.50 TO STA. 58+50.00	

F.A.P. RTE. 717	SECTION (242)RS-4, N 116-RS-5	COUNTY LOGAN	TOTAL SHEETS 32	SHEET NO. 18
CONTRACT NO. 72998				
FED. ROAD DIST. NO. ILLINOIS FED. AID PROJECT				

c:\pwwork\pwwork\LAUGHLIN\LD0181122\d672998-sht-plnprf.dwg