

- PREFORMED PLASTIC PAVEMENT MARKING LEGEND**
- ① THERMOPLASTIC PAVEMENT MARKING, - LINE 5" (SOLID WHITE)
  - ② THERMOPLASTIC PAVEMENT MARKING, - LINE 5" (SOLID YELLOW)
  - ③ PREFORMED PLASTIC PAVEMENT MARKING, - TYPE B INLAID LINE 5" (10' DASH, 30' SKIP, WHITE)
  - ④ PREFORMED PLASTIC PAVEMENT MARKING, - TYPE B INLAID LINE 5" (10' DASH, 30' SKIP, YELLOW)
  - ⑤ THERMOPLASTIC PAVEMENT MARKING, - LINE 6" (SOLID WHITE)
  - ⑥ THERMOPLASTIC PAVEMENT MARKING, - LINE 12" (SOLID YELLOW)
  - ⑦ PREFORMED PLASTIC PAVEMENT MARKING, - TYPE B INLAID LINE 24" (SOLID WHITE)
  - ⑧ PREFORMED PLASTIC PAVEMENT MARKING, - TYPE B INLAID LETTERS AND SYMBOLS (WHITE)
  - ⑨ THERMOPLASTIC PAVEMENT MARKING, - LINE 12" (SOLID WHITE)
  - ⑩ PREFORMED PLASTIC PAVEMENT MARKING TYPE B INLAID LINE - 6" (2' DASH 6' SKIP) (WHITE)
- RAISED REFLECTIVE PAVEMENT MARKER LEGEND**
- YELLOW STRIPE
  - WHITE STRIPE
  - ◀ ONE-WAY AMBER MARKER
  - ◁ ONE-WAY CRYSTAL/OPAQUE MARKER
  - ◀ TWO-WAY AMBER MARKER

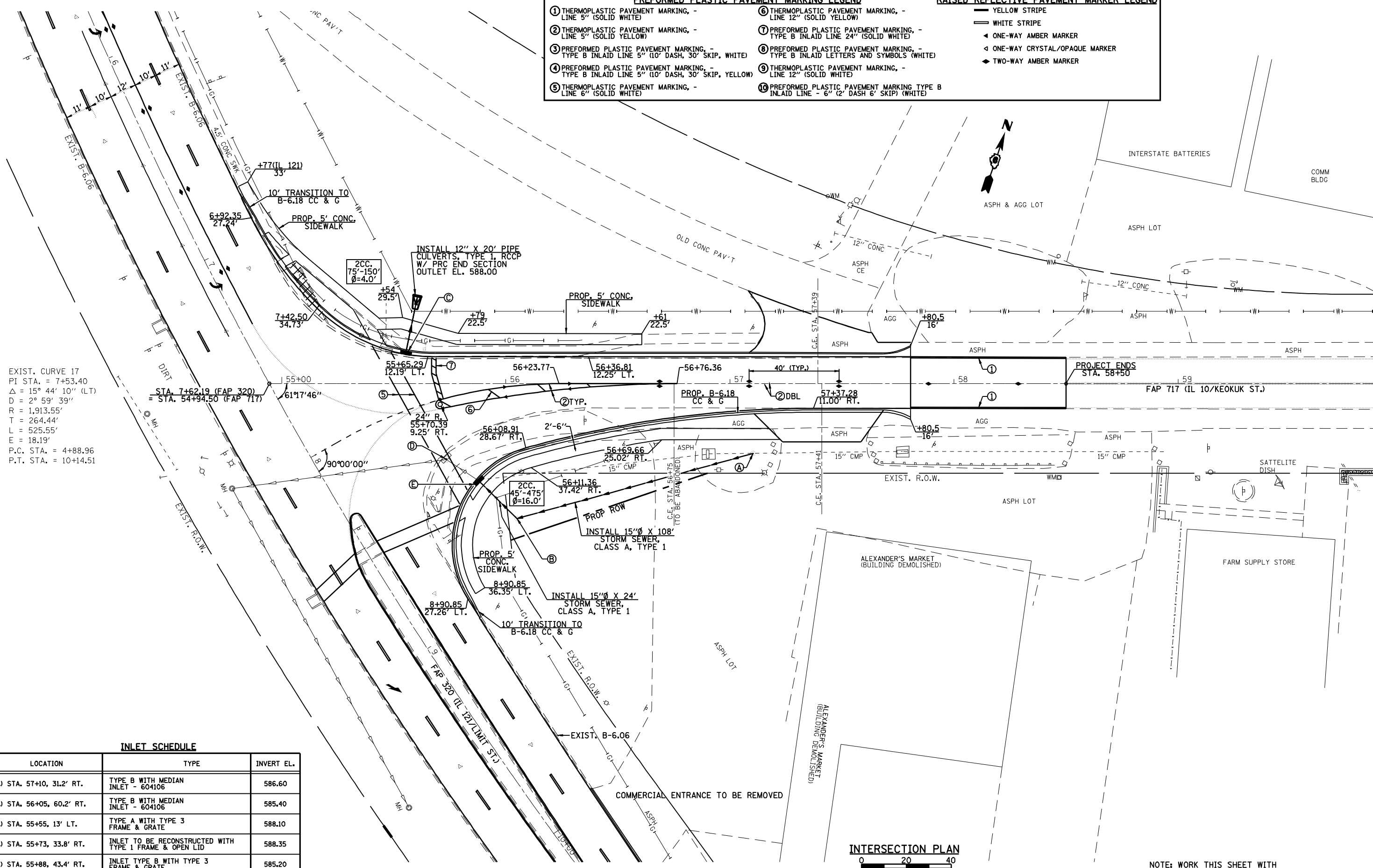

EXIST. CURVE 17  
 PI STA. = 7+53.40  
 $\Delta = 15^\circ 44' 10''$  (LT)  
 $D = 2^\circ 59' 39''$   
 $R = 1,913.55'$   
 $T = 264.44'$   
 $L = 525.55'$   
 $E = 18.19'$   
 P.C. STA. = 4+88.96  
 P.T. STA. = 10+14.51

**INLET SCHEDULE**

LOCATION	TYPE	INVERT EL.
A.) STA. 57+10, 31.2' RT.	TYPE B WITH MEDIAN INLET - 604106	586.60
B.) STA. 56+05, 60.2' RT.	TYPE B WITH MEDIAN INLET - 604106	585.40
C.) STA. 55+55, 13' LT.	TYPE A WITH TYPE 3 FRAME & GRATE	588.10
D.) STA. 55+73, 33.8' RT.	INLET TO BE RECONSTRUCTED WITH TYPE 1 FRAME & OPEN LID	588.35
E.) STA. 55+88, 43.4' RT.	INLET TYPE B WITH TYPE 3 FRAME & GRATE	585.20

**INTERSECTION PLAN**

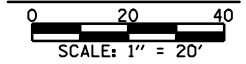

NOTE: WORK THIS SHEET WITH SHEETS NO. 18 & 20