

STA. 19+26.50  
BEGIN IMPROVEMENT

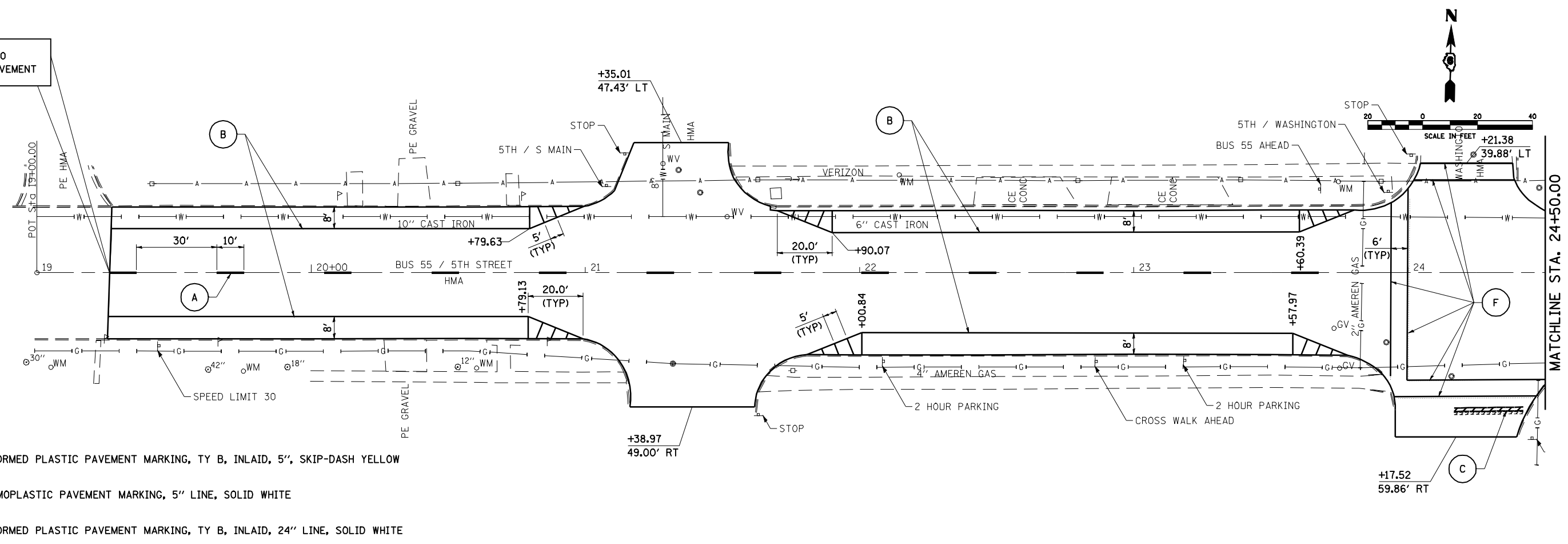

**LEGEND**

- (A) PREFORMED PLASTIC PAVEMENT MARKING, TY B, INLAID, 5", SKIP-DASH YELLOW
- (B) THERMOPLASTIC PAVEMENT MARKING, 5" LINE, SOLID WHITE
- (C) PREFORMED PLASTIC PAVEMENT MARKING, TY B, INLAID, 24" LINE, SOLID WHITE
- (D) THERMOPLASTIC PAVEMENT MARKING, 5" LINE, DOUBLE YELLOW
- (E) THERMOPLASTIC PAVEMENT MARKING, 12" LINE, SOLID DIAGONALS YELLOW @ 20' CENTERS
- (F) PREFORMED PLASTIC PAVEMENT MARKING, TY B - INLAID, 6" LINE, SOLID WHITE

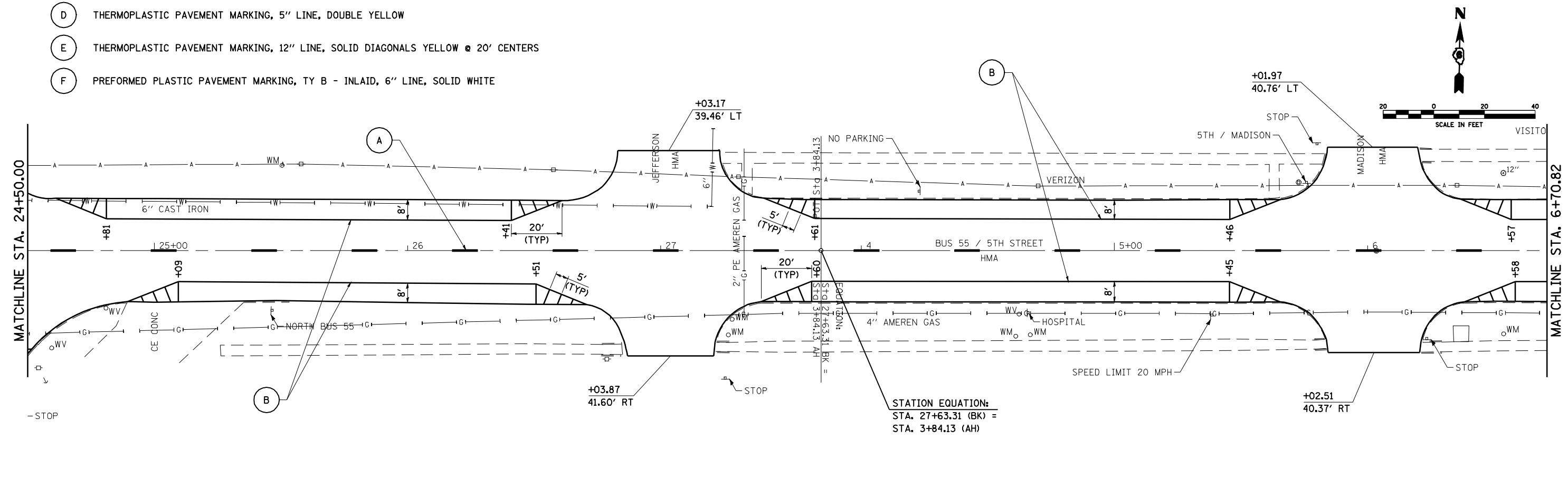

STATION EQUATION:  
STA. 27+63.31 (BK) =  
STA. 3+84.13 (AH)

FILE NAME =	USER NAME = laughlinr1	DESIGNED -	REVISED -	<b>STATE OF ILLINOIS DEPARTMENT OF TRANSPORTATION</b>	<b>PLAN &amp; PAVEMENT MARKING SHEET</b>			F.A.U. RTE.	SECTION	COUNTY	TOTAL SHEETS	SHEET NO.
er:\pwork\p\WIDOT\LAUGHLINRL\dms50958\	672838-SHT-pmk.dgn	DRAWN -	REVISED -					7708	20RS-1 (22 & 23)RS-4	LOGAN	28	10
	PLOT SCALE = 40.0000' / IN.	CHECKED -	REVISED -					CONTRACT NO. 72B38				
	PLOT DATE = Apr-09-2010 09:52:21AM	DATE -	REVISED -					ILLINOIS FED. AID PROJECT				