

MATCHLINE STA. 66+58.53

MATCHLINE STA. 72+58.53

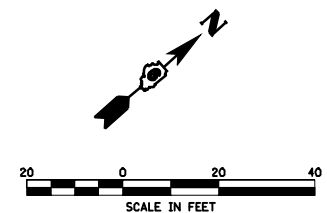
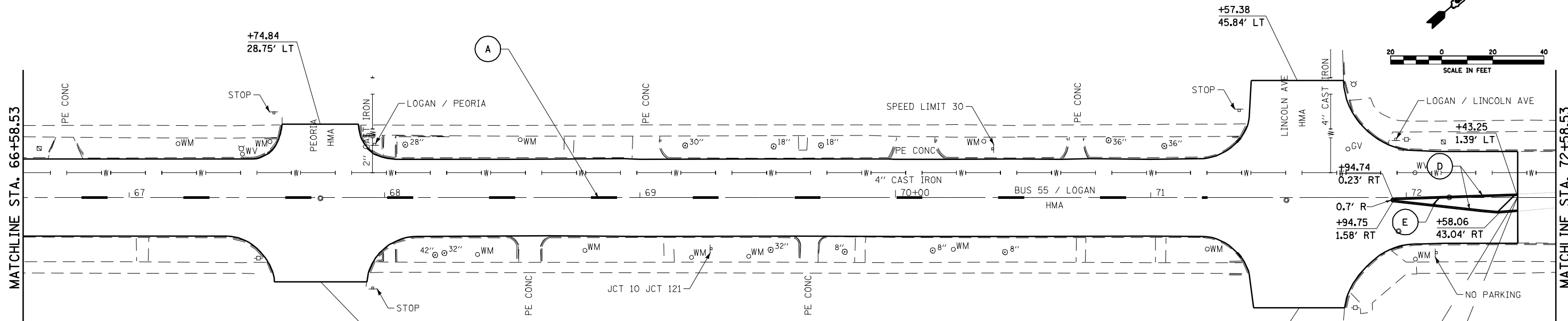

LEGEND

- (A) PREFORMED PLASTIC PAVEMENT MARKING, TY B, INLAID, 5', SKIP-DASH YELLOW
- (B) THERMOPLASTIC PAVEMENT MARKING, 5" LINE, SOLID WHITE
- (C) PREFORMED PLASTIC PAVEMENT MARKING, TY B, INLAID, 24" LINE, SOLID WHITE
- (D) THERMOPLASTIC PAVEMENT MARKING, 5" LINE, DOUBLE YELLOW
- (E) THERMOPLASTIC PAVEMENT MARKING, 12" LINE, SOLID DIAGONALS YELLOW @ 20' CENTERS
- (F) PREFORMED PLASTIC PAVEMENT MARKING, TY B - INLAID, 6" LINE, SOLID WHITE

STA. 72+43.58
END IMPROVEMENT

MATCHLINE STA. 72+58.53

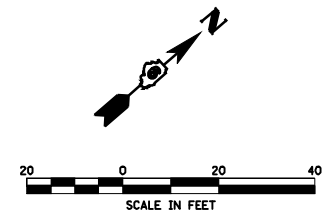
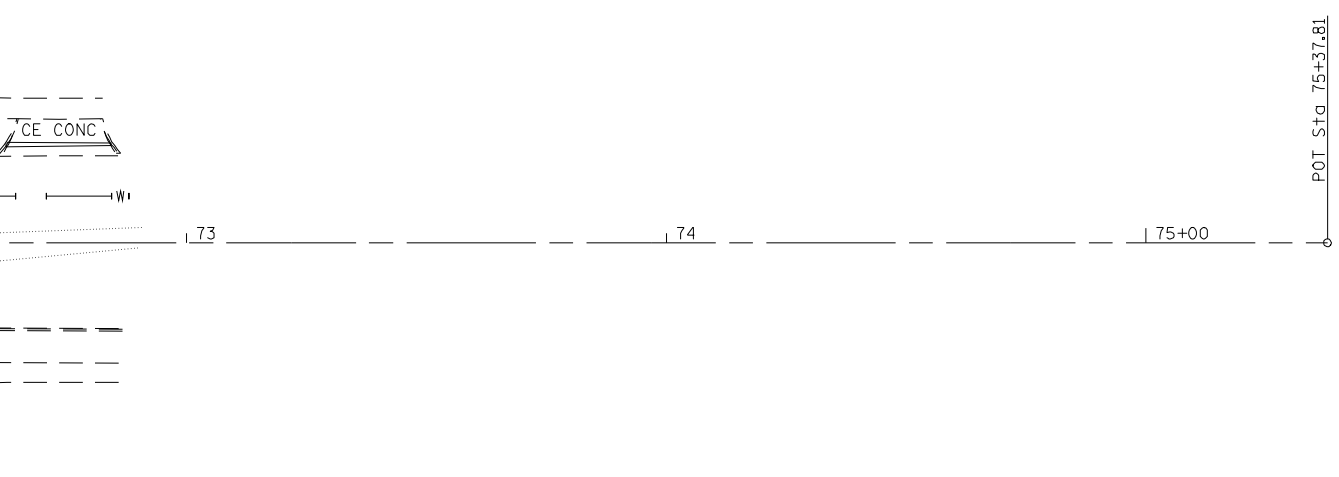

FILE NAME =	USER NAME = laughlinr1	DESIGNED -	REVISED -
es:\pwork\PWIDOT\LAUGHLINRL\dms50958\7272838-SHT-pmk.dgn		DRAWN -	REVISED -
	PLOT SCALE = 40.0000' / IN.	CHECKED -	REVISED -
	PLOT DATE = Apr-09-2010 09:52:46AM	DATE -	REVISED -

**STATE OF ILLINOIS
DEPARTMENT OF TRANSPORTATION**

PLAN & PAVEMENT MARKING SHEET

SCALE: SHEET NO. OF SHEETS STA. TO STA.

F.A.U. RTE.	SECTION	COUNTY	TOTAL SHEETS	SHEET NO.
7708	20RS-1 (22 & 23)RS-4	LOGAN	28	16
CONTRACT NO. 72B38			ILLINOIS FED. AID PROJECT	