

CONTROLLER

(2) (2) (2) (2) (2) (2) (2) (3) (5) (7) (7) (7) (7) (7) (12) (12) (12) (12)

AWC

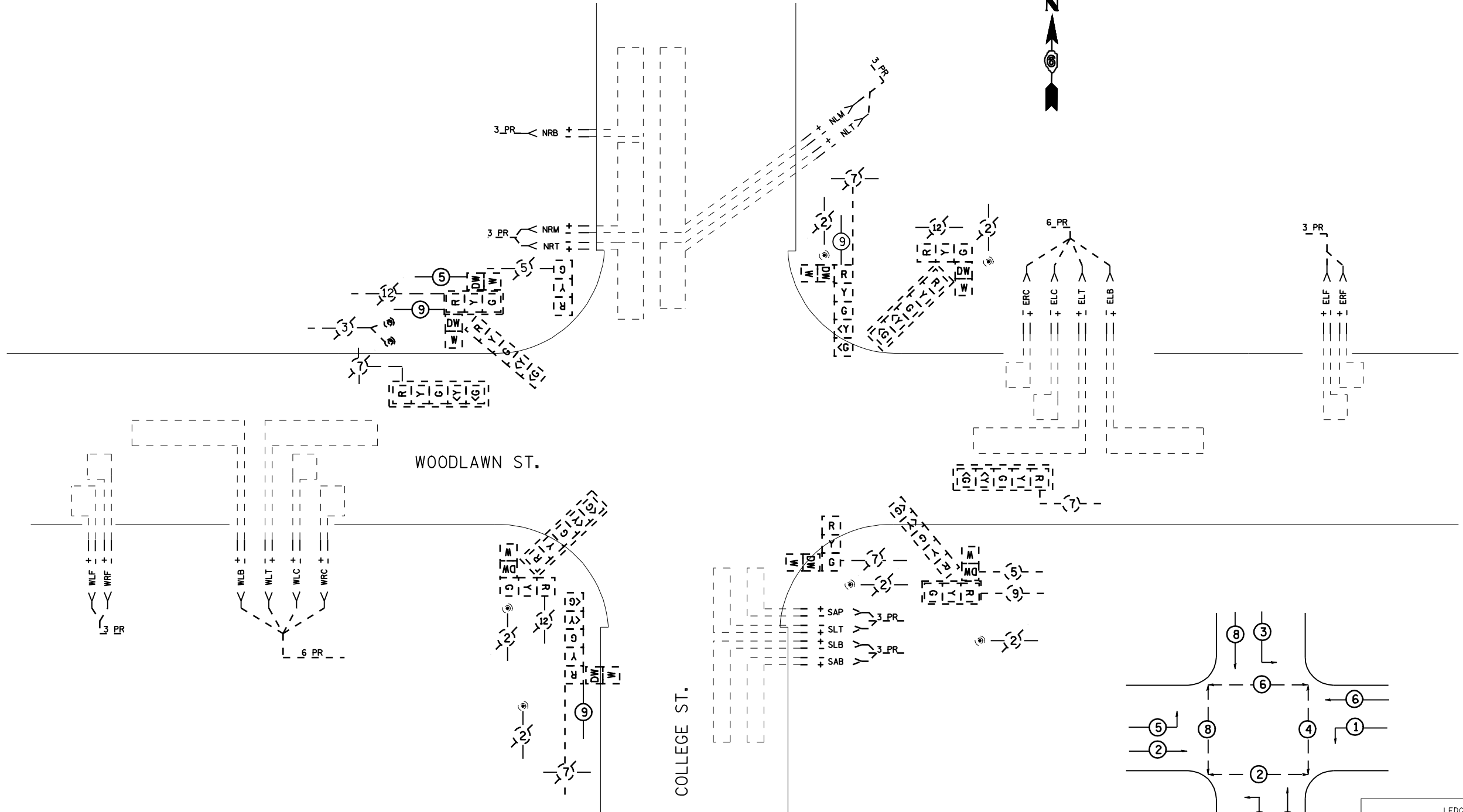

PHASE	2	2	5	5	2	3	3	3	3	3	6	6	1	1	3	8	8	2	2	5	
	WRF	WLF	WLB	WLT	WLC	NRB	NRM	NRT	NLM	NLT	ERF	ELB	ELT	ELC	ERC	SAP	SLT	SLB	SAB		
	3_PR	6_PR	1_PR	3_PR	3_PR	3_PR	3_PR	6_PR	3_PR	3_PR	3_PR	3_PR									

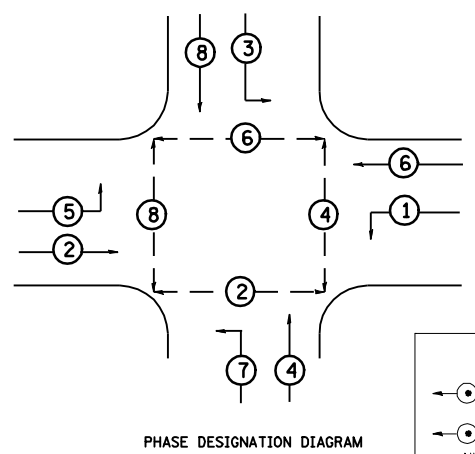

LEGEND

- ⬅ (●) ➡ VEHICLE MOVEMENT
- ⬅ (●) ➡ PEDESTRIAN
- NUMBERS REFER TO ASSOCIATED PHASE

FILE NAME =	USER NAME = laughlinr1	DESIGNED -	REVISED -
er\pwork\PWIDOT\LAUGHLINRL\dms50958\0672838-ts_sheets.dgn		DRAWN -	REVISED -
PLOT SCALE = 48.0000' / IN.		CHECKED -	REVISED -
PLOT DATE = Apr-09-2010 09:52:51AM		DATE -	REVISED -

**STATE OF ILLINOIS
DEPARTMENT OF TRANSPORTATION**

**PROPOSED WIRING DIAGRAM
IL 10/121/WOODLAWN & COLLEGE ST.**

F.A.U. RTE.	SECTION	COUNTY	TOTAL SHEETS	SHEET NO.
7708	20RS-1; (22 & 23)RS-4	LOGAN	28	18
FED. ROAD DIST. NO.			ILLINOIS FED. AID PROJECT	
			CONTRACT NO. 72B38	

SCALE: SHEET NO. OF SHEETS STA. TO STA.