

**TRAFFIC SIGNAL QUANTITIES**

LOCATION:

FIFTH ST & COLLEGE ST (LINCOLN)

QUANTITY	UNIT	ITEM
17.5	SQ FT	SIGN PANEL, TYPE I
22.5	SQ FT	SIGN PANEL, TYPE II
1	EACH	SERVICE INSTALLATION, TYPE A
1	EACH	WOOD POLE, 25 FT., CLASS 4
39.0	FOOT	CONDUIT IN TRENCH, 3/4" DIA., PVC
63.0	FOOT	CONDUIT IN TRENCH, 1 1/2" DIA., PVC
6.0	FOOT	CONDUIT IN TRENCH, 2" DIA., PVC
4.0	FOOT	CONDUIT IN TRENCH, 4" DIA., PVC
11.0	FOOT	CONDUIT, AUGERED, 1 1/2" DIA., PVC
27.0	FOOT	CONDUIT, AUGERED, 2" DIA., PVC
194.0	FOOT	CONDUIT, AUGERED, 3" DIA., PVC
3	EACH	HANDHOLE
1	EACH	DOUBLE HANDHOLE
2	EACH	GULFBOX JUNCTION, COMPOSITE CONCRETE
112.0	FOOT	TRENCH AND BACKFILL FOR ELECTRICAL WORK
1	EACH	FULL ACTUATED CONTROLLER AND TYPE V CABINET
1	EACH	MASTER CONTROLLER
1	EACH	UNINTERRUPTIBLE POWER SUPPLY, STANDARD
1	EACH	TRANSCEIVER - FIBER OPTIC
454.0	FOOT	ELECTRIC CABLE IN CONDUIT, SIGNAL, NO. 14, 3/C
1102.0	FOOT	ELECTRIC CABLE IN CONDUIT, SIGNAL, NO. 14, 5/C
482.0	FOOT	ELECTRIC CABLE IN CONDUIT, SIGNAL, NO. 14, 12/C
470.0	FOOT	ELECTRIC CABLE IN CONDUIT, LEAD-IN, NO. 18, 3 PAIR
12.0	FOOT	ELECTRIC CABLE IN CONDUIT, SERVICE, NO. 6, 2/C
1	EACH	STEEL MAST ARM ASSEMBLY AND POLE, 16 FT.
1	EACH	STEEL MAST ARM ASSEMBLY AND POLE, 22 FT.
1	EACH	STEEL MAST ARM ASSEMBLY AND POLE, 32 FT.
1	EACH	STEEL MAST ARM ASSEMBLY AND POLE, 40 FT.

TRAFFIC SIGNAL MAST ARM ASSEMBLIES SHALL BE DESIGNED FOR THE LOADINGS SHOWN ON THE HIGHWAY STANDARDS OR THESE SIGNAL PLANS WHICHEVER IS GREATER

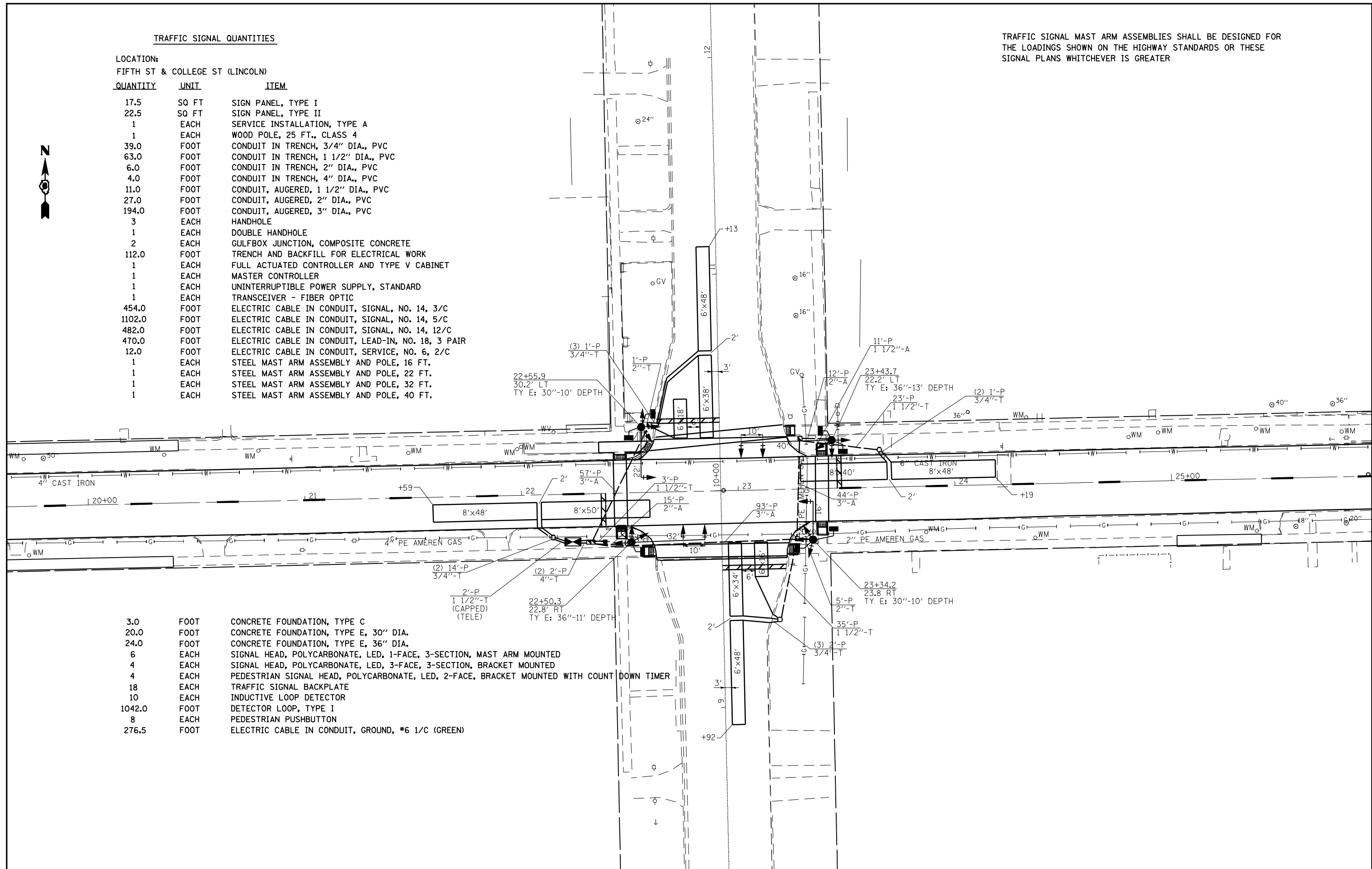

3.0	FOOT	CONCRETE FOUNDATION, TYPE C
20.0	FOOT	CONCRETE FOUNDATION, TYPE E, 30" DIA.
24.0	FOOT	CONCRETE FOUNDATION, TYPE E, 36" DIA.
6	EACH	SIGNAL HEAD, POLYCARBONATE, LED, 1-FACE, 3-SECTION, MAST ARM MOUNTED
4	EACH	SIGNAL HEAD, POLYCARBONATE, LED, 3-FACE, 3-SECTION, BRACKET MOUNTED
4	EACH	PEDESTRIAN SIGNAL HEAD, POLYCARBONATE, LED, 2-FACE, BRACKET MOUNTED WITH COUNT DOWN TIMER
18	EACH	TRAFFIC SIGNAL BACKPLATE
10	EACH	INDUCTIVE LOOP DETECTOR
1042.0	FOOT	DETECTOR LOOP, TYPE I
8	EACH	PEDESTRIAN PUSHBUTTON
276.5	FOOT	ELECTRIC CABLE IN CONDUIT, GROUND, #6 1/C (GREEN)