

F.A.P. RTE.	SECTION	COUNTY	TOTAL SHEETS	SHEET NO.
317	11RS-4; (6CS)RS-4,1	SCHUYLER	7	1
		ILLINOIS	CONTRACT NO. 72B40	

STATE OF ILLINOIS
DEPARTMENT OF TRANSPORTATION
DIVISION OF HIGHWAYS
**PROPOSED
HIGHWAY PLANS**

FAP ROUTE 317 (U.S. 24)
SECTION 11RS-4; (6CS)RS-4,1

RESURFACING, PARKING IMPROVEMENT
SCHUYLER COUNTY

C-96-117-07

FOR INDEX OF SHEETS, SEE SHEET NO. 2

D-96-117-07

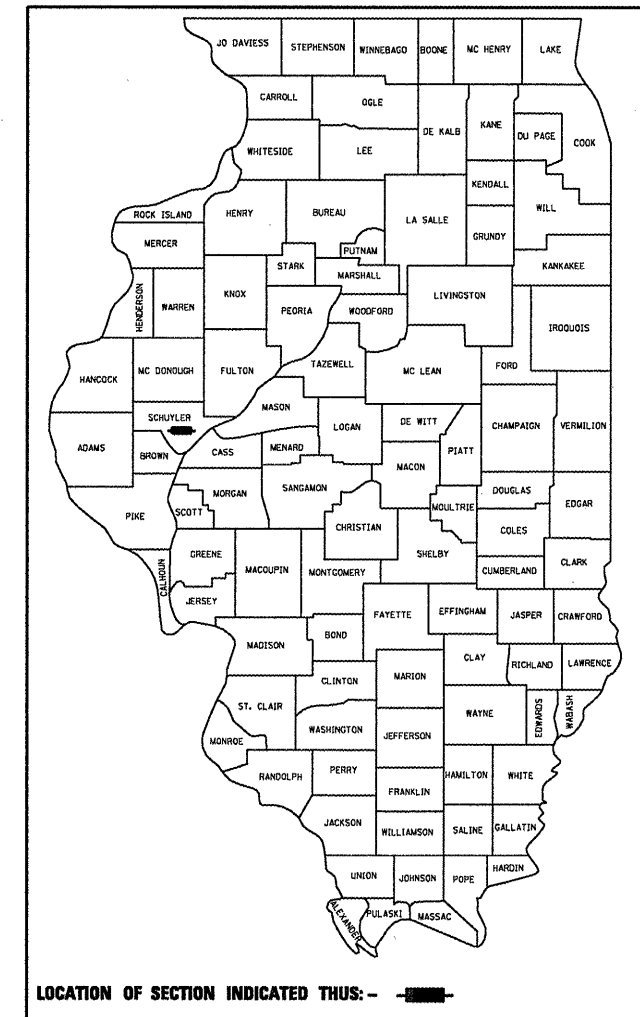

ADT: 5096
SU: 5%
MU: 2%
PV: 93%

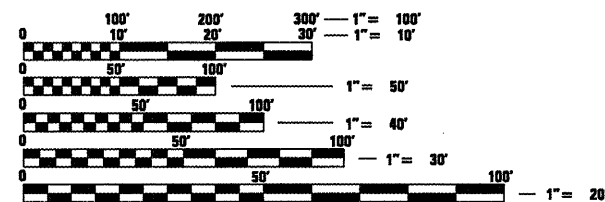

FULL SIZE PLANS HAVE BEEN PREPARED USING STANDARD ENGINEERING SCALES. REDUCED SIZED PLANS WILL NOT CONFORM TO STANDARD SCALES. IN MAKING MEASUREMENTS ON REDUCED PLANS, THE ABOVE SCALES MAY BE USED.

J.U.L.I.E.
JOINT UTILITY LOCATION INFORMATION FOR EXCAVATION
1-800-892-0123
OR 811

PROJECT ENGINEER: JOHN NEGANGARD (217) 782-6990
PROJECT MANAGER: JULIET SHOULTZ (217) 785-2739

CONTRACT NO. 72B40

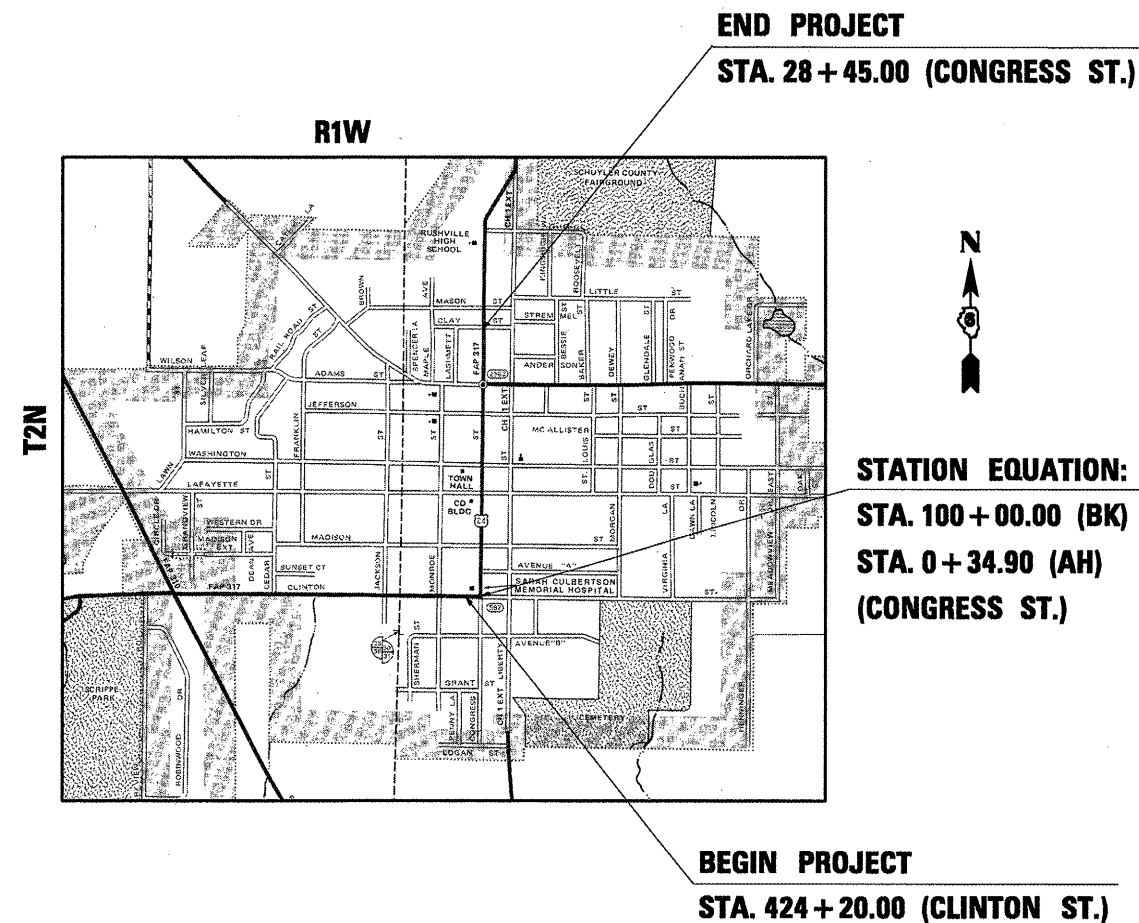

GROSS LENGTH = 2,956.8 FT. = 0.56 MILE
NET LENGTH = 2,956.8 FT. = 0.56 MILE

STATE OF ILLINOIS
DEPARTMENT OF TRANSPORTATION
DIVISION OF HIGHWAYS

SUBMITTED March 25 2010
Ryan Z. Smith
DEPUTY DIRECTOR OF HIGHWAYS, REGION ENGINEER

May 7 2010
Scott E. Stitt, P.E.
acting ENGINEER OF DESIGN AND ENVIRONMENT

May 7 2010
Christine M. Reader
DIRECTOR OF HIGHWAYS, CHIEF ENGINEER

**PRINTED BY THE AUTHORITY
OF THE STATE OF ILLINOIS**

INDEX OF SHEETS

- 1 COVER SHEET
- 2 INDEX OF SHEETS & GENERAL NOTES
- 3 SUMMARY OF QUANTITIES
- 4-5 SCHEDULE OF QUANTITIES
- 6-9 TYPICAL SECTIONS
- 10-15 PLAN SHEETS
- 16-17 SIDE ROAD DETAIL

RATES OF APPLICATION

THE FOLLOWING RATES OF APPLICATION HAVE BEEN ASSUMED IN CALCULATING PLAN QUANTITIES.

BITUMINOUS (PRIMECOAT)	0.00038 TON / SY
AGGREGATE (PRIMECOAT)	0.002 TON / SY
HOT-MIX ASPHALT SURFACE COURSE	0.056 TON / SY - IN
AGGREGATE	2.05 TON / CY

MIXTURE REQUIREMENTS

MIXTURE USE(S):	HMA SURFACE	PATCHING	INCIDENTAL HMA SURFACING
PG:	PG64-22	PG64-22	PG64-22
DESIGN AIR VOIDS:	4.0% @ Ndes = 50	4.0% @ Ndes = 50	4.0% @ Ndes = 50
MIXTURE COMPOSITION:	IL 9.5 or 12.5	IL 19.0	IL 9.5 or 12.5
FRICTION AGGREGATE:	Mix D	N/A	Mix C

HIGHWAY STANDARDS

- 000001-05
- 442201-03
- 701301-03
- 701311-03
- 701501-05
- 701901-01
- 781001-03

DISTRICT SIX	
EXAMINED <u>March 16</u> 20 <u>10</u>	<i>One Walker</i>
OPERATIONS ENGINEER	
EXAMINED <u>March 10</u> 20 <u>10</u>	<i>JRM/LJ</i>
PROGRAM DEVELOPMENT ENGINEER	
EXAMINED <u>MARCH 24</u> 20 <u>10</u>	<i>Tommy Furt</i>
PROGRAM IMPLEMENTATION ENGINEER	

COMMITMENTS

COMMITMENTS ARE NOT TO BE ALTERED WITHOUT THE WRITTEN APPROVAL OF ALL PARTIES TO WHICH THE COMMITMENT WAS MADE.

- 1.) THE RESIDENT ENGINEER SHALL CONTACT STUDIES AND PLANS CONCERNING ANY MAJOR PLAN CHANGE, TO MAKE SURE NO PREVIOUS COMMITMENTS (NOT LISTED) WERE MADE AFFECTING THE DESIGN AND ALLOW AN IMPROVED DESIGN FOR FUTURE PROJECTS.
- 2.) LETTER OF UNDERSTANDING WITH THE CITY OF RUSHVILLE.

GENERAL NOTES

WHERE SECTION OR SUBSECTION MONUMENTS ARE ENCOUNTERED, THE ENGINEER SHALL BE NOTIFIED BEFORE SUCH MONUMENTS ARE REMOVED. THE CONTRACTOR SHALL PROTECT AND CAREFULLY PRESERVE ALL PROPERTY MARKS, MONUMENTS, AND PERMANENT SURVEY MARKERS UNTIL THE OWNER, AND AUTHORIZED SURVEYOR OR AGENT HAS WITNESSES OR OTHERWISE REFERENCED

THE NOMINAL THICKNESS FOR BASE AND SURFACE COURSES ARE SHOWN ON THE TYPICAL SECTIONS, STANDARDS, SCHEDULES, OR SPECIAL DETAILS. THE CONSTRUCTED THICKNESS OF THE ABOVE ITEM SHALL NOT BE LESS THAN 90 PERCENT OF THE NOMINAL THICKNESS AT ANY LOCATION.

THE THICKNESS OF HOT-MIX ASPHALT MIXTURE SHOWN ON THE PLANS IS THE NOMINAL THICKNESS. DEVIATIONS FROM THE NOMINAL THICKNESS WILL BE PERMITTED WHEN SUCH DEVIATION OCCUR DUE TO IRREGULARITIES IN THE EXISTING SURFACE OR BASE ON WHICH THE HOT-MIX ASPHALT MIXTURE IS PLACED.

ANY REFERENCE TO A STANDARD IN THE PLANS SHALL BE INTERPRETED TO MEAN THE EDITION, AS INDICATED BY THE SUB-NUMBER LISTED IN THE INDEX OF SHEETS, OR THE COPY OF THE STANDARD INCLUDED IN THE PLANS.

THE LOCATIONS OF EXISTING WATER MAINS, GAS MAINS, SEWERS, ELECTRIC POWER LINES, TELEPHONE LINES AND OTHER UTILITIES AS SHOWN ON THE PLANS ARE BASED ON THE BEST INFORMATION AVAILABLE, BUT THEY ARE NOT GUARANTEED, ALL UTILITY LOCATIONS SHOWN ARE SUPPLIED BY THE UTILITY COMPANIES. IT IS THE CONTRACTOR'S RESPONSIBILITY TO ASCERTAIN THEIR EXACT LOCATION FROM THE UTILITY COMPANIES AND BY FIELD INSPECTION.

ACCESS MUST BE MAINTAINED TO ALL EXISTING PROPERTIES DURING CONSTRUCTION PER ARTICLE 107.09 UNLESS ARRANGEMENTS ARE MADE IN WRITING BY THE CONTRACTOR WITH THE PROPERTY OWNERS WITH A COPY TO THE ENGINEER FOR SHORT-TERM CLOSURES

ALL ELEVATIONS SHOWN ON THE PLANS ARE ESTABLISHED FROM U.S.G.S. MEAN SEAL LEVEL DATUM.

CONTINUOUS PAVING OPERATIONS ON THE MAIN ROADWAY SHALL BE MAINTAINED AT ALL TIMES DURING THE CONSTRUCTION OF THE HOT-MIX ASPHALT SURFACE. NO INTERRUPTIONS FOR SIDE ROADS, ENTRANCE, TURN LANES, ETC. WILL BE ALLOWED.

THE DISTRICT BUREAU OF OPERATIONS SHALL BE NOTIFIED AT LEAST 14 DAYS PRIOR TO PLACEMENT OF FINAL PAVEMENT MARKINGS. PHONE: (217)782-7314

I000 Y025

		CONSTRUCTION CODE: FUNDING: 100% STATE			
Code No.	Item	Unit	Total	Mainline Total	Parking Total
35800100	PREPARATION OF BASE	SQ YD	1,257	1,257	--
40600200	BITUMINOUS MATERIALS (PRIME COAT)	TON	5.4	4.0	1.4
40600300	AGGREGATE (PRIME COAT)	TON	25.9	18.9	7.0
40603335	HOT-MIX ASPHALT SURFACE COURSE, MIX "D", N50	TON	1,419	1,028	391
40600895	CONSTRUCTING TEST STRIP	EACH	1	1	--
40600982	HOT-MIX ASPHALT SURFACE REMOVAL - BUTT JOINT	SQ YD	1,416	1,416	--
40600990	TEMPORARY RAMP	SQ YD	80	80	--
40800050	INCIDENTAL HOT-MIX ASPHALT SURFACING	TON	133	133	--
44200168	PAVEMENT PATCHING, TYPE II, 14 INCH	SQ YD	55	55	--
44000157	HOT-MIX ASPHALT SURFACE REMOVAL, 2"	SQ YD	9,016	9,016	--
44000198	HOT-MIX ASPHALT SURFACE REMOVAL, VARIABLE DEPTH	SQ YD	3,490	--	3,490
48101200	AGGREGATE SHOULDERS, TYPE B	TON	13	13	--
56109210	WATER VALVES TO BE ADJUSTED	EACH	7	7	--
60255500	MANHOLES TO BE ADJUSTED	EACH	5	5	--
67000400	ENGINEER'S FIELD OFFICE, TYPE A	CAL MO	6	6	--
67100100	MOBILIZATION	L SUM	1	1	--
70102620	TRAFFIC CONTROL AND PROTECTION, STANDARD 701501	LSUM	1	1	--
70300100	SHORT-TERM PAVEMENT MARKING	FOOT	1,492	1,492	--
70301000	WORK ZONE PAVEMENT MARKING REMOVAL	SQ FT	177	177	--
* 78004200	PREFORMED PLASTIC PAVEMENT MARKING, TYPE B - INLAID - LETTERS AND SYMBOLS	SQ FT	4.6	--	4.6
* 78000300	THERMOPLASTIC PAVEMENT MARKING - LINE 5"	FOOT	5,696	5,186	510
* 78004220	PREFORMED PLASTIC PAVEMENT MARKING, TYPE B - INLAID - LINE 5"	FOOT	683	683	--
* 78004230	PREFORMED PLASTIC PAVEMENT MARKING, TYPE B - INLAID - LINE 6"	FOOT	1,280	1,280	--
* 78004280	PREFORMED PLASTIC PAVEMENT MARKING, TYPE B - INLAID - LINE 24"	FOOT	90	90	--
* 78100100	RAISED REFLECTIVE PAVEMENT MARKER	EACH	39	39	--
78300200	RAISED REFLECTIVE PAVEMENT MARKER REMOVAL	EACH	39	39	--

* SPECIALTY ITEM

RESURFACING SCHEDULE																
STATION TO STATION	LENGTH	MAINLINE PAVT. WIDTH	MAINLINE PAVT. AREA	PARKING WIDTH	PARKING AREA	BIT MAT PRIMECOAT	AGG PRIMECOAT	HMA THICKNESS	HMA SURFACE	BUTT JOINT	HMA SURF REM 2"	HMA SURF REM VAR. D	PAVT PATCH TY II, 14IN	TEMP RAMP	AGGREGATE SHOULDER	
MAINLINE	(FT)	(FT)	(SY)	(FT)	(SY)	(TON)	(TON)	(IN)	(TON)	(SY)	(SY)	(SY)	(SY)	(SY)	(TON)	
CLINTON ST																
8+94	9+16	22	39.5	97	--	--	0.04	0.19	2	11	43.9	53	--	--	21.9	--
STA. EQ. 9+35.00(BK) = 425+26.91 (AH)																
424+20	424+69	49	27	147	--	--	0.06		2	16	30.0	117	--	--	15.0	3.7
424+69	425+90	121	61.5	827	--	--	0.31		2	93	--	827	--	--		9.2
CONGRESS ST																
99+70	100+00	30	39	130	--	--	0.05	0.26	2	15	43.3	87	--	--	21.7	--
STA. EQ. 100+00.00(BK) = 0+34.90 (AH)																
+35	1+00	65	39	282	--	--	0.11	0.56	2	32	--	282	--	--	--	--
1+00	5+40	440	24	1,173	--	--	0.45	2.35	2	131	--	1,173	--	--	--	--
5+40	6+18	78	38	329	--	--	0.13	0.66	2	37	--	329	--	--	--	--
6+18	19+53	1335	24	3,560	--	--	1.35	7.12	2	399	--	3,560	--	--	--	--
19+53	20+35	82	38	346	--	--	0.13	0.69	2	39	--	346	--	--	--	--
20+35	22+70	235	24	627	--	--	0.24	1.25	2	70	--	627	--	--	--	--
22+70	23+50	80	38	338	--	--	0.13	0.68	2	38	--	338	--	--	--	--
23+50	28+45	495	24	1,320	--	--	0.50	2.64	2	148	42.2	1,278	--	--	21.1	--
MAINLINE TOTAL		3,032	--	--	--	--	3.5	16.40	--	1,028	159	9,016	--	55	80	12.9
PARKING																
1+00	1+25	25	--	--	15	42	0.10	0.08	2	5	--	42	--	--	--	--
1+25	5+40	415	--	--	14	646	0.25	1.29	2	72	--	646	--	--	--	--
6+18	10+90	472	--	--	14	734	0.28	1.47	2	82	--	734	--	--	--	--
14+84	18+50	366	--	--	19	773	0.29	1.55	2	87	--	773	--	--	--	--
18+50	19+53	103	--	--	14	160	0.06	0.32	2	18	--	160	--	--	--	--
20+35	22+70	235	--	--	14	366	0.14	0.73	2	41	--	366	--	--	--	--
23+50	28+45	495	--	--	14	770	0.29	1.54	2	86	--	770	--	--	--	--
PARKING TOTAL		--	--	--	--	--	1.4	7.0	--	391	--	3,490	--	--	--	--
JOB TOTAL		3,032	--	--	--	--	4.9	23.4	--	1,419	159	9,016	3,490	55	80	13
GROSS LENGTH		0.57 mi														
NET LENGTH		0.57 mi														

PAVEMENT PATCHING	
Type	(SY)
TY II, 14 INCH	55

PAVEMENT MARKING SCHEDULE									
STATION TO STATION	LENGTH	SHORT-TERM			WORKZONE PAVT. MKG REMOVAL	RAIS. REFL. PAVT MKR (EACH)	RAIS. REFL. PAVT MKR REMOVAL (EACH)		
		CENTERLINE PAVT MKG (FT)	EOP MKG (FT)	STOP BARS 12'x(4"x6) (FT)					
CLINTON ST									
8+94	9+16	22	8	--	72	1	1	1	
STA. EQ. 9+35.00(BK) = 425+26.91 (AH)									
424+20	424+64	44	32	--	72	5	2	2	
CONGRESS ST									
99+70	100+00	30	8	--	72	1	1	1	
+35	28+45	2,810	562	450	216	169	35	35	
SUB-TOTAL		--	610	450	432	--	--	--	
TOTALS		--		1,492		177	39	39	
PREFORMED PLASTIC PVT MARKING									
STATION TO STATION	EOP	NO PASS	PARKING	LETTERS & SYMBOLS	24" WHITE STOP BAR (FT)	6" WHITE CROSS WALK (FT)	5" YELLOW SKIP DASH (FT)		
								THERMOPLASTIC PAVT MKG LINE 5"	
CLINTON ST									
8+94	9+16	--	--	--	20	64	--		
STA. EQ. 9+35.00(BK) = 425+26.91 (AH)									
425+27	424+20	130	120	--	--	14	96	24	
CONGRESS ST									
99+70	100+00	--	--	--	--	12	--	--	
STA. EQ. 100+00.00(BK) = 0+34.90 (AH)									
+35	1+75	206	150	--	--	20	100	12	
1+75	22+67	--	--	--	--	--	--	523	
1+75	5+40	730	--	--	--	--	--	--	
5+40	6+18	--	--	--	--	--	228	--	
6+18	11+00	964	--	110	--	--	76	--	
11+00	14+84	488	--	--	--	--	76	--	
14+84	19+53	938	--	400	4.6	--	--	--	
19+53	20+35	--	--	--	--	--	320	--	
20+35	22+70	470	--	--	--	12	--	--	
22+70	23+50	--	--	--	--	--	320	--	
23+50	28+45	990	--	--	--	12	--	124	
SUB-TOTAL		4,916	270	--	--	--	--	--	
TOTALS			5,186	510	4.6	90	1,280	683	

ENTRANCE IMPROVEMENT SCHEDULE											
LOCATION	TYPE OF ENTRANCE	MATERIAL TYPE (PROP. HMA)	WIDTH (EDGE OF PAVEMENT)	WIDTH (ENTRANCE WIDTH)	LENGTH (EOP/BIT SHLD TO LIMITS OF IMPRVMT)	AREA	PREP. OF BASE	HMA SURF REM. - BUTT JOINT	BIT MATLS (P.C.)	AGG (P.C.)	INCIDENTAL BIT.SURF.
(LT / RT) (STA) (+)	(FE / PE / CE)	(EXISTING)	FOOT	FOOT	FOOT	SQ. YD.	SQ. YD.	SQ. YD.	TON	TON	TON
LT STA. 2+40	CE	HMA	30	20	14	38.9	38.9	38.9	0.01	0.08	3.3
LT STA. 3+00	CE	HMA	24	15	14	30.3	30.3	30.3	0.01	0.06	2.5
RT STA. 3+00	ALLEY/CE	HMA	24	15	14	30.3	30.3	30.3	0.01	0.06	5.9
LT STA. 4+12	PE	HMA	20	16	14	28.0	28.0	28.0	0.01	0.06	2.4
LT STA. 5+76	MADISON ST.	HMA	60	35	20	105.6	105.6	105.6	0.04	0.21	8.9
RT STA. 5+76	MADISON ST.	HMA	55	24	20	87.8	87.8	87.8	0.03	0.18	7.4
RT STA. 6+50	CE	HMA	44	35	14	61.4	61.4	61.4	0.02	0.12	5.2
RT STA. 6+90	CE	HMA	44	35	14	61.4	61.4	61.4	0.02	0.12	5.2
LT STA. 7+00	PE	HMA	18	10	14	21.8	21.8	21.8	0.01	0.04	4.3
LT STA. 8+59	ALLEY/CE	O&C	30	18	14	37.3	37.3	37.3	0.01	0.07	7.3
RT STA. 8+59	ALLEY/CE	O&C	30	15	14	35.0	35.0	35.0	0.01	0.07	6.9
LT STA. 9+90	CE	HMA	20	15	14	27.2	27.2	27.2	0.01	0.05	2.3
LT STA. 17+14	ALLEY/CE	O&C	22	18	14	31.1	31.1	31.1	0.01	0.06	6.1
RT STA. 17+14	ALLEY/CE	O&C	22	18	14	31.1	31.1	31.1	0.01	0.06	6.1
LT STA. 19+93	JEFFERSON ST.	HMA	60	40	20	111.1	111.1	111.1	0.04	0.22	9.3
RT STA. 19+93	JEFFERSON ST.	HMA	55	35	20	100.0	100.0	100.0	0.04	0.20	8.4
LT STA. 23+06	ADAMS ST.	HMA	60	40	20	111.1	111.1	111.1	0.04	0.22	9.3
RT STA. 23+06	ADAMS ST.	HMA	56	40	20	106.7	106.7	106.7	0.04	0.21	9.0
LT STA. 24+87	CE	HMA	20	14	14	26.4	26.4	26.4	0.01	0.05	2.2
LT STA. 25+90	CE	HMA	24	20	14	34.2	34.2	34.2	0.01	0.07	2.9
RT STA. 26+43	ALLEY/CE	O&C	30	20	14	38.9	38.9	38.9	0.01	0.08	7.6
LT STA. 26+87	PE	HMA	30	24	14	42.0	42.0	42.0	0.02	0.08	3.5
RT STA. 27+20	PE	HMA	18	10	14	21.8	21.8	21.8	0.01	0.04	4.3
RT STA. 28+19	PE	HMA	24	24	14	37.3	37.3	37.3	0.01	0.07	3.1
	TOTAL						1257	1257	0.5	2.5	133

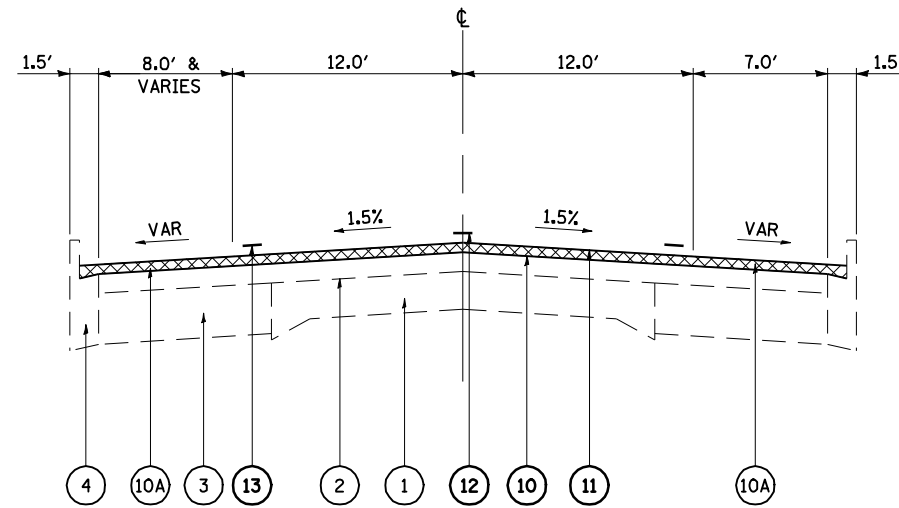

STA. 99+75.52 - 1+25.00
(CONGRESS STREET)

STATION EQUATION:
STA. 100+00.00 (BK) = STA. 0+34.90 (AH)

LEGEND

- ① EXISTING PCC PAVEMENT (9-6-9)
- ② EXISTING HOT-MIX ASPHALT SURFACE COURSE
- ③ EXISTING PCC WIDENING (8")
- ④ EXISTING CONCRETE CURB & GUTTER
- ⑤ EXISTING NATURAL CEMENT BASE (4")
- ⑥ EXISTING SAND CUSHION (1 1/2")
- ⑦ EXISTING BRICK ON EDGE
- ⑧ EXISTING SANDSTONE CURB
- ⑨ EXISTING OPEN-GRADED ASPHALT FRICTION COURSE
- ⑩ PROPOSED HOT-MIX ASPHALT SURFACE REMOVAL (2")
- ⑩A PROPOSED HOT-MIX ASPHALT SURFACE REMOVAL, VARIABLE DEPTH
- ⑪ PROPOSED HOT-MIX ASPHALT SURFACE COURSE, MIX "D" (2")
- ⑫ PROPOSED PREFORMED PLASTIC PAVEMENT MARKING, LINE, SKIP-DASH, YELLOW (5")
- ⑬ PROPOSED THERMOPLASTIC PAVEMENT MARKING, LINE, SOLID, WHITE (5")

••NOTE: MAINLINE OVERLAY THICKNESS 3/4" GREATER THAN PARKING LANE OVERLAY.
MILL 2" ALONG GUTTER LINE AND VARY DEPTH OF MILLING ACROSS PARKING LANE TO
MATCH MILLED DEPTH AT MAINLINE EDGE OF PAVEMENT.

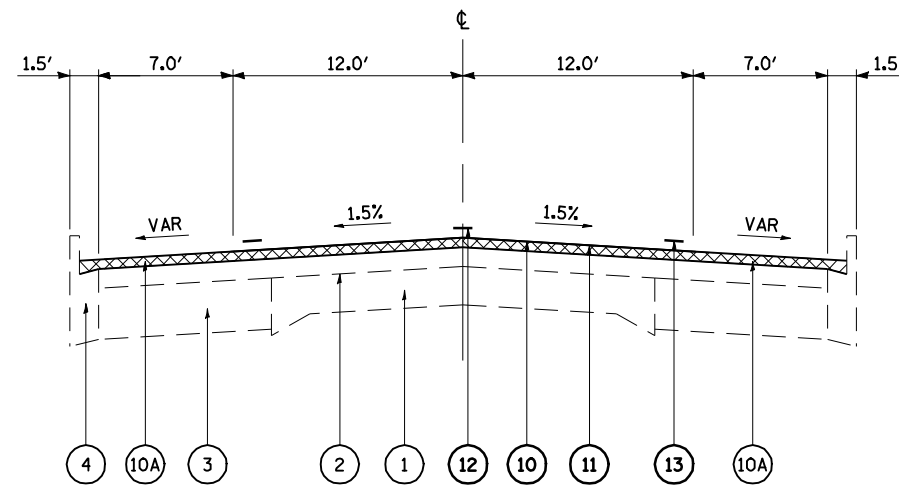

STA. 1+25.00 - 11+00.00
STA. 24+06.00 - 28+45.00
(CONGRESS STREET)

FILE NAME =	USER NAME = laughlinr1	DESIGNED -	REVISED -	STATE OF ILLINOIS DEPARTMENT OF TRANSPORTATION	TYPICAL SECTIONS		F.A.P. RTE.	SECTION	COUNTY	TOTAL SHEETS	SHEET NO.
es:\pwwork\pwwid\LAUGHLINRL\0177182\0672B40-ah-typical.dgn	DRAWN -	REVISD -	REVISD -		317	11RS-4 & (6CS)RS-4,I	SCHUYLER	6	17		
PLOT SCALE = 10,0000 ' / IN.	CHECKED -	REVISD -	REVISD -		CONTRACT NO. 72B40			ILLINOIS FED. AID PROJECT			
PLOT DATE = Mar-25-2010 04:01:35PM	DATE -	REVISD -	REVISD -		SCALE:	SHEET NO. 6 OF 17 SHEETS	STA.	TO STA.			

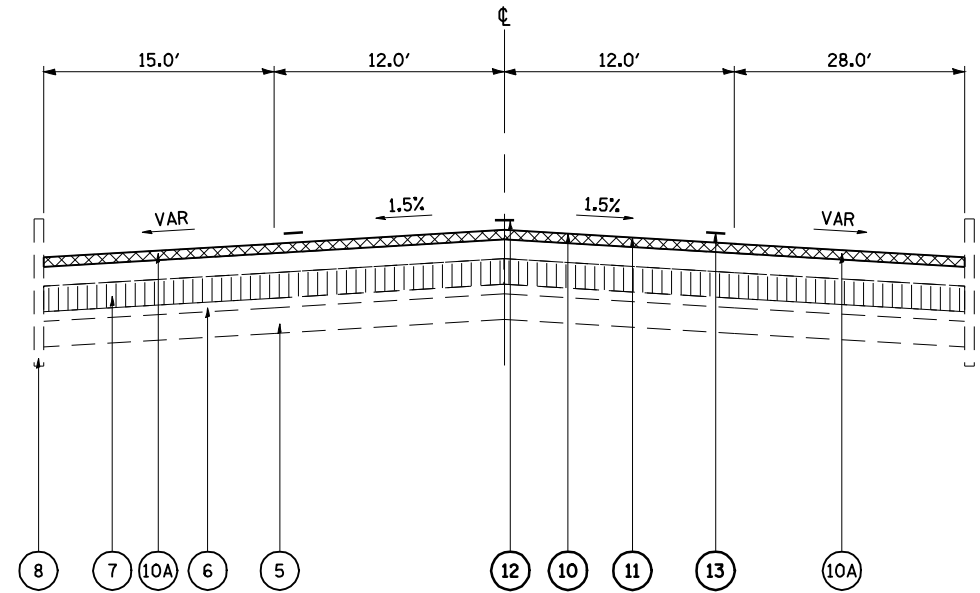

STA. 11+00.00 - 14+71.00
(CONGRESS STREET)

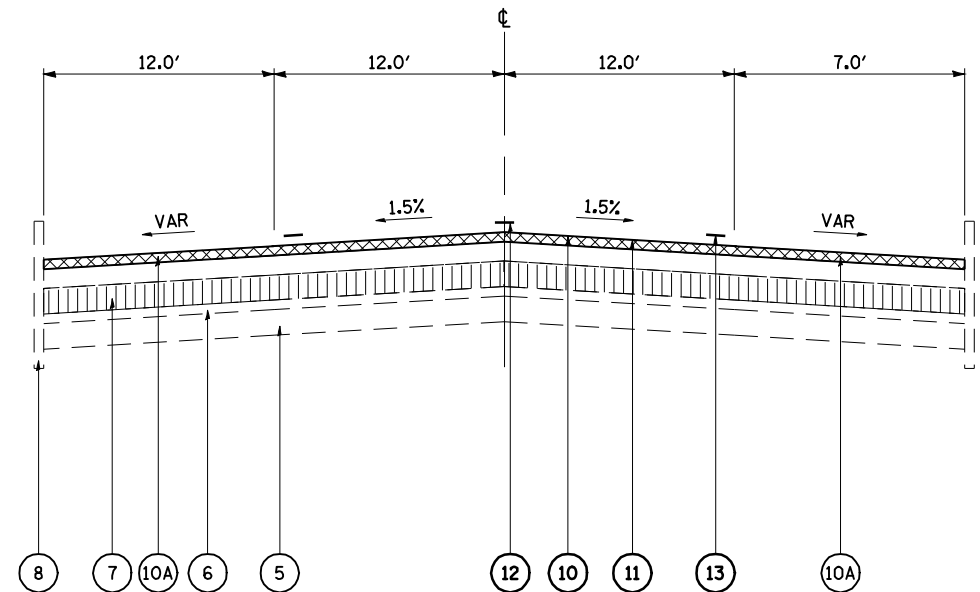

STA. 14+71.00 - 18+50.00
(CONGRESS STREET)

LEGEND

- ① EXISTING PCC PAVEMENT (9-6-9)
- ② EXISTING HOT-MIX ASPHALT SURFACE COURSE
- ③ EXISTING PCC WIDENING (8")
- ④ EXISTING CONCRETE CURB & GUTTER
- ⑤ EXISTING NATURAL CEMENT BASE (4")
- ⑥ EXISTING SAND CUSHION (1 1/2")
- ⑦ EXISTING BRICK ON EDGE
- ⑧ EXISTING SANDSTONE CURB
- ⑨ EXISTING OPEN-GRADED ASPHALT FRICTION COURSE
- ⑩ PROPOSED HOT-MIX ASPHALT SURFACE REMOVAL (2")
- ⑩A PROPOSED HOT-MIX ASPHALT SURFACE REMOVAL, VARIABLE DEPTH
- ⑪ PROPOSED HOT-MIX ASPHALT SURFACE COURSE, MIX "D" (2")
- ⑫ PROPOSED PREFORMED PLASTIC PAVEMENT MARKING, LINE, SKIP-DASH, YELLOW (5")
- ⑬ PROPOSED THERMOPLASTIC PAVEMENT MARKING, LINE, SOLID, WHITE (5")

••NOTE: MAINLINE OVERLAY THICKNESS 3/4" GREATER THAN PARKING LANE OVERLAY.
MILL 2" ALONG GUTTER LINE AND VARY DEPTH OF MILLING ACROSS PARKING LANE TO
MATCH MILLED DEPTH AT MAINLINE EDGE OF PAVEMENT.

FILE NAME =	USER NAME = laughlinr1	DESIGNED -	REVISED -	STATE OF ILLINOIS DEPARTMENT OF TRANSPORTATION	TYPICAL SECTIONS			F.A.P. RTE.	SECTION	COUNTY	TOTAL SHEETS	SHEET NO.
es:\pwork\pwork\LAUGHLINRL\0177182\0672B40-ah-typical.dgn		DRAWN -	REVISED -		317	11RS-4 & (6CS)RS-4,I	SCHUYLER	7	17			
PLOT SCALE = 10.0000 ' / IN.		CHECKED -	REVISED -		CONTRACT NO. 72B40			ILLINOIS FED. AID PROJECT				
PLOT DATE = Mar-25-2010 04:01:39PM		DATE -	REVISED -		SCALE:	SHEET NO. 7 OF 17 SHEETS	STA.	TO STA.				

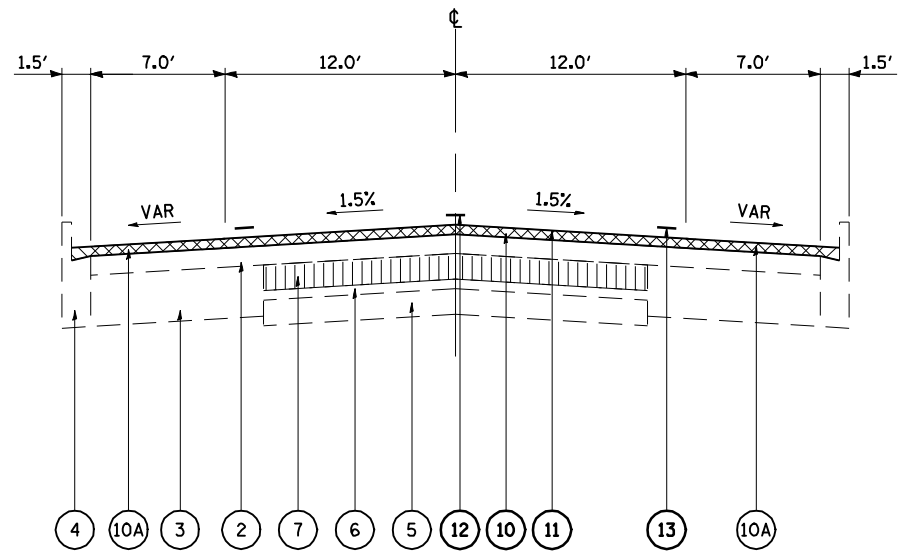

STA. 18+50.00 - 22+06.00
(CONGRESS STREET)

LEGEND

- ① EXISTING PCC PAVEMENT (9-6-9)
- ② EXISTING HOT-MIX ASPHALT SURFACE COURSE
- ③ EXISTING PCC WIDENING (8")
- ④ EXISTING CONCRETE CURB & GUTTER
- ⑤ EXISTING NATURAL CEMENT BASE (4")
- ⑥ EXISTING SAND CUSHION (1 1/2")
- ⑦ EXISTING BRICK ON EDGE
- ⑧ EXISTING SANDSTONE CURB
- ⑨ EXISTING OPEN-GRADED ASPHALT FRICTION COURSE
- ⑩ PROPOSED HOT-MIX ASPHALT SURFACE REMOVAL (2")
- ⑩A PROPOSED HOT-MIX ASPHALT SURFACE REMOVAL, VARIABLE DEPTH
- ⑪ PROPOSED HOT-MIX ASPHALT SURFACE COURSE, MIX "D" (2")
- ⑫ PROPOSED PREFORMED PLASTIC PAVEMENT MARKING, LINE, SKIP-DASH, YELLOW (5")
- ⑬ PROPOSED THERMOPLASTIC PAVEMENT MARKING, LINE, SOLID, WHITE (5")

••NOTE: MAINLINE OVERLAY THICKNESS 3/4" GREATER THAN PARKING LANE OVERLAY.
MILL 2" ALONG GUTTER LINE AND VARY DEPTH OF MILLING ACROSS PARKING LANE TO
MATCH MILLED DEPTH AT MAINLINE EDGE OF PAVEMENT.

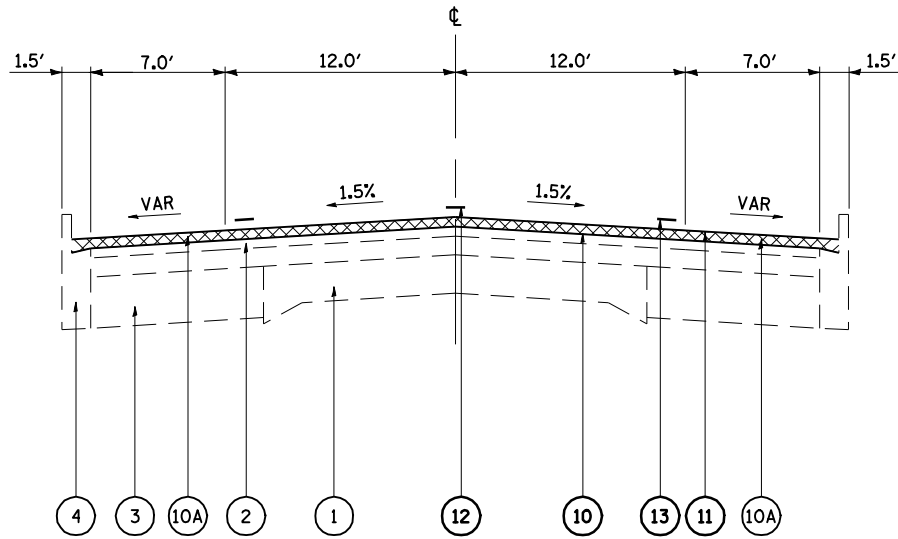

STA. 22+06.00 - 24+06.00
(CONGRESS STREET)

FILE NAME =	USER NAME = laughlinr1	DESIGNED -	REVISED -	STATE OF ILLINOIS DEPARTMENT OF TRANSPORTATION	TYPICAL SECTIONS			F.A.P. RTE.	SECTION	COUNTY	TOTAL SHEETS	SHEET NO.
es:\pwork\pwork\LAUGHLINRL\0177182\0672B40-ah-typical.dgn	DRAWN -	REVISED -	REVISED -		317	11RS-4 & (6CS)RS-4,I	SCHUYLER	8	17			
PLOT SCALE = 10.0000 ' / IN.	CHECKED -	REVISED -	REVISED -		CONTRACT NO. 72B40			ILLINOIS FED. AID PROJECT				
PLOT DATE = Mar-25-2010 04:01:42PM	DATE -	REVISED -	REVISED -		SCALE:	SHEET NO. 8 OF 17 SHEETS	STA.	TO STA.				

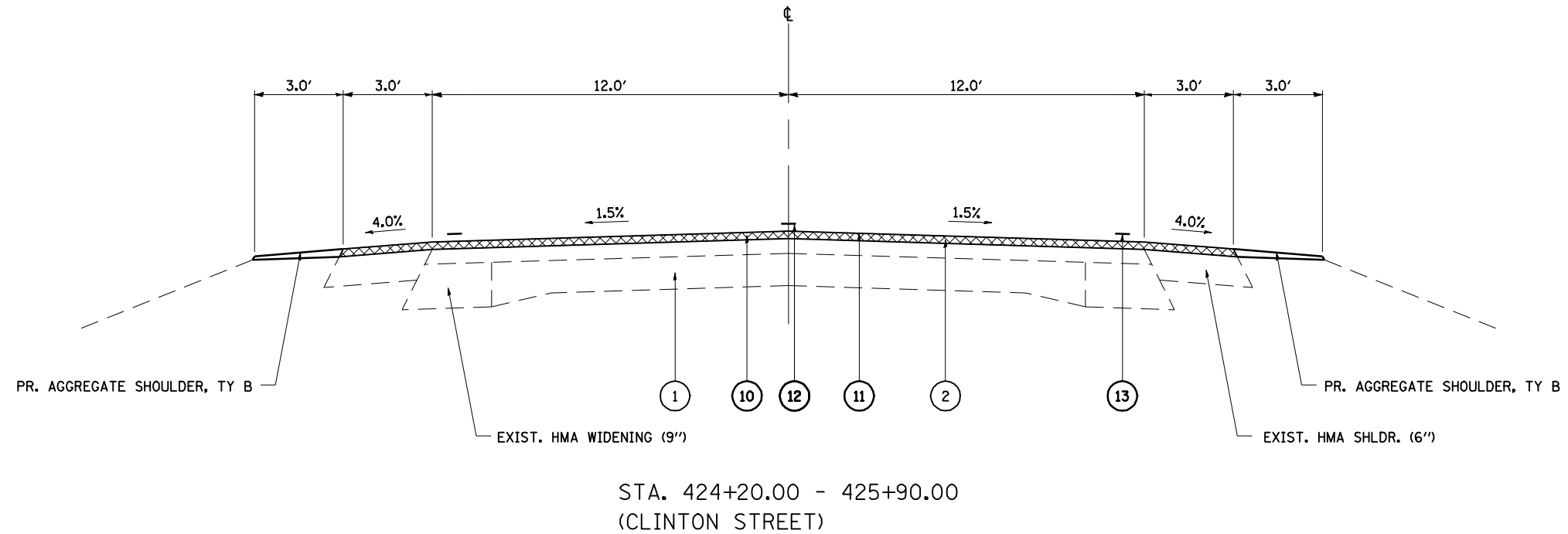

LEGEND

- ① EXISTING PCC PAVEMENT (9-6-9)
- ② EXISTING HOT-MIX ASPHALT SURFACE COURSE
- ③ EXISTING PCC WIDENING (8")
- ④ EXISTING CONCRETE CURB & GUTTER
- ⑤ EXISTING NATURAL CEMENT BASE (4")
- ⑥ EXISTING SAND CUSHION (1 1/2")
- ⑦ EXISTING BRICK ON EDGE
- ⑧ EXISTING SANDSTONE CURB
- ⑨ EXISTING OPEN-GRADED ASPHALT FRICTION COURSE
- ⑩ PROPOSED HOT-MIX ASPHALT SURFACE REMOVAL (2")
- ⑩A PROPOSED HOT-MIX ASPHALT SURFACE REMOVAL, VARIABLE DEPTH
- ⑪ PROPOSED HOT-MIX ASPHALT SURFACE COURSE, MIX "D" (2")
- ⑫ PROPOSED PREFORMED PLASTIC PAVEMENT MARKING, LINE, SKIP-DASH, YELLOW (5")
- ⑬ PROPOSED THERMOPLASTIC PAVEMENT MARKING, LINE, SOLID, WHITE (5")

••NOTE: MAINLINE OVERLAY THICKNESS 3/4" GREATER THAN PARKING LANE OVERLAY. MILL 2" ALONG GUTTER LINE AND VARY DEPTH OF MILLING ACROSS PARKING LANE TO MATCH MILLED DEPTH AT MAINLINE EDGE OF PAVEMENT.

FILE NAME =	USER NAME = laughlinr1	DESIGNED -	REVISED -
es:\pwork\PWIDOT\LAUGHLINRL\0177182\0672B40-ah-typical.dgn		DRAWN -	REVISED -
	PLOT SCALE = 10,0000 ' / IN.	CHECKED -	REVISED -
	PLOT DATE = Mar-25-2010 04:01:46PM	DATE -	REVISED -

**STATE OF ILLINOIS
DEPARTMENT OF TRANSPORTATION**

TYPICAL SECTIONS

SCALE: SHEET NO. 9 OF 17 SHEETS STA. TO STA.

F.A.P. RTE.	SECTION	COUNTY	TOTAL SHEETS	SHEET NO.
317	11RS-4 & (6CS)RS-4,I	SCHUYLER	9	17
CONTRACT NO. 72B40			ILLINOIS FED. AID PROJECT	

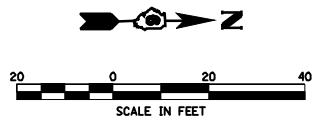

STATION EQUATION:
 STA. 425+26.91 (CLINTON ST. WEST) =
 STA. 9+35.00 (CLINTON ST. EAST) =
 STA. 100+00.00 (CONGRESS ST. SOUTH) =
 STA. 0+34.90 (CONGRESS ST. NORTH)

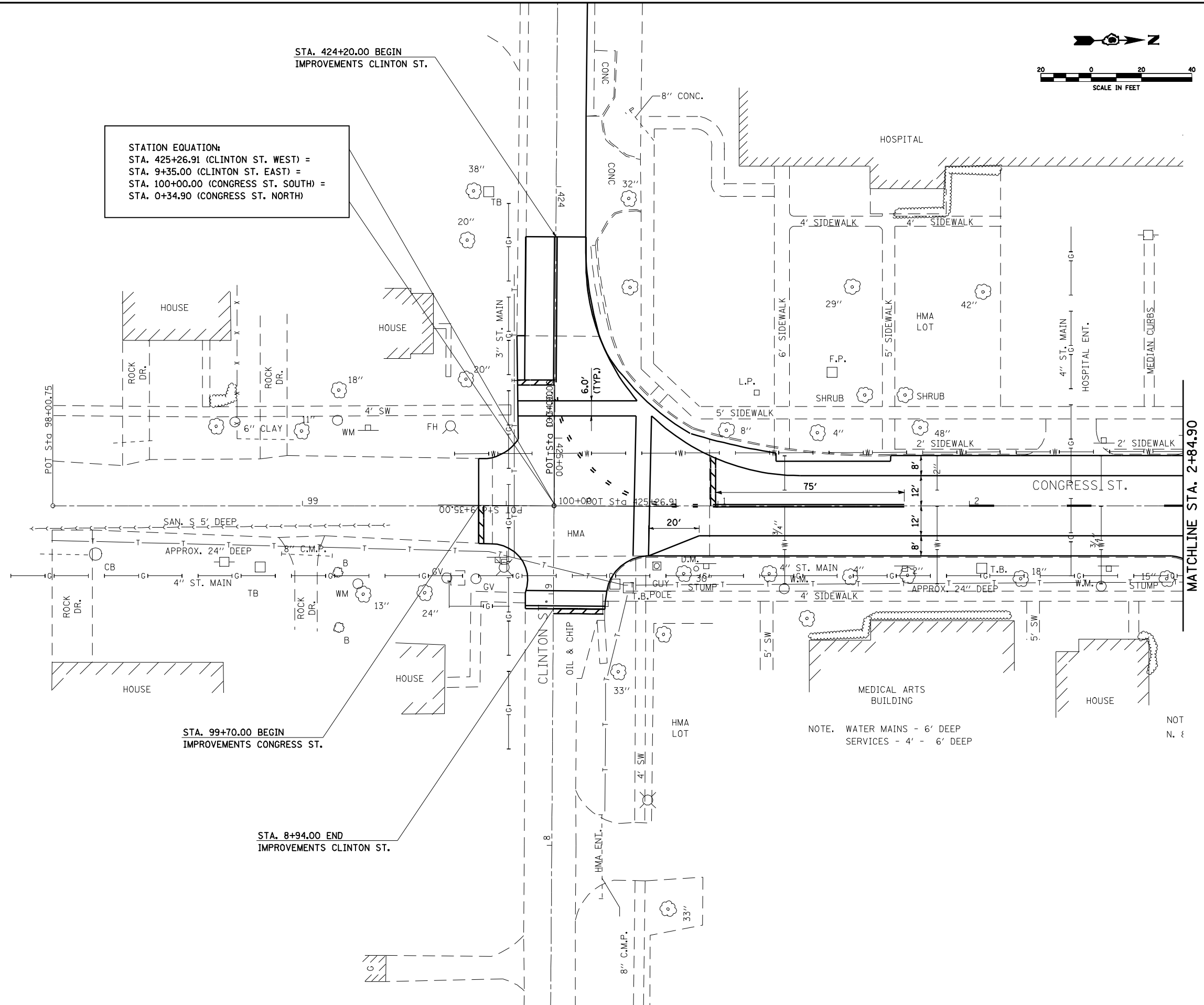

STA. 99+70.00 BEGIN
 IMPROVEMENTS CONGRESS ST.

STA. 8+94.00 END
 IMPROVEMENTS CLINTON ST.

NOTE. WATER MAINS - 6' DEEP
 SERVICES - 4' - 6' DEEP

NOT
 N. E

FILE NAME =	USER NAME = laughlinr1	DESIGNED -	REVISED -
e:\pwork\pwork\LAUGHLINRL\0177182\0672b40-SHT-plan6.dgn		DRAWN -	REVISED -
	PLOT SCALE = 40.0000 ' / IN.	CHECKED -	REVISED -
	PLOT DATE = Mar-25-2010 04:01:48PM	DATE -	REVISED -

**STATE OF ILLINOIS
 DEPARTMENT OF TRANSPORTATION**

PLAN SHEET - US 24

SCALE: SHEET NO. 10 OF 17 SHEETS STA. TO STA.

F.A.P. RTE.	SECTION	COUNTY	TOTAL SHEETS	SHEET NO.
317	11RS-4 & (6CS)RS-4,I	SCHUYLER	10	17
CONTRACT NO. 72B40			ILLINOIS FED. AID PROJECT	

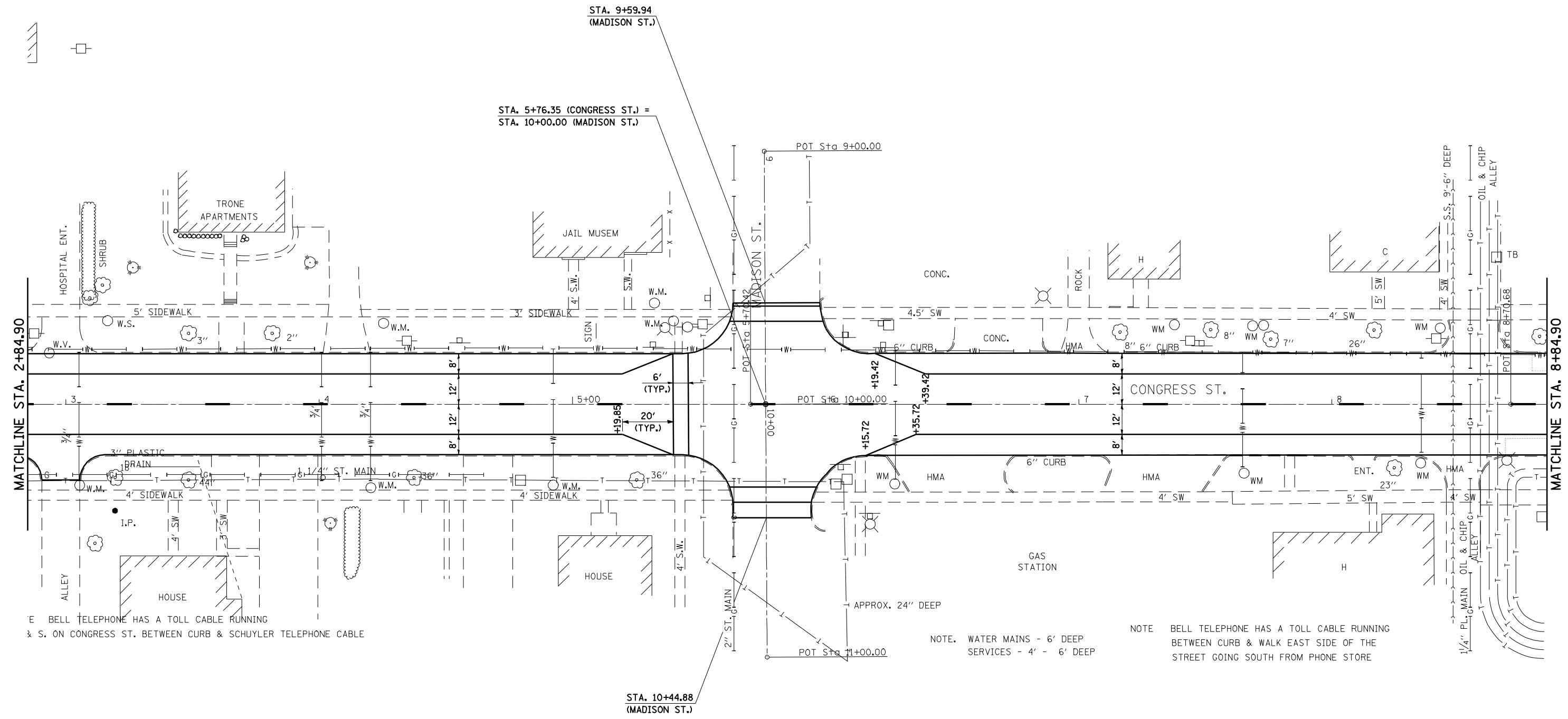
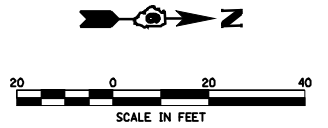

E BELL TELEPHONE HAS A TOLL CABLE RUNNING
 3' S. ON CONGRESS ST. BETWEEN CURB & SCHUYLER TELEPHONE CABLE

NOTE. WATER MAINS - 6' DEEP
 SERVICES - 4' - 6' DEEP

NOTE BELL TELEPHONE HAS A TOLL CABLE RUNNING
 BETWEEN CURB & WALK EAST SIDE OF THE
 STREET GOING SOUTH FROM PHONE STORE

FILE NAME =	USER NAME = laughlinr1	DESIGNED -	REVISED -
e:\pwork\PWIDOT\LAUGHLINRL\0177182\0672b40-SHT-plan6.dgn		DRAWN -	REVISED -
PLOT SCALE = 40.0000' / IN.		CHECKED -	REVISED -
PLOT DATE = Mar-25-2010 04:01:51PM		DATE -	REVISED -

**STATE OF ILLINOIS
 DEPARTMENT OF TRANSPORTATION**

PLAN SHEET - US 24

SCALE: SHEET NO. 11 OF 17 SHEETS STA. TO STA.

F.A.P. RTE.	SECTION	COUNTY	TOTAL SHEETS	SHEET NO.
317	11RS-4 & (6CS)RS-4,I	SCHUYLER	11	17
CONTRACT NO. 72B40			ILLINOIS FED. AID PROJECT	



STA. 11+29.13 (CONGRESS ST.) =
STA. 10+00.00 (LAFAYETTE ST.)

STA. 14+46.48 (CONGRESS ST.) =
STA. 10+00.00 (WASHINGTON ST.)

NOTE. WATER MAINS - 6' DEEP
SERVICES - 4' - 6' DEEP

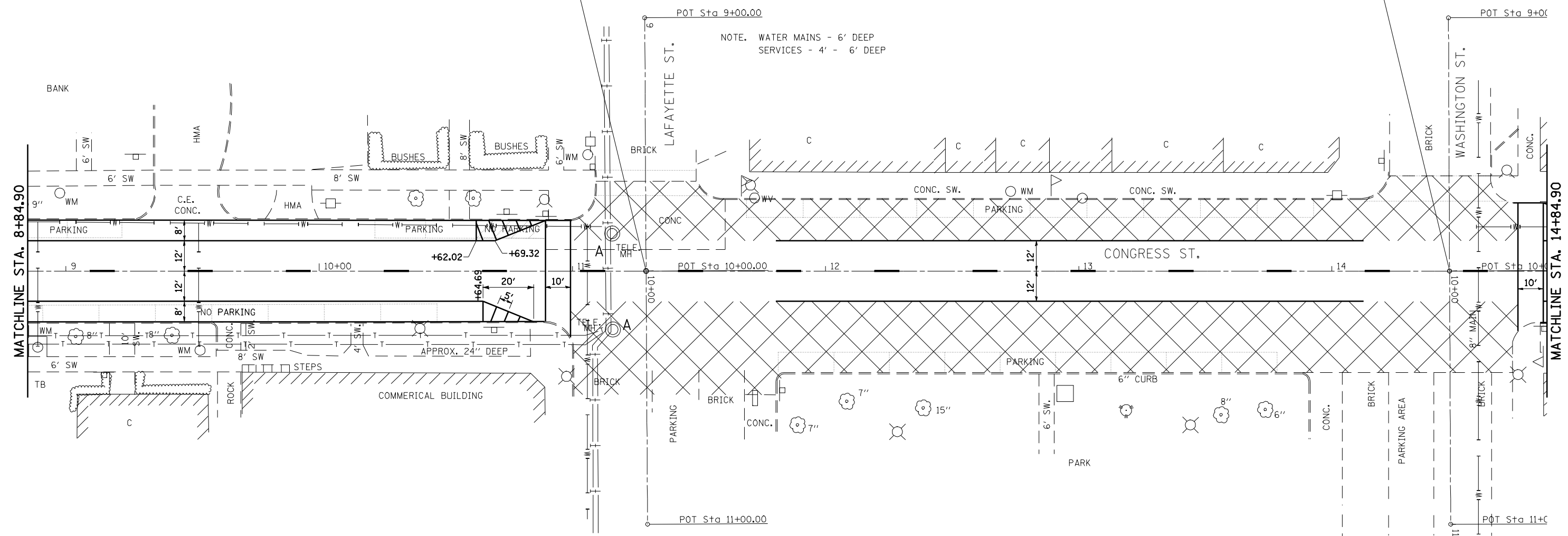

LEGEND

 LOCAL PROJECT
TO BE CONSTRUCTED BY OTHERS

FILE NAME =	USER NAME = laughlinr1	DESIGNED -	REVISED -
e:\pwwork\pwidot\LAUGHLINRL\0177182\0672b40-SHT-plan6.dgn		DRAWN -	REVISED -
PLOT SCALE = 40.0000 ' / IN.		CHECKED -	REVISED -
PLOT DATE = Mar-25-2010 04:01:53PM		DATE -	REVISED -

**STATE OF ILLINOIS
DEPARTMENT OF TRANSPORTATION**

PLAN SHEET - US 24

SCALE: SHEET NO. 12 OF 17 SHEETS STA. TO STA.

F.A.P. RTE.	SECTION	COUNTY	TOTAL SHEETS	SHEET NO.
317	11RS-4 & (6CS)RS-4,I	SCHUYLER	12	17
CONTRACT NO. 72B40				
ILLINOIS FED. AID PROJECT				

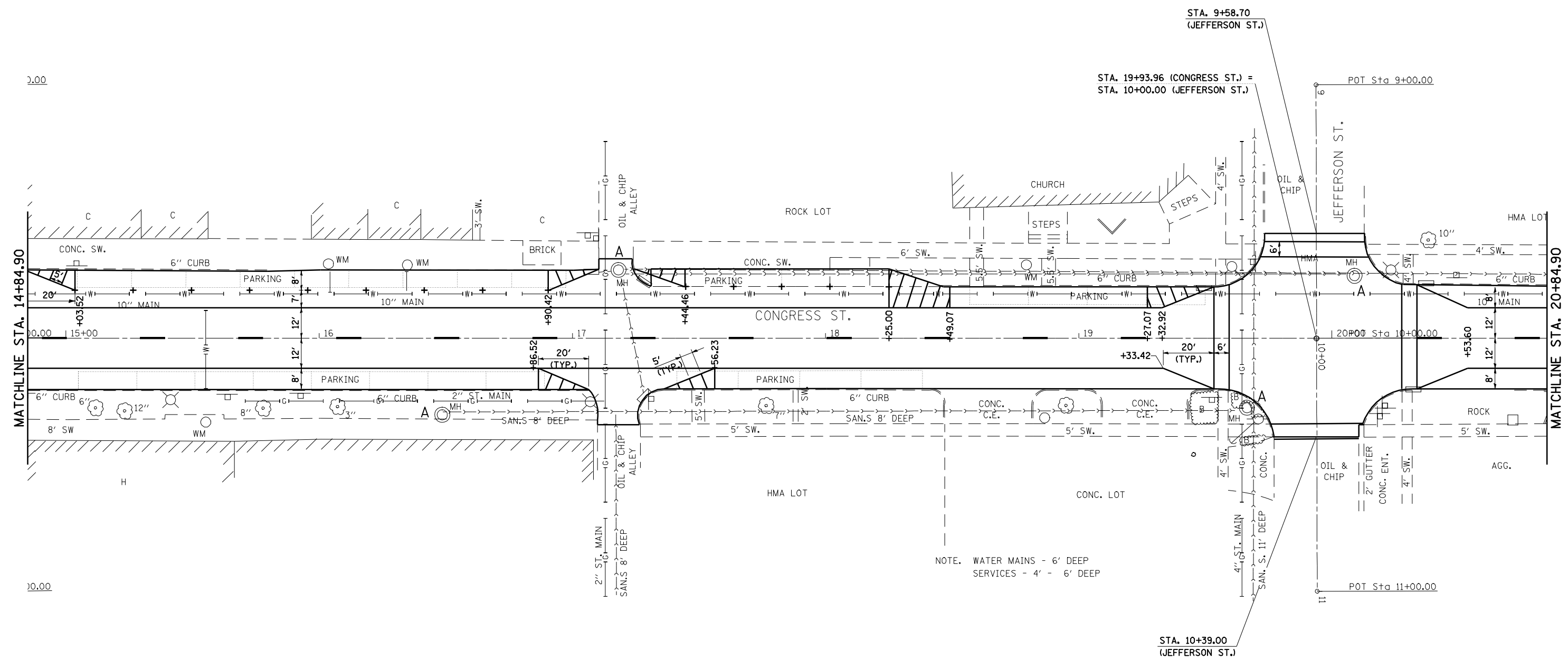
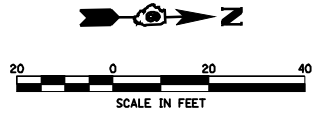

NOTE. WATER MAINS - 6' DEEP
SERVICES - 4' - 6' DEEP

FILE NAME =	USER NAME = laughlinr1	DESIGNED -	REVISED -
er:\pwork\PWIDOT\LAUGHLINRL\0177182\0672b40-SHT-plan6.dgn		DRAWN -	REVISED -
PLOT SCALE = 40.0000' / IN.		CHECKED -	REVISED -
PLOT DATE = Mar-25-2010 04:01:56PM		DATE -	REVISED -

**STATE OF ILLINOIS
DEPARTMENT OF TRANSPORTATION**

PLAN SHEET - US 24

SCALE: SHEET NO. 13 OF 17 SHEETS STA. TO STA.

F.A.P. RTE.	SECTION	COUNTY	TOTAL SHEETS	SHEET NO.
317	11RS-4 & (6CS)RS-4,I	SCHUYLER	13	17
CONTRACT NO. 72B40			ILLINOIS FED. AID PROJECT	

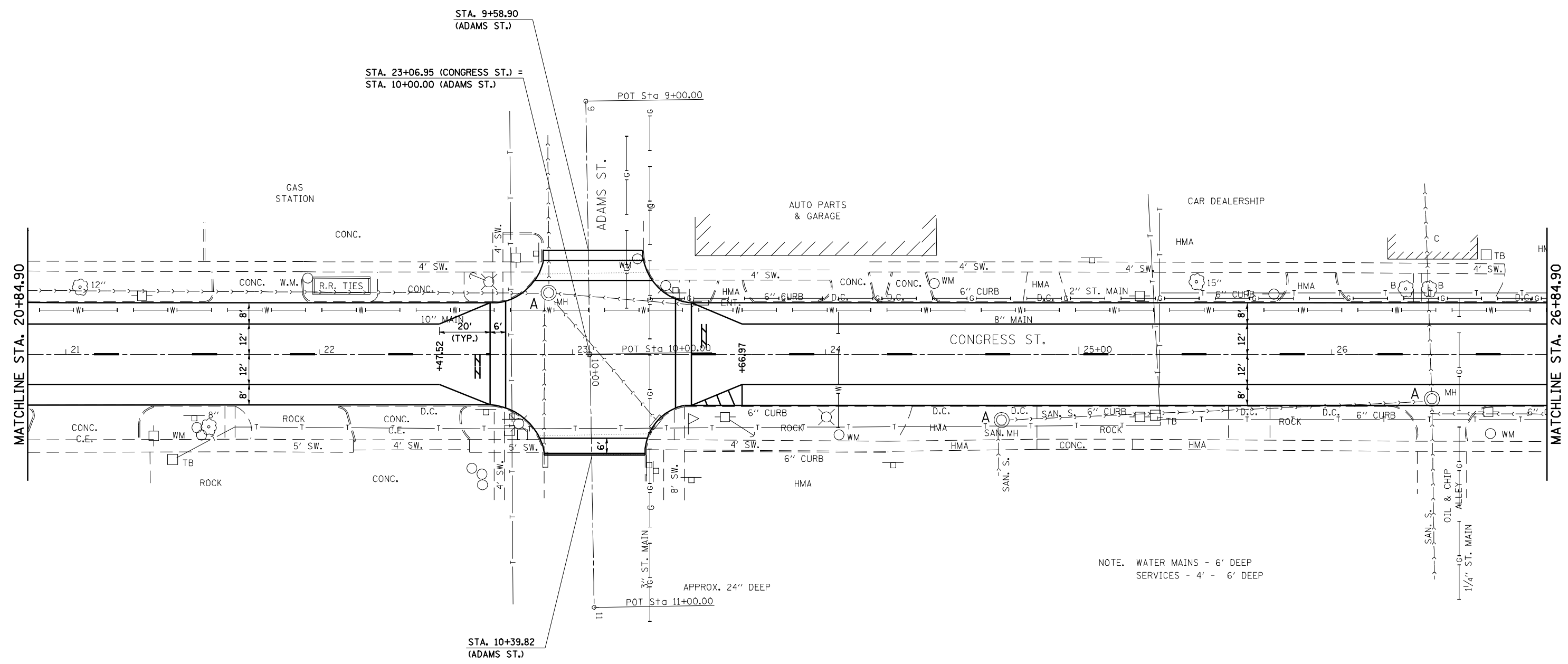
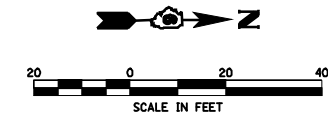

NOTE. WATER MAINS - 6' DEEP
SERVICES - 4' - 6' DEEP

FILE NAME =	USER NAME = laughlinr1	DESIGNED -	REVISED -
e:\pwwork\pwidot\LAUGHLINRL\d0177182\0672b40-SHT-plan6.dgn		DRAWN -	REVISED -
PLOT SCALE = 40.0000 ' / IN.		CHECKED -	REVISED -
PLOT DATE = Mar-25-2010 04:01:58PM		DATE -	REVISED -

**STATE OF ILLINOIS
DEPARTMENT OF TRANSPORTATION**

PLAN SHEET - US 24			
SCALE:	SHEET NO. 14 OF 17 SHEETS	STA.	TO STA.

F.A.P. RTE.	SECTION	COUNTY	TOTAL SHEETS	SHEET NO.
317	11RS-4 & (6CS)RS-4,I	SCHUYLER	14	17
CONTRACT NO. 72B40				
ILLINOIS FED. AID PROJECT				

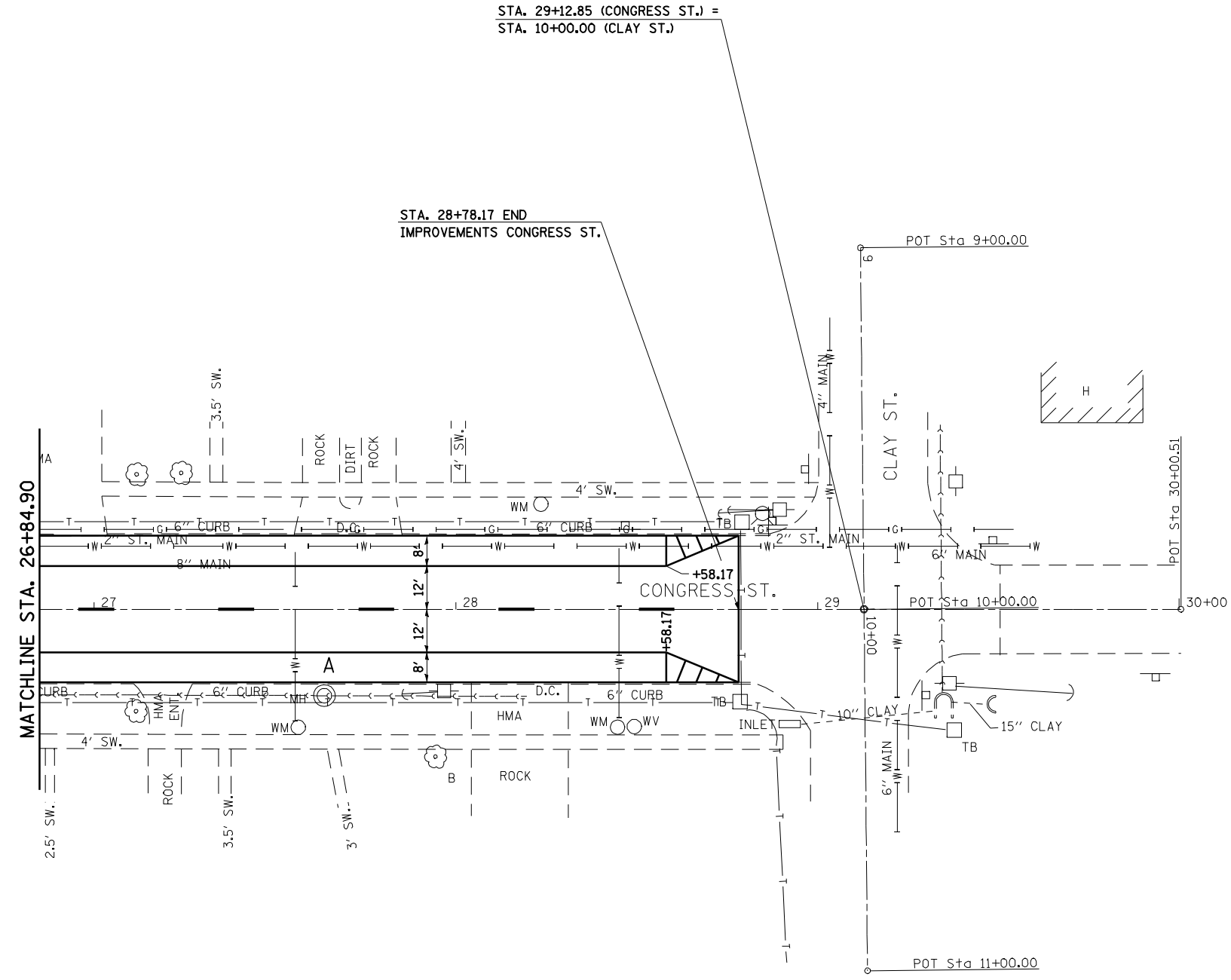
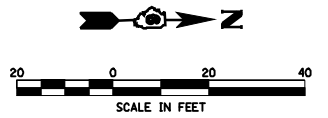

**STATE OF ILLINOIS
DEPARTMENT OF TRANSPORTATION**

PLAN SHEET - US 24

SCALE: SHEET NO. 15 OF 17 SHEETS STA. TO STA.

F.A.P. RTE.	SECTION	COUNTY	TOTAL SHEETS	SHEET NO.
317	1IRS-4 & (6CS)RS-4,I	SCHUYLER	15	17
CONTRACT NO. 72B40			ILLINOIS FED. AID PROJECT	

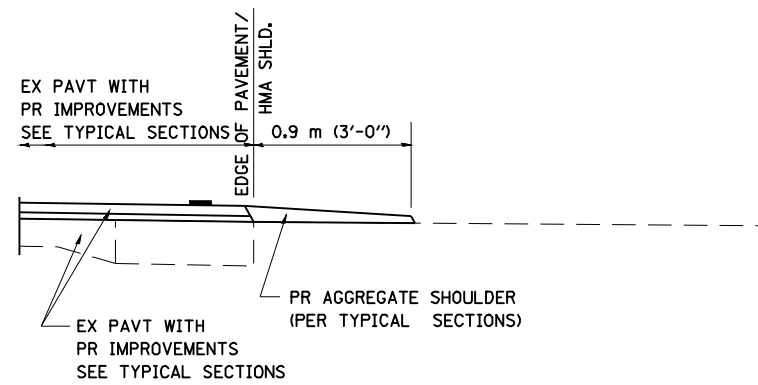

SECTION A-A FOR EX EARTH/AGGREGATE FE

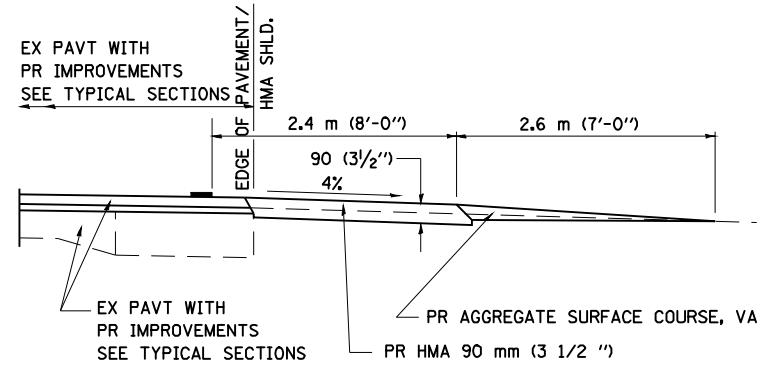

SECTION A-A FOR EX EARTH/AGGREGATE PE

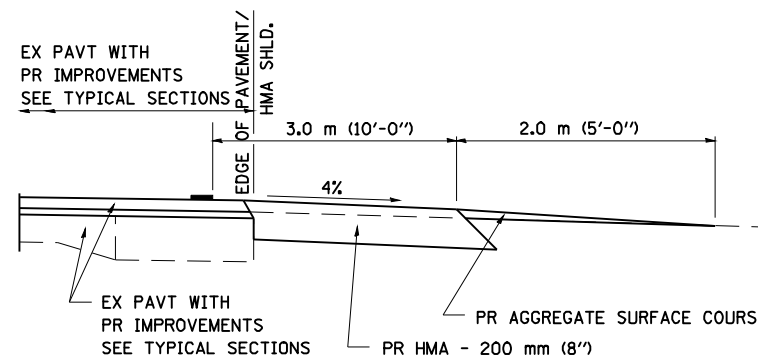

SECTION A-A FOR EX EARTH/AGGREGATE CE & SIDE ROAD

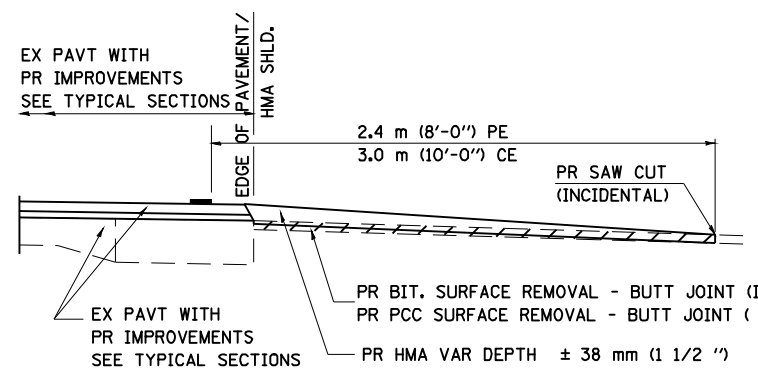

SECTION A-A FOR EX BITUMINOUS/PC CONCRETE PE, CE & SIDE ROAD

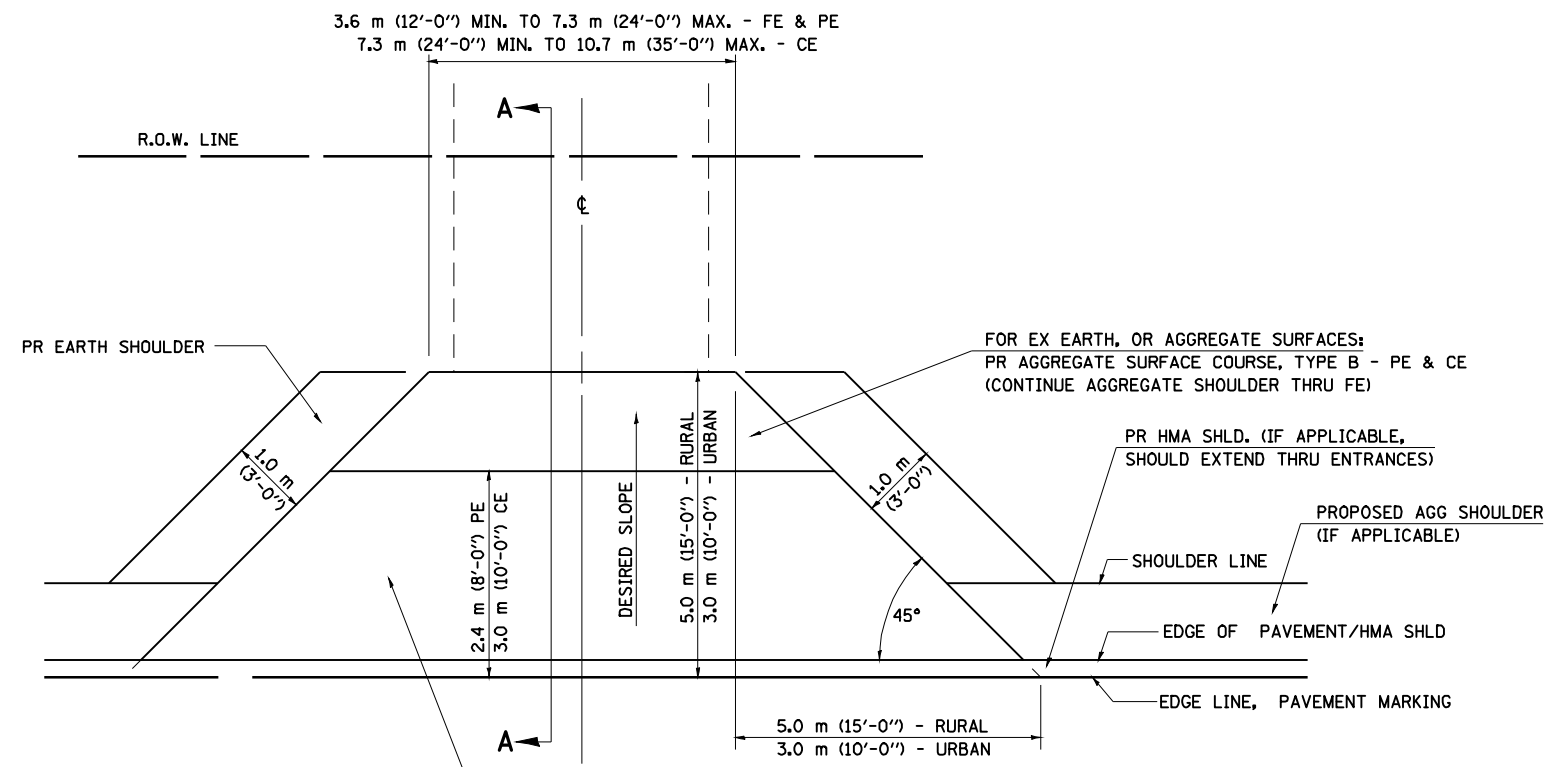

FOR EX EARTH OR AGGREGATE SURFACES:
 PR BIT SURFACE REMOVAL (IF APPLICABLE)
 PR AGGREGATE SHOULDER THRU - FE
 PR BITUMINOUS CONCRETE 90 mm (3 1/2") - PE
 PR BITUMINOUS CONCRETE 200mm (8") - CE

FOR EX BITUMINOUS CONCRETE SURFACES:
 PR BITUMINOUS SURFACE REMOVAL-BUTT JOINT

FOR EX PCC SURFACES:
 PR PCC SURFACE REMOVAL-BUTT JOINT

GENERAL NOTES:

THE RESIDENT ENGINEER WILL DETERMINE THE EXACT TYPE OF IMPROVEMENT TO BE COMPLETED FOR ALL ENTRANCES, SIDEROADS AND MAILBOX TURNOUTS ON THIS PROJECT.

THE PLAN DETAILS AND SCHEDULES SHOULD BE USED AS A GUIDE FOR THE ENGINEER TO IMPLEMENT THE FINAL DESIGN. THE ENGINEER MAY DECIDE TO SALVAGE PORTIONS OF THE EXISTING ENTRANCE PAVEMENT STRUCTURE; THEREFORE, REDUCING PAY ITEM QUANTITIES. NO ADDITIONAL PAYMENT WILL BE ALLOWED FOR THIS REDUCTION IN QUANTITIES.

ANY WORK THE ENGINEER REQUIRES WHICH IS NOT COVERED BY A PAY ITEM CONTAINED IN THE PLANS WILL BE PAID FOR IN ACCORDANCE WITH ARTICLE 109.04 OF THE STANDARD SPECIFICATIONS.

BITUMINOUS CONCRETE REQUIRED TO CONSTRUCT THE ENTRANCES SHALL BE IN ACCORDANCE WITH THE APPLICABLE PORTIONS OF SECTION 406 AND 408 OF THE STANDARD SPECIFICATIONS AND AS DIRECTED BY THE ENGINEER.

WHEN THE BITUMINOUS CONCRETE PROPOSED FOR THE IMPROVEMENT IS THICKER THAN 75 mm (3 INCHES) AND REQUIRE PLACEMENT IN MORE THAN ONE LIFT. THE BOTTOM LIFT(S) SHALL MEET THE REQUIREMENTS OF BITUMINOUS BASE COURSE IN SECTION 406 OF THE STANDARD SPECIFICATIONS AND THE TOP LIFT OF 50 mm (2 INCHES) SHALL MEET THE REQUIREMENTS OF BITUMINOUS CONCRETE SURFACE COURSE, SUPERPAVE.

THIS WORK WILL BE PAID FOR IN ACCORDANCE WITH SECTIONS 351, 358, 408, 423 AND 440 OF THE STANDARD SPECIFICATIONS.

ALL DIMENSIONS ARE IN MILLIMETERS (INCHES) UNLESS OTHERWISE SHOWN.

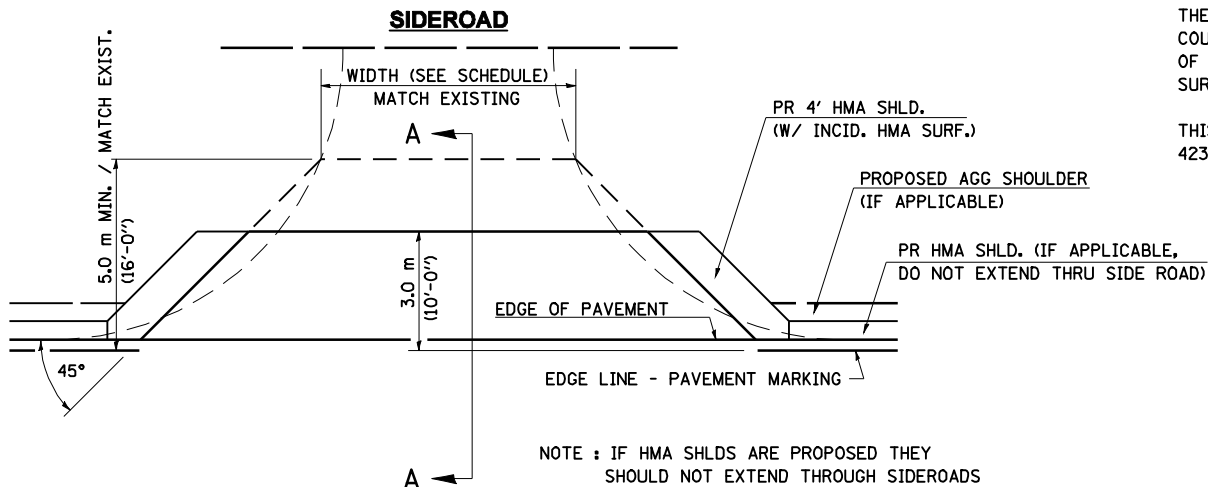

NOTE : IF HMA SHLDS ARE PROPOSED THEY SHOULD NOT EXTEND THROUGH SIDEROADS

FILE NAME =	USER NAME = laughlinr1	DESIGNED -	REVISED - 2/19/03 JCN	STATE OF ILLINOIS DEPARTMENT OF TRANSPORTATION	DIST. 6 DETAILS FOR RURAL/URBAN ENT., MAILBOX TURNOUT & SIDEROADS W/O CONC. GUTTER (3P-PROJ.)	F.A.P. RTE.	SECTION	COUNTY	TOTAL SHEETS	SHEET NO.
es:\pwwork\pwwid01\LAUGHLINRL\0177182\0672840-shl-ent-ppp.dgn	DRAWN - CADD	REVISED - 4/01/04 JCN	317			11RS-4 & (6CS)RS-4, I	SCHUYLER	16	17	
PLOT SCALE = 48,000 ' / IN.	CHECKED - JCN	REVISED -	CONTRACT NO. 72B40							
PLOT DATE = Mar-25-2010 04:02:03PM	DATE - FEBRUARY 23, 1999	REVISED -	FED. ROAD DIST. NO.			ILLINOIS	FED. AID PROJECT			

DETAILS OF MAILBOX TURNOUTS

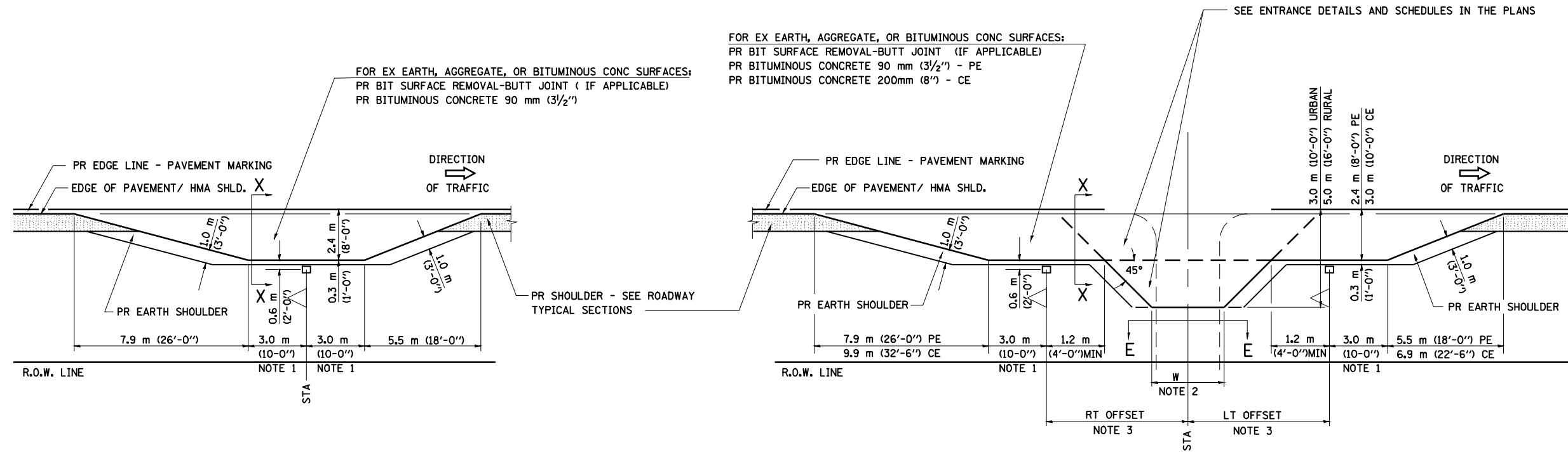

PLAN - MAILBOX TURNOUTS

PLAN - COMBINED MAILBOX TURNOUT WITH TRAILING OR LEADING ENTRANCE

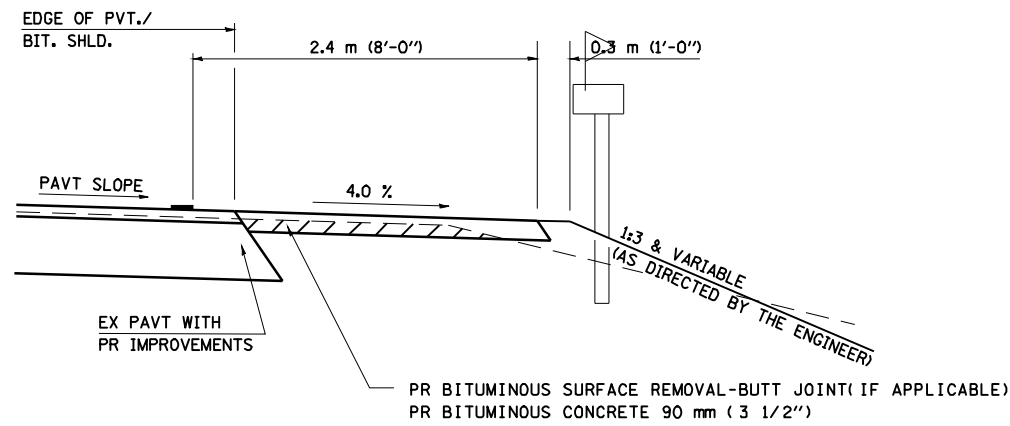

**SECTION X-X THRU MAILBOX TURNOUT
ALSO APPLIES TO MAILBOX TURNOUTS COMBINED WITH
EX EARTH, AGGREGATE, OR BITUMINOUS PE & FE**

(DETAIL APPLIES WHEN M.B. TURNOUT DOES NOT EXIST.
IF EXISTING, TREAT SAME AS ENTRANCE.)

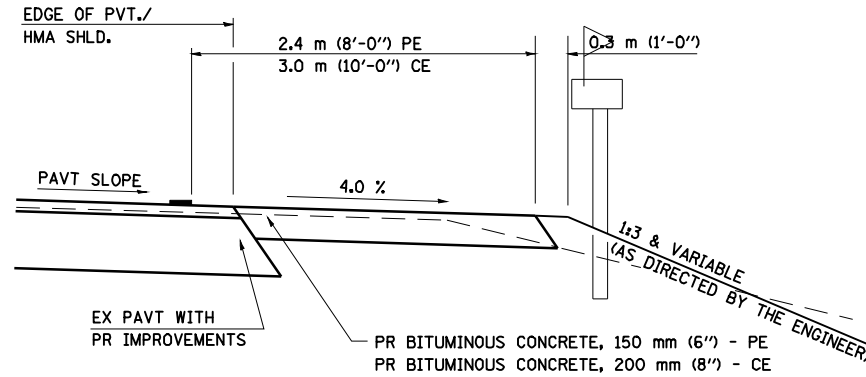

**SECTION X-X THRU MAILBOX TURNOUT
COMBINED WITH EX BITUMINOUS CONC & PC CONC PE & CE**

(DETAIL APPLIES WHEN M.B. TURNOUT DOES NOT EXIST.
IF EXISTING, TREAT SAME AS ENTRANCE.)

- NOTE 1 IF MORE THAN ONE MAILBOX IS PRESENT, DIMENSION FROM CENTER OF END MAILBOX.
- NOTE 2 FOR ENTRANCE LAYOUT DIMENSIONS AND SECTIONS A-A & E-E REFER TO THE SCHEDULES IN THE PLANS.
- NOTE 3 BOTH LT OR RT OFFSETS FOR MAILBOX SHOWN USE OFFSET DIMENSION PER SCHEDULE AND REFER TO LAYOUT SHOWN ON THE PLAN.

ALL DIMENSIONS ARE IN MILLIMETERS (INCHES)
UNLESS OTHERWISE SHOWN.

FILE NAME =	USER NAME = laughlinr1	DESIGNED -	REVISED - 2/19/03 JCN
ENT PPP.DGN	es:\pwwork\pwwid\LAUGHLINRL\0177182\0672840-ent-ent.ppp.dgn	DRAWN - CADD	REVISED - 4/01/04 JCN
	PLOT SCALE = 48.000' / IN.	CHECKED - JCN	REVISED -
	PLOT DATE = Mar-25-2010 04:02:05PM	DATE - FEBRUARY 23, 1999	REVISED -

**STATE OF ILLINOIS
DEPARTMENT OF TRANSPORTATION**

**DIST. 6 DETAILS FOR RURAL/URBAN ENT., MAILBOX
TURNOUT & SIDEROADS W/O CONC. GUTTER (3P-PROJ.)**

SCALE: SHEET NO. 17 OF 17 SHEETS STA. TO STA.

F.A.P. RTE.	SECTION	COUNTY	TOTAL SHEETS	SHEET NO.
317	11RS-4 & (6CS)RS-4, I	SCHUYLER	17	17
CONTRACT NO. 72B40				
FED. ROAD DIST. NO. ILLINOIS FED. AID PROJECT				