

STATE OF ILLINOIS  
DEPARTMENT OF TRANSPORTATION  
DIVISION OF HIGHWAYS

F.A.P. RTE.	SECTION	COUNTY	TOTAL SHEETS	SHEET NO.
745	105RS-7, 106RS-5	ADAMS	47	1
		ILLINOIS	CONTRACT NO. 72B86	

FOR INDEX OF SHEETS, SEE SHEET NO. 2

**IDOT HIGHWAY STANDARDS**

000001-05	630301-05	701306-02
442101-07	635006-03	701326-03
601001-03	635011-02	701501-05
601101-01	701006-03	701901-01
606101-04	701011-02	780001-02
630001-08	701201-03	781001-03
	701301-03	

**PROPOSED  
HIGHWAY PLANS**

F.A.P. ROUTE 745 (IL 104)  
SECTION 105RS-7, 106RS-5

3P RESURFACING  
ADAMS COUNTY

C-96-049-08

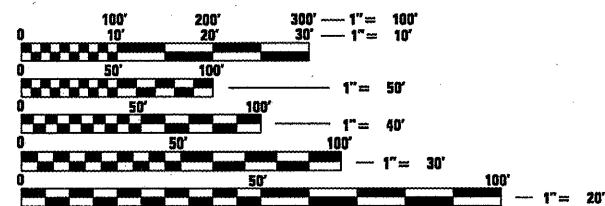
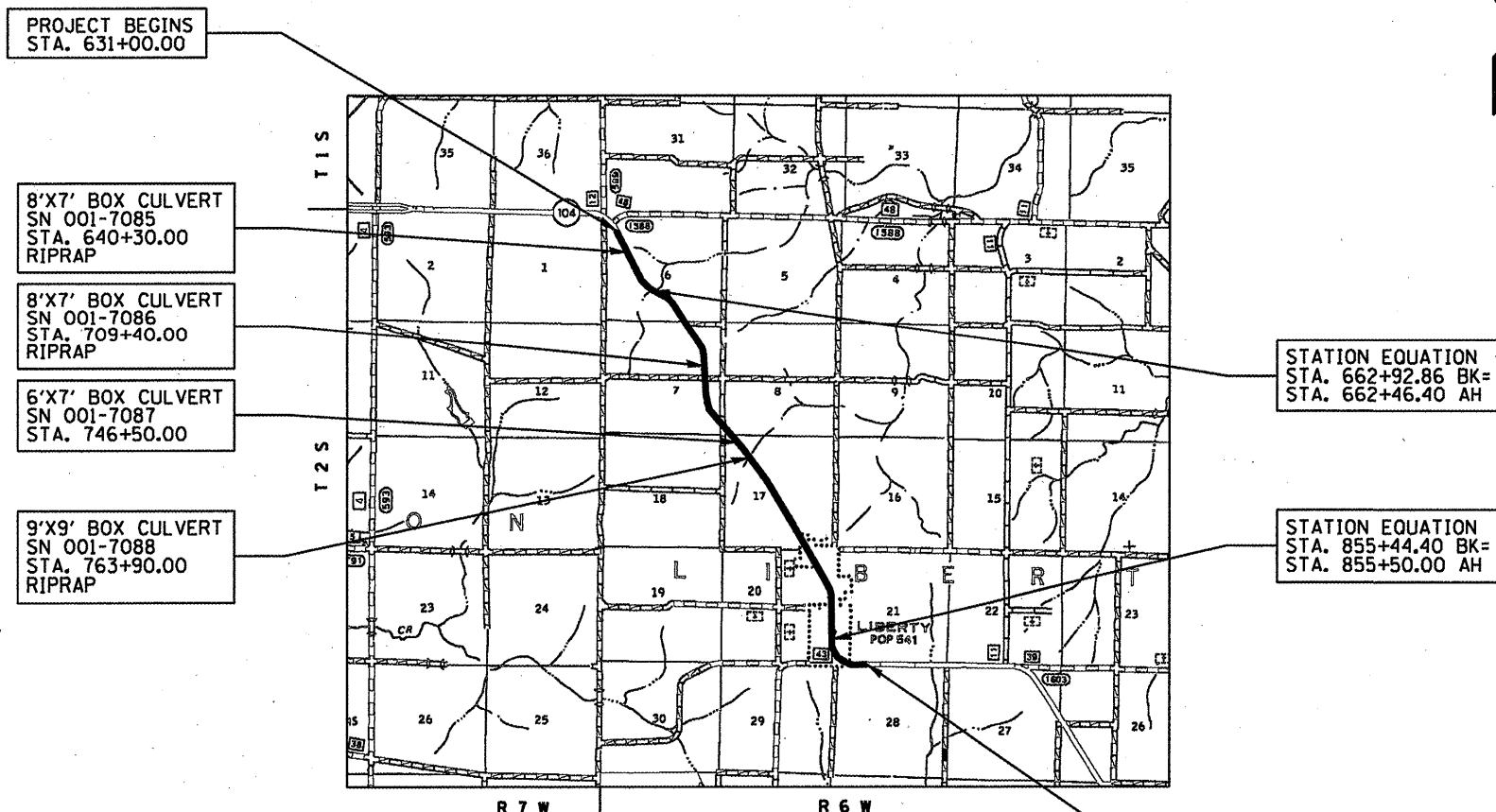
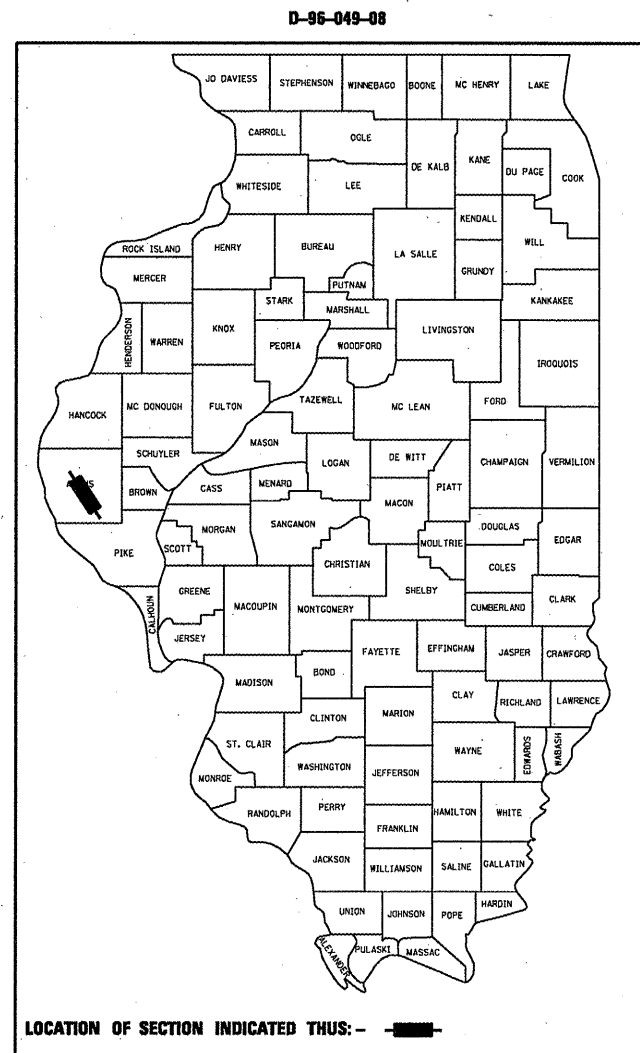

FULL SIZE PLANS HAVE BEEN PREPARED USING STANDARD ENGINEERING SCALES. REDUCED SIZED PLANS WILL NOT CONFORM TO STANDARD SCALES. IN MAKING MEASUREMENTS ON REDUCED PLANS, THE ABOVE SCALES MAY BE USED.

J.U.L.I.E.  
JOINT UTILITY LOCATION INFORMATION FOR EXCAVATION  
1-800-892-0123  
OR 811

PROJECT ENGINEER: JOHN NEGANGARD (217) 782-6990  
TEAM LEADER: MARK DUST (217) 785-0597

CONTRACT NO. 72B86

GROSS LENGTH = 24490.86 FT. = 4.638 MILE  
NET LENGTH = 24490.86 FT. = 4.638 MILE  
HIGHWAY CLASSIFICATION = MINOR ARTERIAL  
ADT = 2183 (2007)  
PV = 1875 (85.9%)  
SU = 188 (8.6%)  
MU = 120 (5.5%)

PAVING ENDS  
STA. 875+50.00

STATE OF ILLINOIS  
DEPARTMENT OF TRANSPORTATION  
DIVISION OF HIGHWAYS

SUBMITTED April 10 2010  
Ray D. Dick  
DEPUTY DIRECTOR OF HIGHWAYS, REGION ENGINEER

May 7 2010  
Scott E. Stitt, P.E., Inc.  
acting ENGINEER OF DESIGN AND ENVIRONMENT

May 7 2010  
Christine M. Reed, Inc.  
DIRECTOR OF HIGHWAYS, CHIEF ENGINEER

**PRINTED BY THE AUTHORITY  
OF THE STATE OF ILLINOIS**