

F.A.U. SHEETS	SECTION	COUNTY	TOTAL SHEETS	SHEET NO.
8139	(30,J)RS-3	MACOUPIN	45	1
		ILLINOIS	CONTRACT NO. 72C18	

**STATE OF ILLINOIS**  
**DEPARTMENT OF TRANSPORTATION**  
**DIVISION OF HIGHWAYS**

**PROPOSED**  
**HIGHWAY PLANS**

**FAU ROUTE 8139 (IL RTE 4)**  
**SECTION (30,J)RS-3**

**RESURFACING**  
**MACOUPIN COUNTY**

C-96-093-08

FOR INDEX OF SHEETS, SEE SHEET NO. 2

<b>ADT (MIN.)</b>	<b>ADT (MAX.)</b>
<b>3,850 (2007)</b>	<b>7,200 (2007) MAX</b>
<b>MU = 80 (2.1%)</b>	<b>MU = 125 (1.7%)</b>
<b>SU = 70 (1.8%)</b>	<b>SU = 200 (2.8%)</b>

D-96-093-08

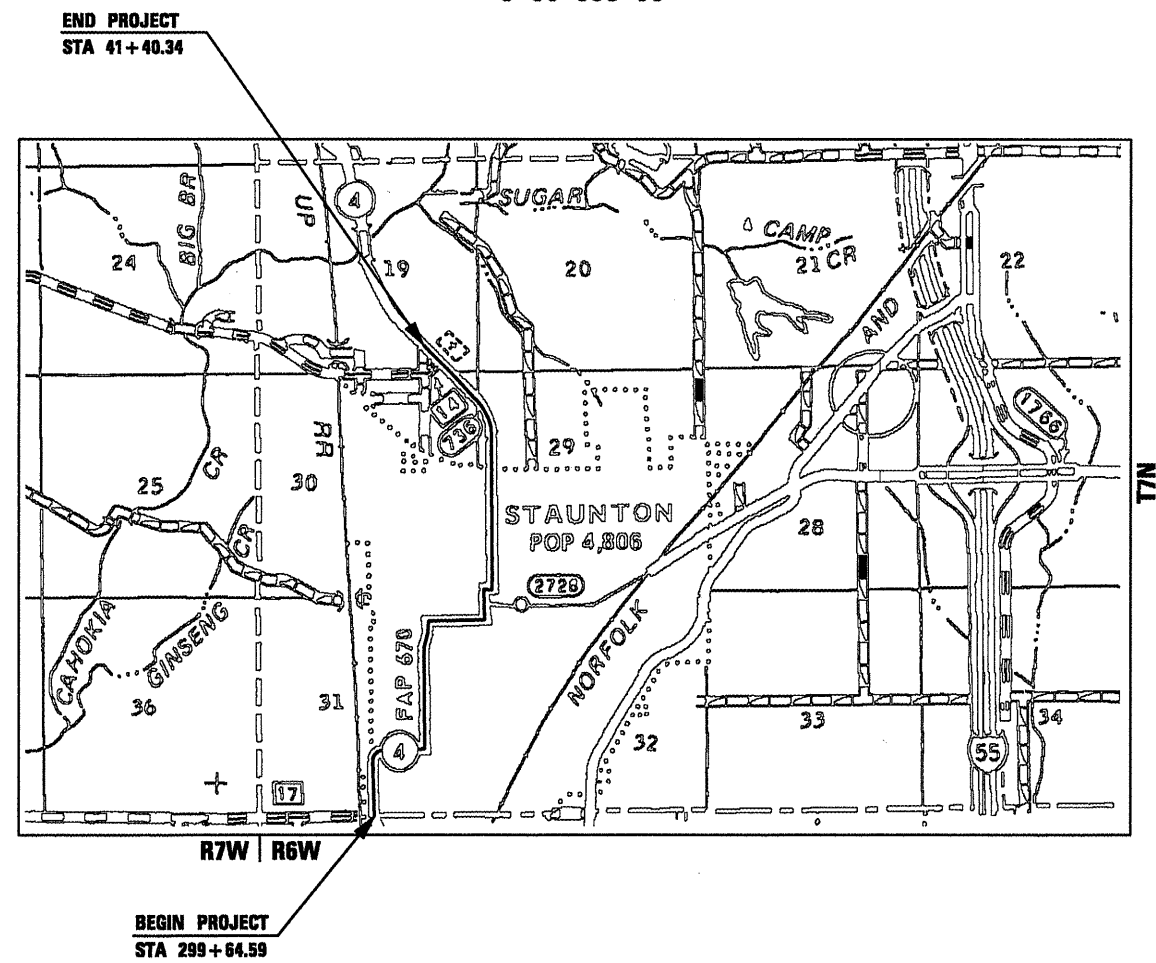
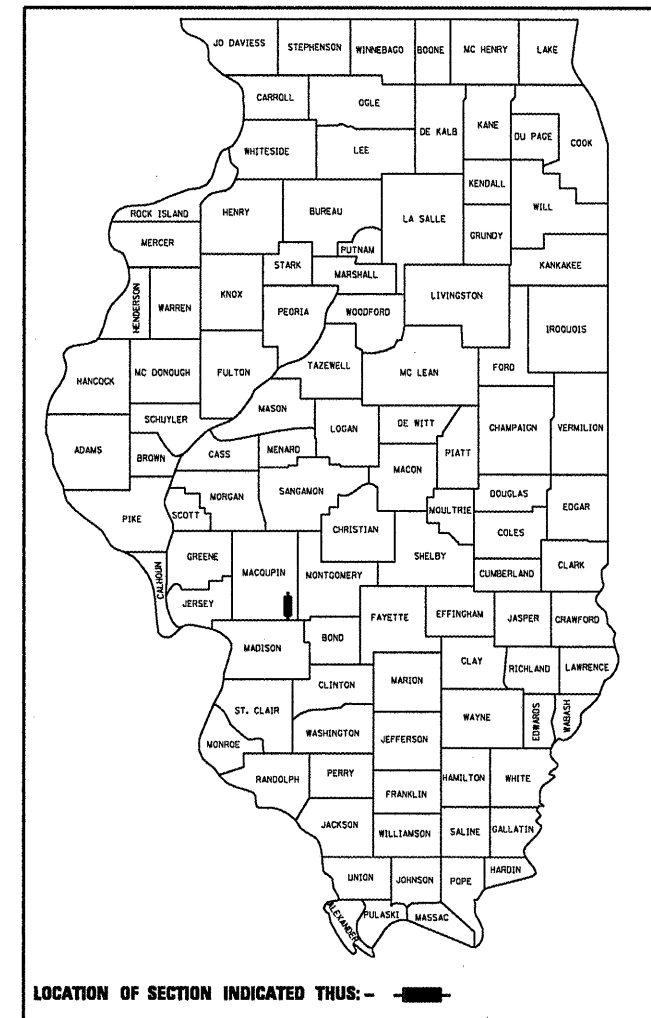

**LOCATION MAP**

NET LENGTH = 14,944 FT. = 2.83 MILES

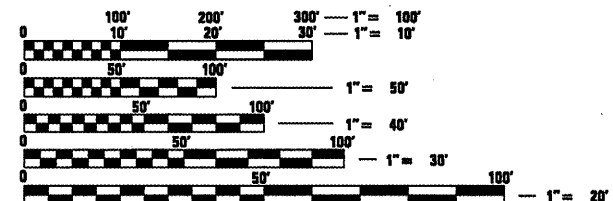

FULL SIZE PLANS HAVE BEEN PREPARED USING STANDARD ENGINEERING SCALES. REDUCED SIZED PLANS WILL NOT CONFORM TO STANDARD SCALES. IN MAKING MEASUREMENTS ON REDUCED PLANS, THE ABOVE SCALES MAY BE USED.

J.U.L.I.E.  
 JOINT UTILITY LOCATION INFORMATION FOR EXCAVATION  
 1-800-892-0123  
 OR 811

**PROJECT ENGINEER JOHN NEGANGARD (217) 782-6990**  
**TEAM ENGINEER MARK DUST (217) 785-0597**

**CONTRACT NO. 72C18**

**STATE OF ILLINOIS**  
**DEPARTMENT OF TRANSPORTATION**  
**DIVISION OF HIGHWAYS**

SUBMITTED April 13 2010  
Les Z. Paul  
 DEPUTY DIRECTOR OF HIGHWAYS, REGION ENGINEER  
May 7 2010  
Scott E. Stitt P.E. /sc  
 ENGINEER OF DESIGN AND ENVIRONMENT  
May 7 2010  
Christine M. Reed /sc  
 DIRECTOR OF HIGHWAYS, CHIEF ENGINEER

**PRINTED BY THE AUTHORITY**  
**OF THE STATE OF ILLINOIS**