

SEE INTERSECTION
DETAILS

STA 554+52.166 IL 29 (E104) =
STA 199+52.078 IL 4 (E205)

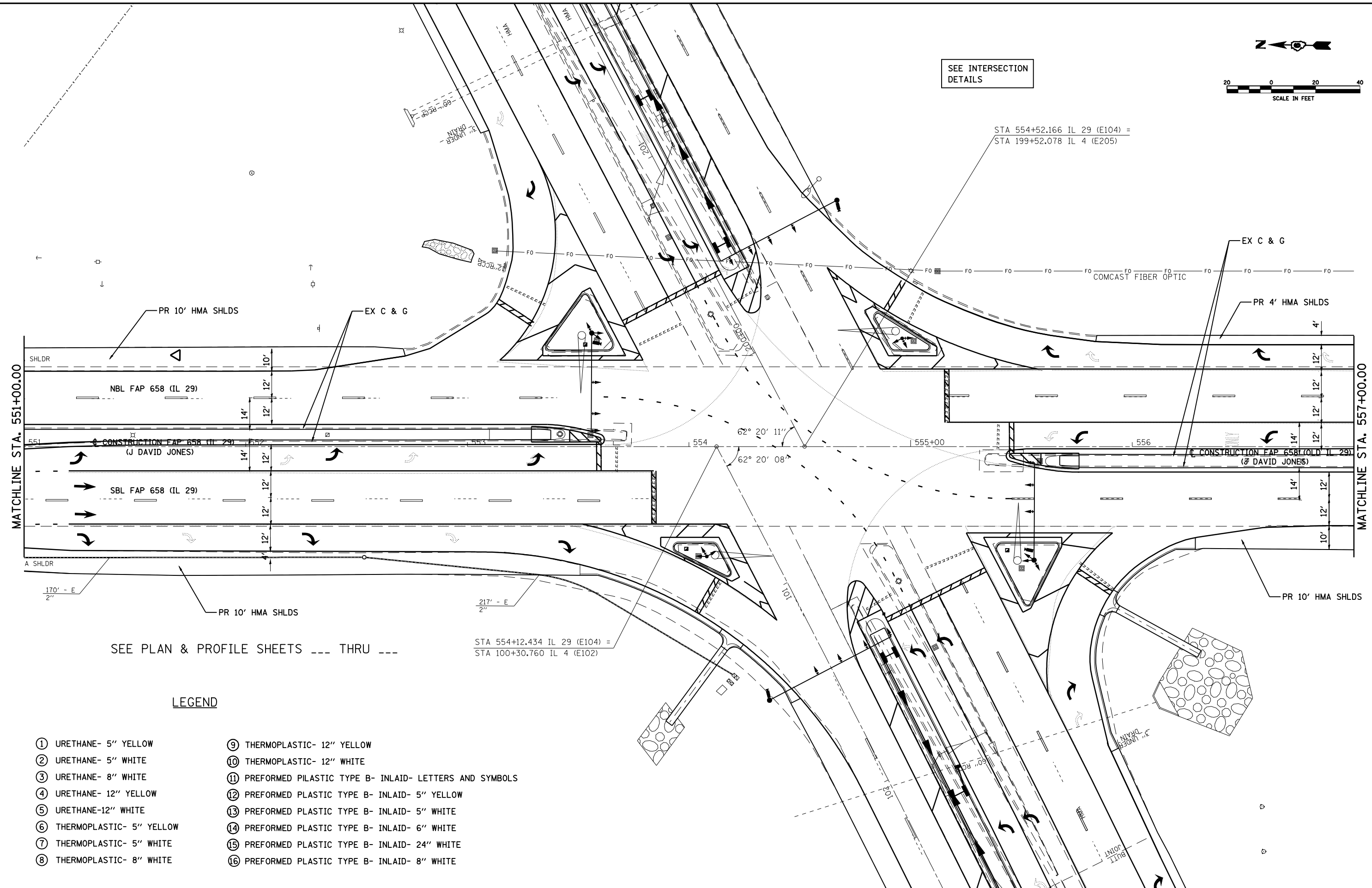

MATCHLINE STA. 551+00.00

MATCHLINE STA. 557+00.00

SEE PLAN & PROFILE SHEETS --- THRU ---

LEGEND

- ① URETHANE- 5" YELLOW
- ② URETHANE- 5" WHITE
- ③ URETHANE- 8" WHITE
- ④ URETHANE- 12" YELLOW
- ⑤ URETHANE-12" WHITE
- ⑥ THERMOPLASTIC- 5" YELLOW
- ⑦ THERMOPLASTIC- 5" WHITE
- ⑧ THERMOPLASTIC- 8" WHITE
- ⑨ THERMOPLASTIC- 12" YELLOW
- ⑩ THERMOPLASTIC- 12" WHITE
- ⑪ PREFORMED PLASTIC TYPE B- INLAID- LETTERS AND SYMBOLS
- ⑫ PREFORMED PLASTIC TYPE B- INLAID- 5" YELLOW
- ⑬ PREFORMED PLASTIC TYPE B- INLAID- 5" WHITE
- ⑭ PREFORMED PLASTIC TYPE B- INLAID- 6" WHITE
- ⑮ PREFORMED PLASTIC TYPE B- INLAID- 24" WHITE
- ⑯ PREFORMED PLASTIC TYPE B- INLAID- 8" WHITE

STA 554+12.434 IL 29 (E104) =
STA 100+30.760 IL 4 (E102)

FILE NAME =	USER NAME = laughlinr1	DESIGNED -	REVISED -
et:\pwork\PWIDOT\LAUGHLINRL\dms47710\672C35-SHT-plan-IL29L.dgn		DRAWN -	REVISED -
	PLOT SCALE = 40.0000 ' / IN.	CHECKED -	REVISED -
	PLOT DATE = Apr-30-2010 11:24:59AM	DATE -	REVISED -

**STATE OF ILLINOIS
DEPARTMENT OF TRANSPORTATION**

PLAN SHEET - SECTION "A" (OLD IL 29)

SCALE: SHEET NO. 5 OF 24 SHEETS STA. TO STA.

F.A.P. RTE.	SECTION	COUNTY	TOTAL SHEETS	SHEET NO.
658	.	SANGAMON	206	65
CONTRACT NO. 72C35			ILLINOIS FED. AID PROJECT	

* 1-1(RS,TS-1027RS-6179Z&102RS-4