

EXIST. CURVE DATA
 PI STA. = 136+39.24
 $\Delta = 22^\circ 52' 00''$ (LT)
 D = 2° 15' 00"
 R = 2,546.47'
 T = 515.00'
 L = 1,016.29'
 E = 51.56'
 P.C. STA. = 131+24.24
 P.T. STA. = 141+40.53
 e = 2.5%
 ATTAIN SUPER
 STA. 130+56 TO STA. 131+90
 REMOVE SUPER
 STA. 140+73 TO STA. 142+07

PROP. S.E. DATA
 e = 2.5%
 T.R. = 40'
 S.E. RUN = 66'

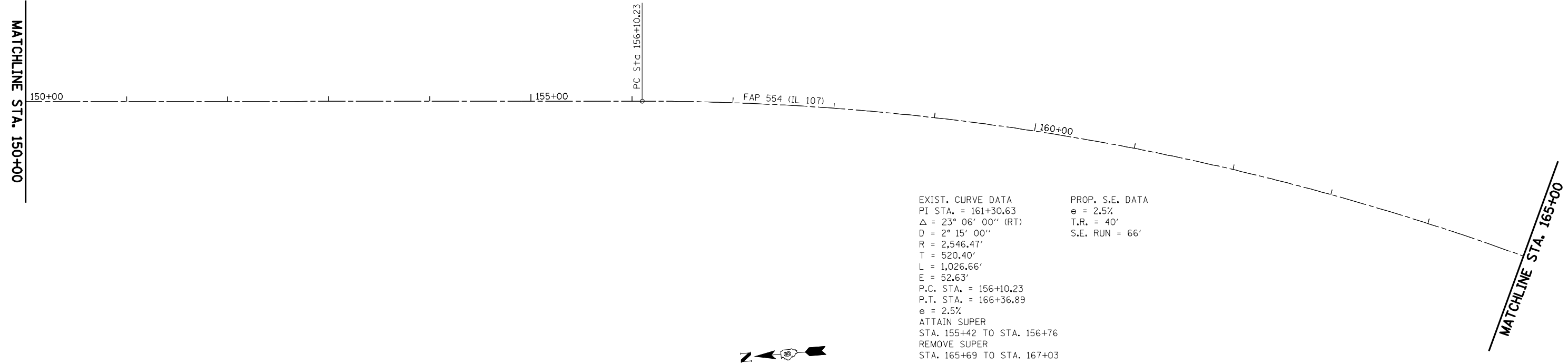
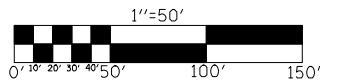
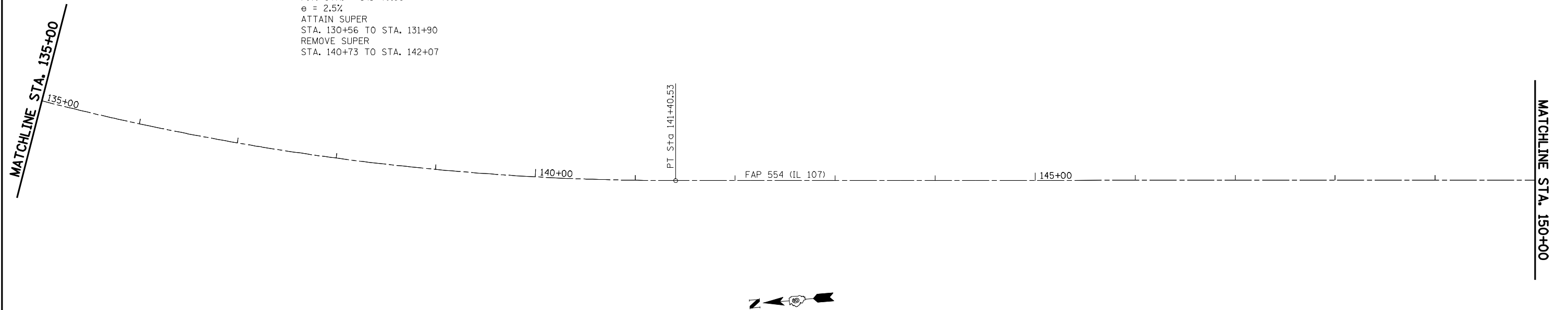

EXIST. CURVE DATA
 PI STA. = 161+30.63
 $\Delta = 23^\circ 06' 00''$ (RT)
 D = 2° 15' 00"
 R = 2,546.47'
 T = 520.40'
 L = 1,026.66'
 E = 52.63'
 P.C. STA. = 156+10.23
 P.T. STA. = 166+36.89
 e = 2.5%
 ATTAIN SUPER
 STA. 155+42 TO STA. 156+76
 REMOVE SUPER
 STA. 165+69 TO STA. 167+03

PROP. S.E. DATA
 e = 2.5%
 T.R. = 40'
 S.E. RUN = 66'

FILE NAME =	USER NAME = laughlinr1	DESIGNED -	REVISED -
es:\pwwork\PIWIDOT\LAUGHLINRL\0200040\672C37-shr-plan.dgn		DRAWN -	REVISED -
	PLOT SCALE = 100.0000' / IN.	CHECKED -	REVISED -
	PLOT DATE = Apr-08-2010 03:19:00PM	DATE -	REVISED -

**STATE OF ILLINOIS
 DEPARTMENT OF TRANSPORTATION**

PLAN SHEET FAP 554 (ILLINOIS 107)

SCALE: 1" = 50' SHEET NO. OF SHEETS STA. 135+00 TO STA. 165+00

F.A.P. RTE.	SECTION	COUNTY	TOTAL SHEETS	SHEET NO.
554	16(RS-6) & 18(RS-6)	BROWN	49	20
CONTRACT NO. 72C37				
ILLINOIS FED. AID PROJECT				

