

EXIST. CURVE DATA
 PI STA. = 180+60.69
 Δ = 23° 18' 00" (RT)
 D = 2° 14' 59"
 R = 2,546.80'
 T = 525.10'
 L = 1,035.69'
 E = 53.57'
 P.C. STA. = 175+35.59
 P.T. STA. = 185+71.28
 e = 2.5%
 ATTAIN SUPER
 STA. 174+68 TO STA. 176+02
 REMOVE SUPER
 STA. 185+03 TO STA. 186+37

PROP. S.E. DATA
 e = 2.5%
 T.R. = 40'
 S.E. RUN = 66'

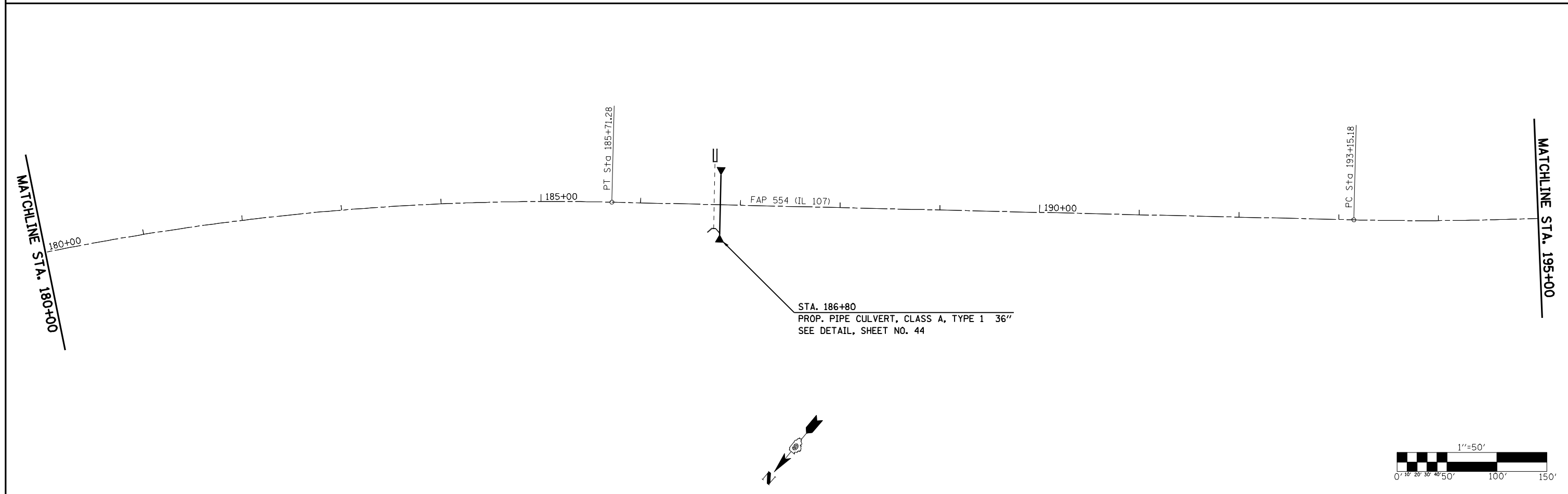

STA. 186+80
 PROP. PIPE CULVERT, CLASS A, TYPE 1 36"
 SEE DETAIL, SHEET NO. 44

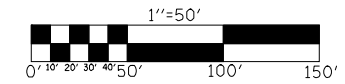

FILE NAME = e:\pwwork\p\WIDOT\LAUGHLINRL\0200040\672C37-shr-plan.dgn 	USER NAME = laughlinr1	DESIGNED -	REVISED -	STATE OF ILLINOIS DEPARTMENT OF TRANSPORTATION	PLAN SHEET FAP 554 (ILLINOIS 107)			F.A.P. RTE.	SECTION	COUNTY	TOTAL SHEETS	SHEET NO.
	DRAWN -	REVISED -	554					16(RS-6) & 18(RS-6)	BROWN	49	21	
PLOT SCALE = 100.0000' / IN.	CHECKED -	REVISED -	REVISED -	SCALE: 1" = 50' SHEET NO. OF SHEETS STA. 165+00 TO STA. 195+00			CONTRACT NO. 72C37					
PLOT DATE = Apr-08-2010 03:19:06PM	DATE -	REVISED -	REVISED -	ILLINOIS FED. AID PROJECT								