

BM 107TA9 CHISELED SQUARE ON END OF SOUTH HEADWALL STA. 406+55 ELEV. 566.12

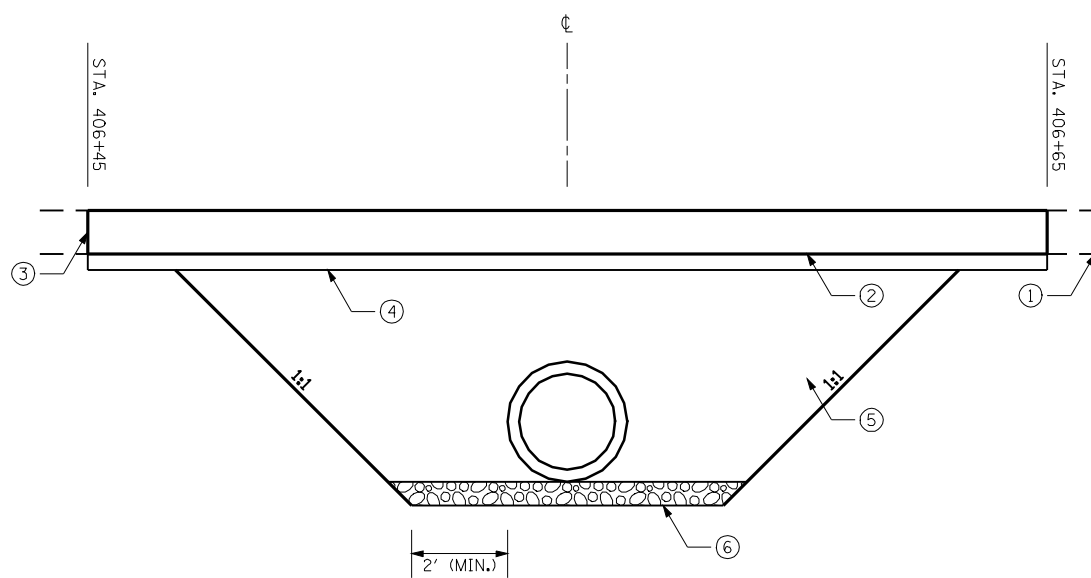

PAVEMENT PATCHING DETAIL

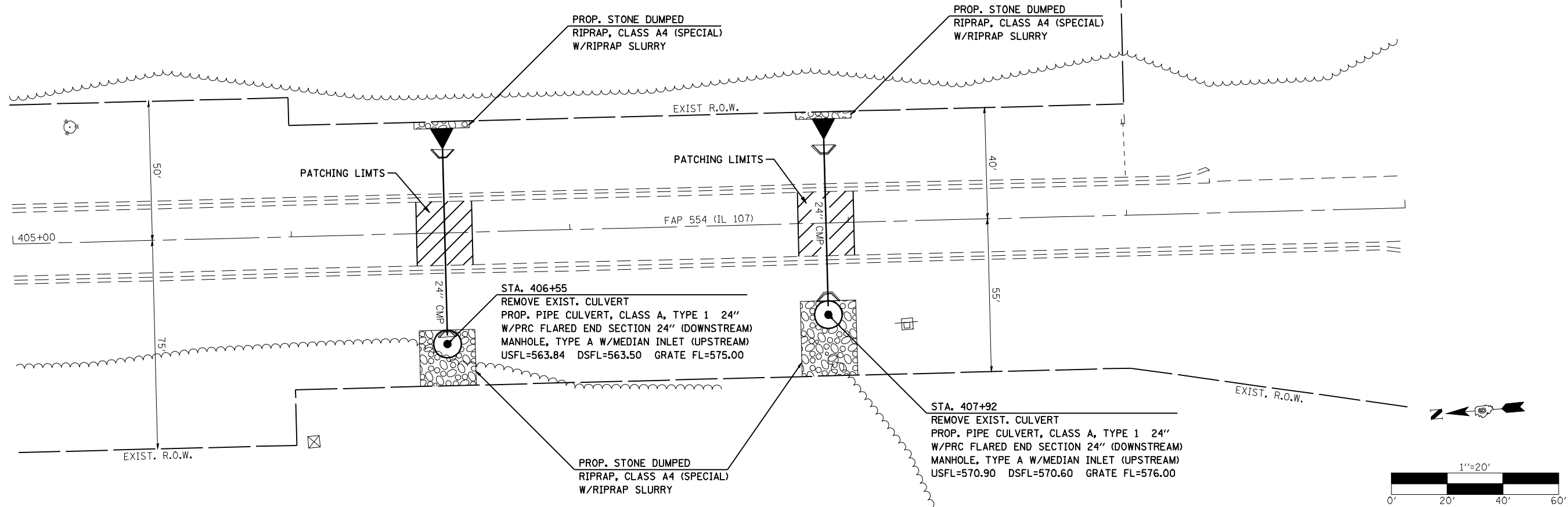
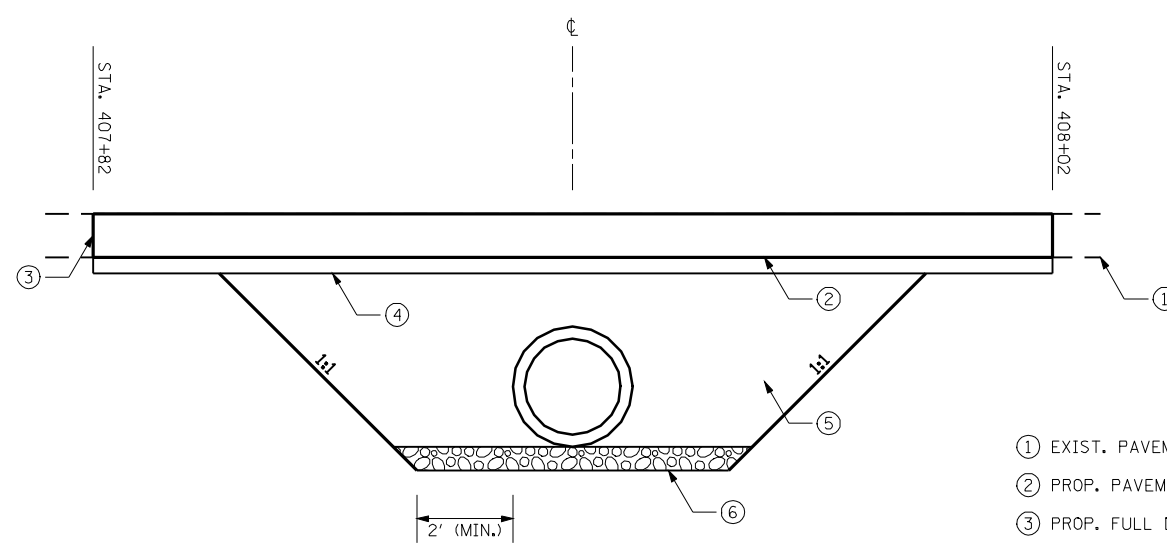

PAVEMENT PATCHING DETAIL

- ① EXIST. PAVEMENT
- ② PROP. PAVEMENT PATCHING, TYPE IV, 11 INCH
- ③ PROP. FULL DEPTH SAW CUT (TYPICAL) - INCLUDED IN COST OF PATCH
- ④ PROP. SUB-BASE GRANULAR MATERIAL, TYPE A 4"
- ⑤ PROP. TRENCH BACKFILL, SPECIAL
- ⑥ PROP. POROUS GRANULAR MATERIAL 6" (INCLUDED IN COST OF PATCH)

NOTE: SEE CROSS SECTIONS FOR ADDITIONAL INFORMATION

FILE NAME =	USER NAME = laughlinr1	DESIGNED -	REVISED -
er:\pwork\PIWIDOT\LAUGHLINRL\0200040\672C37-shd-detail3.dgn		DRAWN -	REVISED -
	PLOT SCALE = 40.000' / IN.	CHECKED -	REVISED -
	PLOT DATE = Apr-08-2010 03:20:29PM	DATE -	REVISED -

**STATE OF ILLINOIS
DEPARTMENT OF TRANSPORTATION**

CULVERT PLAN AND PAVEMENT PATCHING DETAIL

SCALE: SHEET NO. 2 OF 3 SHEETS STA. TO STA.

F.A.P. RTE.	SECTION	COUNTY	TOTAL SHEETS	SHEET NO.
554	16(RS-6) & 18(RS-6)	BROWN	49	45
CONTRACT NO. 72C37				
ILLINOIS FED. AID PROJECT				