

PAVEMENT MARKING LEGEND

- | | |
|---|--|
| ① PREFORMED PLASTIC PAVEMENT MARKING, TYPE B, INLAID - LINE 5" | ↪ PREFORMED PLASTIC PAVEMENT MARKING, TYPE B, INLAID - LETTERS AND SYMBOLS (WHITE) |
| ② PREFORMED PLASTIC PAVEMENT MARKING, TYPE B, INLAID - LINE 6" | ▶ RAISED REFLECTIVE PAVEMENT MARKER (ONE-WAY CRYSTAL) |
| ③ PREFORMED PLASTIC PAVEMENT MARKING, TYPE B, INLAID - LINE 6" (6' SKIP- 2' DASH) | ▶ RAISED REFLECTIVE PAVEMENT MARKER (ONE -WAY AMBER) |
| ④ PREFORMED PLASTIC PAVEMENT MARKING, TYPE B, INLAID - LINE 24" | ▶ RAISED REFLECTIVE PAVEMENT MARKER (TWO -WAY AMBER) |
| ⑤ THERMOPLASTIC PAVEMENT MARKING - LINE 5" | ⊗-W PAVEMENT MARKING, WHITE |
| ⑥ THERMOPLASTIC PAVEMENT MARKING - LINE 5" (DOUBLE YELLOW LINES @ 13" CENTERS) | ⊗-Y PAVEMENT MARKING, YELLOW |
| ⑦ THERMOPLASTIC PAVEMENT MARKING - LINE 6" | |
| ⑧ THERMOPLASTIC PAVEMENT MARKING - LINE 8" | |
| ⑨ THERMOPLASTIC PAVEMENT MARKING - LINE 12" | |
| ⑩ PAINT PAVEMENT MARKING - LINE 5" | |

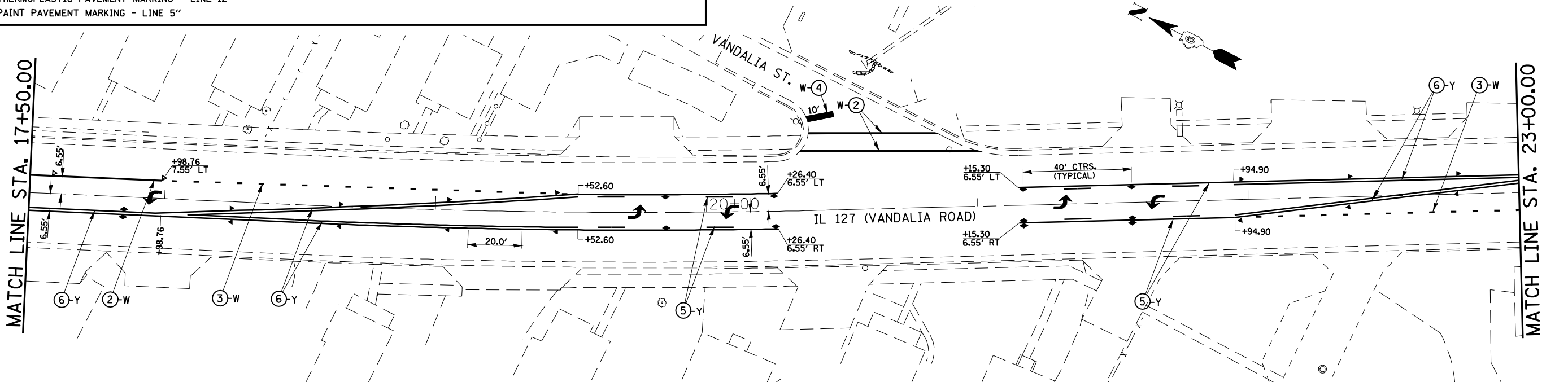

•-20RS-7, 21RS-6, 104RS, 105RS-4
•-325, 42

FILE NAME =	USER NAME = laughlinr1	DESIGNED - RTS	REVISED -	STATE OF ILLINOIS DEPARTMENT OF TRANSPORTATION	PAVEMENT MARKING SHEET		F.A.P. RTE.	SECTION	COUNTY	TOTAL SHEETS	SHEET NO.
et:\pw\work\PWIDOT\LAUGHLINRL\10105356\1072C52-ah1-pmk.dgn		DRAWN - RTS	REVISED -		SCALE:	SHEET NO. 11 OF 15 SHEETS	STA.		MONTGOMERY	60	47
PLOT SCALE = 40.0000' / IN.		CHECKED - RTS	REVISED -				TO STA.		CONTRACT NO. 72C52		
PLOT DATE = Mar-26-2010 12:00:21PM		DATE - 3-10-10	REVISED -						ILLINOIS FED. AID PROJECT		