

EXIST. CURVE 3
 PI STA. =26+41.78 e = -----
 $\Delta = 3^\circ 47' 46''$ (RT) T.R. = -----
 D =1° 53' 53" S.E. RUN = -----
 R =3,018.66' P.C. STA. =25+41.75
 T =100.04' P.T. STA. =27+41.75
 L =200.00'
 E =1.66'

PAVEMENT MARKING LEGEND	
(1) PREFORMED PLASTIC PAVEMENT MARKING, TYPE B, INLAID - LINE 5"	↩ PREFORMED PLASTIC PAVEMENT MARKING, TYPE B, INLAID - LETTERS AND SYMBOLS (WHITE)
(2) PREFORMED PLASTIC PAVEMENT MARKING, TYPE B, INLAID - LINE 6"	▶ RAISED REFLECTIVE PAVEMENT MARKER (ONE-WAY CRYSTAL)
(3) PREFORMED PLASTIC PAVEMENT MARKING, TYPE B, INLAID - LINE 6" (6' SKIP- 2' DASH)	▶ RAISED REFLECTIVE PAVEMENT MARKER (ONE -WAY AMBER)
(4) PREFORMED PLASTIC PAVEMENT MARKING, TYPE B, INLAID - LINE 24"	▶ RAISED REFLECTIVE PAVEMENT MARKER (TWO -WAY AMBER)
(5) THERMOPLASTIC PAVEMENT MARKING - LINE 5"	(X)-W PAVEMENT MARKING, WHITE
(6) THERMOPLASTIC PAVEMENT MARKING - LINE 5" (DOUBLE YELLOW LINES @ 13" CENTERS)	(X)-Y PAVEMENT MARKING, YELLOW
(7) THERMOPLASTIC PAVEMENT MARKING - LINE 6"	
(8) THERMOPLASTIC PAVEMENT MARKING - LINE 8"	
(9) THERMOPLASTIC PAVEMENT MARKING - LINE 12"	
(10) PAINT PAVEMENT MARKING - LINE 5"	

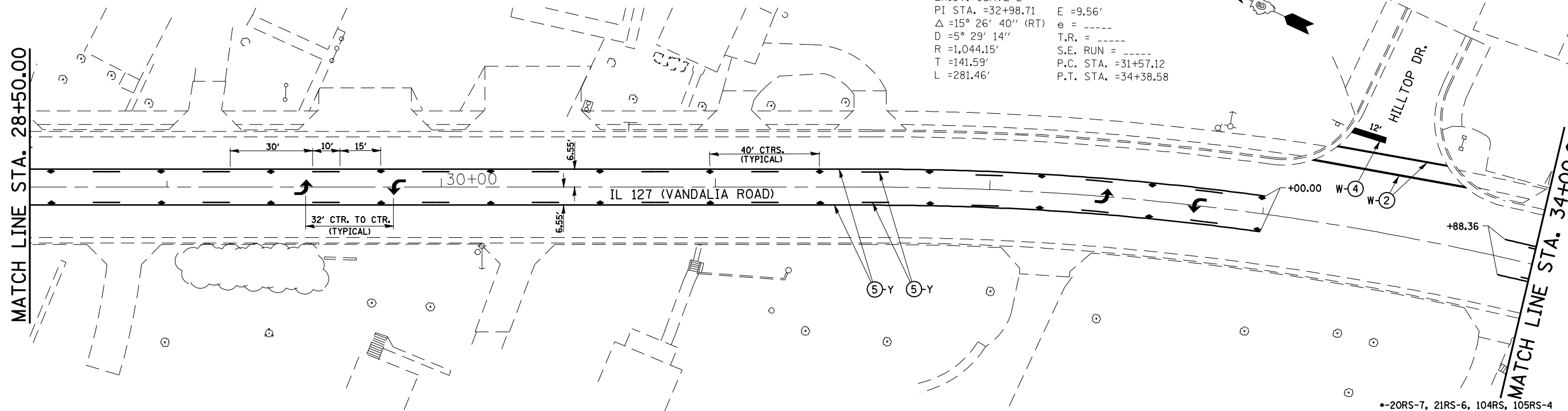

EXIST. CURVE 2
 PI STA. =32+98.71 E =9.56'
 $\Delta = 15^\circ 26' 40''$ (RT) e = -----
 D =5° 29' 14" T.R. = -----
 R =1,044.15' S.E. RUN = -----
 T =141.59' P.C. STA. =31+57.12
 L =281.46' P.T. STA. =34+38.58

•-20RS-7, 21RS-6, 104RS, 105RS-4
 •-325, 42