

STATE OF ILLINOIS
DEPARTMENT OF TRANSPORTATION
DIVISION OF HIGHWAYS

PROPOSED
HIGHWAY PLANS

F.A.P. ROUTE 506 (IL. 96)
SECTION 123RS-5

ROADWAY RESURFACING SMART
HANCOCK COUNTY

C-96-034-09

F.A.P. RTE.	SECTION	COUNTY	TOTAL SHEETS	SHEET NO.
506	123RS-5	HANCOCK	14	1
		ILLINOIS	CONTRACT NO. 72C55	

FOR INDEX OF SHEETS AND HIGHWAY STANDARDS, SEE SHEET NO. 2

CURRENT TRAFFIC DATA

ADT 2600 (2009)
350 TRUCKS (13%)

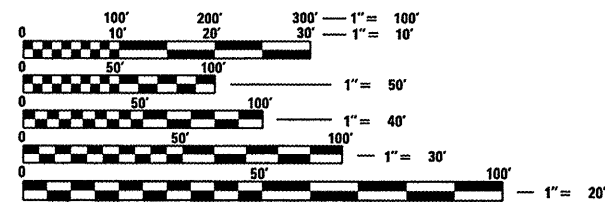
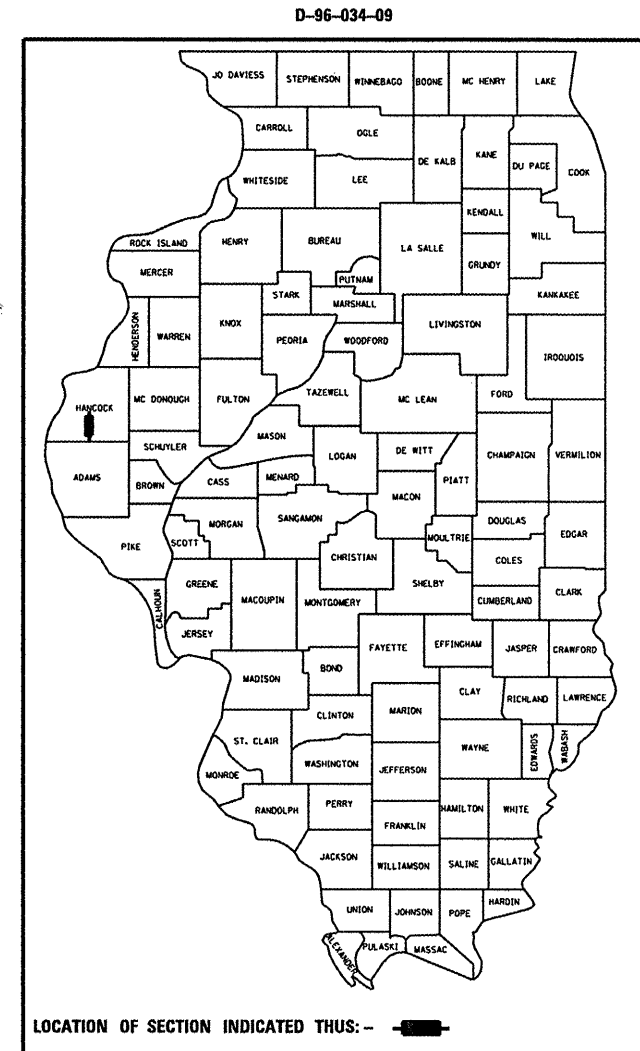

FULL SIZE PLANS HAVE BEEN PREPARED USING STANDARD ENGINEERING SCALES. REDUCED SIZED PLANS WILL NOT CONFORM TO STANDARD SCALES. IN MAKING MEASUREMENTS ON REDUCED PLANS, THE ABOVE SCALES MAY BE USED.

J.U.L.I.E.
JOINT UTILITY LOCATION INFORMATION FOR EXCAVATION
1-800-892-0123
OR 811

SQUAD LEADER: MARK DUST (217) 785-0597
PROJECT MANAGER: JOHN NEGANGARD (217) 782-6990

CONTRACT NO. 72C55

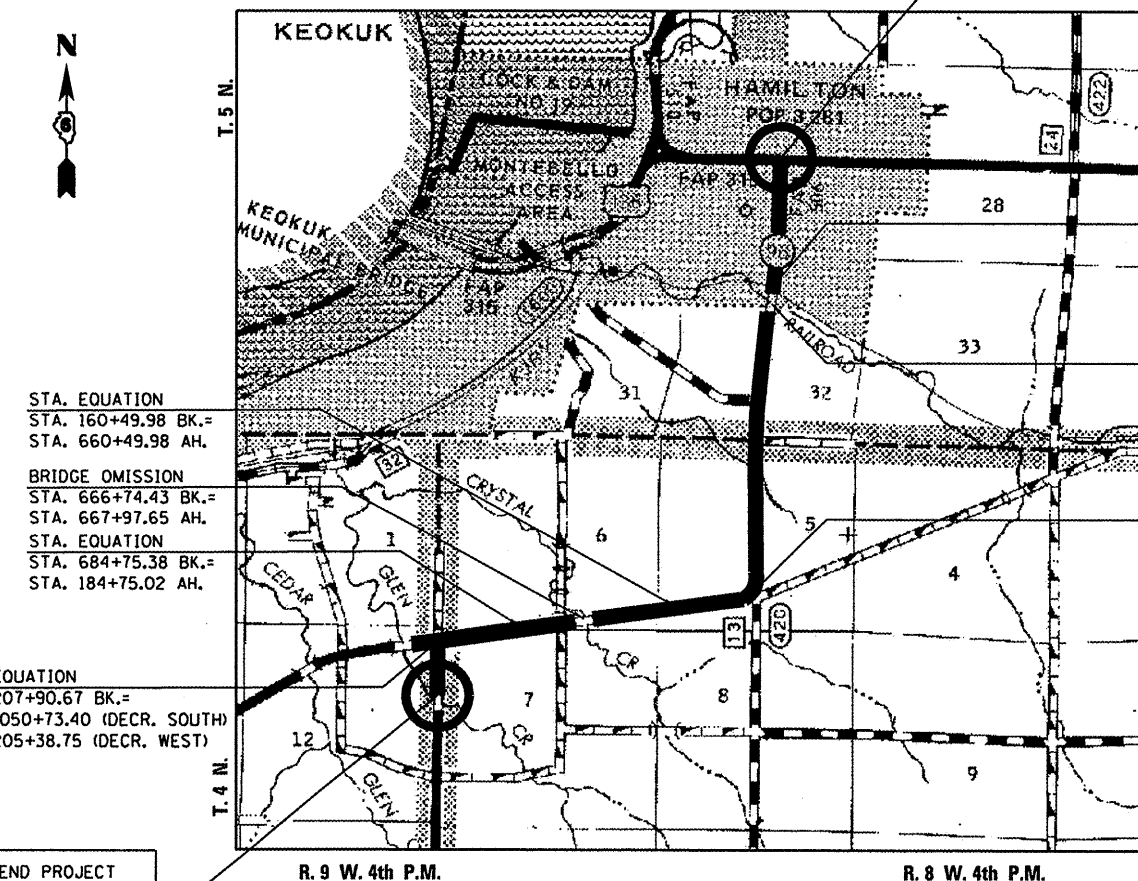

STA. EQUATION
STA. 160+49.98 BK.=
STA. 660+49.98 AH.
BRIDGE OMISSION
STA. 666+74.43 BK.=
STA. 667+97.65 AH.
STA. EQUATION
STA. 684+75.38 BK.=
STA. 184+75.02 AH.

STA. EQUATION
STA. 207+90.67 BK.=
STA. 1050+73.40 (DECR. SOUTH)
STA. 205+38.75 (DECR. WEST)

END PROJECT
STA. 1036+00.00
C F.A.P. 506

BEGIN PROJECT
STA. 2+50.00
C F.A.P. 506

STA. EQUATION
STA. 30+80.00 BK.=
STA. 30+77.60 AH.

OMISSION
STA. 34+00.00 TO
STA. 42+40.00

STA. EQUATION
STA. 128+91.79 BK.=
STA. 131+32.29 AH.

GROSS LENGTH = 22,635.00 FT. = 4.287 MILE
NET LENGTH = 22,079.47 FT. = 4.182 MILE

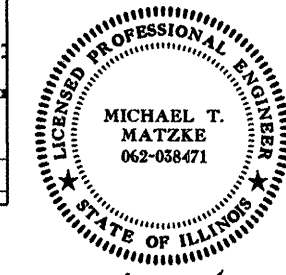

Michael T. Matzke
SIGNATURE

April 6, 2010
DATE

LIC. EXP. DATE : 11/30/2011

STATE OF ILLINOIS
DEPARTMENT OF TRANSPORTATION
DIVISION OF HIGHWAYS

SUBMITTED April 8 2010
Ry 2 Dmb
DEPUTY DIRECTOR OF HIGHWAYS, REGION ENGINEER

May 7 2010
Scott E. Stitt, P.E. /sl
ENGINEER OF DESIGN AND ENVIRONMENT

May 7 2010
Christine M. Reed /sl
DIRECTOR OF HIGHWAYS, CHIEF ENGINEER

PRINTED BY THE AUTHORITY
OF THE STATE OF ILLINOIS

INDEX OF SHEETS

SHEET NO.	DESCRIPTION
1	COVER SHEET
2	SHEETS INDEX & GENERAL NOTES
3	SUMMARY OF QUANTITIES
4-7	SCHEDULE OF QUANTITIES
8-11	TYPICAL SECTIONS
12	PLAN SHEET - FAP RTE 506 (IL. 96)
13-14	DETAILS

GENERAL NOTES

- THESE SECTIONS SHALL BE CONSTRUCTED IN ACCORDANCE WITH THE PLANS: THE "STANDARD SPECIFICATIONS FOR THE ROAD AND BRIDGE CONSTRUCTION", ADOPTED JANUARY 1, 2007; THE "SUPPLEMENTAL SPECIFICATIONS AND RECURRING SPECIAL PROVISIONS"; AND THE SPECIAL PROVISIONS INCLUDED IN THESE PLANS.
- THE NOMINAL THICKNESS FOR BINDER AND SURFACE COURSES ARE SHOWN ON THE TYPICAL SECTIONS, SCHEDULES, OR SPECIAL DETAILS. THE CONSTRUCTED THICKNESS SHALL NOT BE LESS THAN 90 PERCENT OF THE NOMINAL THICKNESS AT ANY LOCATION.
- THE CONTRACTOR SHALL PROTECT AND CAREFULLY PRESERVE ALL PROPERTY MARKERS AND MONUMENTS UNTIL THE OWNER, AUTHORIZED AGENT, OR LAND SURVEYOR HAS WITNESSED OR OTHERWISE REFERENCED THEIR LOCATION. WHERE SECTION OR SUB-SECTION MONUMENTS ARE ENCOUNTERED, THE ENGINEER SHALL BE NOTIFIED BEFORE SUCH MONUMENTS ARE REMOVED. THE CONTRACTOR SHALL BE RESPONSIBLE FOR HAVING AN AUTHORIZED SURVEYOR RE-ESTABLISH ANY SECTION OR SUB-SECTION MONUMENTS DESTROYED BY HIS OPERATIONS.
- ALL DISTURBED AREAS WITHIN THE RIGHT-OF-WAY SHALL BE SEEDED, FERTILIZED, AND MULCHED AS SHOWN IN THE PLANS AND AS DIRECTED BY THE ENGINEER.
- IN ACCORDANCE WITH STATE OF ILLINOIS P.A. 86-0674, THE CONTRACTOR IS TO NOTIFY ALL UTILITY COMPANIES NOT MORE THAN 14 DAYS NOR LESS THAN 48 HOURS (EXCLUSIVE OF SATURDAYS, SUNDAYS, AND HOLIDAYS) IN ADVANCE OF THE START OF EXCAVATION OR DEMOLITION.
- THE CONTRACTOR SHALL BE RESPONSIBLE FOR REPAIRS TO ANY UTILITY LINES AND EXISTING IMPROVEMENTS TO REMAIN THAT ARE DAMAGED AS A RESULT OF THE WORK.
- THE WORK AREA SHALL BE POSITIVELY DRAINED DURING CONSTRUCTION. FINAL GRADES SHALL BE PROTECTED AGAINST DAMAGE FROM EROSION, SEDIMENTATION, AND TRAFFIC.
- WHERE PROPOSED CONSTRUCTION ABUTS EXISTING APPURTENANCES, A SAW-CUT SHALL BE MADE TO ACHIEVE A NEAT BUTT JOINT. THE SAW-CUT IS TO BE INCLUDED IN THE COST OF THE BUTT JOINT.
- WHERE SECTION OR SUB-SECTION MONUMENTS ARE ENCOUNTERED, THE ENGINEER SHALL BE NOTIFIED BEFORE SUCH MONUMENTS ARE REMOVED. THE CONTRACTOR SHALL PROTECT AND CAREFULLY PRESERVE ALL PROPERTY MARKERS AND MONUMENTS UNTIL THE OWNER, AND AUTHORIZED SURVEYOR OR AGENT HAS WITNESS OR OTHERWISE REFERENCED THEIR LOCATION.
- THE PAY ITEM TEMPORARY RAMP HAS BEEN INCLUDED FOR THE CONSTRUCTION OF TEMPORARY RAMPS IN ACCORDANCE WITH ARTICLE 406.08 OF THE STANDARD SPECIFICATIONS. THE COST SHALL INCLUDE BOTH THE INSTALLATION AND THE REMOVAL OF THE TEMPORARY RAMPS.
- SHORT TERM PAVEMENT MARKING SHALL BE APPLIED TO THE MILLED SURFACE AND HOT-MIX ASPHALT SURFACE COURSE AS SPECIFIED IN SECTION 703 OF THE STANDARD SPECIFICATIONS. TEMPORARY PAVEMENT MARKING TAPE SHALL BE USED ON THE SURFACE COURSE AND ON THE MILLED SURFACES AS SPECIFIED IN SECTION 703.
- MAINTAIN EXISTING TRAFFIC CONTROL AT ALL INTERSECTIONS DURING CONSTRUCTION.
- ANY EXISTING ROAD SIGNS THAT INTERFERE WITH CONSTRUCTION WILL BE REMOVED OR RELOCATED AS DIRECTED BY THE ENGINEER. AFTER THE CONSTRUCTION IS COMPLETED, THE CONTRACTOR WILL REPLACE THE SIGNS AS DIRECTED BY THE ENGINEER. THIS WORK WILL NOT BE PAID SEPARATELY BUT SHALL BE CONSIDERED INCIDENTAL TO THE CONTRACT AND NO COMPENSATION WILL BE ALLOWED.
- EXISTING RAISED REFLECTIVE PAVEMENT MARKERS SHALL BE REMOVED PRIOR TO HOT-MIX ASPHALT SURFACE REMOVAL.

ILLINOIS IDOT HIGHWAY STANDARDS

- 000001-05 STANDARD SYMBOL ABBREVIATIONS AND PATTERNS
- 280001-05 TEMPORARY EROSION CONTROL SYSTEMS
- 420001-07 PAVEMENT JOINTS
- 442201-03 CLASS C AND D PATCHES
- 442201-04 CLASS A PATCHES
- 701001-02 OFF - RD OPERATIONS, 2L, 2W, MORE THAN 15' AWAY
- 701006-03 OFF - RD OPERATIONS, 2L, 2W, 15' TO 24" FROM PAVEMENT EDGE
- 701011-02 OFF - RD OPERATIONS, 2L, 2W, DAY ONLY
- 701201-03 LANE CLOSURE, 2L, 2W, DAY ONLY FOR SPEEDS > 45 MPH
- 701306-02 LANE CLOSURE, 2L, 2W, SLOW MOVING OPERATIONS - DAY ONLY, FOR SPEEDS > 45 MPH
- 701311-03 LANE CLOSURE, 2L, 2W, MOVING OPERATIONS - DAY ONLY
- 701501-05 URBAN LANE CLOSURE, 2L, 2W, UNDIVIDED
- 701901-01 TRAFFIC CONTROL DEVICES
- 780001-02 TYPICAL PAVEMENT MARKINGS
- 781001-03 TYPICAL APPLICATIONS RAISED REFLECTIVE PAVEMENT MARKERS

701301-03

COMMITMENTS

THE FIELD/RESIDENT ENGINEER SHALL CONTACT STUDIES & PLANS CONCERNING ANY MAJOR PLAN CHANGES TO MAKE SURE NO PREVIOUS COMMITMENTS (NOT LISTED) WERE MADE AFFECTING THE DESIGN, AND TO ALLOW IMPROVEMENTS IN THE DESIGN FOR FUTURE PROJECTS.

RATES OF APPLICATION TABLE

AGGREGATE (SURFACE, BASE, SUBBASE, OR BACKFILL)	2.05 TON/CU YD
SUBBASE GRANULAR MATERIAL, TYPE C	1.80 TON/CU YD
STONE DUMPED RIPRAP	1.50 TON/CU YD
HOT MIX ASPHALT:	
BITUMINOUS MATERIALS (PRIME COAT)	0.00038 TON/SQ YD (on pavement)
BITUMINOUS MATERIALS (PRIME COAT)	0.001425 TON/SQ YD (on aggregate)
AGGREGATE PRIME COAT	0.002 TON/SQ YD
SURFACE /BINDER (112 lbs)	0.056 TON/SQ YD /IN
SEEDING AREAS:	
NITROGEN FERTILIZER NUTRIENT	90 LBS / ACRE
PHOSPHOROUS FERTILIZER NUTRIENT	90 LBS / ACRE
POTASSIUM FERTILIZER NUTRIENT	90 LBS / ACRE
MULCH	2 TON / ACRE

THE FOLLOWING MIXTURE REQUIREMENTS ARE APPLICABLE FOR THIS PROJECT:

LOCATION(S):	MAINLINE	INCIDENTAL	MAINLINE-SHOULDERS	PATCHING	NEW HMA SHOULDERS
MIXTURE USE(S):	HOT-MIX ASPHALT SURFACE COURSE MIX "C", NSO	HOT-MIX ASPHALT SURFACE COURSE MIX "C", NSO	HOT-MIX ASPHALT SURFACE COURSE MIX "C", NSO	PAVEMENT PATCHING TYPE II OR III	HOT-MIX ASPHALT SHOULDER 8"
AC/PG:	PG 64-22	PG 64-22	PG 64-22	PG 64-22	PG 58-22
DESIGN AIR VOIDS:	4.0% @ N DESIGN =50	4.0% @ N DESIGN =50	4.0% @ N DESIGN =50	4.0% @ N DESIGN =50	2.0% @ N DESIGN =30
MIXTURE COMPOSITION (GRADATION):	IL 9.5 OR 12.5	IL 9.5 OR 12.5	IL 9.5 OR 12.5	IL 19.0	BAM (OTHER)
FRICTION AGGREGATE:	MIX "C"	MIX "C"	MIX "C"	N/A	N/A

DISTRICT SIX	
EXAMINED	MARCH 30 20 10
OPERATIONS ENGINEER	
EXAMINED	MARCH 26 20 10
PROGRAM IMPLEMENTATION ENGINEER	
EXAMINED	MARCH 29 20 10
PROGRAM DEVELOPMENT ENGINEER	

STATE OF ILLINOIS
DEPARTMENT OF TRANSPORTATION

GENERAL NOTES

F.A.P. RTE.	SECTION	COUNTY	TOTAL SHEETS	SHEET NO.
506	123RS-5	HANCOCK	14	2
CONTRACT NO. 72C55				
FED. ROAD DIST. NO. 6 ILLINOIS FED. AID PROJECT				

FILE NAME =	USER NAME = #USER#	DESIGNED - TCG	REVISED -
#FILE#		DRAWN - JJS	REVISED -
	PLOT SCALE = #SCALE#	CHECKED - MTM	REVISED -
	DATE - FEBRUARY 2010	REVISED -	

SCALE: N/A SHEET NO. 1 OF 1 SHEETS STA. TO STA.

MAINLINE RESURFACING SCHEDULE						
STATION TO STATION	WIDTH	44000158	40603340	40600200	40600300	40800050
		HMA SURFACE REMOVAL	HMA SURFACE COURSE MIX "C", N50 1-1/2"	BITUMINOUS MATERIALS (PRIME COAT)	AGGREGATE (PRIME COAT)	INCIDENTAL HOT-MIX ASPHALT SURFACING
		1-1/2"				
		SQ YD	TON			
IL 96						
STA 02+50.00 TO STA. 30+80.00	26	8146.67	686.7	3.11	16.35	
STA. EQU. 30+80.00 BK = STA. 30+77.6 AH						
STA. 30+77.60 TO STA. 34+00.00	26	902.49	78.2	0.35	1.86	
RAILROAD OMISSION 34+00.00 TO 42+40.00						
STA. 42+40.00 TO STA. 128+91.79	26	24965.17	2099.5	9.50	49.99	
STA. EQU. 128+91.79 BK = STA. 131+32.29 AH						
STA. 131+32.29 TO STA. 158+96.65	26	7985.93	670.8	3.03	15.97	
STA. 158+96.65 TO STA. 160+49.98	29	494.06	41.5	0.19	0.99	
STA EQU. 160+49.98 BK = STA. 660+49.98 AH						
STA. 660+49.98 TO STA. 666+44.43	29	1979.89	169.0	0.76	4.02	
BRIDGE OMISSION STA. 666+74.43 TO STA. 667+97.65						
STA. 667+97.65 TO STA. 681+84.52	29	4436.58	375.4	1.70	8.94	
STA. 681+84.52 TO STA. 684+75.49	28	905.24	76.0	0.34	1.81	
STA. EQU. 684+75.49 BK = STA. 184+75.02 AH						
STA. 184+75.02 TO STA. 186+28.35	27	459.99	38.6	0.17	0.92	
STA. 186+28.35 TO STA. 207+90.67	26	6246.70	524.7	2.37	12.49	
SOUTH OF INTERSECTION						
STA. 1050+61.40 TO STA. 1036+30.00		4450.20	381.1	1.72	9.07	
OMIT CONC. ISLAND PORTION		-18.00	-1.50	-0.01	-0.04	
WARSAW RD.						
STA. 197+50.00 TO STA. 205+38.75	26	2249.72	191.4	0.87	4.56	
T.R. 20						
STA. 100+12.00 TO STA. 101+08.10	VAR.	644.60		0.24	1.29	54.1
C.H. 13 STA. 0+13.00 TO STA. 4+00.00	26	1,089.11		0.42	2.24	93.9
BIT. SHOULDERS						
LT. SIDE						
STA. 18+70.00 TO STA. 30+80.00	7	941.11	79.1	0.36	1.88	
STA. 30+77.60 TO STA. 34+00.00	7	250.76	21.1	0.10	0.50	
STA. 42+40.00 TO STA. 67+41.41	7	1945.54	163.4	0.74	3.89	
STA. 80+70.14 TO STA. 108+03.54	7	2125.98	178.6	0.81	4.25	
RT. SIDE						
STA. 670+40.00 TO STA. 676+00.00	7	435.56	36.6	0.17	0.87	
STA. 681+84.52 TO STA. 684+75.49	4.7	151.95	12.8	0.06	0.30	
STA. 184+75.02 TO STA. 186+28.35	1.2	20.44	1.7	0.01	0.04	
NE QUADRANT						
IL. 96 & T.R. 20						
STA. 206+61.19 TO STA. 101+08.11	4	69.70	5.9	0.03	0.14	
SE QUADRANT						
IL. 96 & T.R. 20						
STA. 206+61.19 TO STA. 1049+58.15	4	59.90	5.0	0.02	0.12	
NW QUADRANT						
T.R. 20 & WARSAW RD.						
STA. 101+08.11 TO STA. 198+00.00	4-8	265.70	22.3	0.10	0.53	
SW QUADRANT						
SOUTH LEG & WARSAW RD.						
STA. 1049+58.15 TO STA. 198+00.00	4-8	351.10	29.5	0.13	0.70	
TOTAL		71556	5,887	27	144	148

HMA SHOULDERS 8"	
LOCATION	SQ YD
F.A. RTE 506 (IL 96)	
LT. SHOULDER	
STA. 107+55.87 TO STA. 108+55.87	22.2
STA. 108+55.87 TO STA. 128+91.79	678.6
STA. EQUATION 128+91.79 BK = STA. 131+32.29 AH	
STA. 131+32.29 TO STA. 132+32.29	33.3
STA. 132+32.29 TO STA. 133+32.29	22.2
RT. SHOULDER	
STA. 107+55.87 TO STA. 108+55.87	22.2
STA. 108+55.87 TO STA. 128+91.79	678.6
STA. EQUATION 128+91.79 BK = STA. 131+32.29 AH	
STA. 131+32.29 TO STA. 132+32.29	33.3
STA. 132+32.29 TO STA. 133+32.29	22.2
TOTAL	1512.8
USE	1513

FILE NAME =	USER NAME = laughlinr1	DESIGNED - TCG	REVISED -
es:\pwork\PWIDOT\LAUGHLINRL\0198500\0672C55-shr-schedule.dgn		DRAWN - JJS	REVISED -
	PLOT SCALE = 100.0000' / IN.	CHECKED - MTM	REVISED -
	PLOT DATE = Apr-07-2010 09:36:08AM	DATE - FEBRUARY 2010	REVISED -

**STATE OF ILLINOIS
DEPARTMENT OF TRANSPORTATION**

SCHEDULE OF QUANTITIES			
F.A.P. RTE.	SECTION	COUNTY	TOTAL SHEETS
506	123RS-5	HANCOCK	14
			5
CONTRACT NO. 72C55			
SCALE: 1"=50'	SHEET NO. 2 OF 4 SHEETS	STA.	TO STA.

ILLINOIS FED. AID PROJECT

PAVEMENT MARKING SCHEDULE

STATION TO STATION	LENGTH	PAINT PAVEMENT MARKING- LINE 5"				TEMP. PAVEMENT MARKING-LINE 5"			
		5" WHITE EDGELINES	5" SOLID YELLOW	5" DOUBLE YELLOW	5" SKIP DASH YELLOW	5" WHITE (EDGELINES)	5" SOLID YELLOW	5" DOUBLE YELLOW	5" SKIP DASH YELLOW
		FOOT				FOOT			
		LT.	RT.			LT.	RT.		
IL 96									
STA. 18+70.00 TO STA. 30+80.00	1210.0	1210.0	1210.0			1210.0	1210.0		
STA. 2+50.00 TO STA. 05+20.00				540.0				930.0	
STA. 05+20.00 TO STA. 08+33.00				313.0	80.0			313.0	80.0
STA. 08+33.00 TO STA. 08+63.00					10.0				10.0
STA. 08+63.00 TO STA. 15+04.00				641.0	160.0			641.0	160.0
STA. 15+04.00 TO STA. 16+18.00					228.0				228.0
STA. 16+18.00 TO STA. 19+78.00				360.0	90.0			360.0	90.0
STA. 19+78.00 TO STA. 27+55.00					190.0				190.0
STA. 27+55.00 TO STA. 30+80.00				325.0	80.0			325.0	80.0
STA. EQU. 30+80.00 BK = 30+77.6 AH									
STA. 30+77.6 TO STA. 33+79.00				301.0	80.0			301.0	80.0
STA. 33+79.00 TO STA. 34+00.00					42.0				42.0
STA. 30+77.60 TO STA. 34+00.00	322.4	322	322			322	322		
RAILROAD OMISSION STA. 34+00.00 TO STA. 42+40.00									
STA. 42+40.00 TO STA. 128+91.79	8651.8	8652	8652			8652	8652		
STA. 42+40.00 TO STA. 53+00.00					2120.0				2120.0
STA. 53+00.00 TO STA. 63+83.00				1083.0	270.0			1083.0	270.0
STA. 63+83.00 TO STA. 65+69.00					50.0				50.0
STA. 65+69 TO STA. 86+19.00				2050.0	510.0			2050.0	510.0
STA. 86+19.00 TO STA. 88+19.00					400.0				400.0
STA. 88+19.00 TO STA. 109+55.00				2136.0	530.0			2136.0	530.0
STA. 109+55.00 TO STA. 128+91.79					480.0				480.0
STA. EQU. 128+91.79 BK = STA. 131+32.29 AH									
STA. 131+32.29 TO STA. 136+00.00					120.0				120.0
STA. 131+32.29 TO STA. 160+49.98	2917.7	2918	2918			2918	2918		
STA. 136+00.00 TO STA. 160+49.98				2450.0	610.0			2450.0	610.0
STA. EQU. 160+49.98 BK = STA. 660+49.98 AH									
STA. 660+49.98 TO STA. 666+74.43	624.4	624	624	624.0	160.0	624	624	624.0	160.0
BRIDGE OMISSION 666+74.43 TO STA. 667+97.65									
STA. 667+97.65 TO STA. 684+00.00				1602.0	400.0			1602.0	400.0
STA. 684+00.00 TO STA. 684+75.38					150.0				150.0
STA. 667+97.65 TO STA. 684+75.38	1677.7	1678	1678			1678	1678		
STA. EQU. 684+75.49 BK = STA. 184+75.02 AH									
STA. 184+75.00 TO STA. 186+75.00				200.0	50.0			200.0	50.0
STA. 186+75.00 TO STA. 187+75.00					200.0				200.0
STA. 187+75 TO STA. 197+25.00				950.0	240.0			950.0	240.0
STA. 197+75.00 TO STA. 207+25.00					1900.0				1900.0
STA. 184+75.02 TO STA. 207+25.00	2250	2250	2250			2250	2250		
OMISSIONS									
LAUREL ST.									
STA. 04+07.00			70				70		
STA. 05+00.00				70				70	
OAK ST.									
STA. 08+20.00			70				70		
STA. 08+57.00				80				80	
BROADWAY ST.									
STA. 12+41.00			90				90		
STA. 12+47.00				90				90	
WALNUT ST.									
STA. 16+18.00			70				70		
STA. 16+20.00				70				70	
ELM ST.									
STA. 23+39.00			70				70		
DIRADO LANE									
STA. 54+41.00			90				90		

(SEE NEXT SHEET FOR QUANTITY TOTALS)

FILE NAME =	USER NAME = laughlinr1	DESIGNED - TCG	REVISED -	STATE OF ILLINOIS DEPARTMENT OF TRANSPORTATION	SCHEDULE OF QUANTITIES			F.A.P. RTE.	SECTION	COUNTY	TOTAL SHEETS	SHEET NO.
es:\pwwork\PIV\DOT\LAUGHLINRL\10198500\10672C55-sht-schedule.dgn		DRAWN - JJS	REVISED -		506	123RS-5	HANCOCK	14	6			
PLOT SCALE = 100.0000' / IN.		CHECKED - MTM	REVISED -		SCALE: 1"=50'			SHEET NO. 3 OF 4 SHEETS			STA.	TO STA.
PLOT DATE = Apr-07-2010 09:36:10AM		DATE - FEBRUARY 2010	REVISED -		ILLINOIS FED. AID PROJECT			CONTRACT NO. 72C55				

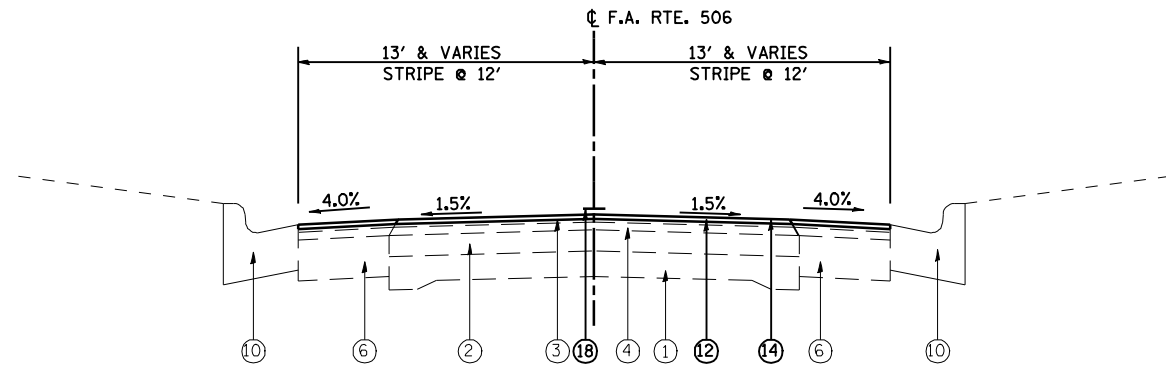

PROPOSED TYPICAL
STA. 2+50.00 TO STA. 18+70.00

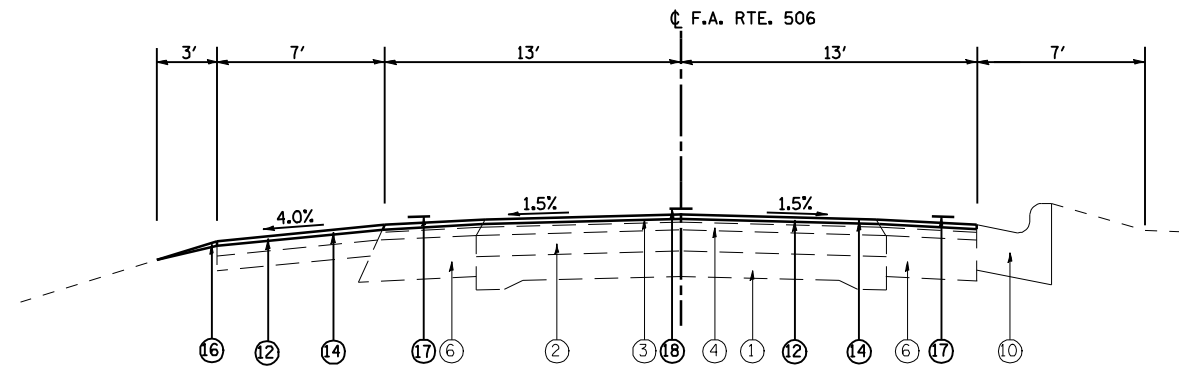

PROPOSED TYPICAL
STA. 18+70.00 TO STA. 19+43.00
STA. 24+20.00 TO STA. 26+00.00

LEGEND

- ① EXISTING P.C. CONCRETE PAVEMENT 9"-6"-9"
- ② EXISTING HMA SURFACE OVERLAY
- ③ EXISTING HMA SURFACE COURSE, MIX D, CLASS I, TYPE 2, 1 1/2"
- ④ EXISTING LEVELING BINDER (MACHINE METHOD), MIX B, TYPE II, 1 1/2"
- ⑤ EXISTING HMA PAVEMENT (FULL DEPTH), TYPE 2, 13"
(EX. HMA SURFACE COURSE, MIX D, CLASS I, TYPE 2, 2") (AC-10)
(EX. HMA BINDER COURSE, MIX B, TYPE 2, 11") (AC-20)
- ⑥ EXISTING HMA BASE COURSE WIDENING, 9"
- ⑦ EXISTING BITUMINOUS SHOULDERS, 8"
- ⑧ EXISTING CONC. GUTTER, TYPE A
- ⑨ EXISTING SUB-BASE GRANULAR, TYPE A, 12"
- ⑩ EXISTING COMBINATION CONC. CURB & GUTTER, TYPE B-6.24
- ⑪ EXISTING LEVELING BINDER (MACHINE METHOD), MIX C, TYPE 2, VARIES

PROPOSED

- ⑫ HMA SURFACE REMOVAL 1-1/2"
- ⑬ NOT USED
- ⑭ HMA SURFACE COURSE MIX "C", N50, 1-1/2"
- ⑮ HMA SHOULDERS 8"
- ⑯ AGGREGATE SHOULDERS TYPE B
- ⑰ PAINT PAVEMENT MARKING LINE 5" (SOLID WHITE)
- ⑱ PAINT PAVEMENT MARKING LINE 5" (SKIP DASH/SOLID YELLOW)

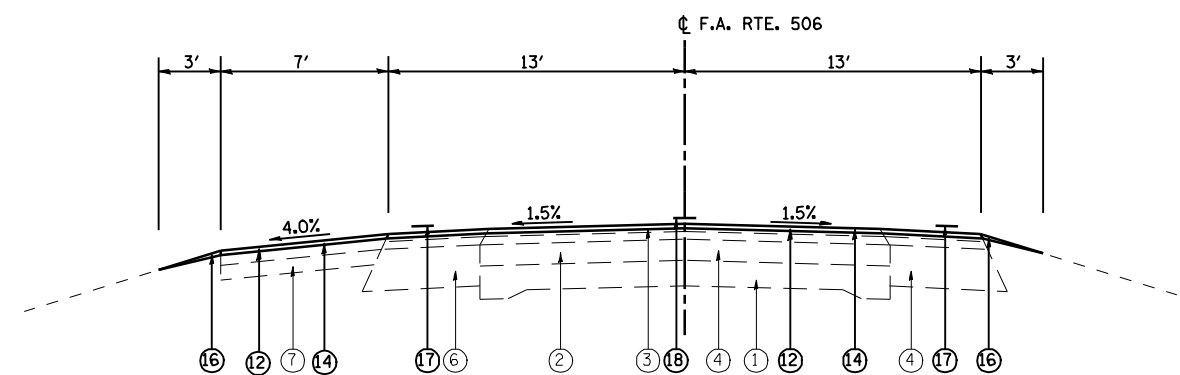

PROPOSED TYPICAL
STA. 19+43.00 TO STA. 24+20.00
STA. 26+00.00 TO STA. 30+80.00
STA. EQU. 30+80.00 BK. TO STA. 30+77.60 AH.
STA. 30+77.60 TO STA. 34+00.00
ROADWAY OMISSION STA. 34+00.00 TO STA. 42+40.00
STA. 42+40.00 TO STA. 67+41.41
STA. 80+70.04 TO STA. 108+03.54

FILE NAME =	USER NAME = laughlinr1	DESIGNED - TCG	REVISED -	STATE OF ILLINOIS DEPARTMENT OF TRANSPORTATION	PROPOSED TYPICAL SECTIONS			F.A.P. RTE.	SECTION	COUNTY	TOTAL SHEETS	SHEET NO.
e:\pwwork\pwwid\LAUGHLINRL\0198500\0672C55-sh-t-typico1.dgn	DRAWN - JJS	CHECKED - MTM	REVISED -		506	123RS-5	HANCOCK	14	8			
PLOT SCALE = 100.0000' / IN.	DATE - FEBRUARY 2010	REVISI	REVISI		CONTRACT NO. 72C55			ILLINOIS FED. AID PROJECT				
PLOT DATE = Apr-07-2010 09:36:14AM	REVISI	REVISI	REVISI		SCALE: N.T.S	SHEET NO. 1 OF 4 SHEETS	STA.	TO STA.				

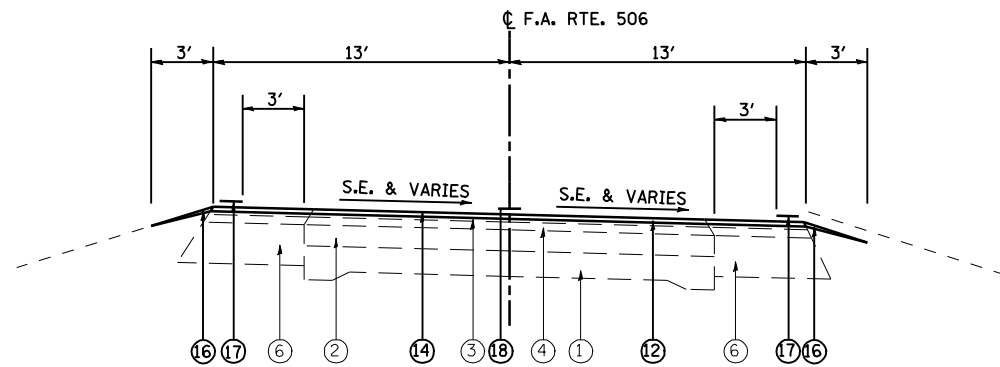

PROPOSED TYPICAL
STA. 67+41.41 TO STA. 80+70.04

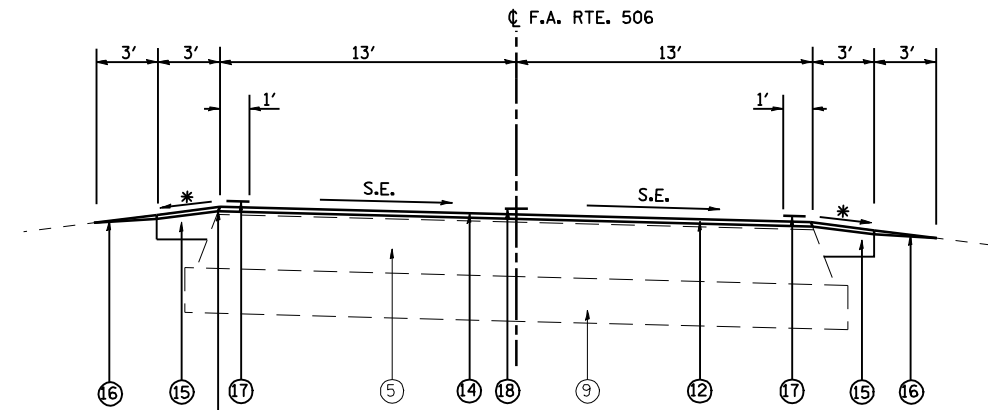

ALGEBRAIC DIFF. SHALL NOT BE GREATER THAN 8%
* SEE STD. 482001

PROPOSED TYPICAL
STA. 108+03.54 TO STA. 132+85.62

HMA SHOULDER WIDENING 8"
STA. 107+55.87 TO STA. 108+55.87
STA. 108+55.87 TO STA. 128+91.79
STA. EQ. 128+91.79 = STA. 131+32.29 AH.
STA. 131.32.29 TO STA. 132+32.29
STA. 132+32.29 TO STA. 133+32.29

WIDTH
1' TO 3' LT & RT
3' LT & RT
3' LT & RT
3' LT & RT
3' TO 1' LT & RT

LEGEND

- ① EXISTING P.C. CONCRETE PAVEMENT 9"-6"-9"
- ② EXISTING HMA SURFACE OVERLAY
- ③ EXISTING HMA SURFACE COURSE, MIX D, CLASS I, TYPE 2, 1 1/2"
- ④ EXISTING LEVELING BINDER (MACHINE METHOD), MIX B, TYPE II, 1 1/2"
- ⑤ EXISTING HMA PAVEMENT (FULL DEPTH), TYPE 2, 13"
(EX. HMA SURFACE COURSE, MIX D, CLASS I, TYPE 2, 2") (AC-10)
(EX. HMA BINDER COURSE, MIX B, TYPE 2, 11") (AC-20)
- ⑥ EXISTING HMA BASE COURSE WIDENING, 9"
- ⑦ EXISTING BITUMINOUS SHOULDERS, 8"
- ⑧ EXISTING CONC. GUTTER, TYPE A
- ⑨ EXISTING SUB-BASE GRANULAR, TYPE A, 12"
- ⑩ EXISTING COMBINATION CONC. CURB & GUTTER, TYPE B-6.24
- ⑪ EXISTING LEVELING BINDER (MACHINE METHOD), MIX C, TYPE 2, VARIES

PROPOSED

- ⑫ HMA SURFACE REMOVAL 1-1/2"
- ⑬ NOT USED
- ⑭ HMA SURFACE COURSE MIX "C", N50, 1-1/2"
- ⑮ HMA SHOULDERS 8" (ACCORDING TO STD. 482001)
- ⑯ AGGREGATE SHOULDERS TYPE B
- ⑰ PAINT PAVEMENT MARKING LINE 5" (SOLID WHITE)
- ⑱ PAINT PAVEMENT MARKING LINE 5" (SKIP DASH/SOLID YELLOW)

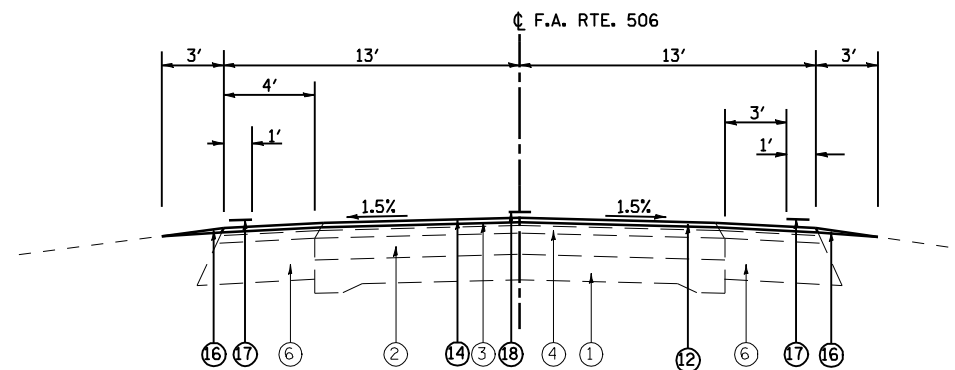

PROPOSED TYPICAL
STA. 132+85.62 TO STA. 158+96.65
STA. 186+28.35 TO STA. 206+75.00
STA. 1036+00.00 TO STA. 1041+35.00

FILE NAME =	USER NAME = laughlinr1	DESIGNED - TCG	REVISED -	STATE OF ILLINOIS DEPARTMENT OF TRANSPORTATION	PROPOSED TYPICAL SECTIONS			F.A.P. RTE.	SECTION	COUNTY	TOTAL SHEETS	SHEET NO.
e:\pwwork\pwidot\LAUGHLINRL\0198500\0672C55-sh-t-typxcol.dgn	DRAWN - JJS	REVISED -			506	123RS-5	HANCOCK	14	9			
PLOT SCALE = 100.0000' / IN.	CHECKED - MTM	REVISED -			CONTRACT NO. 72C55							
PLOT DATE = Apr-07-2010 09:36:16AM	DATE - FEBRUARY 2010	REVISED -			ILLINOIS FED. AID PROJECT							
				SCALE: N.T.S	SHEET NO. 2 OF 4 SHEETS	STA.	TO STA.					

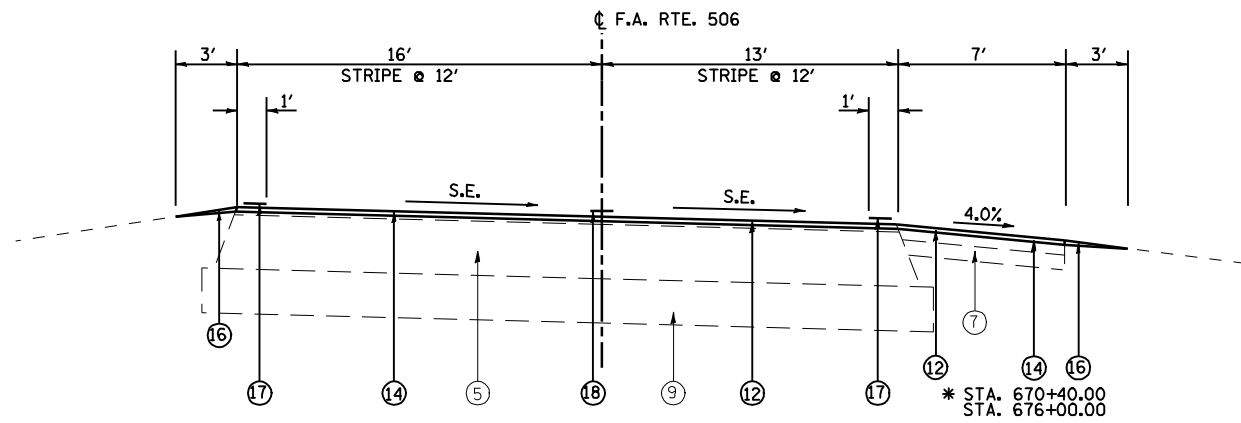

PROPOSED TYPICAL
 STA. 158+96.65 TO STA. 160+49.98
 STA. EQUATION 160+49.98 BK = STA. 660+49.98 AH
 STA. 660+49.98 TO STA. 666+74.43
 BRIDGE OMISSION STA. 666+74.43 TO STA. 667+97.65
 STA. 667+97.65 TO STA. 681+84.52

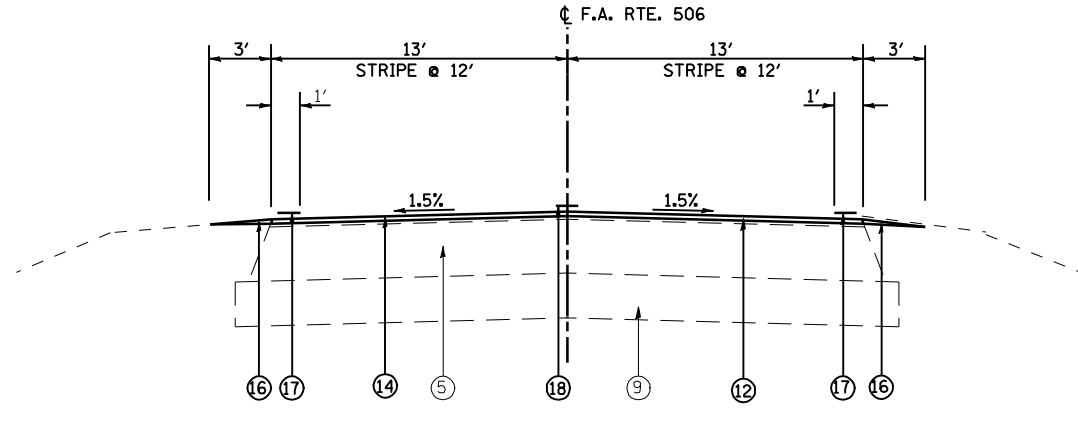

PROPOSED TYPICAL
 STA. 1041+35 TO STA. 1050+73.4

LEGEND

- ① EXISTING P.C. CONCRETE PAVEMENT 9"-6"-9"
- ② EXISTING HMA SURFACE OVERLAY
- ③ EXISTING HMA SURFACE COURSE, MIX D, CLASS I, TYPE 2, 1 1/2"
- ④ EXISTING LEVELING BINDER (MACHINE METHOD), MIX B, TYPE II, 1 1/2"
- ⑤ EXISTING HMA PAVEMENT (FULL DEPTH), TYPE 2, 13"
 (EX. HMA SURFACE COURSE, MIX D, CLASS I, TYPE 2, 2") (AC-10)
 (EX. HMA BINDER COURSE, MIX B, TYPE 2, 11") (AC-20)
- ⑥ EXISTING HMA BASE COURSE WIDENING, 9"
- ⑦ EXISTING BITUMINOUS SHOULDERS, 8"
- ⑧ EXISTING CONC. GUTTER, TYPE A
- ⑨ EXISTING SUB-BASE GRANULAR, TYPE A, 12"
- ⑩ EXISTING COMBINATION CONC. CURB & GUTTER, TYPE B-6.24
- ⑪ EXISTING LEVELING BINDER (MACHINE METHOD), MIX C, TYPE 2, VARIES

PROPOSED

- ⑫ HMA SURFACE REMOVAL 1-1/2"
- ⑬ NOT USED
- ⑭ HMA SURFACE COURSE MIX "C", N50, 1-1/2"
- ⑮ HMA SHOULDERS 8"
- ⑯ AGGREGATE SHOULDERS TYPE B
- ⑰ PAINT PAVEMENT MARKING LINE 5" (SOLID WHITE)
- ⑱ PAINT PAVEMENT MARKING LINE 5" (SKIP DASH/SOLID YELLOW)

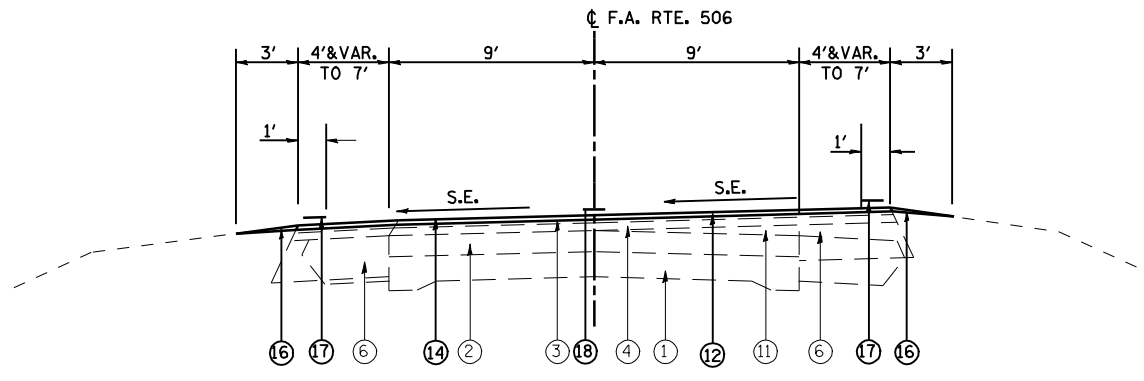

PROPOSED TYPICAL
 STA. 681+84.52 TO STA. 684+75.49
 STA. EQUATION 684+75.49 BH = STA. 184+75.02 AH
 STA. 184+75.02 TO STA. 186+28.35

FILE NAME =	USER NAME = laughlinr1	DESIGNED - TCG	REVISED -	STATE OF ILLINOIS DEPARTMENT OF TRANSPORTATION	PROPOSED TYPICAL SECTIONS			F.A.P. RTE. 506	SECTION 123RS-5	COUNTY HANCOCK	TOTAL SHEETS 14	SHEET NO. 10
es:\pwwork\pwwid\LAUGHLINRL\0198500\0672C55-shr-typicol.dgn	DRAWN - JJS	REVISIONS -	REVISIONS -		SCALE: N.T.S	SHEET NO. 3 OF 4 SHEETS	STA. TO STA.	CONTRACT NO. 72C55				
PLOT SCALE = 100.0000' / IN.	CHECKED - MTM	REVISIONS -	REVISIONS -		ILLINOIS FED. AID PROJECT							
PLOT DATE = Apr-07-2010 09:36:18AM	DATE - FEBRUARY 2010	REVISIONS -	REVISIONS -									

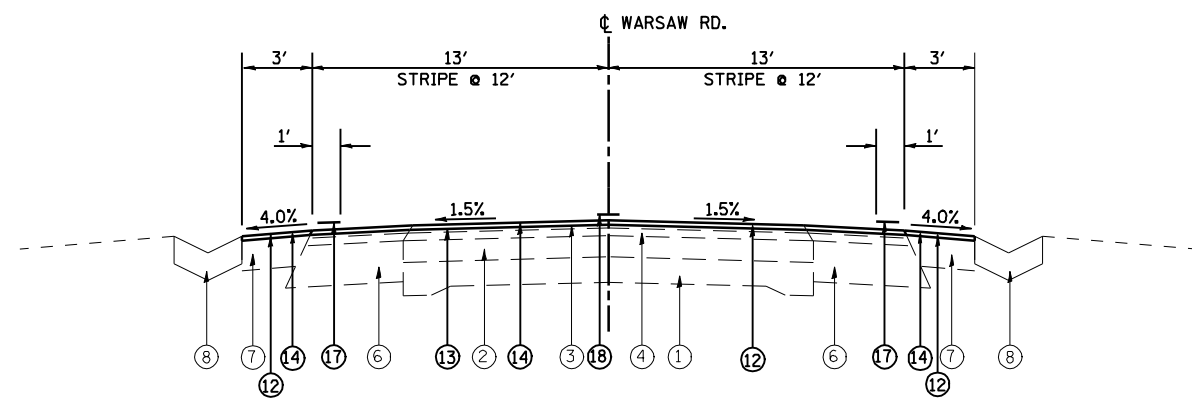

PROPOSED TYPICAL
STA. 197+50.00 TO STA. 200+00.00

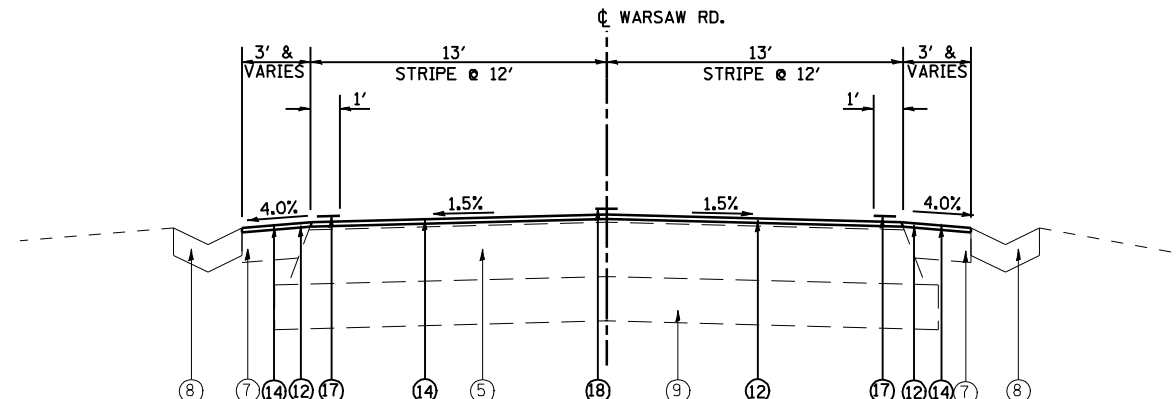

PROPOSED TYPICAL
STA. 200+00.00 TO STA. 203+52.00

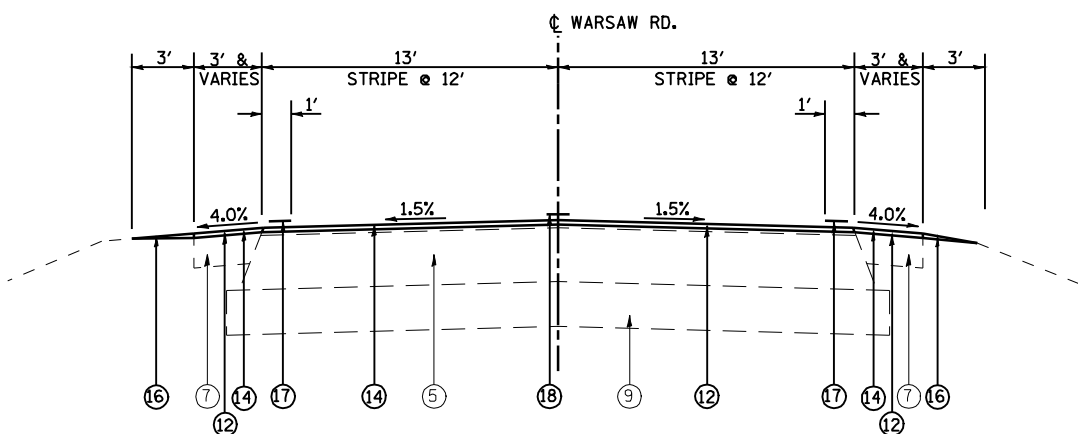

PROPOSED TYPICAL
STA. 206+75.00 TO STA. 207+90.67 (F.A.P. RTE. 506)
STA. 203+52.00 TO STA. 205+38.75 (WARSAW RD.)

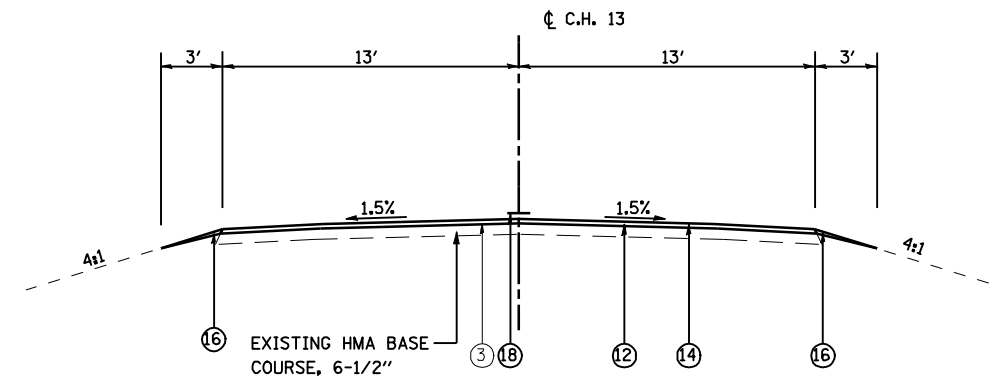

PROPOSED TYPICAL C.H. 13
STA. 0+13.00 TO STA. 4+00.00

LEGEND

- ① EXISTING P.C. CONCRETE PAVEMENT 9"-6"-9"
- ② EXISTING HMA SURFACE OVERLAY
- ③ EXISTING HMA SURFACE COURSE, MIX D, CLASS I, TYPE 2, 1 1/2"
- ④ EXISTING LEVELING BINDER (MACHINE METHOD), MIX B, TYPE II, 1 1/2"
- ⑤ EXISTING HMA PAVEMENT (FULL DEPTH), TYPE 2, 13"
(EX. HMA SURFACE COURSE, MIX D, CLASS I, TYPE 2, 2") (AC-10)
(EX. HMA BINDER COURSE, MIX B, TYPE 2, 11") (AC-20)
- ⑥ EXISTING HMA BASE COURSE WIDENING, 9"
- ⑦ EXISTING BITUMINOUS SHOULDERS, 8"
- ⑧ EXISTING CONC. GUTTER, TYPE A
- ⑨ EXISTING SUB-BASE GRANULAR, TYPE A, 12"
- ⑩ EXISTING COMBINATION CONC. CURB & GUTTER, TYPE B-6.24
- ⑪ EXISTING LEVELING BINDER (MACHINE METHOD), MIX C, TYPE 2, VARIES

PROPOSED

- ⑫ HMA SURFACE REMOVAL 1-1/2"
- ⑬ NOT USED
- ⑭ HMA SURFACE COURSE MIX "C", N50, 1-1/2"
- ⑮ HMA SHOULDERS 8"
- ⑯ AGGREGATE SHOULDERS TYPE B
- ⑰ PAINT PAVEMENT MARKING LINE 5" (SOLID WHITE)
- ⑱ PAINT PAVEMENT MARKING LINE 5" (SKIP DASH/SOLID YELLOW)

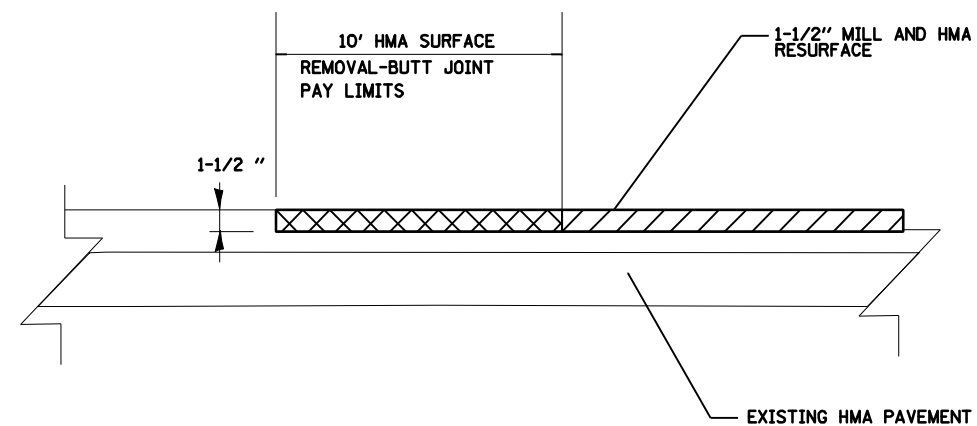

BUTT JOINT DETAIL

FILE NAME =	USER NAME = laughlinr1	DESIGNED - TCG	REVISED -	STATE OF ILLINOIS DEPARTMENT OF TRANSPORTATION	PROPOSED TYPICAL SECTIONS			F.A.P. RTE. 506	SECTION 123RS-5	COUNTY HANCOCK	TOTAL SHEETS 14	SHEET NO. 11
es:\pwwork\pwwid\LAUGHLINRL\0198500\0672C55-sh-t-typic01.dgn		DRAWN - JJS	REVISED -		SCALE: N.T.S	SHEET NO. 4 OF 4 SHEETS	STA.	TO STA.	CONTRACT NO. 72C55			
		CHECKED - MTM	REVISED -		ILLINOIS FED. AID PROJECT							
		DATE - FEBRUARY 2010	REVISED -									

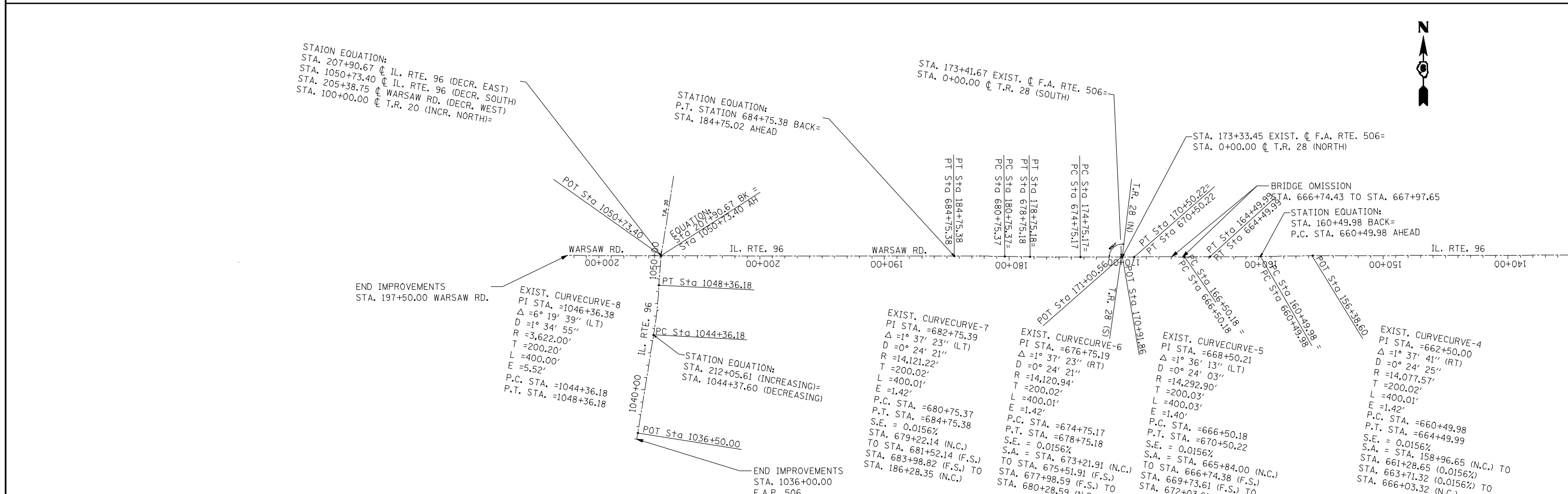
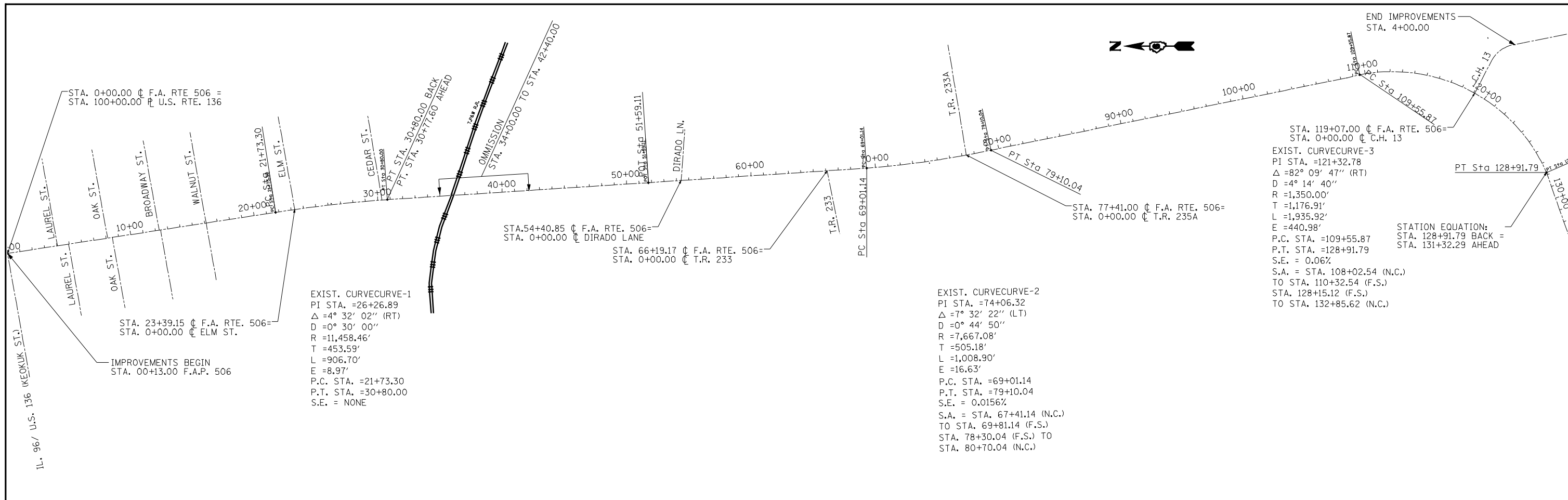

FILE NAME =	USER NAME = laughlinr1	DESIGNED - TCG	REVISED -	STATE OF ILLINOIS DEPARTMENT OF TRANSPORTATION	EXISTING ALIGNMENT IL 96		F.A.P. RTE. 506	SECTION 123RS-5	COUNTY HANCOCK	TOTAL SHEETS 14	SHEET NO. 12	
es:\pwwork\pwwid\LAUGHLINR1\0198500\0672C55-shr-plan-1196.dgn	PLOT SCALE = 800.0000' / IN.	DRAWN - JJS	REVISED -		SCALE: 1"=400'	SHEET NO. 1 OF 1 SHEETS	STA. 0+00.00 TO STA. 207+90.67	CONTRACT NO. 72C55				
PLOT DATE = Apr-07-2010 09:36:22AM	DATE - JANUARY 2010	CHECKED - MTM	REVISED -		ILLINOIS FED. AID PROJECT							
		DATE -	REVISED -									

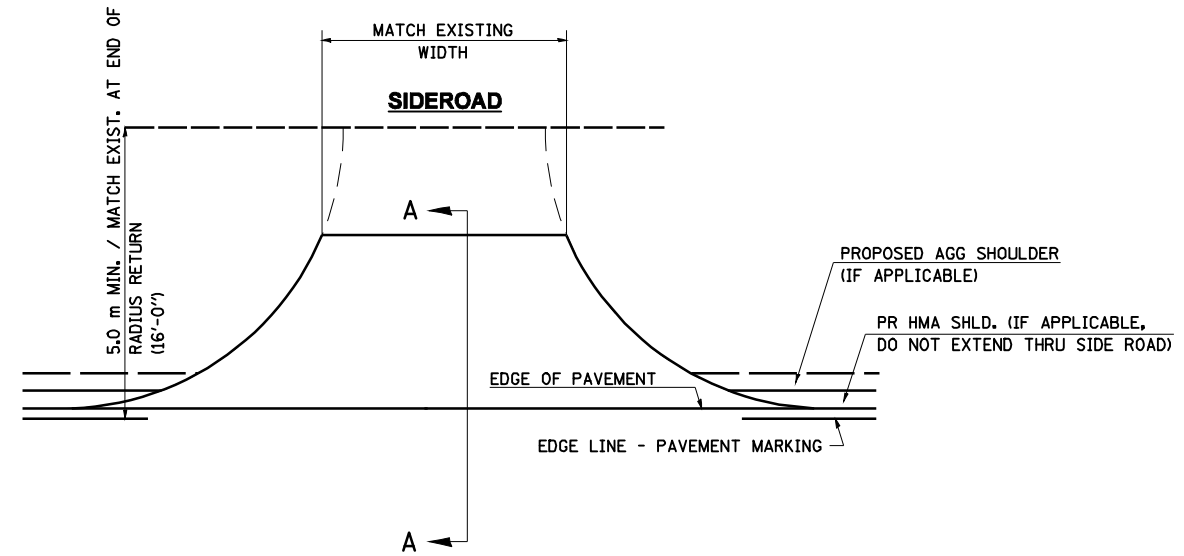
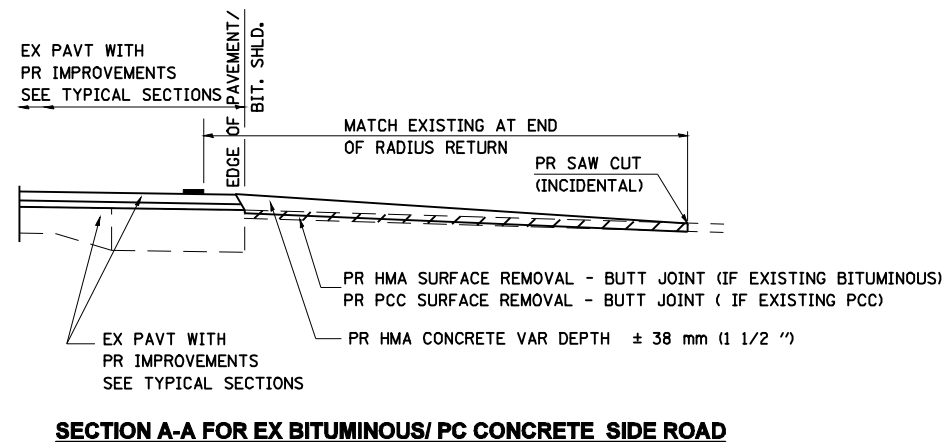
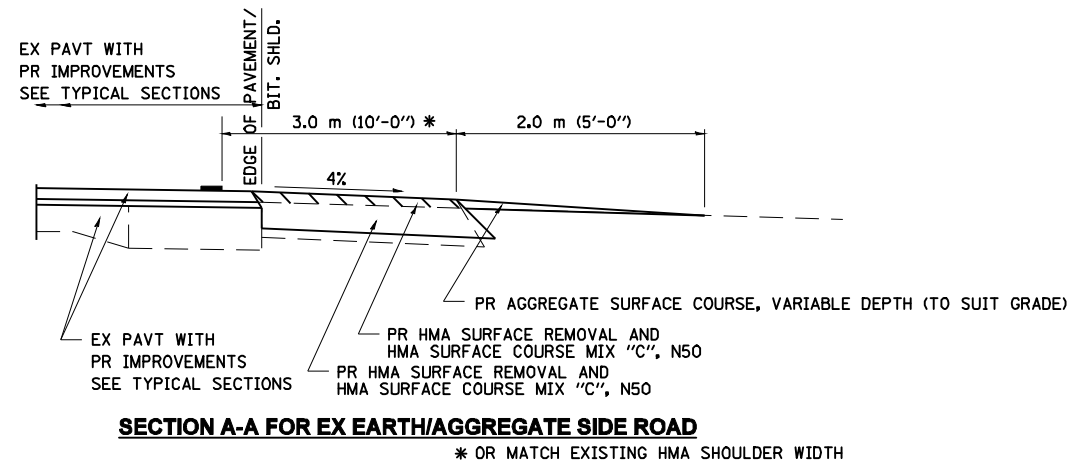

NOTE : IF BIT. SHLDS ARE PROPOSED THEY SHOULD NOT EXTEND THROUGH SIDEROADS

GENERAL NOTES:

THE RESIDENT ENGINEER WILL DETERMINE THE EXACT TYPE OF IMPROVEMENT TO BE COMPLETED FOR ALL SIDEROADS ON THIS PROJECT.

THE PLAN DETAILS AND SCHEDULES SHOULD BE USED AS A GUIDE FOR THE ENGINEER TO IMPLEMENT THE FINAL DESIGN. THE ENGINEER MAY DECIDE TO SALVAGE PORTIONS OF THE EXISTING SIDE ROAD PAVEMENT STRUCTURE; THEREFORE, REDUCING PAY ITEM QUANTITIES. NO ADDITIONAL PAYMENT WILL BE ALLOWED FOR THIS REDUCTION IN QUANTITIES.

ANY WORK THE ENGINEER REQUIRES WHICH IS NOT COVERED BY A PAY ITEM CONTAINED IN THE PLANS WILL BE PAID FOR IN ACCORDANCE WITH ARTICLE 109.04 OF THE STANDARD SPECIFICATIONS.

BITUMINOUS CONCRETE REQUIRED TO CONSTRUCT THE SIDE ROADS SHALL BE IN ACCORDANCE WITH THE APPLICABLE PORTIONS OF SECTION 406 AND 408 OF THE STANDARD SPECIFICATIONS AND AS DIRECTED BY THE ENGINEER.

THIS WORK WILL BE PAID FOR IN ACCORDANCE WITH SECTIONS 351, 358, 408, 423 AND 440 OF THE STANDARD SPECIFICATIONS.

ALL DIMENSIONS ARE IN MILLIMETERS (INCHES) UNLESS OTHERWISE SHOWN.

FILE NAME =	USER NAME = laughlinr1	DESIGNED - TCG	REVISED -
er:\pwork\PWIDOT\LAUGHLINRL\0198500\0672C55-shd-details.dgn		DRAWN - JJS	REVISED -
PLOT SCALE = 100.0000' / IN.		CHECKED - MTM	REVISED -
PLOT DATE = Apr-07-2010 09:36:25AM		DATE - FEBRUARY 2010	REVISED -

**STATE OF ILLINOIS
DEPARTMENT OF TRANSPORTATION**

**DETAILS FOR RURAL/URBAN
SIDEROADS W /O CONCRETE GUTTER (PPP)**

SCALE: N.T.S. SHEET NO. 1 OF 1 SHEETS STA. TO STA.

F.A.P. RTE.	SECTION	COUNTY	TOTAL SHEETS	SHEET NO.
506	123RS-5	HANCOCK	14	13
CONTRACT NO. 72C55				
ILLINOIS FED. AID PROJECT				

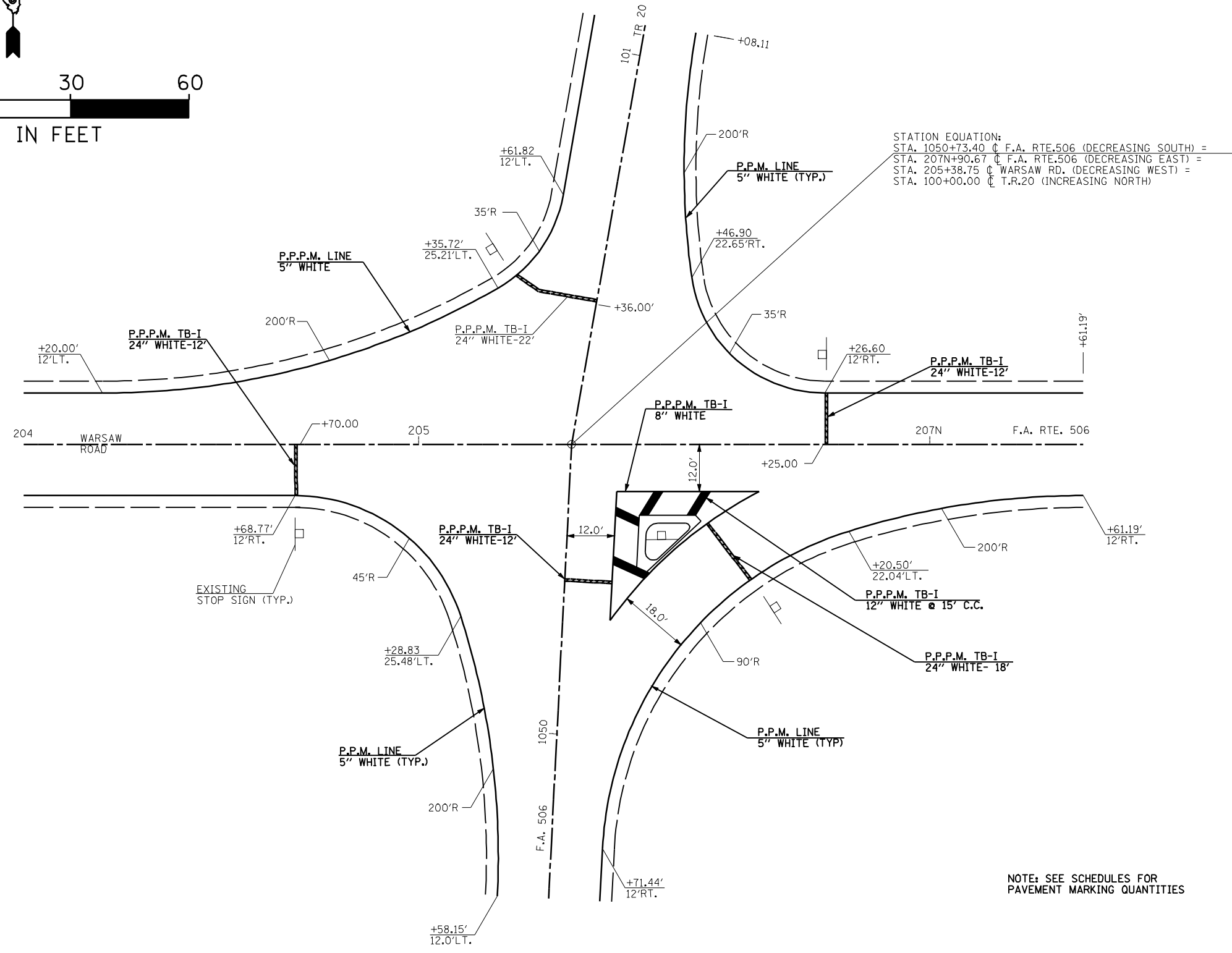
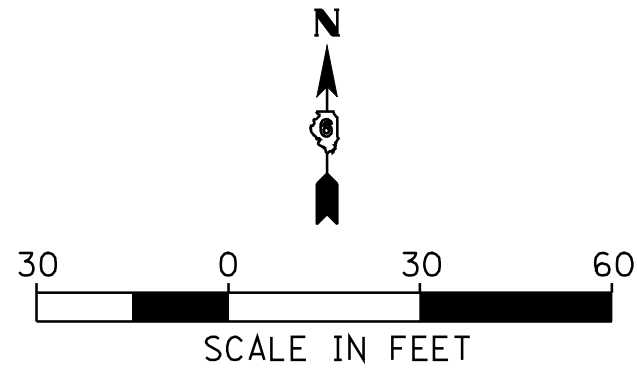

NOTE: SEE SCHEDULES FOR PAVEMENT MARKING QUANTITIES

FILE NAME =	USER NAME = laughlinr1	DESIGNED - TCG	REVISED -	STATE OF ILLINOIS DEPARTMENT OF TRANSPORTATION	PROPOSED INTERSECTION DETAIL			F.A.P. RTE.	SECTION	COUNTY	TOTAL SHEETS	SHEET NO.
e:\pwwork\pwidot\LAUGHLINRL\0198500\0672C55-sht-details.dgn	DRAWN - JJS	REVISED -			506	123RS-5	HANCOCK	14	14			
PLOT SCALE = 100.0000' / IN.	CHECKED - MTM	REVISED -			CONTRACT NO. 72C55							
PLOT DATE = Apr-07-2010 09:36:27AM	DATE - FEBRUARY 2010	REVISED -			ILLINOIS FED. AID PROJECT							
				SCALE: 1"=30'	SHEET NO. 1 OF 1 SHEETS	STA.	TO STA.					