

EXIST. CURVE 102
 PI STA. = 497+88.08
 $\Delta = 39^\circ 16' 07''$ (RT)
 $D = 2^\circ 47' 52''$
 $R = 2,047.96'$
 $T = 730.63'$
 $L = 1,403.60'$
 $E = 126.43'$
 $e = 5.4$
 $T.R. = 41.94$
 $S.E. RUN = 151$
 $P.C. STA. = 490+57.46$
 $P.T. STA. = 504+61.06$

S.E.T. STA 503+84.40 TO STA 487+96.03

STA EQA STA 504+61.07 (BK) =
 STA 486+41.30 (AH)

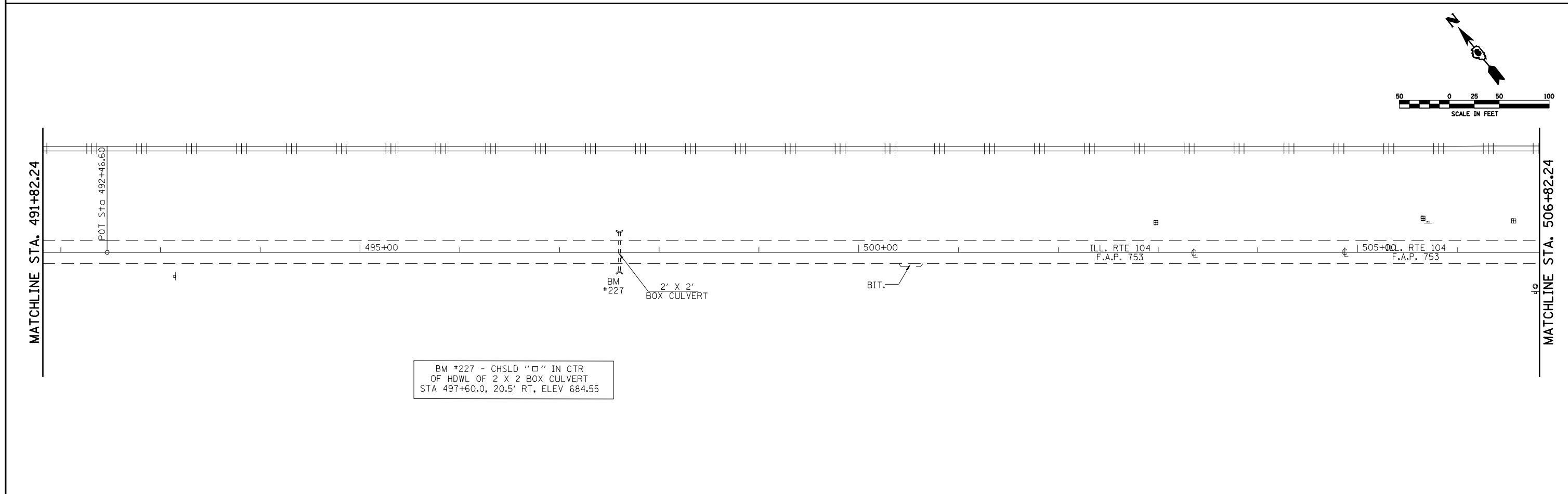

BM #227 - CHSLD "□" IN CTR
 OF HDWL OF 2 X 2 BOX CULVERT
 STA 497+60.0, 20.5' RT, ELEV 684.55

FILE NAME =	USER NAME = laughlinr1	DESIGNED -	REVISED -	STATE OF ILLINOIS DEPARTMENT OF TRANSPORTATION	PLAN SHEET - IL 104		F.A.P. -	SECTION	COUNTY	TOTAL	SHEET
es:\pwwork\pwwid\LAUGHLINRL\0120394\0672C66-SHT-plan1.dgn	DRAWN -	REVISED -	753				(128)RS-3	MORGAN	SHEETS	NO.	
PLOT SCALE = 100.0000' / IN.	CHECKED -	REVISED -	CONTRACT NO. 72C66			26	18				
PLOT DATE = Mar-29-2010 10:07:49AM	DATE -	REVISED -	ILLINOIS FED. AID PROJECT								
				SCALE:	SHEET NO. 18 OF 26 SHEETS	STA.	TO STA.				