

F.A.P. RTE.	SECTION	COUNTY	TOTAL SHEETS	SHEET NO.
302	1-7(RS)	ADAMS	38	1
		ILLINOIS	CONTRACT NO. 72D14	

STATE OF ILLINOIS
DEPARTMENT OF TRANSPORTATION
DIVISION OF HIGHWAYS

**PROPOSED
HIGHWAY PLANS**

F.A.P. ROUTE 302 (IL 336)
SECTION 1-7(RS)

**3P ROADWAY RESURFACING
ADAMS COUNTY**

C-96-117-10

FOR INDEX OF SHEETS AND HIGHWAY STANDARDS, SEE SHEET NO. 2

D-96-117-10

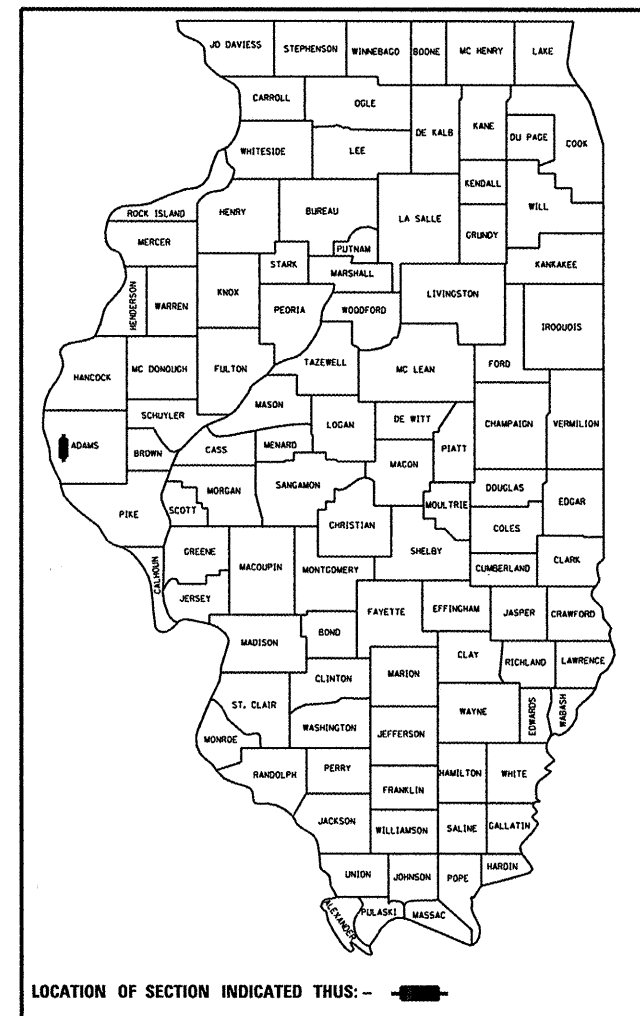

LOCATION OF SECTION INDICATED THUS: -

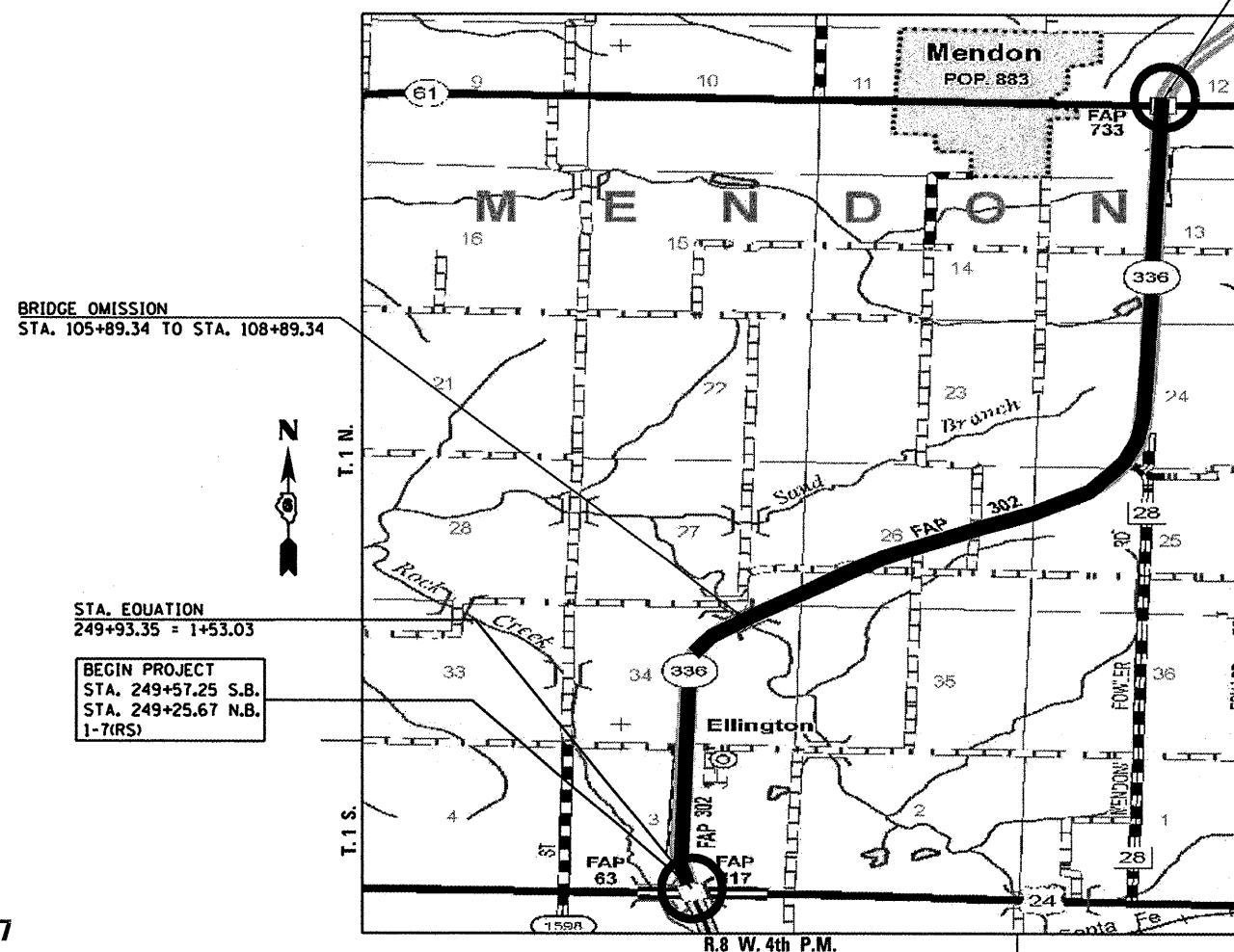

END PROJECT
STA. 344+00.00
N.B. & S.B.
1-7(RS)

BRIDGE OMISSION
STA. 105+89.34 TO STA. 108+89.34

STA. EQUATION
249+93.35 = 1+53.03

BEGIN PROJECT
STA. 249+57.25 S.B.
STA. 249+25.67 N.B.
1-7(RS)

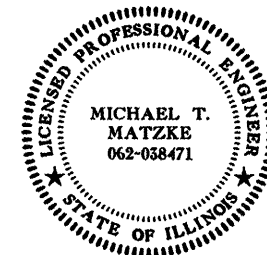

Michael T. Matzke
SIGNATURE

April 8, 2010
DATE
LIC. EXP. DATE: 11/30/2011

STATE OF ILLINOIS
DEPARTMENT OF TRANSPORTATION
DIVISION OF HIGHWAYS

SUBMITTED: April 7, 2010
Royce D. Park
DEPUTY DIRECTOR OF HIGHWAYS, REGION ENGINEER

May 7, 2010
Scott E. Stitt, P.E.
ACTING ENGINEER OF DESIGN AND ENVIRONMENT

May 7, 2010
Christine M. Reed, P.E.
DIRECTOR OF HIGHWAYS, CHIEF ENGINEER

**PRINTED BY THE AUTHORITY
OF THE STATE OF ILLINOIS**

CURRENT TRAFFIC DATA
ADT 4600 (2009)
TRUCKS: 18% SU, 13% MU

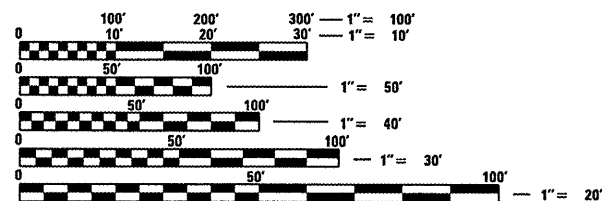

FULL SIZE PLANS HAVE BEEN PREPARED USING STANDARD ENGINEERING SCALES. REDUCED SIZED PLANS WILL NOT CONFORM TO STANDARD SCALES. IN MAKING MEASUREMENTS ON REDUCED PLANS, THE ABOVE SCALES MAY BE USED.

J.U.L.I.E.
JOINT UTILITY LOCATION INFORMATION FOR EXCAVATION
1-800-892-0123
OR 811

TEAM ENGINEER: MARK DUST (217) 785-0597
PROJECT ENGINEER: JOHN NEGANGARD (217) 782-6990

CONTRACT NO. 72D14

GROSS LENGTH = 34,314.65 FT. = 6.499 MILE
NET LENGTH = 34,014.65 FT. = 6.442 MILE