

STATE OF ILLINOIS
DEPARTMENT OF TRANSPORTATION

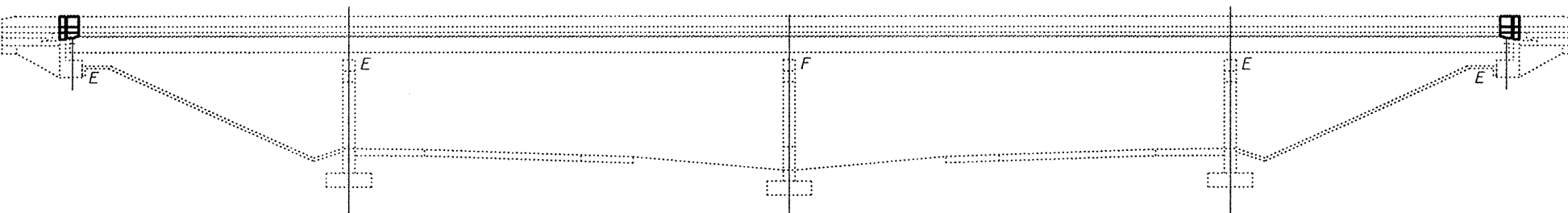

ELEVATION

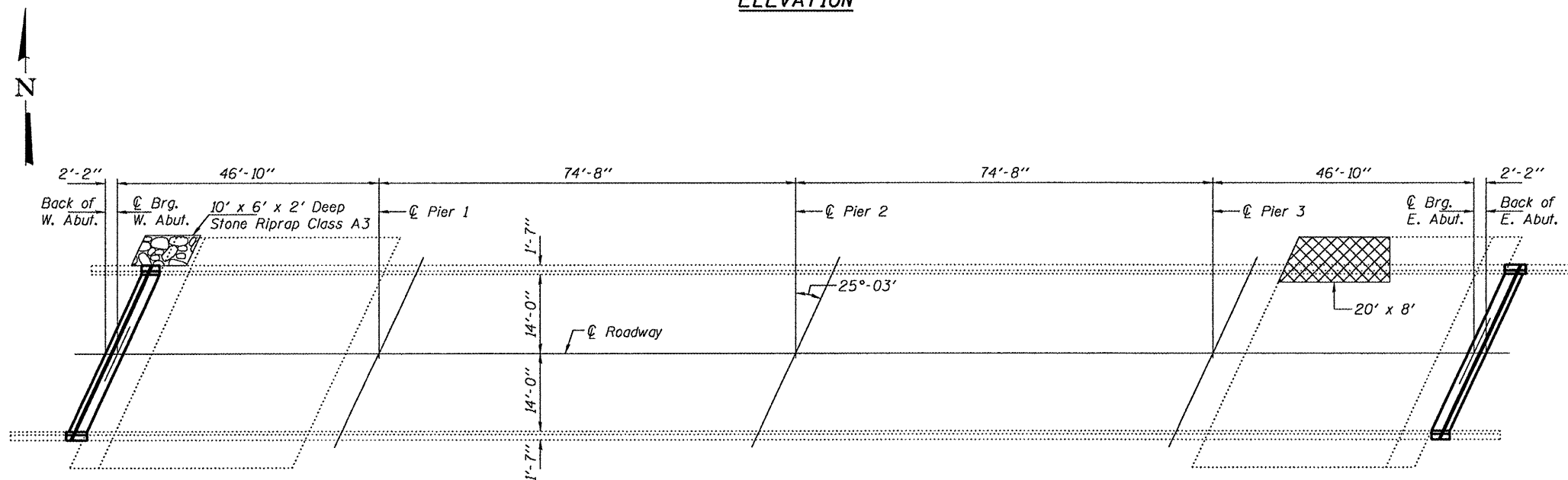

PLAN

NOTES:

Slopewall shall be reinforced with welded wire fabric, 6" x 6" - W4.0 x W4.0 weighing 58 lbs. per 100 sq. ft. Cost included with Slopewall 4".

Existing and new welded wire fabric should overlap at least 6". Any void should be filled with Porous Granular Embankment prior to placement of new slopewall. Cost included with Slopewall 4".

GENERAL NOTES

Existing reinforcement bars extending into the removal area shall be cleaned, straightened and incorporated into the new construction. Any reinforcement bars that are damaged during concrete removal shall be replaced with an approved bar splicer or anchorage system. Cost included with Concrete Removal.

Joint openings shall be adjusted according to Article 520.04 of the Std. Specs. when the deck is poured at an ambient temperature other than 50° F.

Prior to pouring the new concrete deck, all heavy or loose rust, loose mill scale, and other loose or potentially detrimental foreign material shall be removed from the surfaces in contact with concrete. Tightly adhered paint may remain unless otherwise noted. Removal shall be accomplished by methods that will not damage the steel and the cost will be included in the pay item covering removal of the existing concrete.

The existing structural steel coating contains lead. The Contractor shall take appropriate precautions to deal with the presence of lead on this project.

Reinforcement bars shall conform to the requirements of ASTM A 706 Gr 60. See Special Provisions.

Reinforcement bars designated (E) shall be epoxy coated.

Plan dimensions and details relative to existing plans are subject to nominal construction variations. The Contractor shall field verify existing dimensions and details affecting new construction and make necessary approved adjustments prior to construction or ordering of materials. Such variations shall not be cause for additional compensation for a change in scope of the work, however, the Contractor will be paid for the quantity actually furnished at the unit price bid for the work.

The deck surface shall have its final finish tined according to Article 420.09(e)(1) of the Standard Specifications. Cost included with Concrete Superstructure.

 - Slopewall Removal & Replacement

TOTAL BILL OF MATERIAL

ITEM	UNIT	QUANTITY
Concrete Removal	Cu. Yd.	9.0
Concrete Superstructure	Cu. Yd.	9.2
Preformed Joint Strip Seal	Foot	66
Reinforcement Bars, Epoxy Coated	Pound	1260
Bar Splicers	Each	24
* Protective Coat	Sq. Yd.	52.0
Slopewall Removal	Sq. Yd.	18.0
Slopewall 4"	Sq. Yd.	18.0
Stone Riprap Class A3	Sq. Yd.	7.0
Filter Fabric	Sq. Yd.	7.0

* On new concrete only

PLAN AND ELEVATION
TR 33 OVER FAI 55
SN 084-0100

DESIGNED *Jim J. Foley*
CHECKED *Adriani-Halloway*
DRAWN *baliva*
CHECKED *IJL ATH*

MAY 7, 2010
EXAMINED *Ralph E. Anderson*
PASSED *Ralph E. Anderson*
ENGINEER OF STRUCTURAL SERVICES
ENGINEER OF BRIDGES AND STRUCTURES

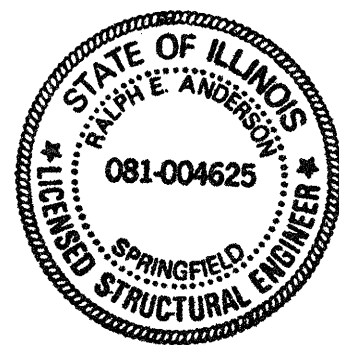

EXPIRES 11-30-2010

SHEET NO. 1	F.A.I. RTE.	SECTION	COUNTY	TOTAL SHEETS	SHEET NO.
	55	84 2(RS-3)	SANGAMON	156	149
5 SHEETS					
FED. ROAD DIST. NO.			ILLINOIS FED. AID PROJECT		
CONTRACT NO. 72D43					