

F.A.S. RTE.	SECTION	COUNTY	TOTAL SHEETS	SHEET NO.
731	1(1-3)	MACOUPIN	18	1
ILLINOIS				

STATE OF ILLINOIS
DEPARTMENT OF TRANSPORTATION
DIVISION OF HIGHWAYS
PLANS FOR PROPOSED
CONTRACT MAINTENANCE

FAS ROUTE 731 (SCOTTVILLE ROAD)
SECTION (1)I-3

MACOUPIN COUNTY
C-96-173-10

INDEX OF SHEETS

- 1 COVER SHEET
- 2 GENERAL NOTES /MIX REQUIREMENTS
- 3, 4 SUMMARY OF QUANTITIES
- 5, 6 TYPICAL CROSS SECTIONS
- 7, 8 SCHEDULE OF QUANTITIES
- 9-16 PLAN LAYOUT SHEETS
- 17 SIDEROAD /ENTRANCE DETAIL
- 18 BUTT JOINT DETAILS

LIST OF STANDARDS

000001-05	701306-02
001006	701311-03
701001-02	701326-03
701006-03	701501-05
701011-02	701901-01
701301-03	780001-02

D-96-173-10

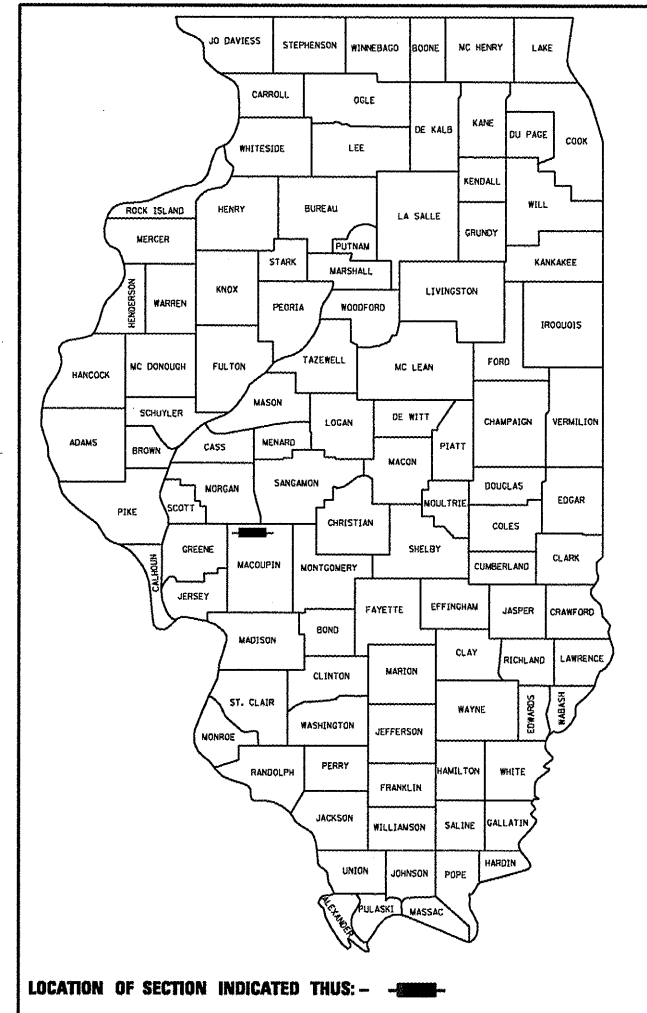

STATION: 11+95 TO 91+15
3' HMA SHOULDER CONSTRUCTION

STATION 11+95 TO 353+76
3" HMA MIXTURE FOR STABILIZED BASE,
CA 7 MIX (WITH CLASS A-1 TREATMENT)

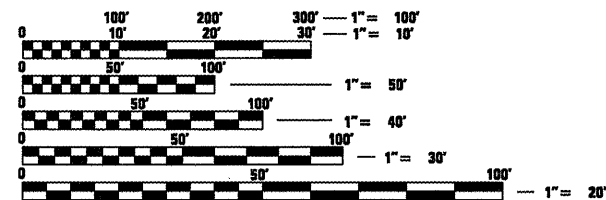

FULL SIZE PLANS HAVE BEEN PREPARED USING STANDARD ENGINEERING SCALES. REDUCED SIZED PLANS WILL NOT CONFORM TO STANDARD SCALES. IN MAKING MEASUREMENTS ON REDUCED PLANS, THE ABOVE SCALES MAY BE USED.

J.U.L.I.E.
 JOINT UTILITY LOCATION INFORMATION FOR EXCAVATION
 1-800-892-0123
 OR 811

PROJECT ENGINEER: SAL MADONIA (217) 782-4761
 PROJECT MANAGER: MARCUS BRUCE (217) 524-0946

CONTRACT NO. 72D45

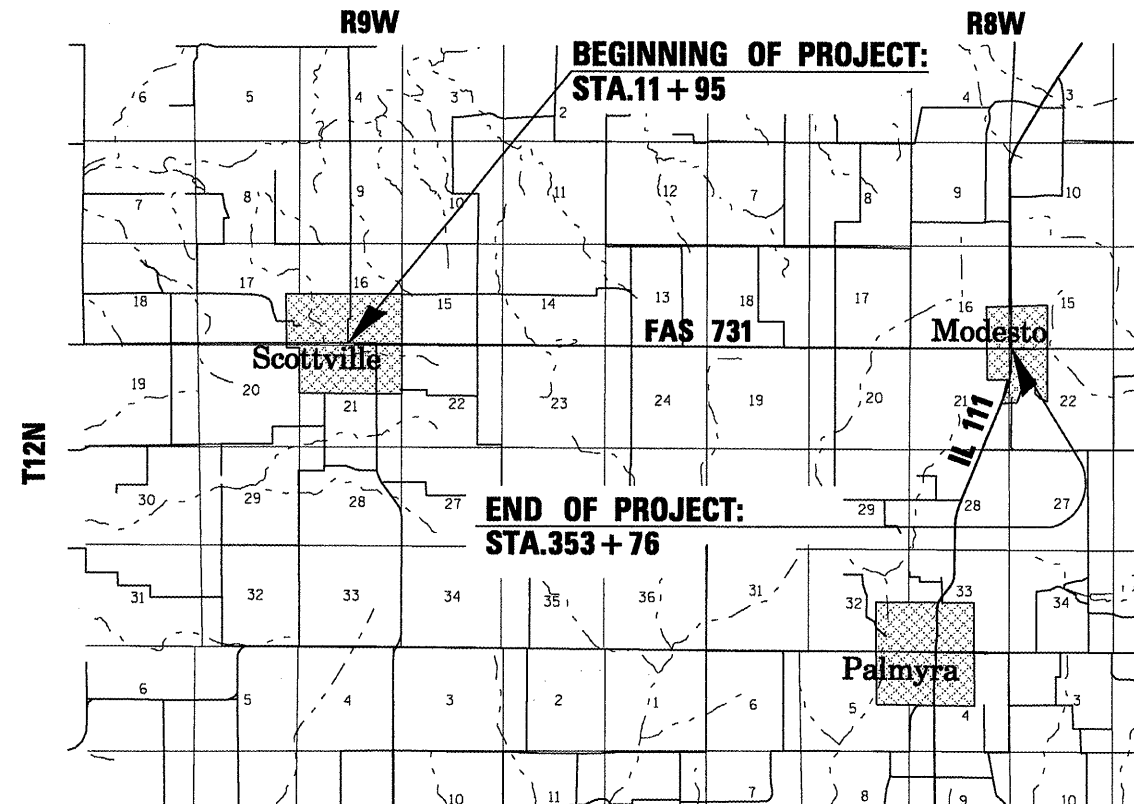

LOCATION MAP

GROSS LENGTH = 34,181 FT. = 6.474 MILES
 NET LENGTH = 34,181 FT. = 6.474 MILES

ADT: 457 (2010)
 CRS: 3.1 (2010)

STATE OF ILLINOIS
 DEPARTMENT OF TRANSPORTATION
 DIVISION OF HIGHWAYS

SUBMITTED *April 8 2010*
Rep 2 Paul
 DEPUTY DIRECTOR OF HIGHWAYS, REGION ENGINEER

May 7 2010
Scott Estitt P.E. /a
 acting ENGINEER OF DESIGN AND ENVIRONMENT

May 7 2010
Christine M. Reed /a
 DIRECTOR OF HIGHWAYS, CHIEF ENGINEER

PRINTED BY THE AUTHORITY
OF THE STATE OF ILLINOIS