

STATE OF ILLINOIS
 DEPARTMENT OF TRANSPORTATION
 DIVISION OF HIGHWAYS

PROPOSED
 HIGHWAY PLANS

VARIOUS ROUTES
 SECTION BDGE DECK SEALING 2010-1

BRIDGE DECK SEALING
 VARIOUS COUNTIES

C-96-180-10

FOR INDEX OF SHEETS, SEE SHEET NO. 2

F.A. RTE.	SECTION	COUNTY	TOTAL SHEETS	SHEET NO.
..	***	..	8	1
ILLINOIS			CONTRACT NO. 72D49	

- VARIOUS ROUTES
- BROWN, PIKE, AND SCHUYLER COUNTIES
- BDGE DECK SEALING 2010-1

D-96-180-10

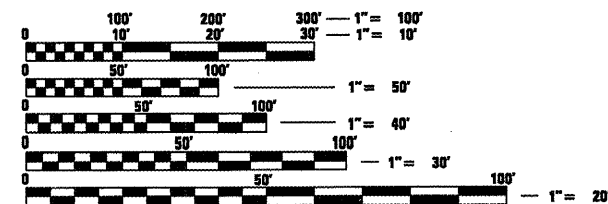
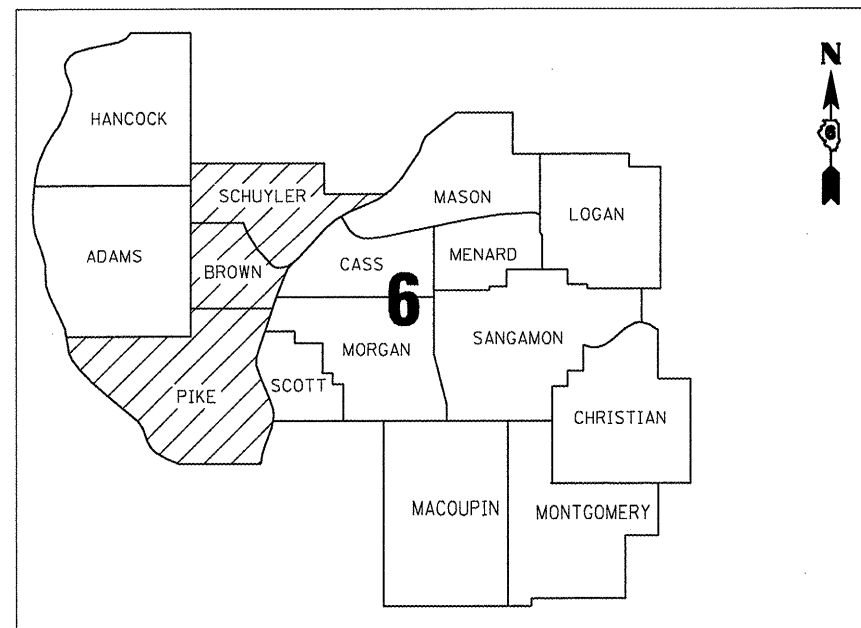
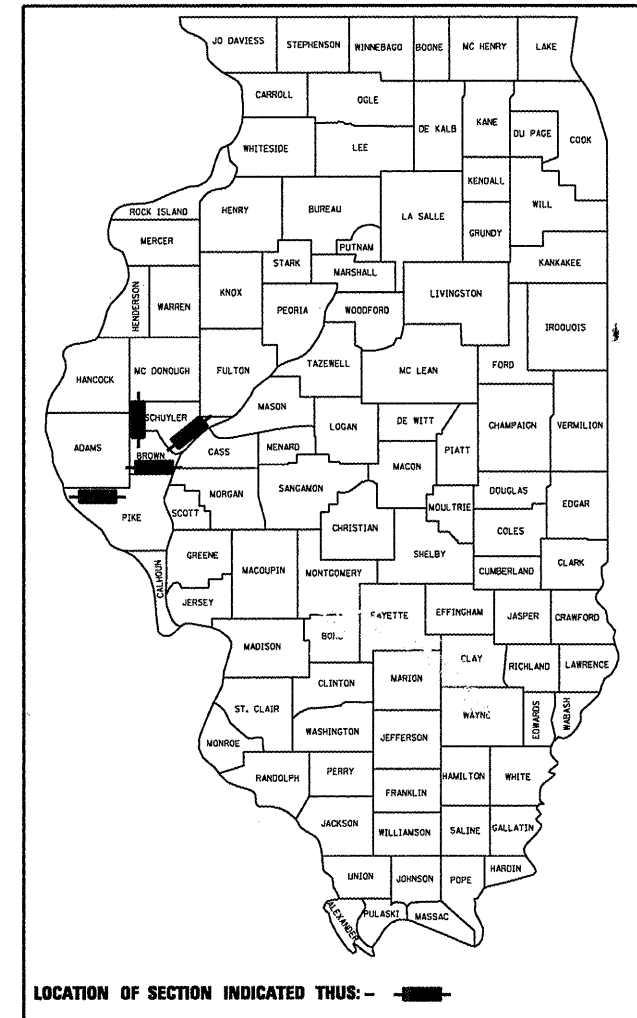

FULL SIZE PLANS HAVE BEEN PREPARED USING STANDARD ENGINEERING SCALES. REDUCED SIZED PLANS WILL NOT CONFORM TO STANDARD SCALES. IN MAKING MEASUREMENTS ON REDUCED PLANS, THE ABOVE SCALES MAY BE USED.

J.U.L.I.E.
 JOINT UTILITY LOCATION INFORMATION FOR EXCAVATION
 1-800-892-0123
 OR 811

PROJECT ENGINEER SAL MADONIA 217-782-4761
 TEAM MANAGER TOM COX 217-524-7940

CONTRACT NO. 72D49

STATE OF ILLINOIS
 DEPARTMENT OF TRANSPORTATION
 DIVISION OF HIGHWAYS

SUBMITTED *March 9* 20 *10*
Regan Z. Dinkel
 DEPUTY DIRECTOR OF HIGHWAYS, REGION ENGINEER

May 7 20 *10*
Scott E. Still, P.E. /s/
 ACTING ENGINEER OF DESIGN AND ENVIRONMENT

May 7 20 *10*
Christine M. Reed /s/
 DIRECTOR OF HIGHWAYS, CHIEF ENGINEER

PRINTED BY THE AUTHORITY
 OF THE STATE OF ILLINOIS

SUMMARY OF QUANTITIES			
CODE NO.	ITEM	UNIT	100% STATE
			TOTAL QUANTITY
58700300	CONCRETE SEALER	SQ FT	423, 293
67100100	MOBILIZATION	L SUM	1
70100450	TRAFFIC CONTROL AND PROTECTION, STANDARD 701201	L SUM	1
70100700	TRAFFIC CONTROL AND PROTECTION, STANDARD 701406	L SUM	1

- * VARIOUS ROUTES
- ** BROWN, PIKE, AND SCHUYLER COUNTIES
- *** BDGE DECK SEALING 2010-1

CONCRETE SEALER

LOCATION			DECK LENGTH	DECK WIDTH	PARAPET LT	PARAPET RT	AREA	TC&P
			(FT)	(FT)	(FT)	(FT)	(SQ FT)	
BROWN COUNTY								
STRUCTURE NO.	FACILITY CARRIED	LOCATION						
0050002	IL 107	7.2M S IL99-MT STRLG	565	30	3.77	3.77	21,210	701201
0050003	IL 99	2.6M S 2ND-VERSAILLES	22.3	41.1	0.00	0.00	917	701201
0050004	IL 99	4M S 2ND-VERSAILLES	22.2	41.2	0.00	0.00	915	701201
PIKE COUNTY								
STRUCTURE NO.	FACILITY CARRIED	LOCATION						
0750036	ILL 96	.5MI S KINDERHOOK	364.3	31.4	3.77	3.77	14,186	701201
0750038	ILL 96	AT NEW CANTON	270	24.5	3.77	3.77	8,651	701201
0750076	IL 96 / 106	1M E IL96/106 SPLIT	283	41.1	3.77	3.77	13,765	701201
0750084	I-72 / US 36 (EB)	2.43M W IL96/HULL IN	480	38.5	3.77	3.77	22,099	701406
0750085	I-72 / US 36 (WB)	2.43M W IL96/HULL IN	480	38.5	3.77	3.77	22,099	701406
0750086	I-72 / US 36 (EB)	2.12M W IL96/HULL IN	414	38.5	3.77	3.77	19,061	701406
0750087	I-72 / US 36 (WB)	2.12M W IL96/HULL IN	414	38.5	3.77	3.77	19,061	701406
0750089	IL 96	I-72/IL96 INT (HULL)	227.5	61.5	3.77	3.77	15,707	701201
0750090	I-72 (EB)	1.8M E HULL INTCHG	591.3	38.5	3.77	3.77	27,223	701406
0750091	I-72 (WB)	1.8M E HULL INTCHG	591.3	38.5	3.77	3.77	27,223	701406
0750094	I-72 EB	3.3M E HULL INTCHG	97.7	38.5	3.77	3.77	4,498	701406
0750095	I-72 WB	3.3M E HULL INTCHG	98.2	38.5	3.77	3.77	4,521	701406
0750096	I-72 EB	3.7M W BARRY INTCHG	172.6	38.5	3.77	3.77	7,947	701406
0750097	I-72 WB	3.7M W BARRY INTCHG	174.6	38.5	3.77	3.77	8,039	701406
0750100	FAI 72 EB	3.4 MI W BARRY INT	169.3	38.5	3.77	3.77	7,795	701406
0750101	FAI 72 WB	3.4 MI W BARRY INT	166.4	38.5	3.77	3.77	7,661	701406
0750102	IL 106	2.5MI NE KINDERHOOK	169.4	32.5	3.77	3.77	6,783	701201
0750124	I-72 EB	2M E HULL INTCHG	145.8	38.5	3.77	3.77	6,713	701406
0750125	I-72 WB	2M E HULL INTCHG	145.8	38.5	3.77	3.77	6,713	701406
0750130	I-72/US 36 (WB)	I-72/I-172 TRMPT INT	230.8	38.5	3.77	3.77	10,626	701406
0750131	I-72EB TO I-172NB	I-72/I-172 TRMPT INT	229.8	24.5	3.77	3.77	7,363	701406
0750139	IL 96	.67M N I-72/HULL INT	70	32.5	3.77	3.77	2,803	701201
0750152	I-72/US 36 (EB)	2M SW I-172	200.1	37.9	3.77	3.77	9,093	701406
0750153	I-72/US 36 (WB)	2M SW I-172	200.1	37.9	3.77	3.77	9,093	701406
0750155	IL 106	1.2M E MO BORDER	223.8	54.6	3.77	3.77	13,907	701201
0750181	I-72/US 36 (WB)	1.03M E I-172	151.6	50.5	3.77	3.77	8,799	701406
0750182	I-72/US 36 (EB)	1.03M E I-172	151.6	38.5	3.77	3.77	6,980	701406
0750500	ILL 96	2.0 MI SE KINDERHOOK	119.4	32	3.77	3.77	4,721	701201
0750505	IL 106	1.3 MI NW BARRY	249.3	34.6	3.77	3.77	10,506	701201
0750507	IL 106	2.1 M W OF IL 96	73	34.5	3.77	3.77	3,069	701201
SCHUYLER COUNTY								
STRUCTURE NO.	FACILITY CARRIED	LOCATION						
0850005	IL 103	2.4M W US 67	205.5	41.2	3.77	3.77	10,016	701201
0850008	IL 100	3.7M N BROWNING CTR	25.4	35.1	3.77	3.77	1,083	701201
0850010	IL 100	1.1M N BROWNING CTR	26	31.6	3.77	3.77	1,018	701201
0850011	IL 100	.5M N BROWNING CTR	22	31.6	3.77	3.77	861	701201
0850025	IL 101	2.5M E IL61-AUGUSTA	147.5	30.5	3.77	3.77	5,611	701201
0850026	IL 101	2.4M E IL 99	64.5	30.5	3.77	3.77	2,454	701201
0850030	IL 99	1M N BROWN COUNTY	200	30.5	3.77	3.77	7,608	701201
0850031	IL 99	.25M N BROWN COUNTY	150	30.5	3.77	3.77	5,706	701201
0850032	IL 100	E EDGE BROWNING	78.8	31	3.77	3.77	3,037	701201
0850033	IL 100	1.9M S BROWNING CTR	80	30.5	3.77	3.77	3,043	701201
0850035	IL 100	E EDGE BLUFF CITY	98.4	32	3.77	3.77	3,891	701201
0850036	IL 100	E EDGE SHELDON GROVE	99.2	32	3.77	3.77	3,922	701201
0850038	IL 100	1.5M N BROWNING CTR	75.5	32	3.77	3.77	2,985	701201
0850039	IL 100	2.3M N FREDERICK	328.1	30	3.77	3.77	12,317	701201
TOTAL							423,293	

* VARIOUS ROUTES
 ** BROWN, PIKE, AND SCHUYLER COUNTIES
 *** BDGE DECK SEALING 2010-1

FILE NAME =	USER NAME = laughlinc	DESIGNED -	REVISED -	STATE OF ILLINOIS DEPARTMENT OF TRANSPORTATION	SCHEDULE OF QUANTITIES				F.A. RTE.	SECTION	COUNTY	TOTAL SHEETS	SHEET NO.
ca:\pwork\PIWDOT\LAUGHLIN\LD0180365\72049-sht-schedule.dgn		DRAWN -	REVISED -		SCALE:	SHEET NO.	OF	SHEETS	STA.	TO STA.	**	8	4
PLOT SCALE = 100.0000' / IN.		CHECKED -	REVISED -		CONTRACT NO. 72D49								
PLOT DATE = Mar-09-2010 08:50:04AM		DATE -	REVISED -		ILLINOIS FED. AID PROJECT								

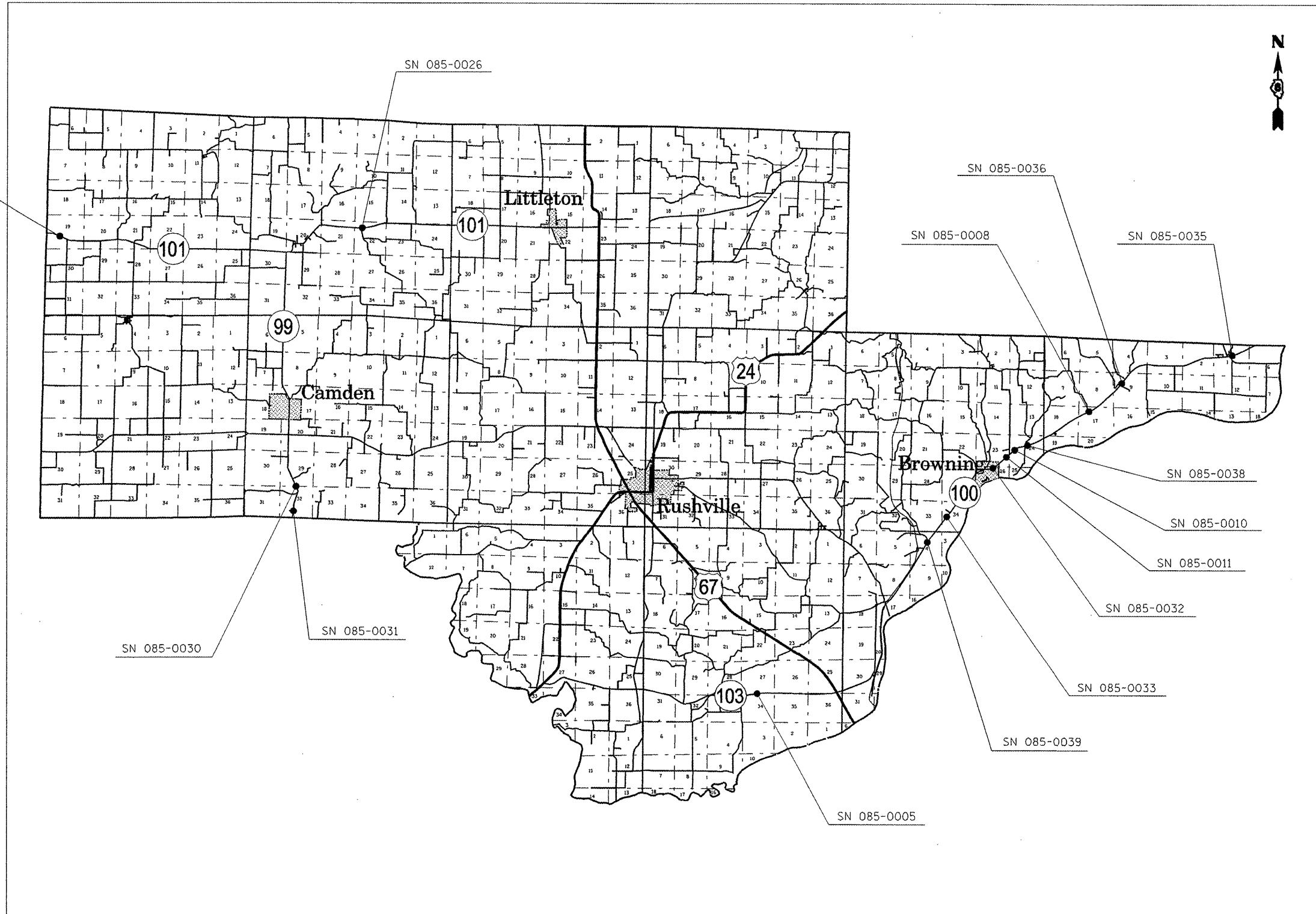

SCHUYLER COUNTY

- * VARIOUS ROUTES
- ** BROWN, PIKE, AND SCHUYLER COUNTIES
- *** BDGE DECK SEALING 2010-1

FILE NAME =
 c:\pw\work\PW100T\LAUHLINRL\d0180365\

USER NAME = laughlinr1
 72049-bridge-location-map.dgn
 PLOT SCALE = 100.0000' / IN.
 PLOT DATE = Mar-09-2010 08:50:06AM

DESIGNED -
 DRAWN -
 CHECKED -
 DATE -

REVISED -
 REVISED -
 REVISED -
 REVISED -

STATE OF ILLINOIS
 DEPARTMENT OF TRANSPORTATION

SCHUYLER COUNTY
 BRIDGE LOCATION MAP

SCALE: SHEET NO. OF SHEETS STA. TO STA.

F.A. RTE.	SECTION	COUNTY	TOTAL SHEETS	SHEET NO.
*	***	**	8	5

CONTRACT NO. 72049

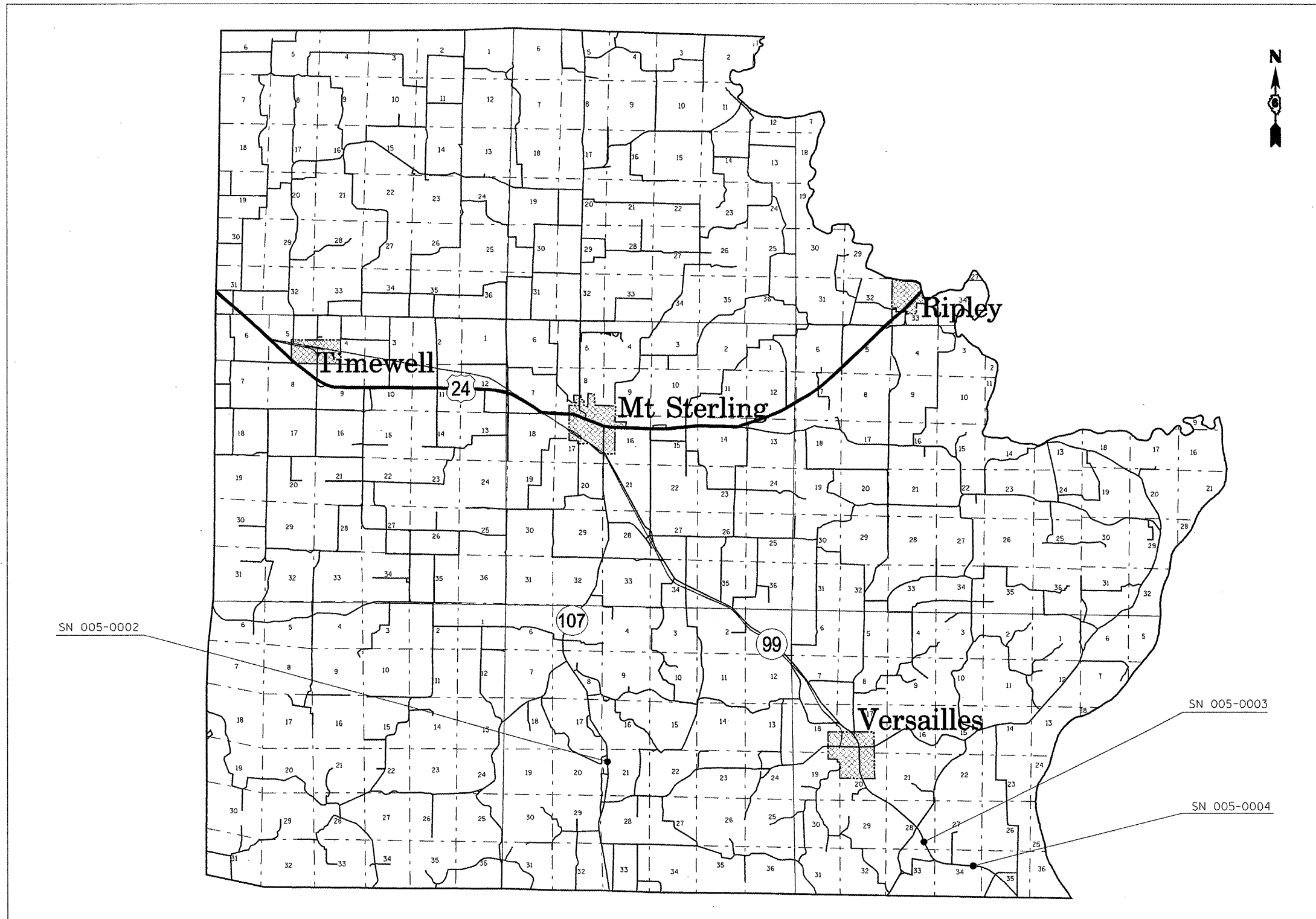

BROWN COUNTY

- * VARIOUS ROUTES
- ** BROWN, PIKE, AND SCHUYLER COUNTIES
- *** BDGE DECK SEALING 2010-1

FILE NAME =	USER NAME = laughlinr1	DESIGNED -	REVISED -
et:\pw\work\PIWIDOT\LAUGHLINR1\0180365\072049-bridge-location-map.dgn		DRAWN -	REVISED -
		CHECKED -	REVISED -
		DATE -	REVISED -

**STATE OF ILLINOIS
DEPARTMENT OF TRANSPORTATION**

BROWN COUNTY BRIDGE LOCATION MAP			
SCALE:	SHEET NO.	OF SHEETS	STA. TO STA.

F.A. RTE.	SECTION	COUNTY	TOTAL SHEETS	SHEET NO.
*	***	**	8	6
CONTRACT NO. 72049				
ILLINOIS FED. AID PROJECT				

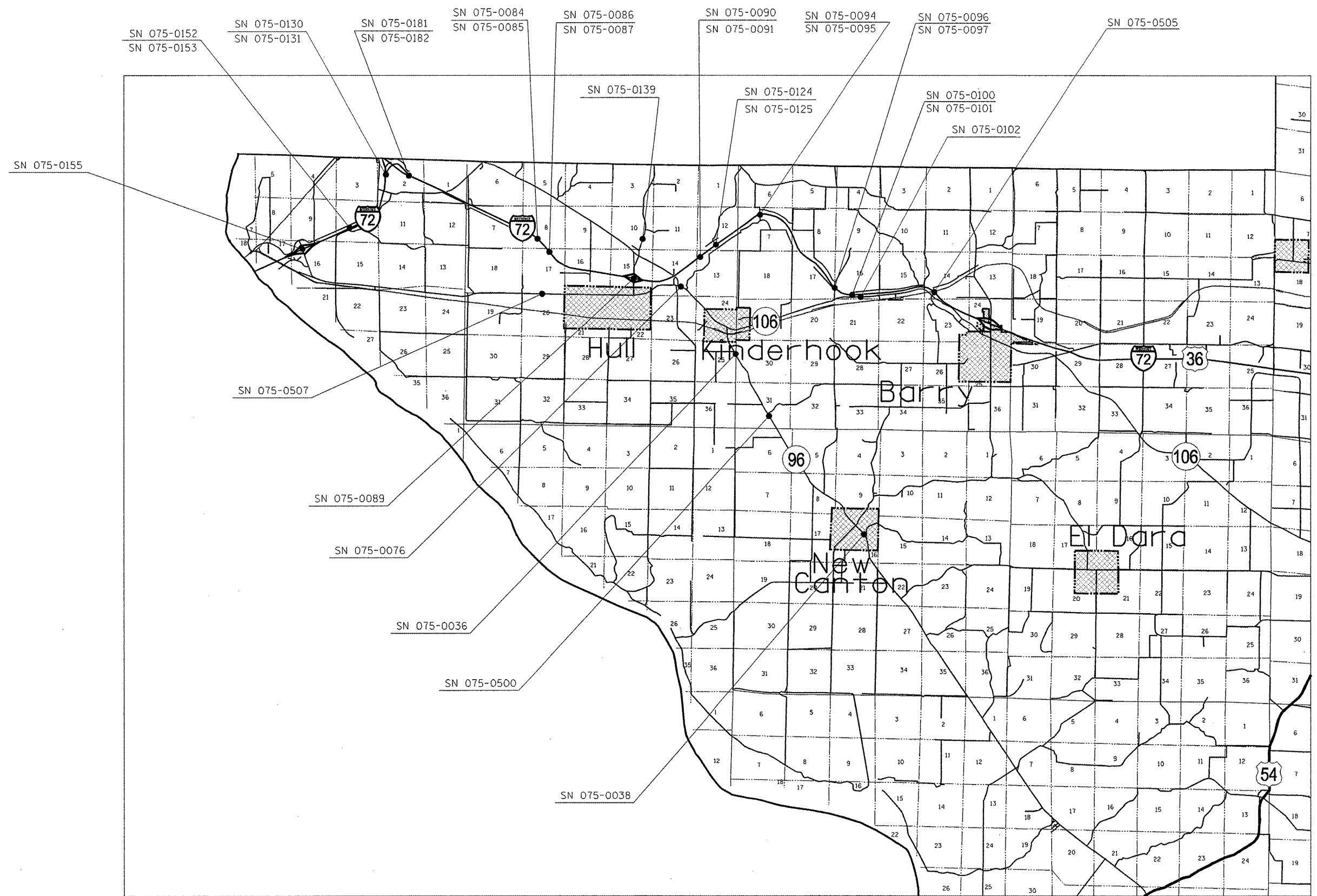

PIKE COUNTY

- VARIOUS ROUTES
- BROWN, PIKE, AND SCHUYLER COUNTIES
- BDGE DECK SEALING 2010-1

FILE NAME = c:\pvc\work\PIV\DOT\LAUGHLIN\RL\0180365\072049-bridge-location-map.dgn	USER NAME = laughlinr1	DESIGNED -	REVISED -	STATE OF ILLINOIS DEPARTMENT OF TRANSPORTATION	PIKE COUNTY BRIDGE LOCATION MAP			F.A. RTE.	SECTION	COUNTY	TOTAL SHEETS	SHEET NO.		
PLOT SCALE = 100,0000' / IN.	PLOT DATE = Mar-09-2010 08:50:11AM	DRAWN -	REVISED -		SCALE:	SHEET NO.	OF	SHEETS	STA.	TO STA.	•	••	8	7
		CHECKED -	REVISED -									•••		
		DATE -	REVISED -											
CONTRACT NO. 72049											ILLINOIS FED. AID PROJECT			

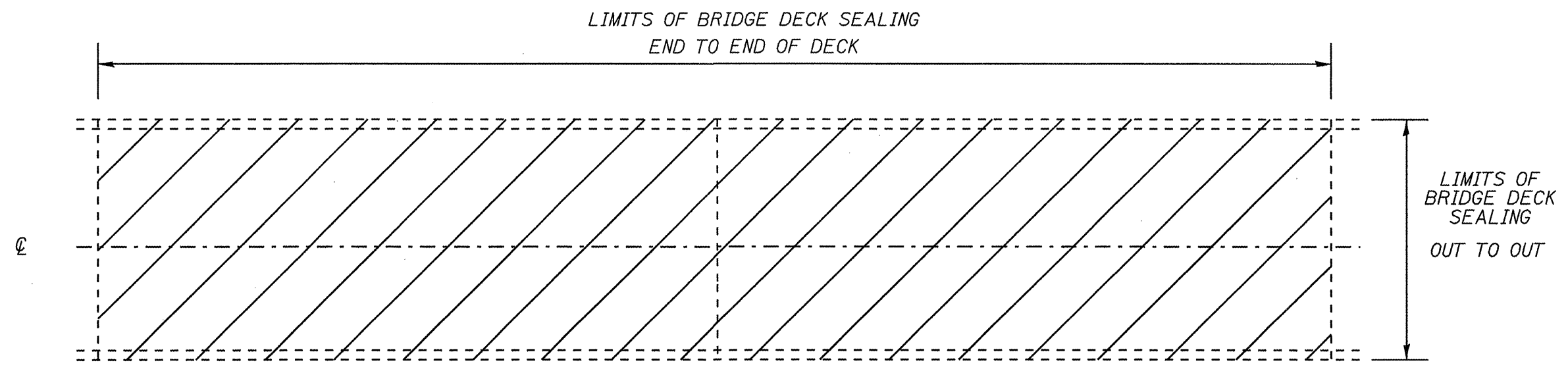

PLAN VIEW

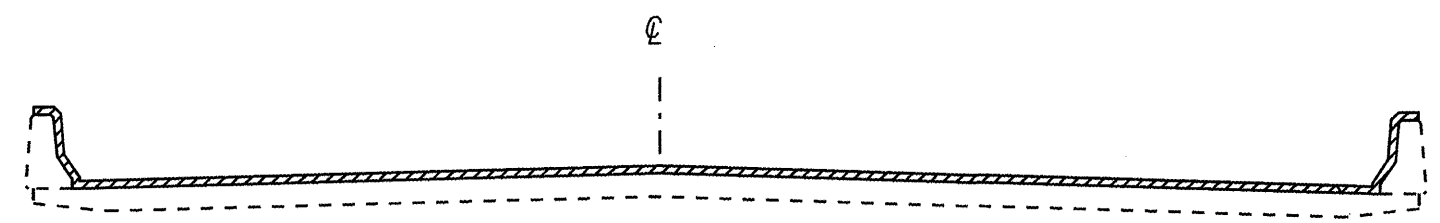

CROSS SECTION WITH PARAPET

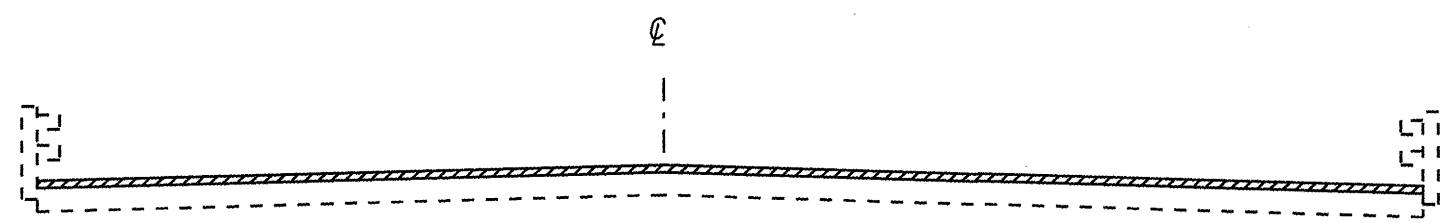

CROSS SECTION WITH BRIDGE RAIL

NOTE: BRIDGE APPROACH PAVEMENT SHALL NOT BE SEALED

NOT TO SCALE

AREA TO BE SEALED

- * VARIOUS ROUTES
- ** BROWN, PIKE, AND SCHUYLER COUNTIES
- *** BDGE DECK SEALING 2010-1

FILE NAME =	USER NAME = laughlinr1	DESIGNED -	REVISED -	STATE OF ILLINOIS DEPARTMENT OF TRANSPORTATION	BRIDGE PLAN SHEET				F.A. RTE.	SECTION	COUNTY	TOTAL SHEETS	SHEET NO.
c:\pwork\pvidot\LAUGHLINR1\0180365\672049-sht-plnprf.dgn	PLOT SCALE = 100.0000' / IN.	DRAWN -	REVISED -		SCALE:	SHEET NO.	OF	SHEETS	STA.	TO STA.	..	8	8
PLOT DATE = Mar-09-2010 08:50:33AM	CHECKED -	REVISED -					CONTRACT NO. 72049		ILLINOIS FED. AID PROJECT				
	DATE -	REVISED -											