

US 24 / US 61  
INTERSECTION

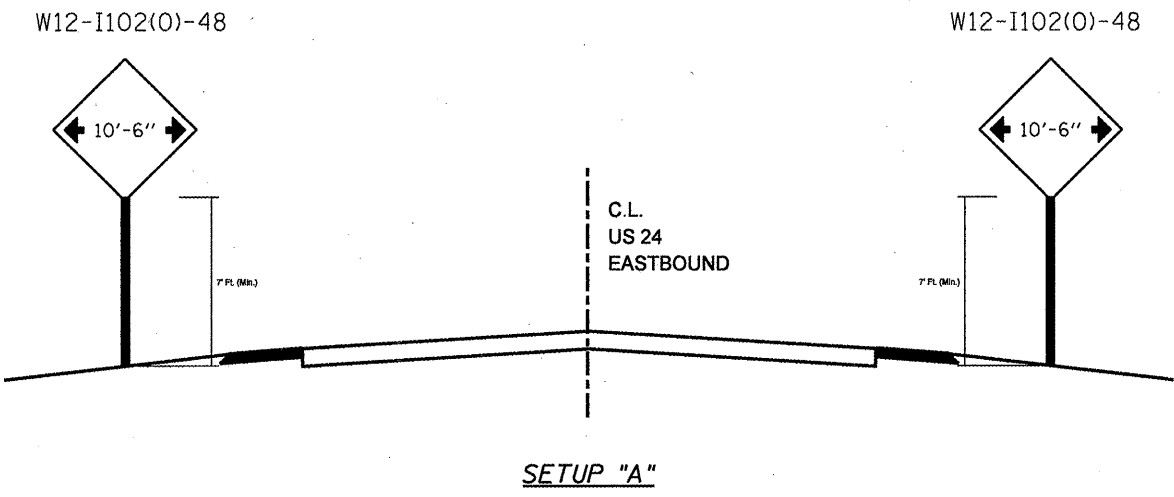

NOTES:  
SIGNS DETAILED IN SETUP "A" SHALL BE PLACED 1000' AHEAD OF THE W20-5(0)-48. "LANE CLOSED 1/2 MILE" SIGNS DETAILED IN STANDARD 701422.  
WORK ZONE SPEED LIMIT SIGNS DETAILED IN THE TRAFFIC CONTROL STANDARDS SHALL BE CHANGED FROM 45 MPH TO 35 MPH.

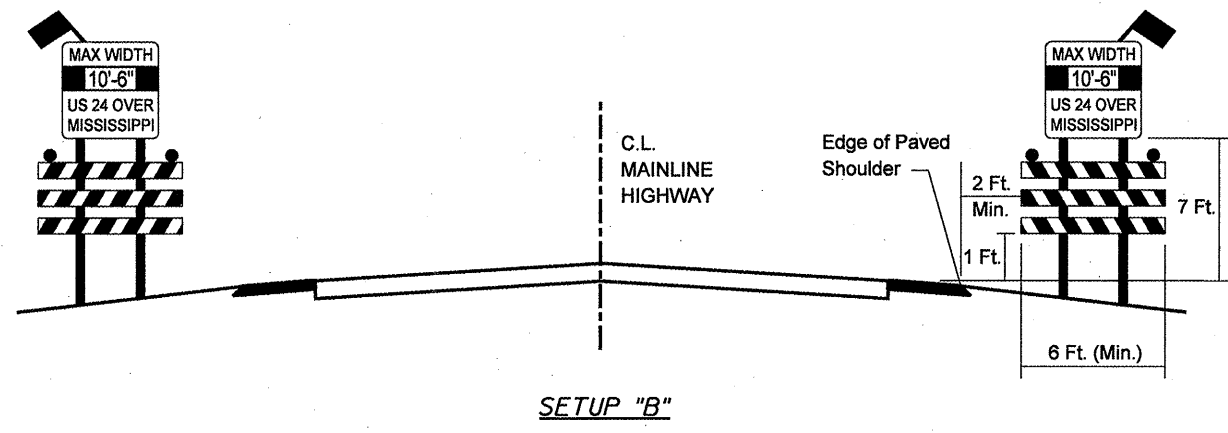
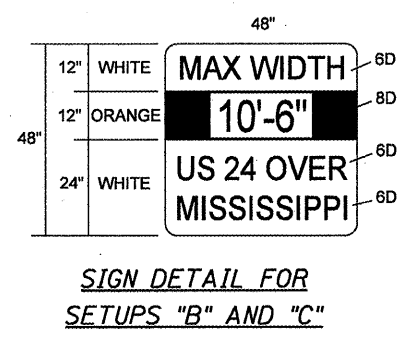
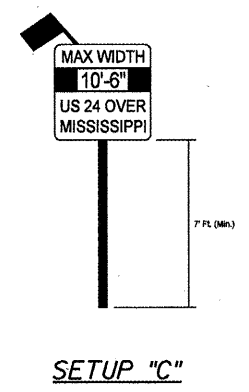

MAXIMUM WIDTH SIGNING PLAN  
FAP 63 (US 24)  
SECTION (12B)I-4  
ADAMS COUNTY