

**SEQUENCE OF CONSTRUCTION:**

**STAGE 1 TRAFFIC:**

SET UP TEMPORARY TRAFFIC CONTROL UTILIZING THESE PLANS IN CONJUNCTION WITH STANDARD 701321.

SIDEWALK SHALL REMAIN CLOSED FOR THE DURATION OF THIS STAGE.

INSTALL TEMPORARY TRAFFIC SIGNALS AND LOOP DETECTORS AT LOCATIONS SHOWN ON THESE PLANS AND STANDARD 701321.

PLACE TEMPORARY CONCRETE BARRIER AND PAVEMENT MARKING IN ACCORDANCE WITH THESE PLANS AND STANDARD 701321.

REMOVE ANY CONFLICTING PAVEMENT MARKINGS.

CHANNEL ALL TRAFFIC TO SOUTH SIDE OF STRUCTURE.

**STAGE 1 CONSTRUCTION:**

INSTALL TEMPORARY SHEET PILING PRIOR TO ANY EXCAVATION.

REMOVE STAGE 1 PORTION OF EXISTING BOX CULVERT, CURB & GUTTER AND PAVEMENT.

CONSTRUCT STAGE 1 PORTION OF BOX CULVERT, WIDENING, SIDEWALK AND RIP RAP.

CONSTRUCT STAGE 1 PORTION OF DRAINAGE ITEMS.

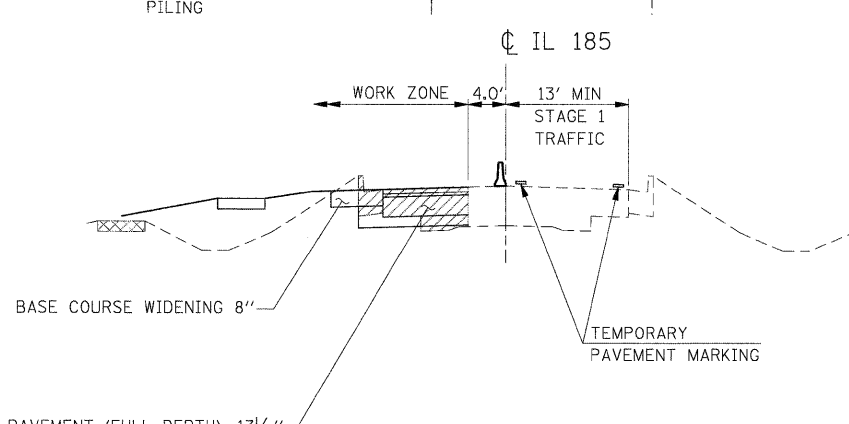
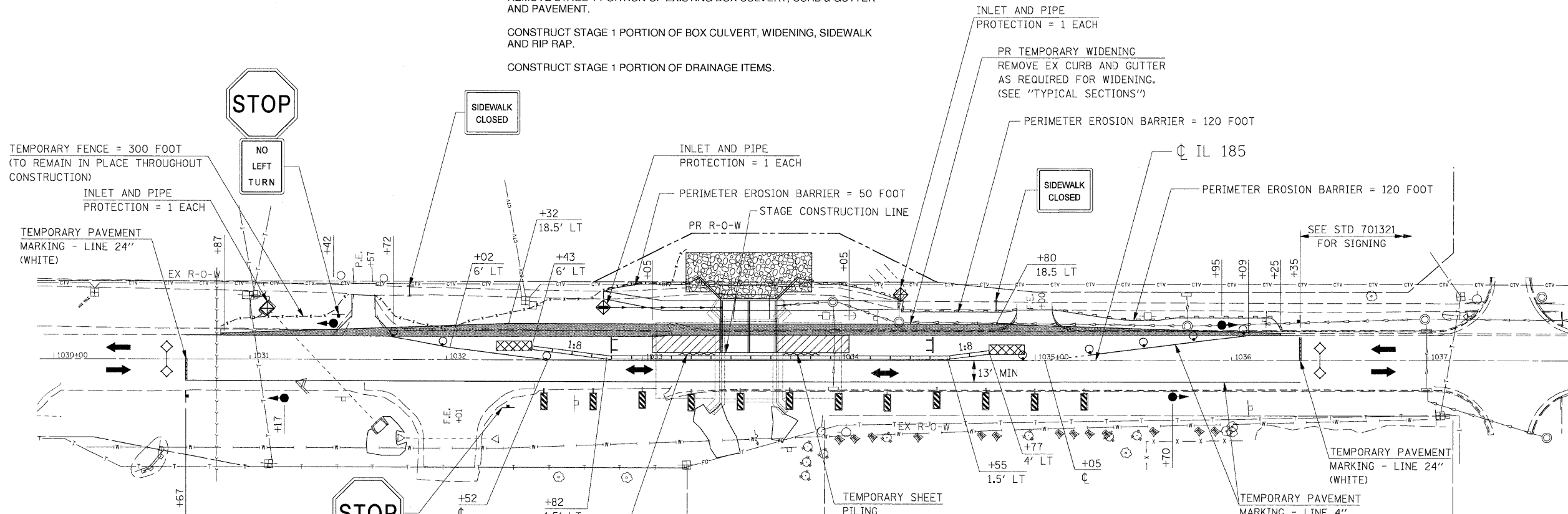
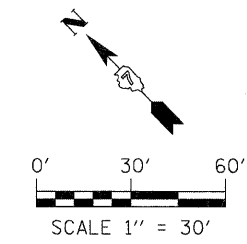

**LEGEND**

+	SIGN
○	DRUM WITH STEADY BURNING LIGHT (BI-DIRECTIONAL)
I	TYPE II BARRICADE
●	TRAFFIC SIGNAL
▬	TEMPORARY CONCRETE BARRIER
▨	IMPACT ATTENUATOR, TEMPORARY
▩	PAVEMENT REMOVAL
➔	DIRECTION OF TRAFFIC
⊥	TYPE III BARRICADE
◇	LOOP DETECTORS
▨	DOUBLE VERTICAL PANEL

**GENERAL STAGING NOTES:**

1. CONTRACTOR SHALL MAINTAIN ACCESS TO ENTRANCES AT ALL TIMES. NO SIGNALS WILL BE REQUIRED.
2. ACCESS MUST BE PROVIDED TO ALL F.E.'s. NO SIGNALS WILL BE REQUIRED.
3. THIS TRAFFIC CONTROL PLAN SHALL BE USED IN CONJUNCTION WITH STANDARD 701321 AND AS DIRECTED BY THE ENGINEER.

FILE NAME =	USER NAME = IC Consultants	DESIGNED -	REVISED -
G:\S08026-G\Cadd Sheets\0774111-sh1-Stage01-1.dgn		DRAWN -	REVISED -
		CHECKED -	REVISED -
		DATE -	REVISED -

**STATE OF ILLINOIS  
DEPARTMENT OF TRANSPORTATION**

**MAINTENANCE OF TRAFFIC – STAGE 1**

SCALE:      SHEET NO.    OF    SHEETS    STA.      TO STA.

<b>PROPOSED S.N. 026-2019</b>	
F.A. RTE.	SECTION
•	1148-1(1) & 1148-1(2)
F.A.P. RTE. 750, F.A.S. RTE. 719	COUNTY
FED. ROAD DIST. NO.	ILLINOIS
TOTAL SHEETS	SHEET NO.
54	38
CONTRACT NO. 74110	
FED. AID PROJECT	