

STATE OF ILLINOIS
DEPARTMENT OF TRANSPORTATION

Notes:
See sheet 15 of 26 for Sections C-C & D-D and View E-E.
a20(E) thru a23(E) & a35(E) thru a42(E) bar spacings measured along \varnothing Rdwy.

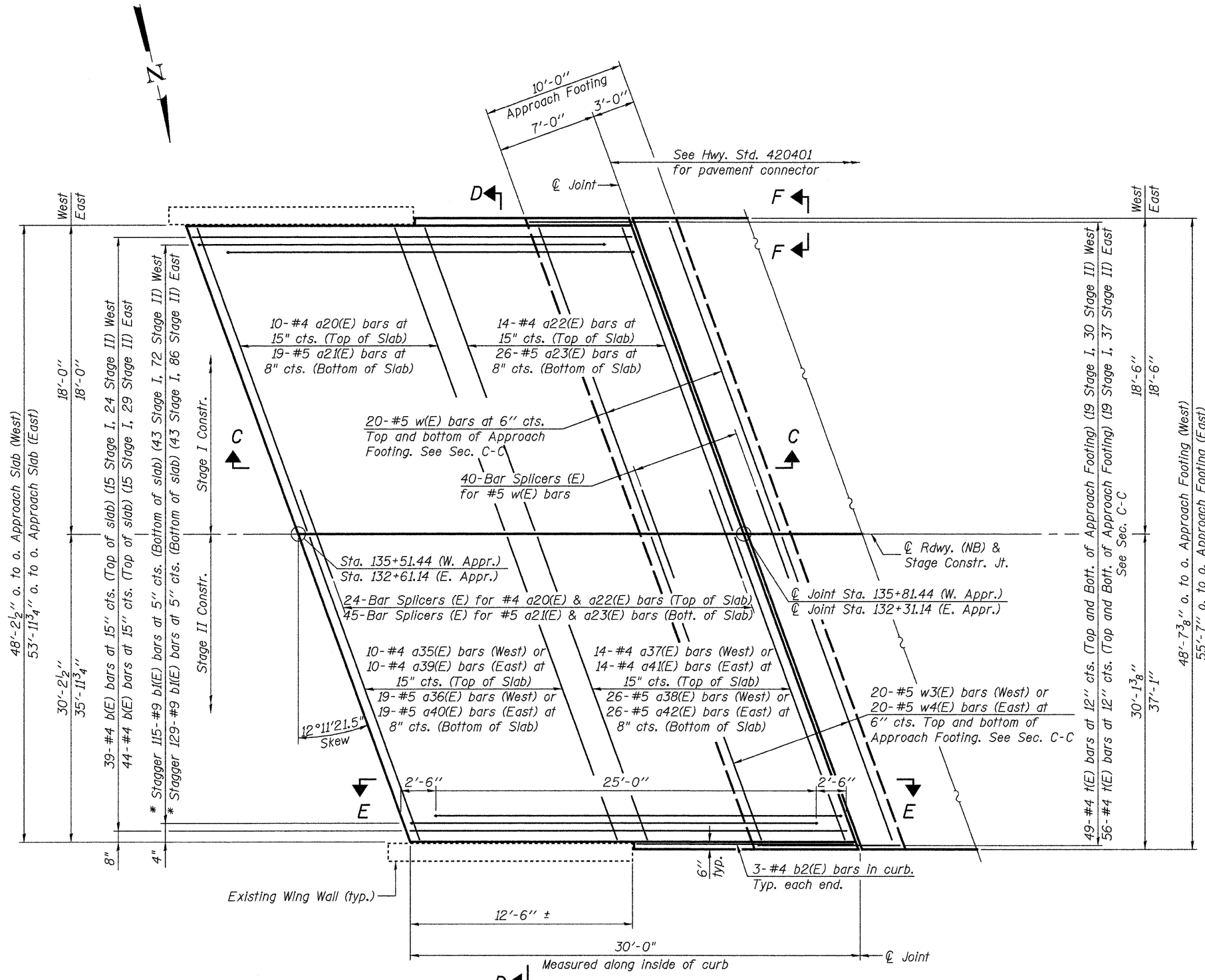

PLAN

(West Approach shown, East Approach similar)

* Tilt #9 b(E) bars as required to maintain clearance.

*** Cost included with Concrete Superstructure.

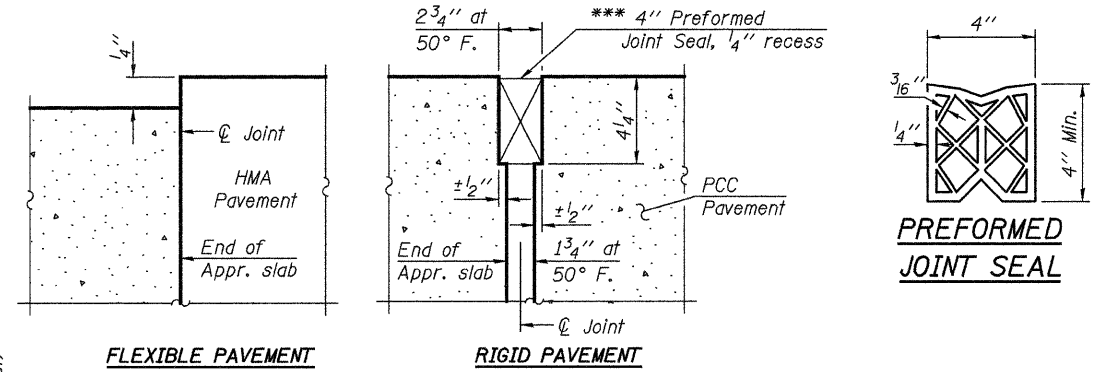

DETAIL A

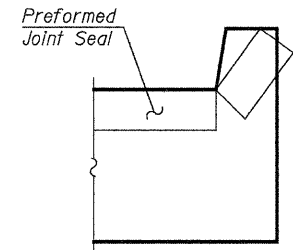

VIEW F-F

Angle Preformed Joint Seal at 45° at curbs when req'd for drainage.

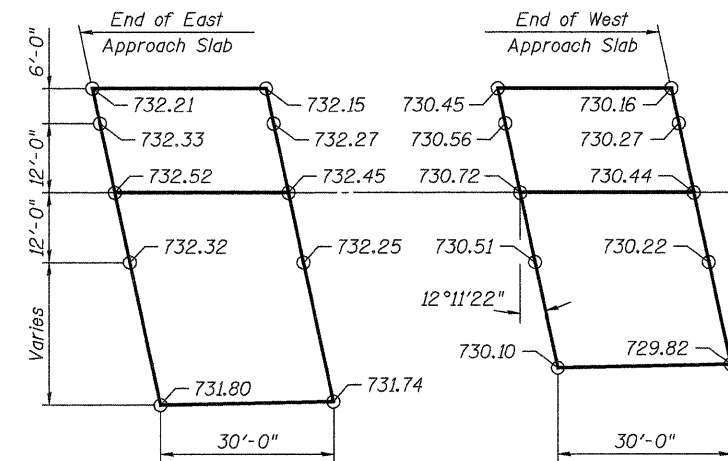

TOP OF APPROACH SLAB ELEVATIONS

NOTE:
Proposed elevations are based on the original 1975 plan elevations, increased by 0.02' (1/4") to account for the proposed deck overlay. The top of the existing pavement at the abutment backwall can be used as a temporary benchmark by assuming the following elevations:
Back of East Abut. original PG Elev. 732.44
Back of West Abut. original PG Elev. 730.71

DESIGNED: JDQ	DRAWN: SJS
CHECKED: DCD	CHECKED: DCD

BA-R 11-1-09 (Modified)

(Sheet 1 of 2)
BRIDGE APPROACH SLAB DETAILS (NB)
STRUCTURE NO. 058-0101(NB) & 0102(SB)

SHEET 14 OF 26	F.A.P. RTE.	SECTION	COUNTY	TOTAL SHEETS	SHEET NO.
	322	158-20/RS	MACON	151	79
STA. 133+62.02			CONTRACT NO. 74150		
FED. ROAD DIST. NO.		ILLINOIS FED. AID PROJECT			

FILE: J:\JDD\10177 IL-DTVV#8 US51Brdge Repairs\1-US51bus-ICRR\0580101-74150-014-appr-slab-NB.dgn

USER: DCD

DATE: 04/09/2010 12:24:41