

EXISTING STRUCTURE: S.N. 058-0104(NB) & 0105(SB), originally constructed in 1976 as FA Route 412 Sec. 58-20-HB-1 at Station 142+55.53, using 54" PPC I-beams with 7 1/2" concrete deck and 1 1/2" bituminous wearing surface, 1 span (plus abutment spans), 137'-3" back-back approach bents, 42'-0" out-out width, vaulted abutments on concrete piles.

STATE OF ILLINOIS  
DEPARTMENT OF TRANSPORTATION

Staged construction shall be used to maintain one lane of traffic in each direction.

INDEX OF SHEETS

Sheet No.	Description
1	Gen Plan, Gen Notes, Bill of Mat'l
2	Temporary Concrete Barrier
3-6	Superstructure
7	Preformed Joint Strip Seal
8	Bearings
9-10	Abutments
11	Bar Splicer Assembly Details

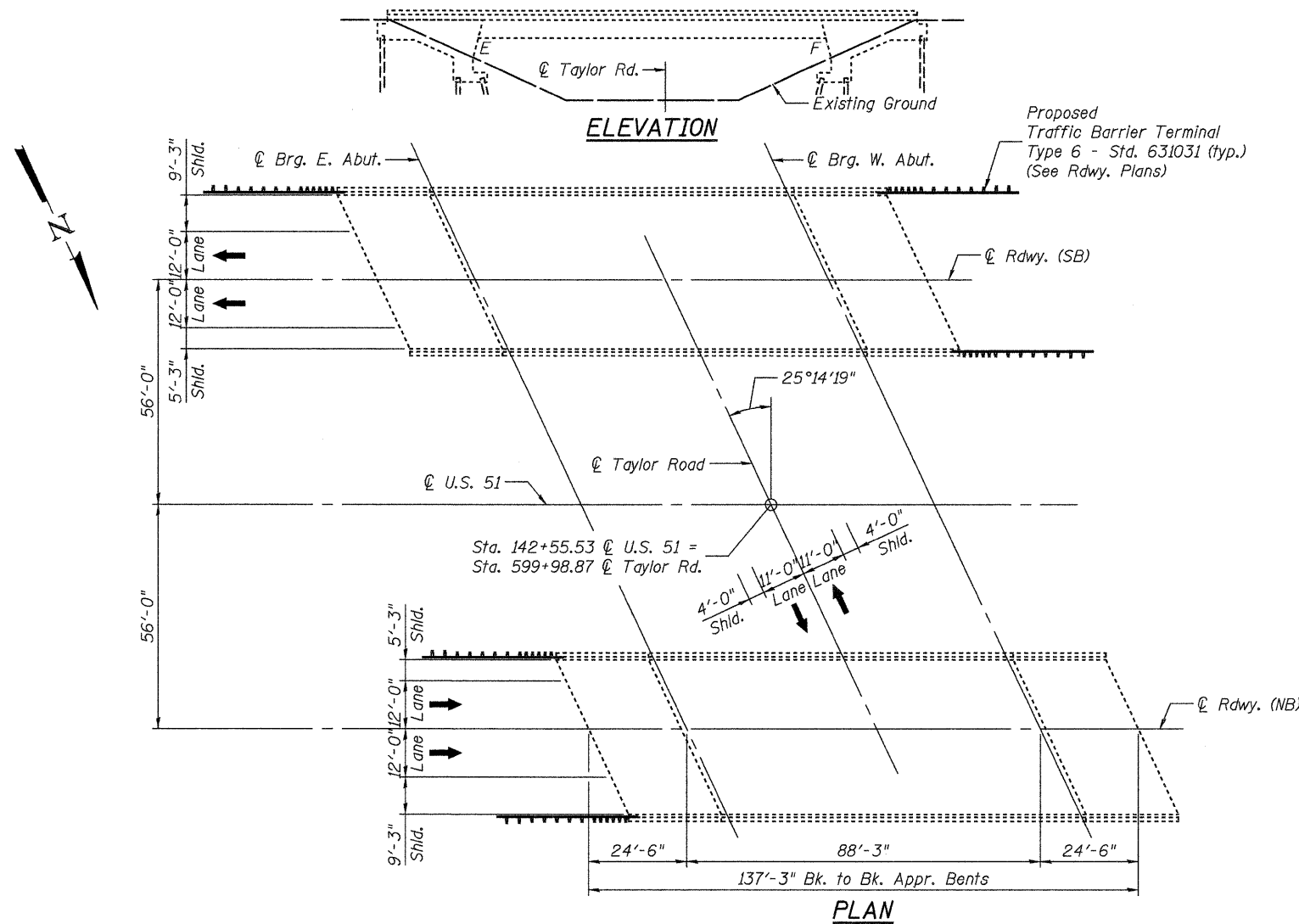

**GENERAL NOTES**

Reinforcement bars shall conform to the requirements of ASTM A 706 Gr 60. See Special Provisions.

Reinforcement bars designated (E) shall be epoxy coated.

Existing reinforcement bars extending into the removal area shall be cleaned, straightened and incorporated into the new construction. Any reinforcement bars that are damaged during concrete removal shall be replaced with an approved bar splicer or anchorage system. Cost Included with Concrete Removal.

Where shown on the plans, reinforcement bars shall be epoxy grouted into existing concrete according to Section 584 of the Standard Specifications. Cost included with Reinforcement Bars, Epoxy Coated.

Plan dimensions and details relative to existing plans are subject to routine variations. The Contractor shall field verify existing dimensions and details affecting new construction and make necessary approved adjustments prior to construction or ordering of materials. Such variations shall not be cause for additional compensation for a change in scope of the work, however, the Contractor will be paid for the quantity actually furnished based upon the unit price bid for the work.

All structural steel shall be shop painted with the inorganic zinc rich primer per AASHTO M300, Type 1. Cost included with Furnishing and Erecting Structural Steel.

Protective Shield shall be provided for the full width of the bridge deck, over the roadway below from edge of shoulder to edge of shoulder.

Joint openings shall be adjusted according to Article 520.04 of the Std. Specs. when the deck is poured at an ambient temperature other than 50° F.

TOTAL BILL OF MATERIAL

ITEM	UNIT	SB	NB
Hot-Mix Asphalt Surface Removal (Deck)	Sq Yd	581	581
Concrete Removal	Cu Yd	23.1	23.1
Protective Shield	Sq Yd	155	155
Concrete Superstructure	Cu Yd	25.6	25.6
Bridge Deck Grooving	Sq Yd	551	551
Protective Coat	Sq Yd	682	682
Furnishing And Erecting Structural Steel	Pound	140	140
Reinforcement Bars, Epoxy Coated	Pound	4420	4360
Bar Splicers	Each	32	32
Preformed Joint Strip Seal	Foot	90	90
Anchor Bolts, 1"	Each	10	10
Structural Repair Of Concrete (Depth = < 5")	Sq Ft	--	5
Bridge Deck Microsilica Concrete Overlay 2 1/4"	Sq Yd	534	534
Bridge Deck Hydro-Scarification 1/2"	Sq Yd	534	534
Deck Slab Repair (Full Depth, Type II)	Sq Yd	8	1

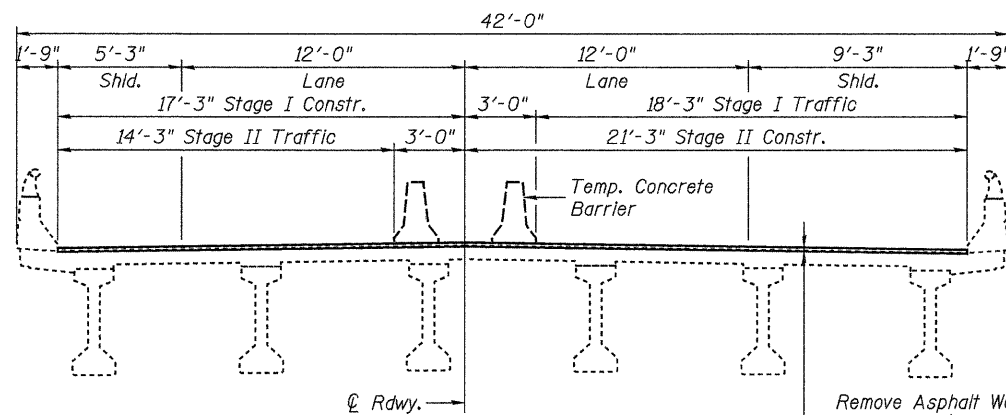

CROSS SECTION  
(Looking with traffic)

Remove Asphalt Wearing Surface.  
Construct 2 1/4" Microsilica Concrete Overlay with 1/2" Hydro-Scarification.

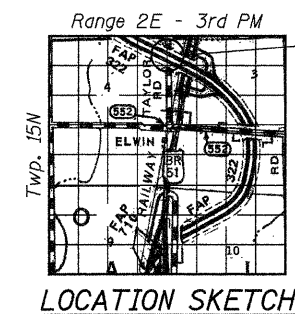

GENERAL PLAN & ELEVATION  
U.S. 51 OVER TAYLOR ROAD  
F.A.P. RTE. 322 SECTION (58-20)RS  
MACON COUNTY  
STATION 142+55.53  
STRUCTURE NO. 058-0104(NB) & 0105(SB)

SHEET NO.	SECTION	COUNTY	TOTAL SHEETS	SHEET NO.
SHEET 1 OF 11	(58-20)RS	MACON	151	92
F.A.P. RTE. 322		STATION 142+55.53		CONTRACT NO. 74150
FED. ROAD DIST. NO.		ILLINOIS FED. AID PROJECT		

**JD** Johnson, Depp & Quisenberry  
CONSULTING ENGINEERS  
Springfield, Illinois

DESIGNED: JDQ DRAWN: SJS  
CHECKED: DCD CHECKED: DCD

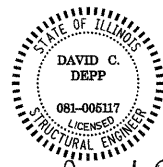

Signed: David Depp  
Date: 4-9-2010  
Lic. Expires: 11-30-2010

FILE: J:\JDD\101077 IL-DTVM#8 USS1 Bridge Repairs\2-TaylorRoad\058004-74150-001-gplan.dgn

USER: DCD

DATE: 04/09/2010 10:50:52